

AN INSULATED 4mm SOCKET, FOR DIRECT MOUNTING ONTO A PRINTED CIRCUIT BOARDS.  
GROOVES IN THE OUTER ACETAL HOUSING PROVIDE STACKING ALIGNMENT  
FOR BOARD SPACE SAVING.

DIMENSIONS

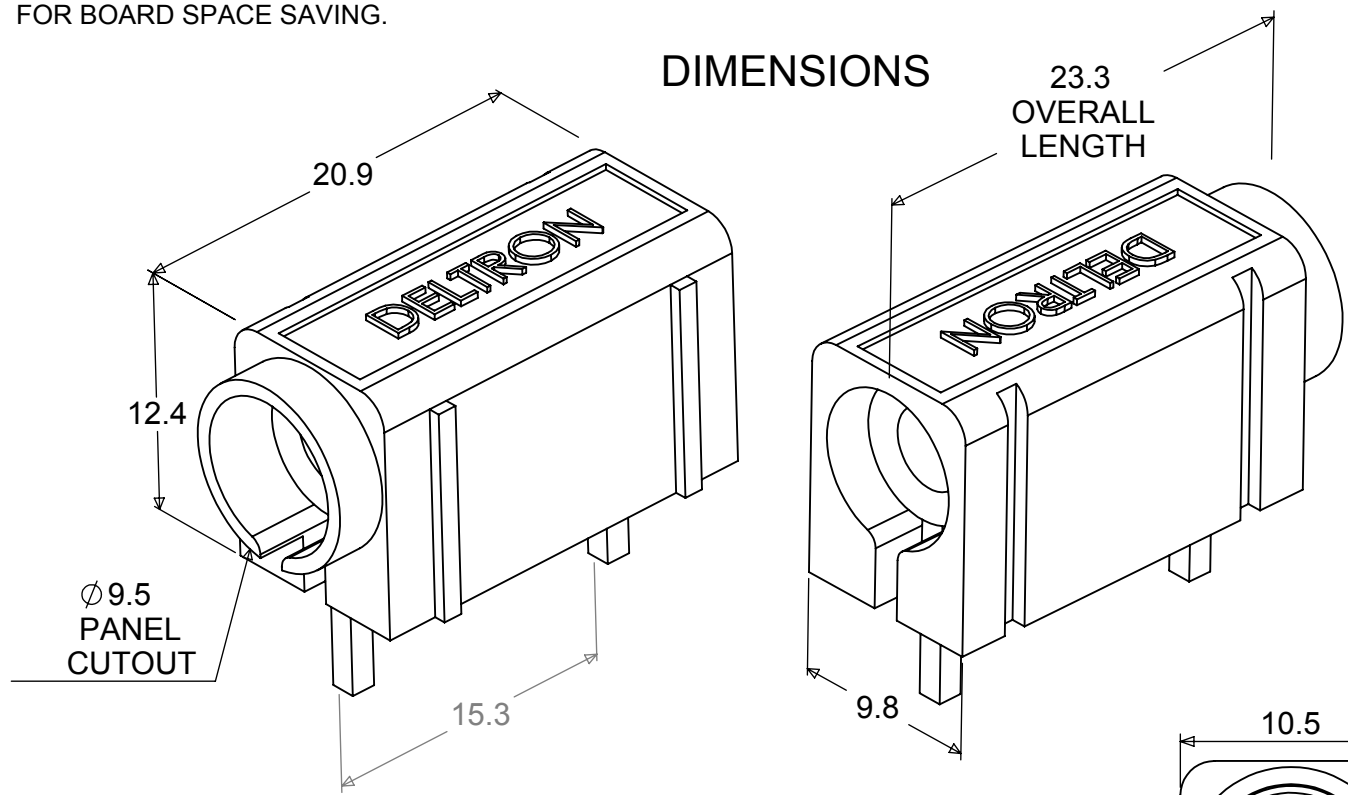

Insulant	Acetal
Pin	Brass, Silver Plate
Bush	Brass, Silver Plate
Amps	10A
Working Voltage	50V
Contact Resistance	10mΩ
Maximum Temperature RTI	+ 110 °C
Minimum Temperature	- 25 °C
Recommended Temperature	10A @ 55 °C
Voltage Breakdown	5000V
Recommended Conductor Size	1.5mm <sup>2</sup>
Colours	Order Code
Black	571-0110
Blue	571-0210
Brown	571-0310
Green	571-0410
Red	571-0510
White	571-0610
Yellow	571-0710

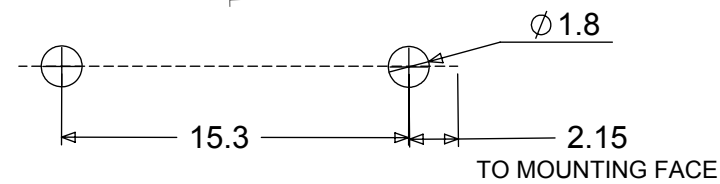

PCB LAYOUT

PCB PIN LENGTH

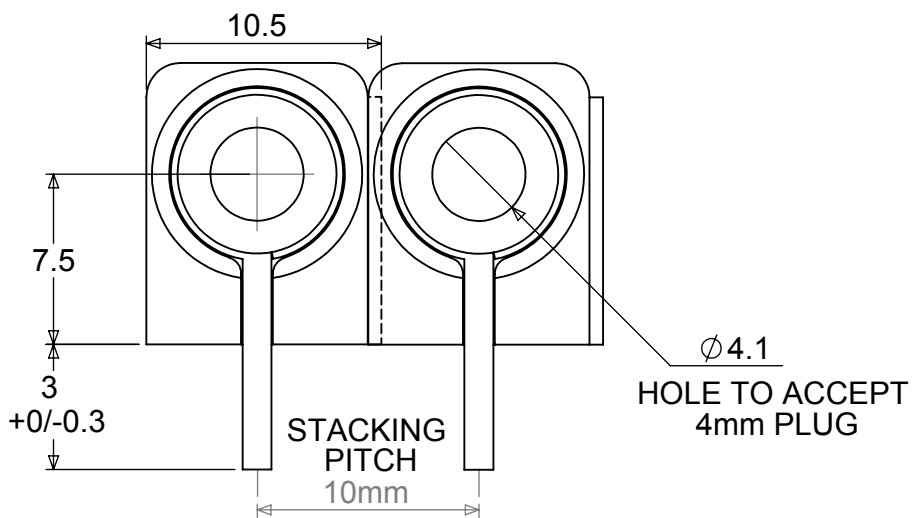

Component complies with 260° deg J-STD-075  
Non-IC Electronic Components Standard  
Met PSL W4

90° PCB MOUNTED INSULATED SOCKET-SINGLE