

PART NUMBER	PLATING	AWG SIZE	DIM A
10171423-S02LF	SILVER	4	7.6
10171423-S03LF		2	8.9
10171423-S05LF		1/0	11.2

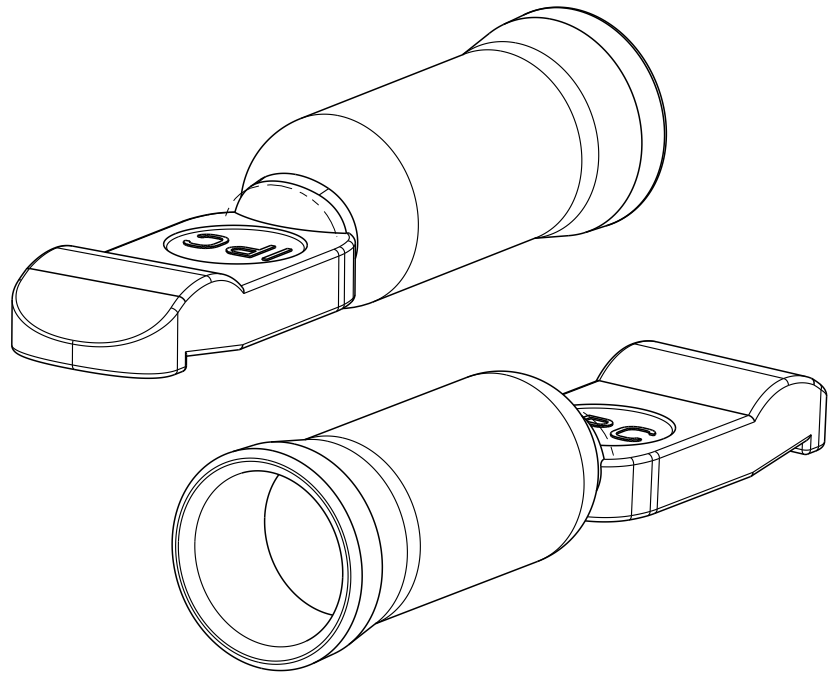
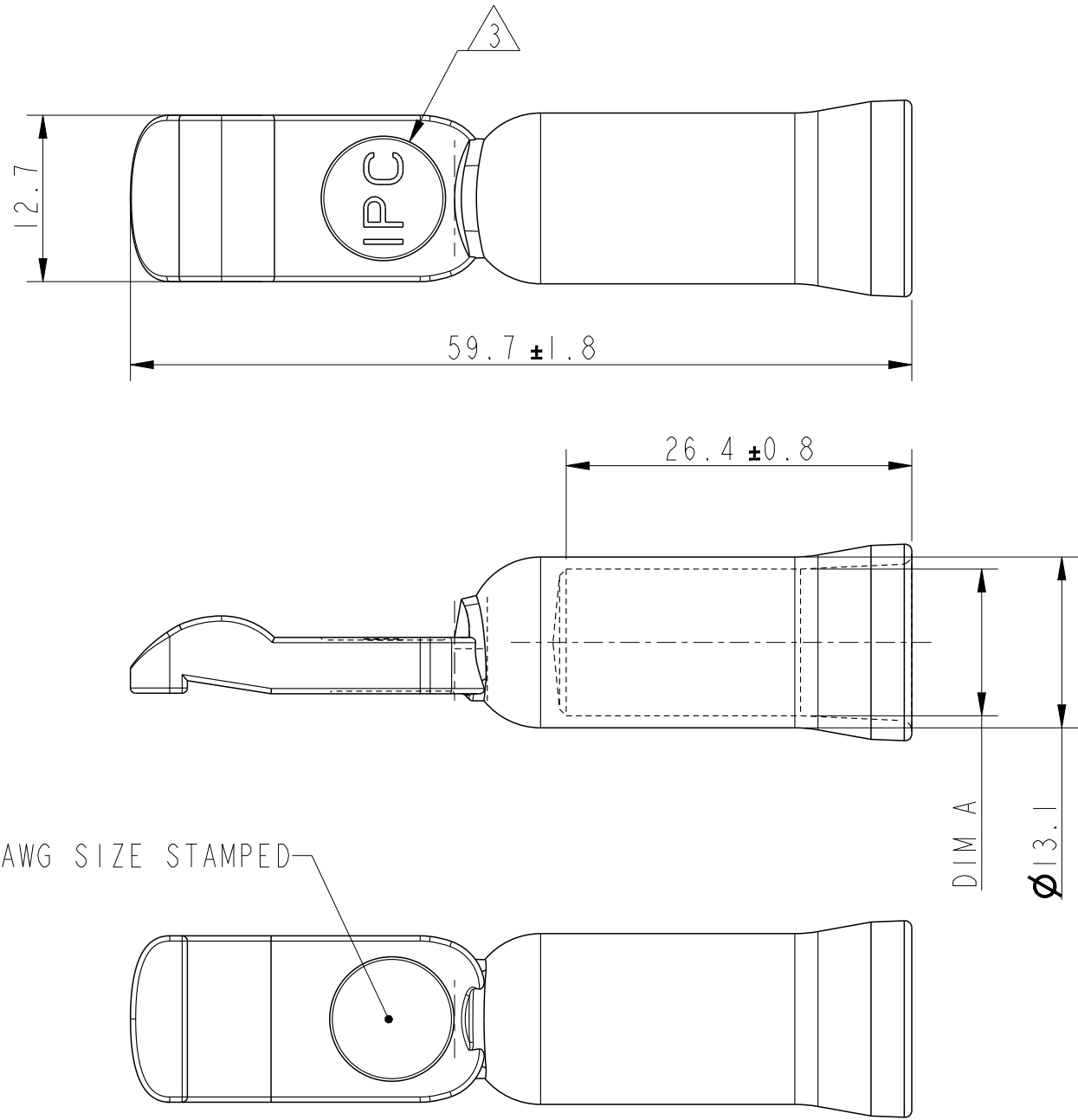

NOTES :

1 - MATERIAL : COPPER ALLOY

2 - SILVER PLATED

3 - STAMP MARK MAY BE ROTATED

spec ref		dr		Anooj-P Jacob		2024/03/18		<div>Amphenol Power Solutions</div>			<div>MM</div>		scale		size				
tolerance std		eng		Anooj-P Jacob		2024/03/18					ecn no								
ISO 406 ISO 1101		rvwr		-		-					rel level								
TOLERANCES UNLESS OTHERWISE SPECIFIED		appr		Varma Sudhir		2024/03/18		A Division of Amphenol Corporation			amphenol-icc.com			Released					
<div>surface</div> <div>ISO 1302</div>		<div>linear</div>		<div>0.X</div> <div>±0.5</div>		<div>0.XX</div> <div>±0.2</div>		<div>0.XXX</div> <div>±0.1</div>		<div>projection</div> <div></div>		<div>title</div> <div>IPC-S180/M175 CONTACT</div> <div>ePwr™ BATTERY CONNECTOR</div>		<div>dwg no</div> <div>10171423</div>		<div>rev</div> <div>A</div>			
angular		0°		±2°		product family		-		Product - Customer Drw			sheet 1 of 1						