

REVISIONS

P	LTR	DESCRIPTION	DATE	DWN	APVD
	A	REVISED PER ECN-24-291266	30OCT2024	TR	GA

NOTE:

1.MATERIALS AND FINISH

INSULATOR : LCP BK UL-94V0,
SHELL : PHOSPHOR COPPER,NICKEL PLATED
CONTACT MATERIAL : PHOSPHOR COPPER,
SELECTIVE GOLD FINISH

2.ELECTRICAL CHARACTERISTICS

CONTACT CURRENT RATING : 0.5 AMPS
CONTACT VOLTAGE RATING:40VAC
CONTACT RESISTANCE :30 MILLIOHMS MAX.
DIELECTRIC WITHSTANDING VOLTAGE : 150V AC MIN.
INSULATION RESISTANCE : 100 MEGAOHMS MIN.

3.MECHANICAL

MATING FORCE:4.5Kgf MAX.
UNMATING FORCE:0.5Kgf MIN
DURABILITY LIFE: 5,000 Cycles;

4.ENVIRONMENTAL

TEMPERATURE RATING : -20°C ~ +85°C

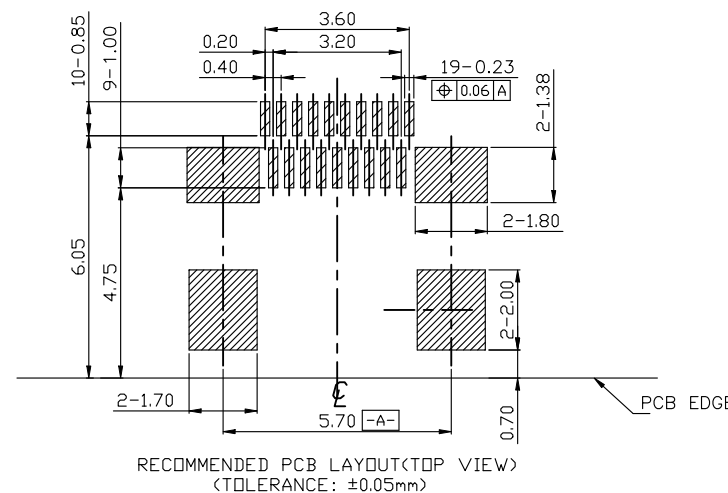
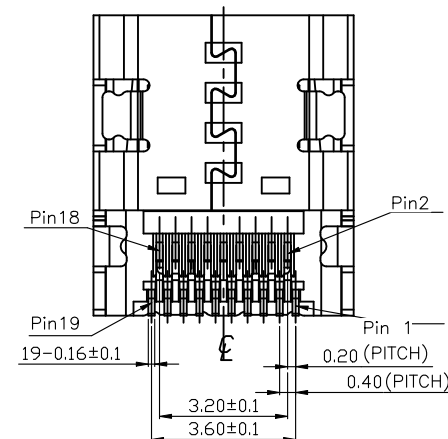
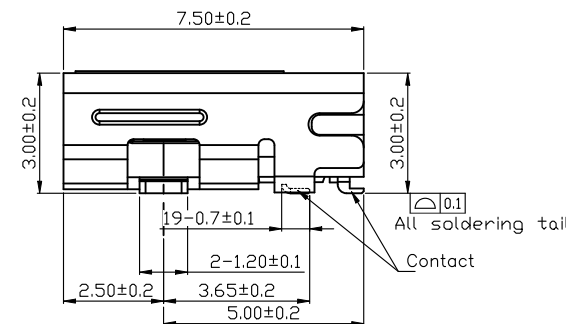
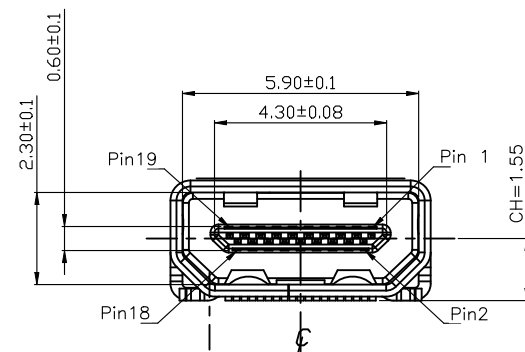
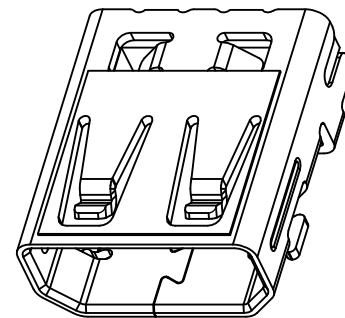
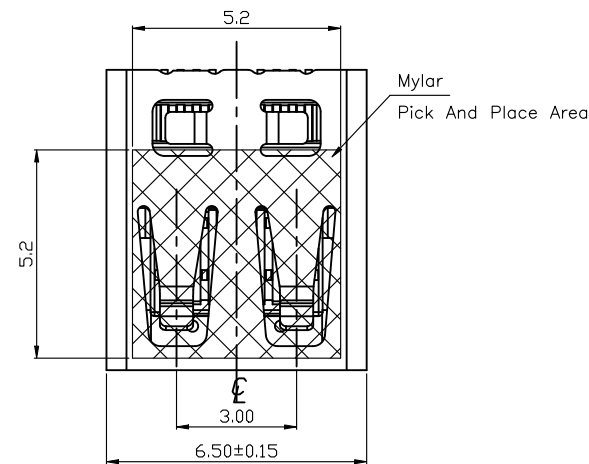

PIN	Signal Assignment	PIN	Signal Assignment
1	Hot Plug Detect	2	Utility
3	TMDS Data2+	4	TMDS Data2 Shield
5	TMDS Data2-	6	TMDS Data1+
7	TMDS Data1 Shield	8	TMDS Data1-
9	TMDS Data0+	10	TMDS Data0 Shield
11	TMDS Data0-	12	TMDS Clock+
13	TMDS Clock Shield	14	TMDS Clock-
15	CEC	16	DDC/CEC Ground
17	SCL	18	SDA
19	+5V Power		

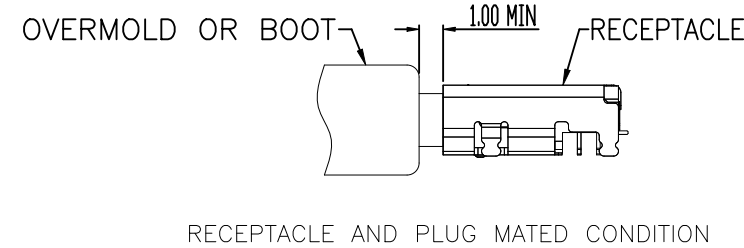

THIS DRAWING IS A CONTROLLED DOCUMENT.

DIMENSIONS:
mm

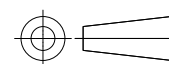

MATERIAL

TOLERANCES UNLESS
OTHERWISE SPECIFIED:

0 PLC ± 0.35
1 PLC ± 0.30
2 PLC ± 0.20
3 PLC ± -
4 PLC ± -
ANGLES ± 2°

FINISH

DWN 19SEP2024

CHK TARUN, R 20SEP2024

GIRIDHAR, VA

APVD 20SEP2024

RAGHAVAN, CG

PRODUCT SPEC

108-161524

APPLICATION SPEC

WEIGHT 0

CUSTOMER DRAWING



TE Connectivity

NAME
HDMI 19P 3.00H DF STD SMT CONN

SIZE CAGE CODE DRAWING NO RESTRICTED TO

A3 00779 C-2494823

SCALE 1:1 SHEET 1 OF 2 REV A

REVISIONS					
P	LTR	DESCRIPTION	DATE	DWN	APVD
	—	SEE SHEET 1	—	—	—

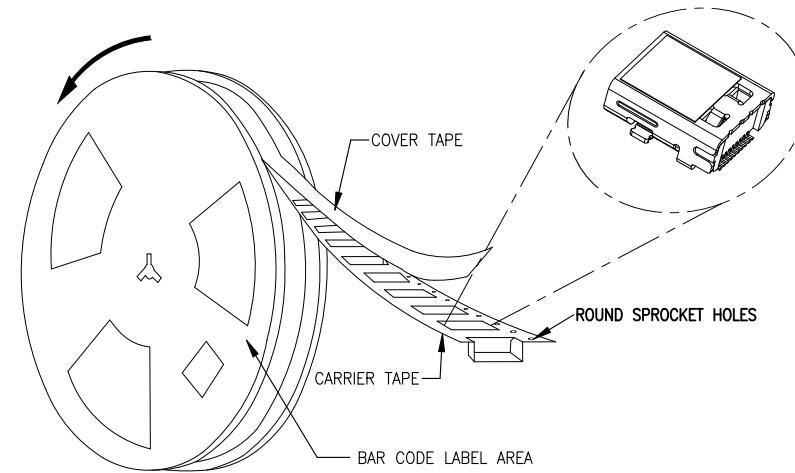
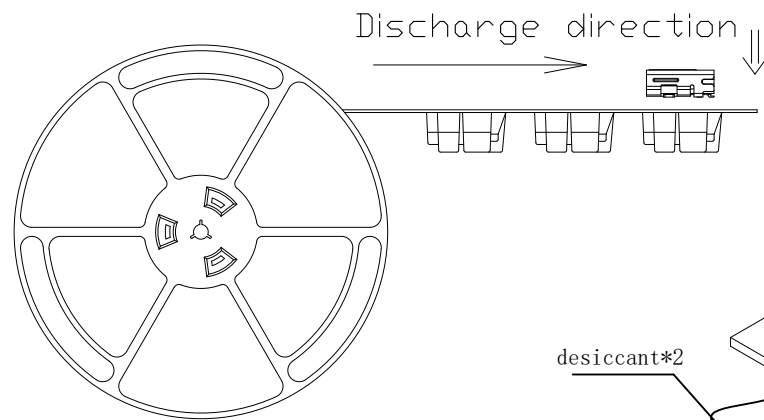
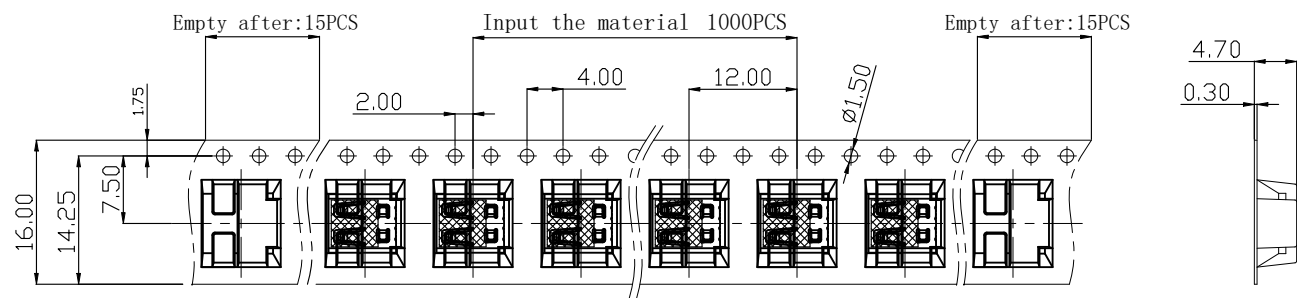

Per roll:1000PCS

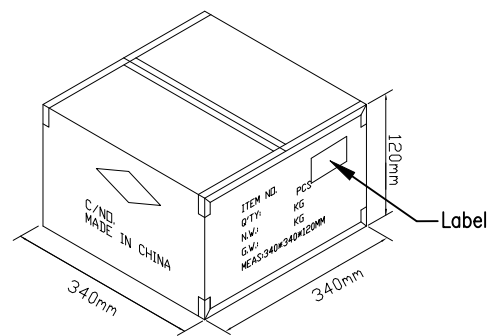

aling the case with transparent tape, attach various labels according to the figure

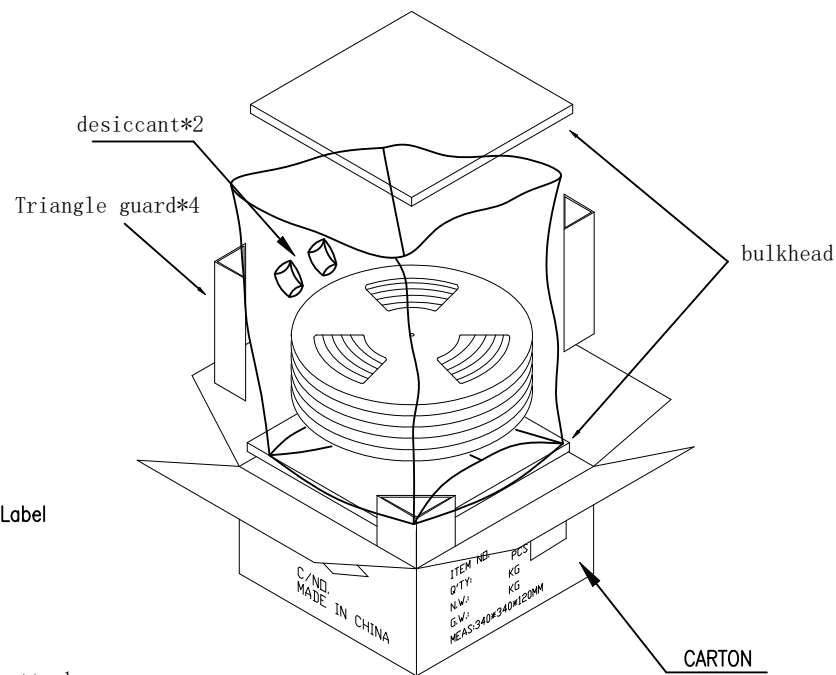

Each bag (1 trays) is packed in one box, that is, 1000PCS/ box

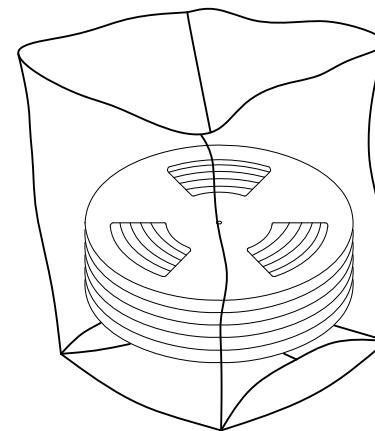

Every 1 plates in a waterproof bag, That is 1000PCS/ bag

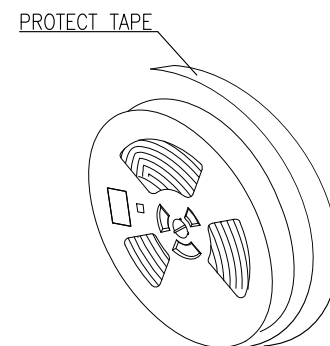

Wrap protective tape and label it

Note:

1. Each plate contains 1000PCS of products.
2. Each 1 plates of products (1000PCS) into a moisture-proof bag
3. Each bag (1000PCS) is packed in one box
4. Outer box size and specification: 340*340*120mm
5. All kinds of labels need to be posted according to the position shown.
6. The carrier belt is heat-sealed packaging

THIS DRAWING IS A CONTROLLED DOCUMENT.		DWN TARUN, R 19SEP2024	TE Connectivity		
		CHK GIRIDHAR, VA 20SEP2024			
		APVD RAGHAVAN, CG 20SEP2024	NAME		
		PRODUCT SPEC 108-161524	HDMI 19P 3.00H DF STD SMT CONN LCP,BK,Gold 1u",label,roll packaging		
		APPLICATION SPEC	—		
		WEIGHT	SIZE A3	CAGE CODE 00779	DRAWING NO C-2494823
		CUSTOMER DRAWING	SCALE 1:1		SHEET 2 OF 2
					REV A