

PART
NUMBER: 680-SMG

CUSTOMER PRINT

NOTES:

1. MATERIAL: BRASS
2. FINISH: GOLD OVER NICKEL

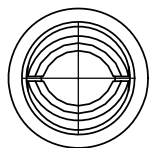

END VIEW

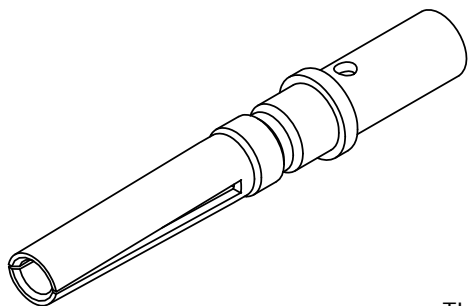
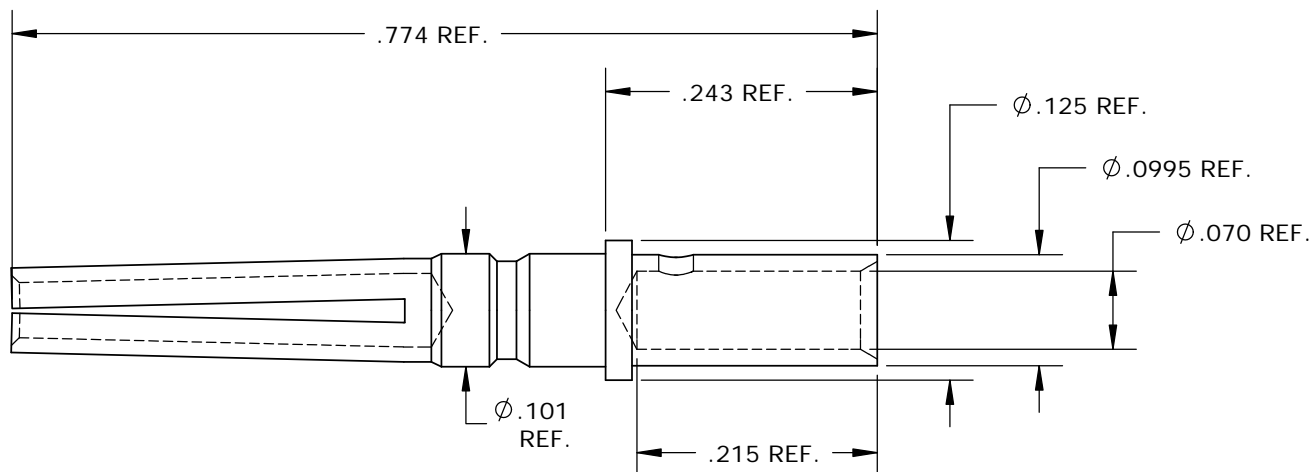

PROPRIETARY

THIS DOCUMENT CONTAINS CONFIDENTIAL
INFORMATION PROPRIETARY TO CONXALL
CORPORATION. ANY REPRODUCTION,
DISCLOSURE, OR USE OF THIS
DOCUMENT /INFORMATION IS EXPRESSLY
PROHIBITED UNLESS AUTHORIZED IN
WRITING BY CONXALL CORPORATION.

D	AN	02-27-09	CONVERTED TO SOLIDWORKS, UPDATED VIEWS PER ECR 7120						
C	TG	03-09-99	MODIFIED TINES PER ECR 2887						
REV.	INIT.	DATE	DESCRIPTION						
<div>ALL INFORMATION ILLUSTRATED IS THE PROPERTY OF "CONXALL CORPORATION." UNAUTHORIZED DUPLICATION OR DISTRIBUTION OF THIS DOCUMENT IS PROHIBITED.</div> <div>ALL UNITS ARE IN FEET, INCHES, FRACTION OF INCHES AND DECIMALS UNLESS OTHERWISE SPECIFIED TOLERANCES: 3 PLACE DECIMALS ± .005 ANGLES ±1° FRACTIONS ±1/16</div> <div>▷ = CRITICAL CHARACTERISTIC FLAG PER SPEC. XXXX</div>			ORIG. DRAWN BY:		DATE:		<div>conxall</div> <div>601 E. WILDWOOD VILLA PARK, IL 60181</div>		
			G.A.		01-08-96				
			CHECKED BY:						
			APPROVED BY:						
<div>SCALE</div> <div>NTS</div>			<div>SIZE</div> <div>A</div>		<div>SHEET</div> <div>1 OF 1</div>		TITLE:	CONTACT, SOCKET, #16 CRIMP TYPE GOLD PLATED STANDARD PRODUCT	
			FILE:		DIRECTORY:		CUSTOMER:		
			680-SMG		SLW		PART NUMBER:	680-SMG	
								REV	D