

REVISIONS			
REV.	DESCRIPTION	DATE	BY
A1	RELEASE	8/23/2024	CE

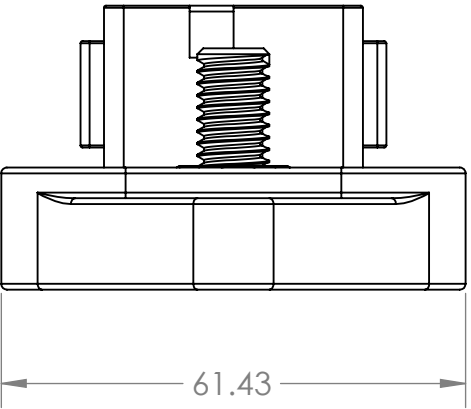
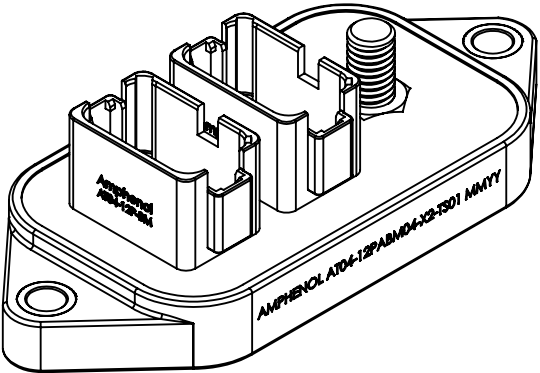
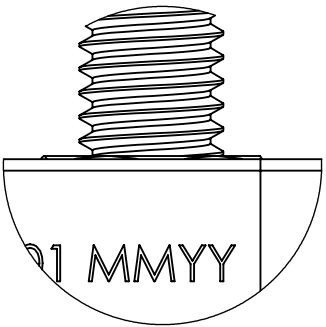
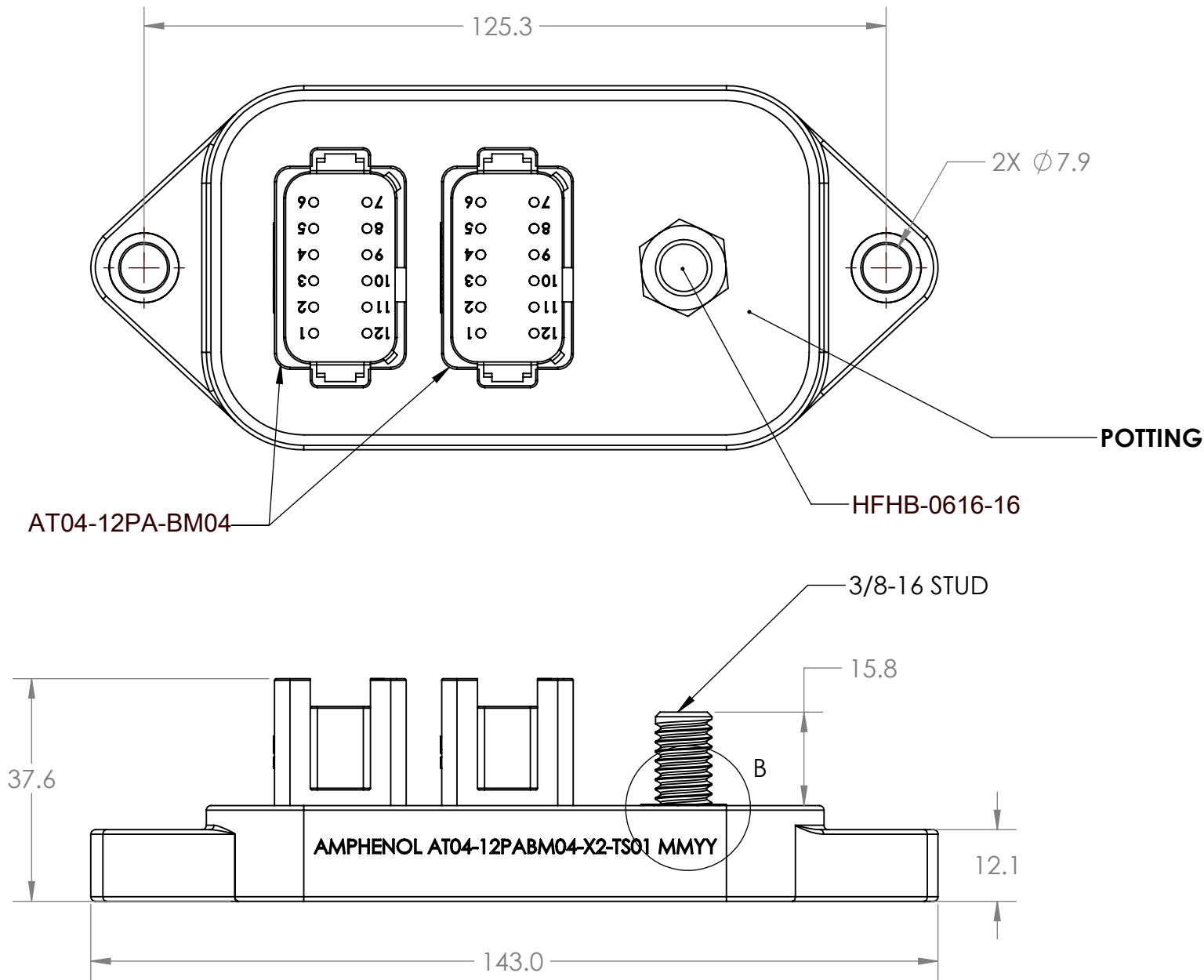

NOTES: UNLESS OTHERWISE SPECIFIED

1. MATERIAL:
HOUSING: THERMOPLASTIC
CONTACT: COPPER ALLOY
SLEEVE: ALUMINUM; BLACK ANNODIZED
2. MODIFICATIONS: ALL 25 PINS BUSSED TOGETHER.
3. SPECIFICATIONS:
3.1 CURRENT RATING: (HFHB-0616-16) 300 AMPS MAX.
(AT04-12PA-BM04) 13 AMPS MAX PER PIN.
3.2 OPERATING TEMPERATURE: -55°C TO +125°C
3.3 DIELECTRIC WITHSTANDING VOLTAGE: LESS THAN 2 MILLIAMPS CURRENT LEAKAGE @ 1500 VOLTS AC.
3.4 INSULATION RESISTANCE: 1000 MEGOHMS MIN @ 25°C.
3.5 IP68 (1M of water for a period of 24 hours, in mated condition) IP69K (in mated condition)
3.6 MATING CYCLE DURABILITY: 100 CYCLES
3.7 RoHS COMPLIANT
4. MATING PART:
3/8-16 STUD
AT04-12PA-BM03: AT06-12SX* PLUG (X = A,B,C,D KEYS; * = MODIFICATIONS)
5. ALL DIMENSIONS ARE FOR REFERENCE USE ONLY.

UNLESS OTHERWISE SPECIFIED:		SIGNATURES		DATE	<div>Amphenol</div> <div>Sine Systems - www.amphenol-sine.com 44724 Morley Drive Clinton Township, MI 48036</div> <div>DESCRIPTION: HYPERBUSS 300 AMP POWER SPLITTER STRAIGHT 24 POSITION, 16AWG, NICKEL, THREADED STUD, POTTED,</div> <div>SIZE DWG NO: REV</div> <div>B AT04-12PABM04-X2-TS01 A1</div> <div>SCALE: NONE SHEET 1 OF 1</div>
1) DIMENSIONS ARE IN METRIC(mm) 2) TOLERANCES ARE AS FOLLOWS: 1 PL DEC: ± 0.5 FRACTIONAL: ± 1/8 2 PL DEC: ± 0.25 ANGLES: ± 1° 3 PL DEC: ± 0.1		DRAWN:	CE	7/15/2024	
3) NOTE REFERENCE =		CHECKED:			
		ENGINEER:			
		APPROVAL:			
MATERIAL SPECIFICATIONS:		THIS DRAWING IS SUPPLIED FOR INFORMATION ONLY. DESIGN FEATURES, SPECIFICATIONS AND PERFORMANCE DATA SHOWN HEREON ARE THE PROPERTY OF THE AMPHENOL CORPORATION. NO RIGHTS OF REPRODUCTION ARE IMPLIED. ALL DIMENSIONS ARE SUBJECT TO NORMAL MANUFACTURING VARIATIONS.			
WEIGHT:					
DO NOT SCALE DRAWING					