

# NOTES:

1. ALLOWABLE FLEXIBLE LIGHT PIPE CUT LENGTH AVAILABLE IN INCREMENTS OF 0.05".
2. MINIMUM BEND RADIUS OF FLEXIBLE LIGHT PIPE: 1.22" [31mm].
3. LENS AND FLEXIBLE LIGHT PIPE SHIPPED ASSEMBLED. ADAPTER AND SEALING GASKET SHIPPED NON-ASSEMBLED.
4. SEE SHEET 2 FOR DETAILED ASSEMBLY INSTRUCTIONS TO ACHIEVE OPTIMUM FUNCTION OF SEALING GASKET.

REVISIONS			
REV.	DESCRIPTION	DATE	APPROVED
A	Engineering Release	2/27/2025	A.V.
B	ECO-1335: Updated Adapter Mounting Holes	6/17/2025	A.V.

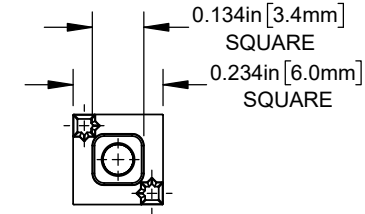
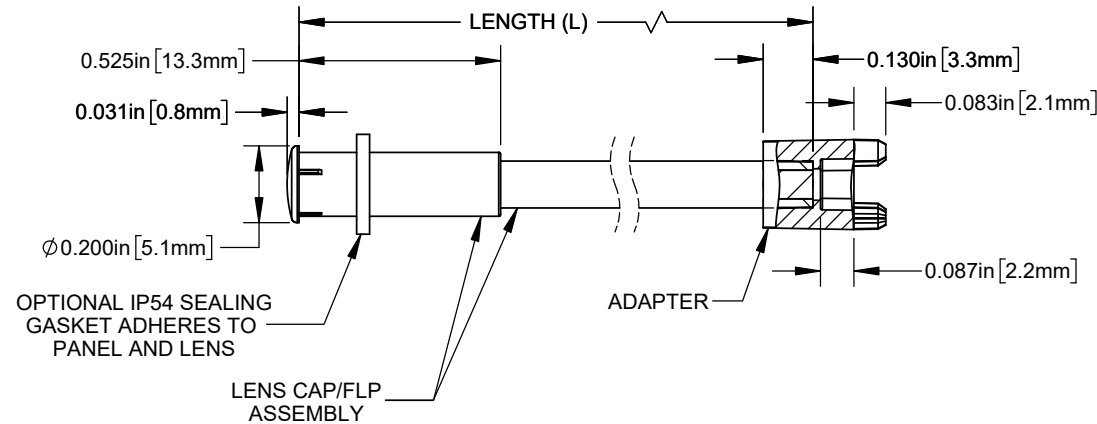

## PART NUMBER CONFIGURATOR

SEE SHEET 2 FOR ORDERING INFORMATION

SZSF4-X.XX-F5PX

LENGTH (L)  
(SEE TABLE 1)

LENS COLOR  
(SEE TABLE 2)

IP RATING

IP OPTION	CODE
NONE	(BLANK)
IP54	54

## RECOMMENDED LENS MOUNTING HOLE

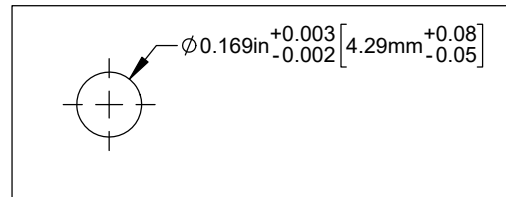

## RECOMMENDED ADAPTER MOUNTING HOLES

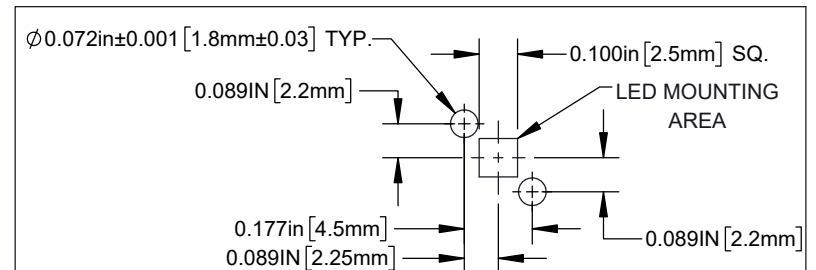

OPTIONAL IP54 SEALING GASKET APPLIED  
TO PANEL BEFORE INSERTING LENS  
CAP/FLP ASSEMBLY INTO PANEL

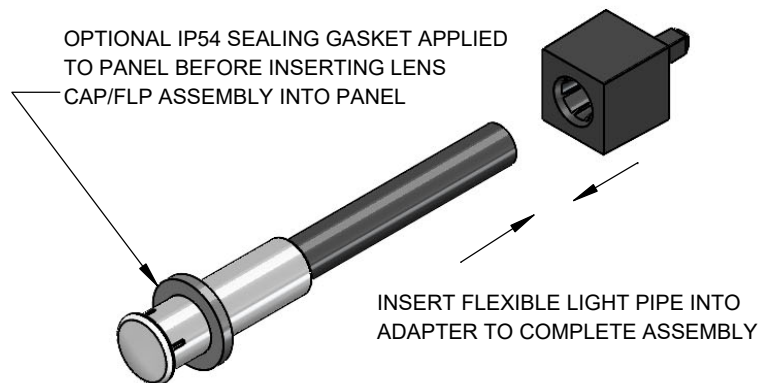

## CUSTOMER USE DRAWING

STANDARD TOLERANCE (UNLESS OTHERWISE SPECIFIED)		 4 THOMAS, IRVINE, CA. 92618 TEL: (949) 951-8808 FAX: (949) 951-3974	
DECIMALS	ANGULAR		
.X ± .1	X° ± 1°	TITLE: FLP ASSEMBLY WITH SMALL FOOTPRINT ADAPTER, LC2	
.XX ± .02		DRAWING NO: SZSF4-X.XX-F5PX	REVISION: B
.XXX ± .010		SHEET SIZE: A	CAGE CODE: 32559
DESIGNED: K. BARON	DATE: 2/27/2025	SCALE: 2:1	SHEET # 1 OF 2
REVISD: K. BARON	DATE: 6/17/2025	CAD GENERATED DOCUMENT, DO NOT MEASURE DRAWING	
CHECKED: D. ASHBY	DATE: 6/17/2025		

TABLE 1 - LENGTH	
LENGTH (L)*	TOLERANCE
1.00" - 16.00"	±0.05"
16.05" - 40.00"	±0.15"
40.05" - 80.00"	±0.30"
80.05" - 3,940.00"	±0.5%

\*AVAILABLE IN 0.05" INCREMENTS

TABLE 2 - LENS	
ORDER CODE	LENS APPEARANCE
(BLANK)	CLEAR
D	DIFFUSED

SAMPLE PART NUMBER:

SZSF4-11.20-F5PD54

11.20" LENGTH ———

DIFFUSED LENS ———

IP54 RATED SEALING GASKET INCLUDED

**ASSEMBLY INSTRUCTIONS TO ACHIEVE OPTIMUM FUNCTION OF SEALING GASKET:**

- CLEAN PANEL SURFACE AROUND MOUNTING HOLE WITH ALCOHOL
- PEEL LINER OFF TOP OF THE SEALING GASKET WHILE KEEPING SEALING GASKET ON PLASTIC ROLL
- APPLY SEALING GASKET TO PANEL HOLE AS CENTERED AS POSSIBLE AND PEEL PLASTIC LINER SLOWLY AWAY
- INSERT LIGHT PIPE INTO PANEL UNTIL SEALING GASKET MATERIAL IS COMPRESSED BETWEEN LENS AND PANEL
- HOLD FOR A FEW SECONDS TO ENSURE ENTIRE SEALING GASKET ADHERES TO PANEL AND LENS FLANGE SURFACE

**CUSTOMER USE DRAWING**

		<b>BIVAR</b> <sup>®</sup>	
CAGE CODE:	32559	DRAWING NO:	REVISION:
		SZSF4-X.XX-F5PX	B
SHEET SIZE:	A	SCALE: 2:1	SHEET # 2 OF 2
		CAD GENERATED DOCUMENT, DO NOT MEASURE DRAWING	