

PRODUCT NUMBER

71600-YXXLF

LEAD FREE, SEE NOTE 6

TOTAL NB OF POSITION 04 TO 64
SEE SHEET 2

OPTIONAL STRAIN RELIEF
SEE SHEET 2

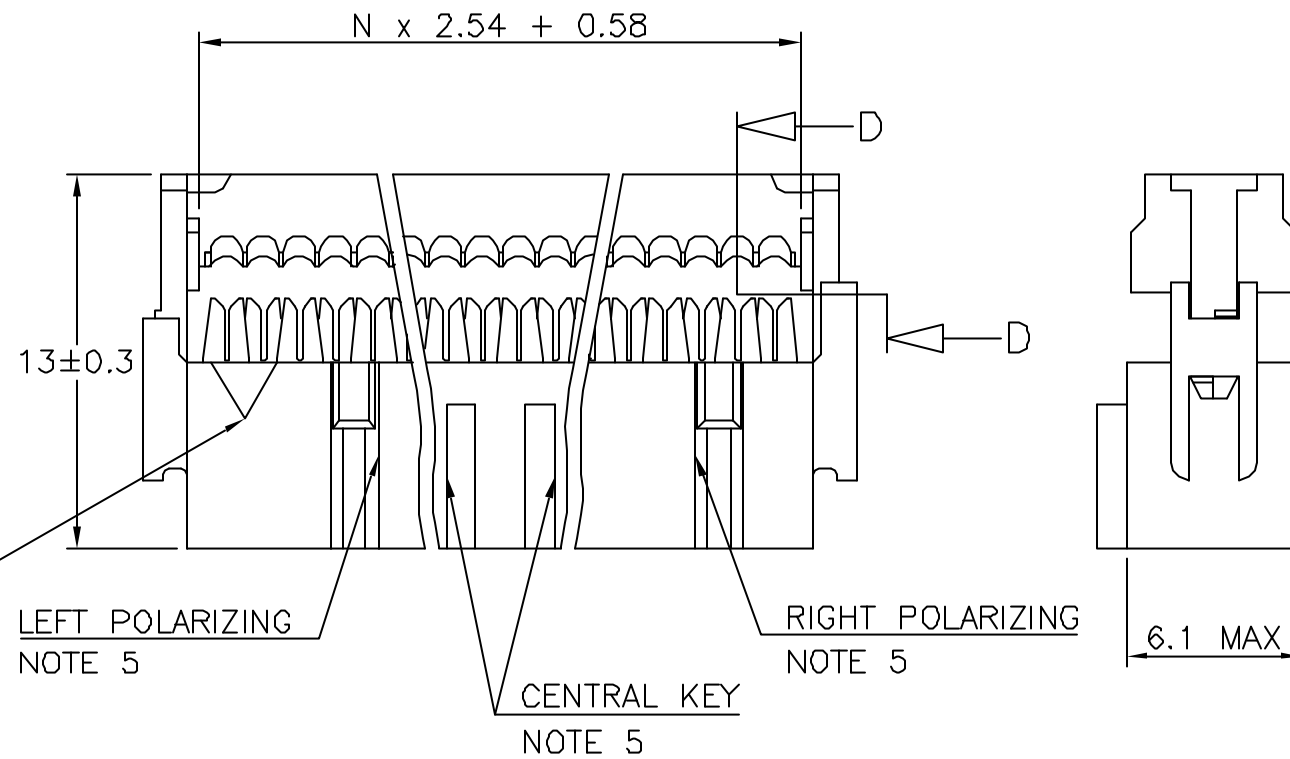

TRIANGLE INDICATES
POSITION 1
NOTE 5

LEFT POLARIZING
NOTE 5

RIGHT POLARIZING
NOTE 5

CENTRAL KEY
NOTE 5

NOTES:

- 1 - PLASTIC MAT'L : GLASS FILLED HIGH TEMPERATURE THERMOPLASTIC. UL94V-0 COLOR: GREY
- 2 - PIN MATERIAL : PHOSPHOR BRONZE
- 3 - PRODUCT PACKAGED IN TUBES.
- 4 - TO DETERMINE DIMENSIONS :
N = NUMBER OF POSITIONS
EXAMPLE : 8 POS $N \times 2.54 = 20.32\text{mm}$
- 5 - 2x5, 2x6, 2x7 HAVE NO LEFT POLARIZING SLOT.
- 2x2, 2x3 WITH CENTRAL KEY HAVE NO TRIANGLE, NO LEFT AND RIGHT POLARIZING SLOT.
- 2x2 WITHOUT CENTRAL KEY HAS NO LEFT AND RIGHT POLARIZING SLOT.
- 2x3, 2x4 WITHOUT CENTRAL KEY HAVE NO LEFT POLARIZING SLOT
- 2x4 WITH CENTRAL KEY HAVE NO LEFT AND RIGHT POLARIZING SLOT
- 6 - THIS PRODUCT MEETS EUROPEAN UNION DIRECTIVES AND OTHER COUNTRY REGULATIONS AS PER GS-22-008.
PACKAGING SPECIFICATION AS PER GS-14-920.

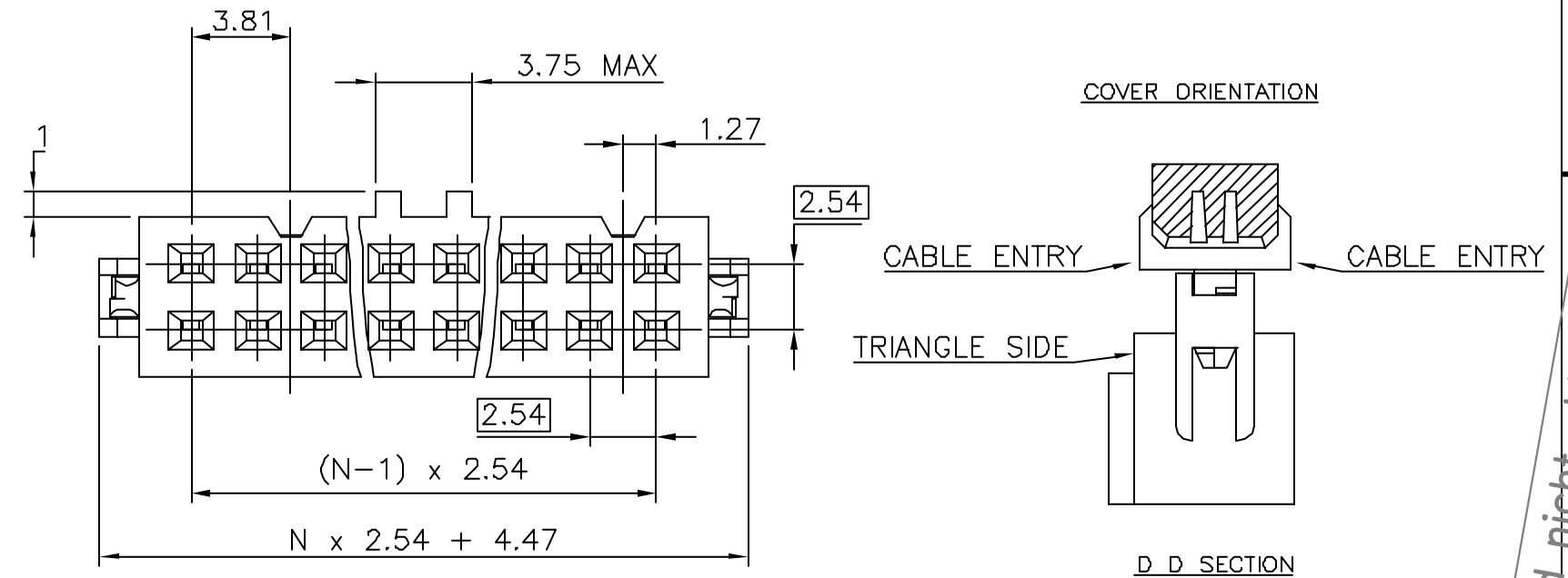

COVER ORIENTATION

CABLE ENTRY

CABLE ENTRY

TRIANGLE SIDE

D D SECTION

wird nicht aktualisiert

| | | | | | | | | | | | |
|-------------|----------------|-----|----------|----------|---------------------------------------|------------------|-------|------------|-----------------|----------------|------------------|
| mat'l. code | | | | surface | | tolerance | | projection | | product family | |
| SEE NOTES | | | | ISO 1302 | | ISO 406 ISO 1101 | | mm | | 2.54MM IDC | |
| Ltr | ecn | na | dr | date | tolerances unless otherwise specified | | mm | | title | | |
| AG | F04-0330 | LMU | 04.09.01 | | angles | Linear | X.X | ±0.3 | QUICKIE III FEM | | |
| AH | F05-0109 | JCO | 05.01.17 | | | | X.XX | ±0.13 | 0.76µm Au | | |
| AJ | F05-0171 | LMU | 05.04.07 | | | | X.XXX | ±0.05 | scale 5:1 | | |
| AK | F05-0180 | LMU | 05.04.22 | dr | D.LE | | | | dwg no | | sheet 1 of 2 |
| AL | F06-0270 | LMU | 06.09.12 | enrg | P.NZ | | | | 71600 | | A3 |
| AM | F06-0274 | LMU | 06.09.25 | chr | JF.N | | | | type | | CUSTOMER Drawing |
| | | | | appd | P.NZ | | | | | | |
| sheet index | revision sheet | AM | AE | 1 | 2 | | | | | | |

| CORE RANGE | |
|---|------------------|
| STRAIN RELIEF | Nbr OF POSITIONS |
| 0/1 | 04 |
| 0/1 | 06 |
| 0/1 | 08 |
| 0/1 | 10 |
| 0/1 | 14 |
| 0/1 | 16 |
| 0/1 | 18 |
| 0/1 | 20 |
| 0/1 | 24 |
| 0/1 | 26 |
| 0/1 | 30 |
| 0/1 | 34 |
| 0/1 | 40 |
| 0/1 | 50 |
| 0/1 | 60 |
| 0/1 | 64 |
| PLATING 0.76µm GOLD ON CONTACT AREA 1.27 µm Ni REMAINDER OF PRODUCT | |

| CATALOGUE RANGE | |
|---|------------------|
| STRAIN RELIEF | Nbr OF POSITIONS |
| 2/6 | 04 |
| 2/6 | 06 |
| 2/6 | 08 |
| 2/6 | 10 |
| 2/6 | 14 |
| 2/6 | 16 |
| 2/6 | 18 |
| 2/6 | 20 |
| 2/6 | 24 |
| 2/6 | 26 |
| 2/6 | 30 |
| 2/6 | 34 |
| 2/6 | 40 |
| 2/6 | 50 |
| 2/6 | 60 |
| 2/6 | 64 |
| PLATING 0.76µm GOLD ON CONTACT AREA 1.27 µm Ni REMAINDER OF PRODUCT | |

| |
|----------------------|
| 624 |
| 304 |
| 204 / 224 |
| 004 |
| DASHES NOT AVAILABLE |

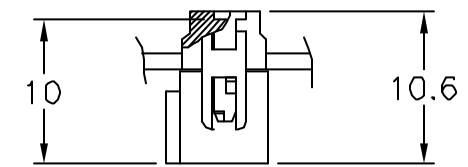

WITHOUT STRAIN RELIEF

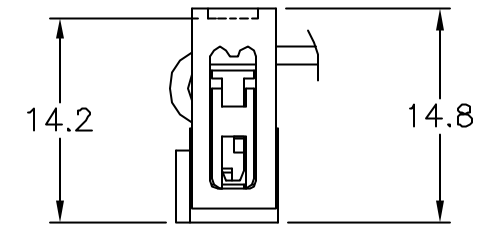

WITH LOW PROFILE STRAIN RELIEF

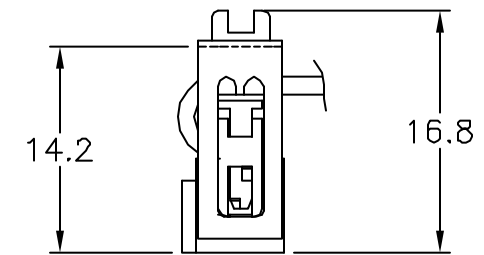

WITH STANDARD STRAIN RELIEF

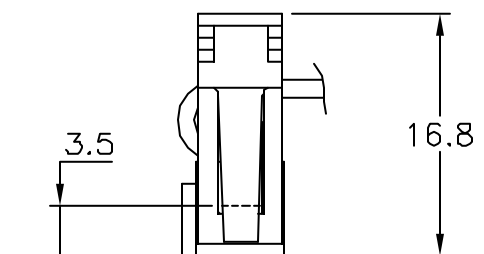

WITH LATCHING STRAIN RELIEF

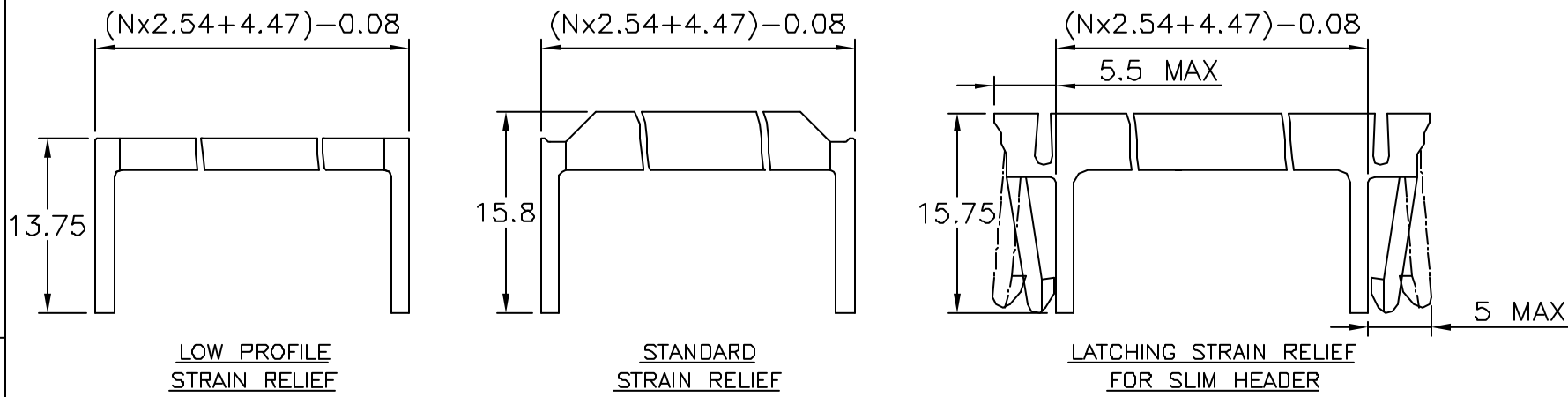

LOW PROFILE STRAIN RELIEF

STANDARD STRAIN RELIEF

LATCHING STRAIN RELIEF FOR SLIM HEADER

| | | | | | | |
|----------------|------------------|---------------------|------------------------|-----------------------|---------------------------|------------------------|
| 71600-6YYLF | ● | | | | | ● |
| 71600-3YYLF | | ● | ● | | | |
| 71600-2YYLF | ● | | | | ● | |
| 71600-1YYLF | ● | | | ● | | |
| 71600-0YYLF | ● | | ● | | | |
| PRODUCT NUMBER | WITH CENTRAL KEY | WITHOUT CENTRAL KEY | STANDARD STRAIN RELIEF | WITHOUT STRAIN RELIEF | LOW PROFILE STRAIN RELIEF | LATCHING STRAIN RELIEF |

| | | | | | | | | | |
|-------------|----------------|--------------------|----------|---------------------------------------|------|------------|--|-----------------------------------|--|
| mat'l. code | | surface ISO 1302 ✓ | | tolerance ISO 406 ISO 1101 | | projection | | product family QUICKIE | |
| ltr | ecn no | dr | date | tolerances unless otherwise specified | | mm | | title | |
| X | F70666 | AAN | 97.11.05 | angles Linear | | scale N/A | | IDC RECEIPT DR | |
| Y | F10121 | DLE | 01.01.24 | | | | | dwg no 71600 sheet 2 of - size A3 | |
| AA | F10199 | GCO | 01.04.26 | | | | | type CUSTOMER Drawing | |
| AB | F03019 | DLE | 03.01.23 | dr | D.LE | 01.01.24 | | | |
| AC | F05-0180 | LMU | 05.04.22 | engr | P.NZ | 01.01.24 | | | |
| AD | F06-0270 | LMU | 06.09.12 | chr | JF.N | 01.01.24 | | | |
| AE | F06-0274 | LMU | 06.09.25 | appd | P.NZ | 01.01.24 | | | |
| sheet index | revision sheet | | | | | | | | |

wird nicht aktualisiert



Copyright FCI