

NO OF PIN	A	B	ORDER CODE
02	1.00	4.30	M40-3010206
03	2.00	5.30	M40-3010306
04	3.00	6.30	M40-3010406
05	4.00	7.30	M40-3010506
06	5.00	8.30	M40-3010606
07	6.00	9.30	M40-3010706
08	7.00	10.30	M40-3010806
09	8.00	11.30	M40-3010906
10	9.00	12.30	M40-3011006
11	10.00	13.30	M40-3011106
12	11.00	14.30	M40-3011206
13	12.00	15.30	M40-3011306
14	13.00	16.30	M40-3011406
15	14.00	17.30	M40-3011506

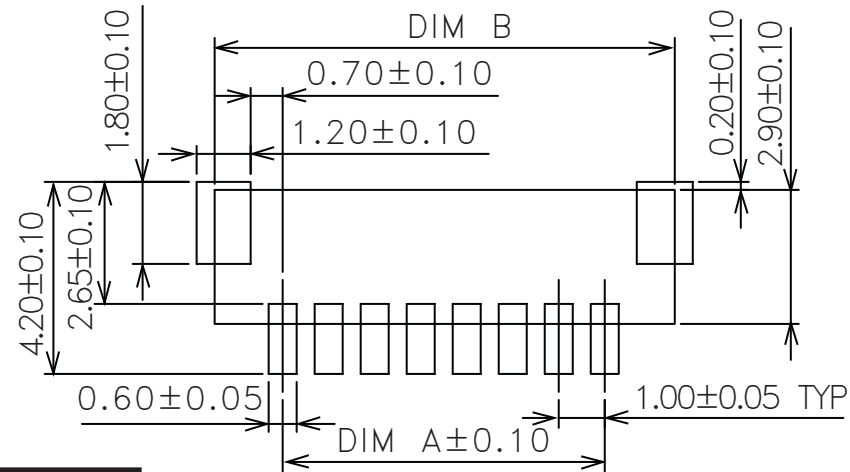

ORDER CODE
M40-301XX06

1	220202	-
ISS.	DATE	C/N
APPROVED: TED T		
CHECKED: MIKE M		
DRAWN:		
CUSTOMER REF:		
ASSEMBLY DRG:		

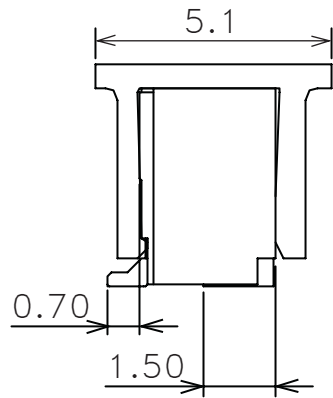

THIS INFORMATION AND ANY INFORMATION OR DESCRIPTIVE MATTER SET OUT HEREON ARE CONFIDENTIAL AND COPYRIGHT PROPERTY OF THE HARWIN GROUP AND MUST NOT BE DISCLOSED, LOANED, COPIED OR USED FOR MANUFACTURING, TENDERING OR FOR ANY OTHER PURPOSE WITHOUT THEIR WRITTEN PERMISSION.

TOLERANCES
X = ±1mm
XX = ±0.25mm
XXX = ±0.10mm
XXXX = ±0.01mm
ANGLES = °
UNLESS STATED

MATERIAL:
SEE ABOVE

TITLE:
CABLE TO BOARD HEADER
1.00mm TOP ENTRY SMT TYPE

HARWIN INC
U.S.A.
TEL: (812)542 2546
FAX: (812)542 2541

HARWIN PLC
U.K.
TEL: 023 9237 0451
FAX: 023 9231 4590

HARWIN PTE LTD
SINGAPORE
TEL: 65 6779 4909
FAX: 65 6779 3868

FINISH: SEE ABOVE

DRAWING NUMBER:

S/AREA: mm²

M40-301XX06

SHT
1
OF
1