

SECTION A-A
SCALE 10:1

- PARTS COMPLY TO AMP SOLDERABILITY SPECIFICATION 109-11-3.
- CONTACT IS PLATED OVERALL WITH 0.00127 [.000050] NICKEL, THEN 0.00076 [.000030] GOLD OVER CONTACT LENGTH INDICATED AND MATTE TIN ON SOLDER TAIL END.
- CIRCUIT IDENTIFICATION CHARACTERS ARE ADJACENT TO THE INDICATED CAVITIES, BUT LOCATION AND ORIENTATION MAY DIFFER FROM PRINT.
- DIMENSIONS IN BRACKETS ARE IN INCHES.

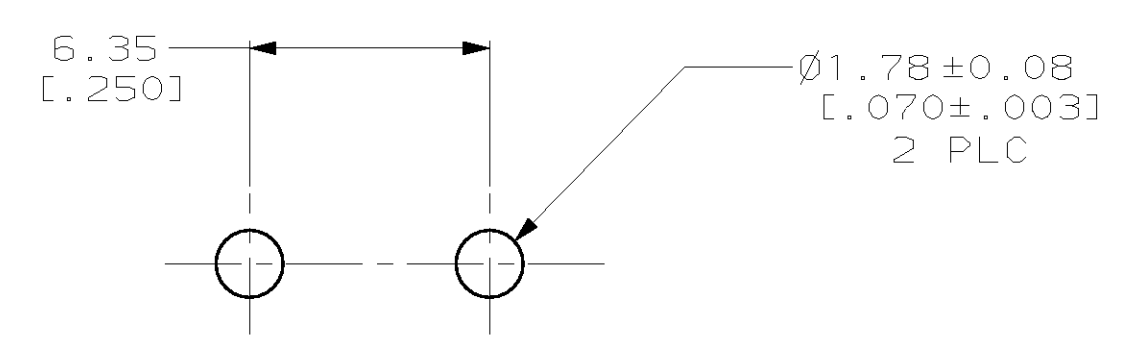
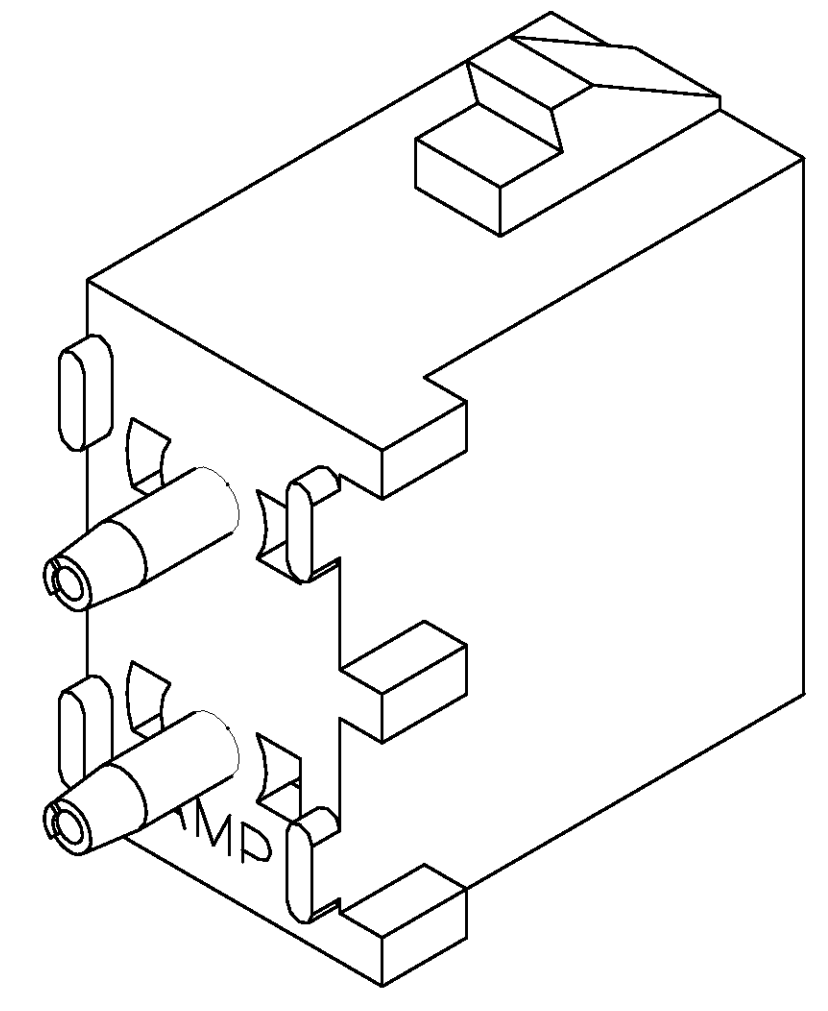

RECOMMENDED MOUNTING HOLE PATTERN FOR 1.57 [.062] THICK P.C. BOARD

| | | |
|---------------------------------|-------------------------|----------|
| PHOSPHOR BRONZE, GOLD Δ | NYLON, UL94V-2, NATURAL | 350428-2 |
| PHOSPHOR BRONZE, PRE-TIN | NYLON, UL94V-2, NATURAL | 350428-1 |
| PIN CONTACT MATERIAL AND FINISH | HOUSING MATERIAL | PART NO |

| | | | | |
|--|---------------|------------------|------------|------------------|
| THIS DRAWING IS A CONTROLLED DOCUMENT. | | DWN | J. HUFFMAN | 9-26-96 |
| DIMENSIONS: mm (INCHES) | | CHK | R. SWING | 9-26-96 |
| TOLERANCES UNLESS OTHERWISE SPECIFIED: | | APVD | M. TRULLI | 9-30-96 |
| Ø PLC | ± | DATE | | |
| PLC | ± | PRODUCT SPEC | | |
| PLC | ±0.13 (.0051) | APPLICATION SPEC | | |
| PLC | ± | SIZE | | |
| PLC | ± | CAGE CODE | | |
| ANGLES | ± | DRAWING NO | | |
| | ± | HEIGHT | | |
| MATERIAL | SEE TABLE | FINISH | SEE TABLE | CUSTOMER DRAWING |

| | |
|--|--------|
| AMP AMP Incorporated Harrisburg, PA 17105-3608 | |
| PIN HEADER ASSEMBLY, 2 CIRCUIT UNIVERSAL MATE-N-LOK™ | |
| SCALE | 5:1 |
| SHEET | 1 OF 1 |
| REV | W |

METRIC