

Basic series with elevated
switching distance
4 mm embeddable

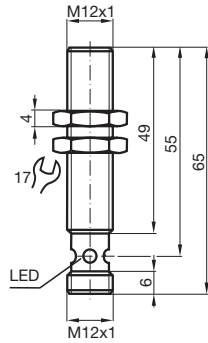

CE

Switching element function	NPN	Make function
Installation	embeddable	
Rated operating distance s_n	4 mm	
Assured operating distance s_a	0 ... 3.24 mm	
Reduction factor r_{V2A}	0.7	
Reduction factor r_{AI}	0.45	
Reduction factor r_{Ms}		
Reduction factor r_{Cu}	0.35	
Operating voltage U_B	10 ... 30 V	
Operating current I_L	0 ... 150 mA	
Switching frequency f	0 ... 1000 Hz	
No-load supply current I_0	≤ 15 mA	
Off-state current I_r	≤ 0.5 mA	
Voltage drop U_d	≤ 3 V	
Short circuit protection	pulsing	
Polarity reversal protected	yes	
Indication of the switching state	ring LED, yellow	
Ambient temperature	-25 ... 70 °C (248 ... 343 K)	
Protection degree	IP67	
Connection type	V1-connector	
Housing material	brass, nickel plated	
Sensing face	PBT	
Standard conformity	EN 60947-5-2	

www.pepperl-fuchs.com

PEPPERL+FUCHS GmbH

Connection

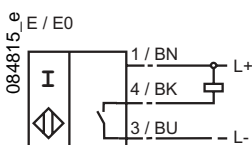

06.11.2001