

# Speakon®

## Loudspeaker Amplifier Connectors

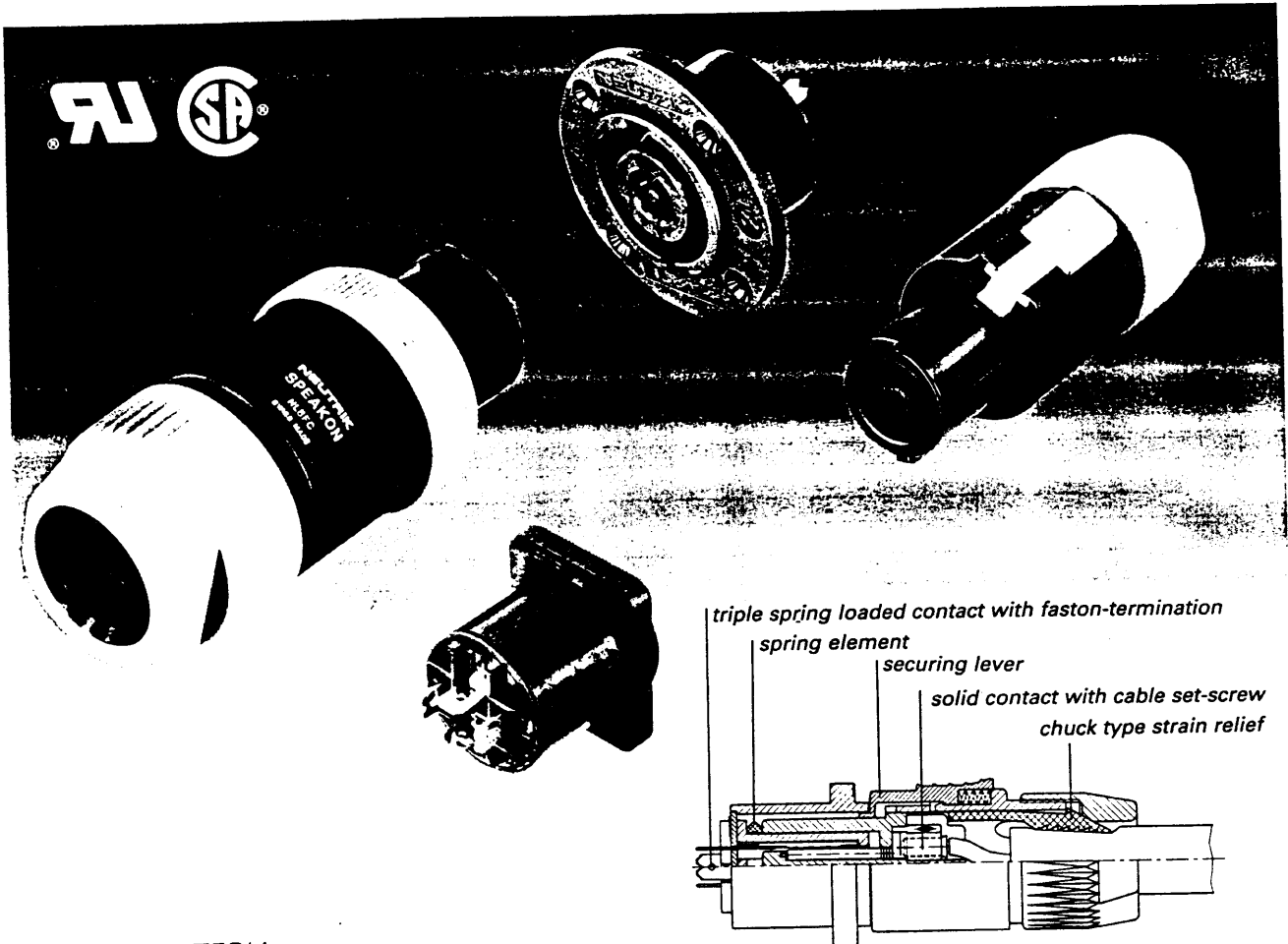

### DESIGN CRITERIA

- 4-pole version now available with new quicklock system: much easier handling of the release mechanism with a locking lever.
- Only 2 variations of the connector in 4-pole and 8-pole configuration for simplicity: cable version and a chassis-mount type
- All contacts on both connectors are touch proof, the connector meets the safety requirements of IEC 65, IEC 348, UL Recognized, CSA listed
- Terminations are solderless, making the connectors field serviceable, and the chassis types are fast and reliable to wire with Faston-terminations.
- Chassis connector for speakers is airtight and uses panel cutouts the same as existing audio connector types for flexibility and simplicity of metal/wood work tooling.
- Extremely robust, step-on proof, multiple contact finger for highest connecting integrity.
- Contacts are designed to prevent any damage (arcing) when disconnected under load.



# NEUTRIK

## CONNECTING THE WORLD

CONNECTORS  
AUDIO TEST SYSTEMS  
INFOMATIC SYSTEMS

## Dimensional Drawings

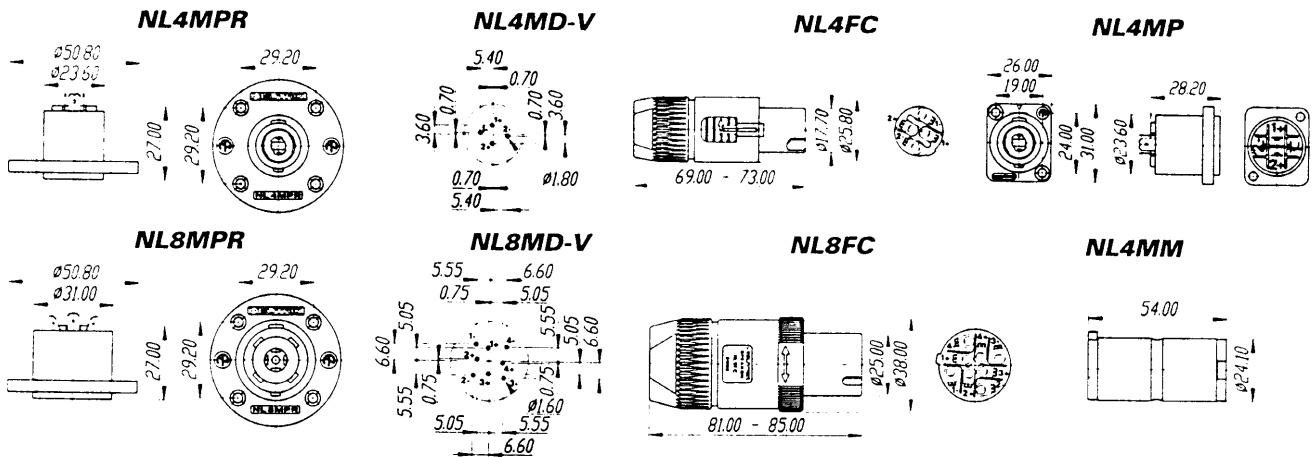

## Specification and Technical Data

### MATERIALS

**Contact:** Zn Al4 Cu1/Cu Sn8  
4 μm Ag plated  
**Securing lever:** Zn Al4 Cu1, Cu Ni plated  
**Spring element:** Neoprene ring  
**Housing:** PA 6.6 30% GR  
**Bushing:** PA 6.6 15% GR  
**Chuck:** POM

### MECHANICAL

**Retention method:** Locking with securing lever (4-pole) or securing ring (8-pole)  
**Cable anchoring:** NEUTRIK chuck principle  
**Cable OD range:** 6 – 15 mm (4-pole), 8 – 20 mm (8-pole)  
**Wiring:**  
• Cable: screws with protection cups or soldering.  
• Chassis: Faston 0.187" x 0.02" (4.8 mm x 0.5 mm) or PCB-versions: pin dimension: 1.6 mm x 0.5 mm  
**Max. wire size/contact:** 6 mm<sup>2</sup> (solid), 10 AWG; 4 mm<sup>2</sup> (stranded), 12 AWG  
**Cable retention force:** ≥ 220 N, depending on cable dia and material  
**Operating temperature:** -30°C to +80°C

### ELECTRICAL

**UL-, CSA-listed**  
**Rated current/contact:** 30 A rms continuous, 40 A rms 1 min.  
**Test voltage:** 4240 Vpp  
**Rated voltage:** 250 Vac  
**Contact resistance:** ≤ 3 mΩ after 5000 insertions  
**Insulation resistance:** after saltmist test IEC 68-2-11: > 10<sup>8</sup> Ω  
**Inrush/outrush current capability (12 V source):** 300/30 A/200 ms  
**Creepage distance:** according to IEC 664-1

## Wiring

Positive signal on speaker pin "+" produces positive waveform from driver (moves cone outwardly)  
"+" = In phase (high) "-" = Ground (out of phase low) Lower numbers for lower frequencies

	AMPLIFIER	CABLE	SPEAKER
<b>Stereo ("HiFi")</b>	one NL4MP socket left channel pins 1+/1- right channel pins 2+/2-	NL4FC on amplifier end, four conductor cable splits into two pairs with NL4FC on each end.	one NL4MP per speaker left speaker pins 1+/1- right speaker pins 2+/2-
<b>Power ("PA") Standard</b>	three NL4MP sockets "A" socket: left channel pins 1+/1- "B" socket: right channel pins 1+/1- "M" socket: left channel pins 1+/1- right channel pins 2+/2-	a two-conductor cable for each channel with NL4FC on both ends	NL4MP pin 1+ to speaker coil "+", NL4MP pins 1- and 2+ to speaker coil "-"
<b>Bridged mono</b>	"M" socket: left channel pins 1+/1- right channel pins 2+/2-	a special two-conductor cable, on both ends wired to pins 1+/2+ of NL4FC.	NL4MP pin 1+ to speaker coil "+", NL4MP pins 1- and 2+ to speaker coil "-"
<b>Bi - Amp</b>	one NL4MP socket low frequency pins 1+/1- high frequency pins 2+/2-	a four-conductor cable on both ends wired to pins 1+/1- 2+/2- of NL4FC	one NL4MP socket low frequency pins 1+/1- high frequency pins 2+/2-

## Ordering Information

- Cable connector, quick lock with securing lever
- Cable connector, twist lock with securing ring
- Chassis connector, air tight  
Neutrik D- and G-series compatible
- Direct on PCB-version, air tight
- Chassis connector, air tight, round flange,  
Cannon EP 13/14 compatible
- Coupler for linking (extending) cables

4-pole	8-pole
NL4FC	NL8FC
NL4MP	NL8MP
NL4MD-V	NL8MD-V
NL4MPR	NL8MPR
NL4MM	NL8MM



# NEUTRIK

**CONNECTING THE WORLD**

REPRESENTED AND SERVICED BY:

NEUTRIK AG  
Liechtenstein  
Tel 075 / 237 24 24  
Fax 075 / 232 53 93

NEUTRIK USA INC.,  
USA  
Tel 908 / 901 9488  
Fax 908 / 901 9608

NEUTRIK UK Ltd.  
United Kingdom  
Tel 0983 / 81 14 41  
Fax 0983 / 81 14 39

NEUTRIK Zürich AG  
Switzerland  
Tel 01 / 734 0400  
Fax 01 / 734 3891

Datas subject to change without prior notice

SPE/E - 1/95

## Dimensional Drawings

**NL4MPR**

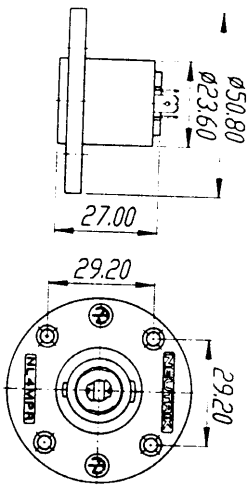

**NL8MPR**

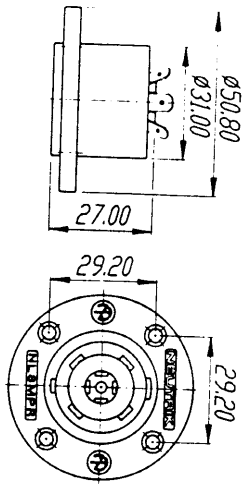

**NL4MD-V**

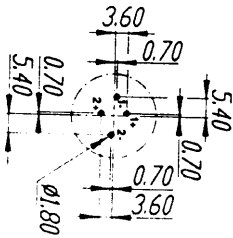

**NL8MD-V**

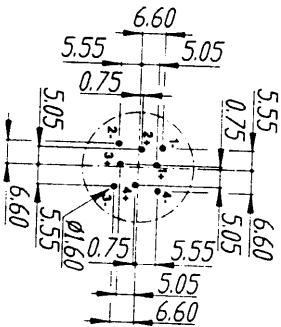

**NL4FC**

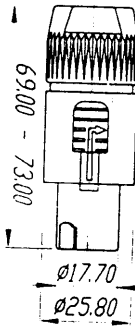

**NL8FC**

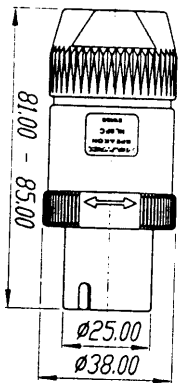

**NL4MP**

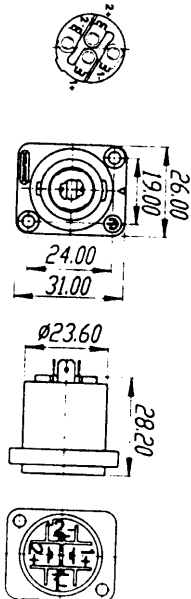

**NL4MM**

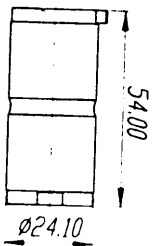

## Specification and Technical Data

### MATERIALS

**Contact:** Zn Al4 Cu1/Cu Sn8  
4 μm Ag plated  
**Securing lever:** Zn Al4 Cu1, Cu Ni plated

### MECHANICAL

**Retention method:** Locking with securing lever (4-pole) or securing ring (8-pole)  
**Cable anchoring:** NEUTRIK chuck principle

### ELECTRICAL

**UL-, CSA-listed**  
**Rated current/contact:** 30 A rms continuous, 40 A rms 1 min.  
**Test voltage:** 4240 V<sub>pn</sub>