



Eveready Battery Company, Inc.

533 Maryville University Drive
 St. Louis, MO 63141
 Telephone 1-800-383-7323
 Internet: www.energizer.com

Engineering Data

**Zinc Chloride 1.5V
 Super Heavy Duty**
 No Added Mercury or Cadmium

EVEREADY NO. 1250

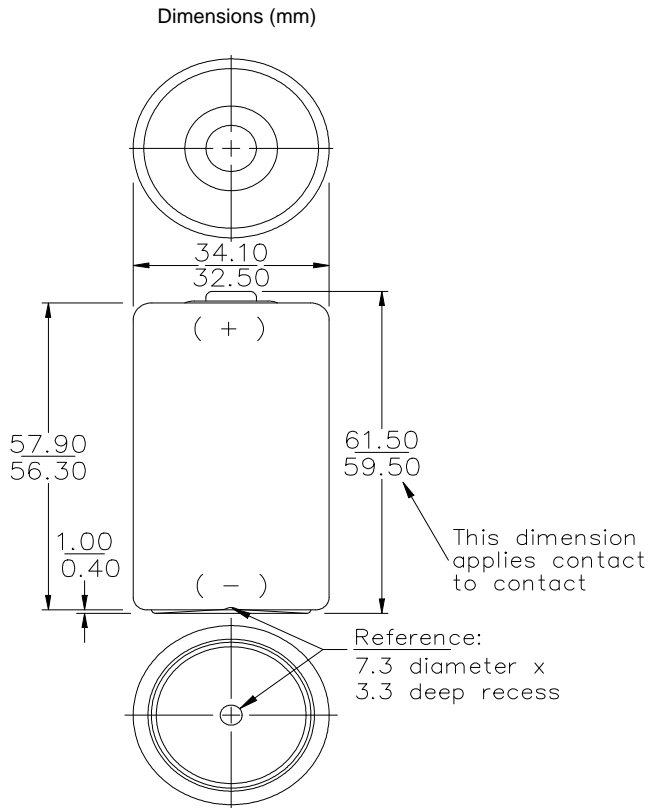

Chemical System: Zinc-Manganese Dioxide (Zn/MnO₂)

Designation: ANSI-13D, IEC-R20

Battery Voltage: 1.5 Volts

Average Weight: 89 grams (3.1 oz.)

Volume: 53 cubic centimeters (3.2 cubic inch)

Average Service capacity (to 0.8 Volts): 5900 mAh
 (Rated Capacity at 25 mA continuous drain)

Cell: One No. 50 (size "D")

Jacket: Metal

Millimeters	Inches
0.40	0.016
1.00	0.039
3.30	0.130
7.30	0.287
32.50	1.280
34.10	1.343
56.30	2.217
57.90	2.280
59.50	2.343
61.50	2.421

CONSTANT RESISTANCE PERFORMANCE
 Typical Service

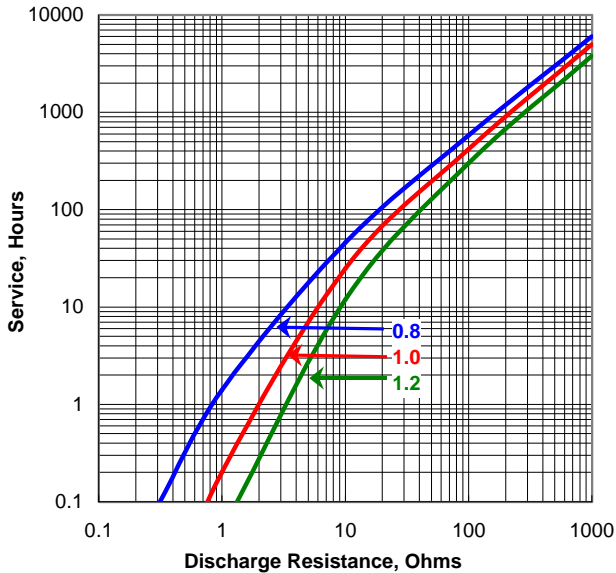

CONSTANT CURRENT DISCHARGE
 Typical Service

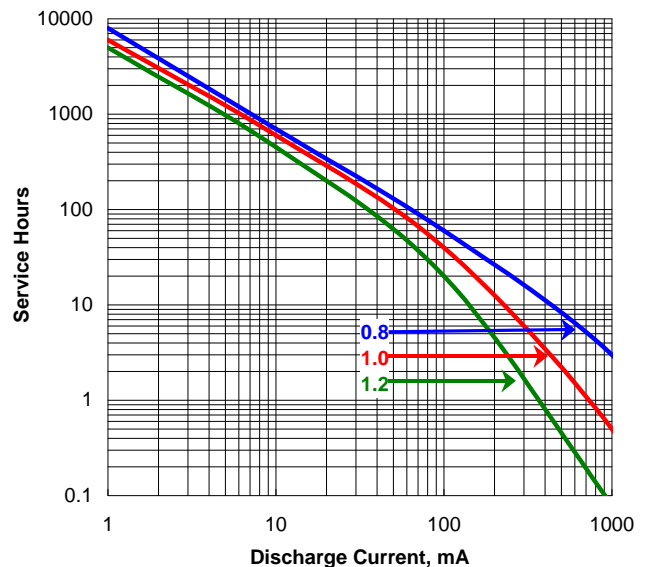

Typical Applications

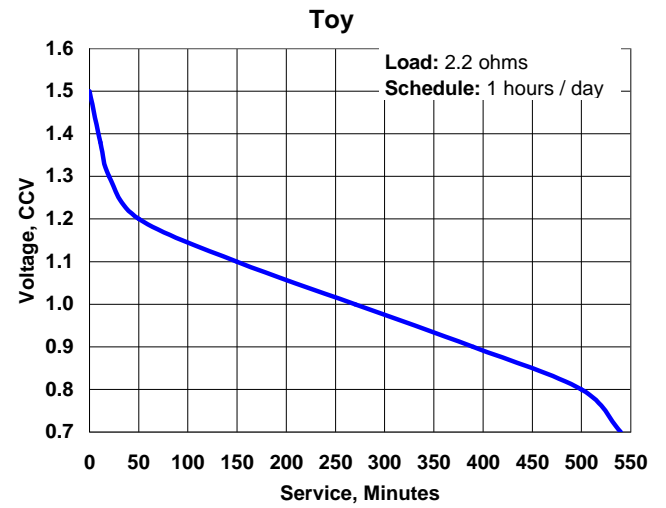
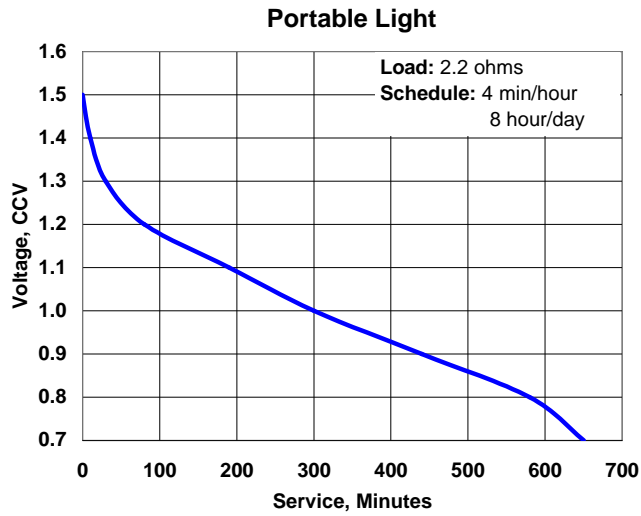
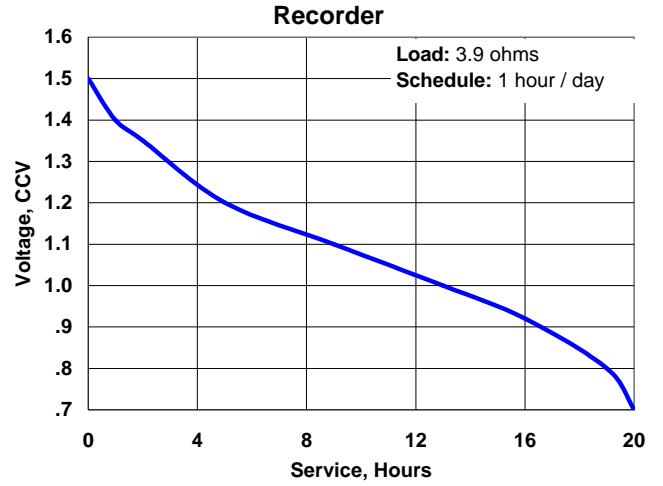
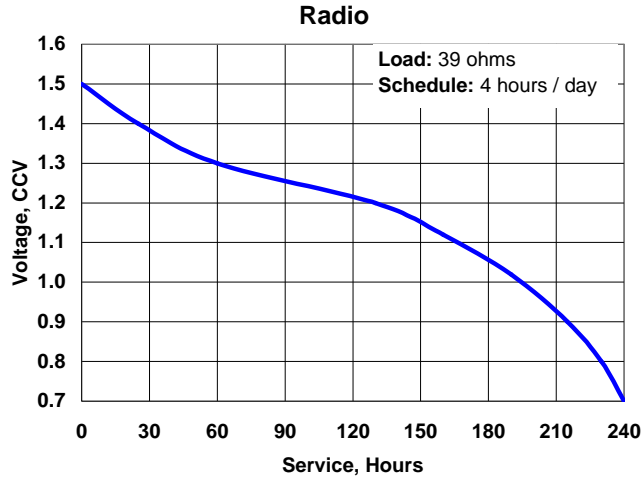

Important Notice

This data sheet contains information specific to batteries manufactured at time of its publication. Please contact your Energizer representative for most current information. Contents herein do not constitute a warranty.