



CML7001 Series Ordering Information

Part	Height	Base	Seq #
CML7001-	52	- 10	- 101
CML7001-	52	- 8	- 101
CML7001-	52	- 6	- 101

LED Heat Sink Specification



1. Material: Al 6063
2. Dimension:
Foot print: Ø70mm
3. Finish: Black Anodize

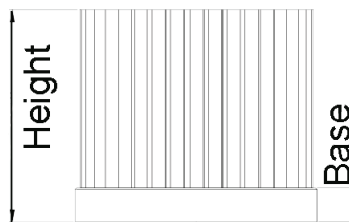
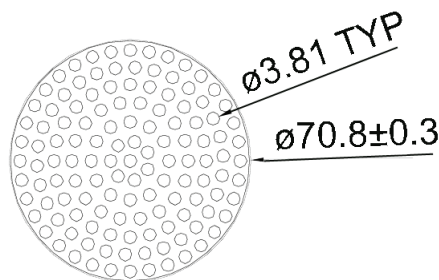

Performance

Heat Source (LxW)	37x37mm
-------------------	---------

Results Based On Natural Convection	
Height	oC/W
CML7001-52-10-101	3.7
CML7001-52-8-101	4.1
CML7001-52-6-101	4.5