

7.2 3M™ Couplings / Connectors / Pigtails



Description

3M SC-Connectivity

SC connectivity still is the master of choice for the majority of FTTH network concepts. The proven reliability and broad availability gives every network consultant the security and planning safety without any need for approval tests.

3M offers a variety of SC products, as SC/NPC connectors, SC pigtails, patch cords and couplings for PC and APC endface technology.

Ordering Information

3M SC Couplings / Pigtails



| | Ref. No. |
|---|----------------|
| <p>> SC Duplex Coupling, multimode Plastic housing, grey, mounting bracket included, PU: 60 pcs</p> | 6313 |
| <p>> SC Duplex Coupling, single-mode Plastic housing, blue, mounting bracket included, PU: 60 pcs</p> | 8313 |
| <p>> SC Coupling, multimode Simplex, grey, mounting springs included, PU: 60 pcs</p> | 6310 |
| <p>> SC Coupling, single-mode Simplex, blue, mounting springs included, PU: 60 pcs</p> | 8310-E |
| <p>> SC/APC Coupling, single-mode Simplex, green, mounting springs included, PU: 60 pcs</p> | 8310-GE |

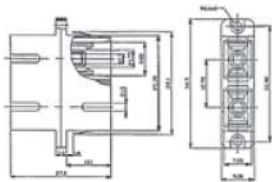

SC duplex coupling

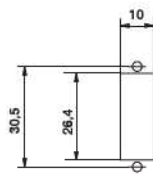

Hole pattern

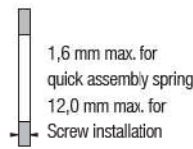

Sheet thickness

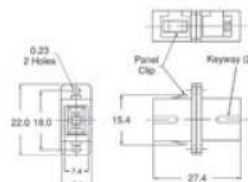

SC duplex coupling

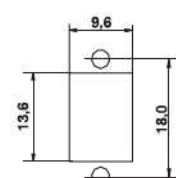

Hole pattern

| Coupling/Connector type | 6313 | 8313 | 6310 | 8310-E | 8310-GE |
|-------------------------|-----------------|------------------|------------------|------------------|------------------|
| Type | Multimode | Single-mode | Multimode | Single-mode | Single-mode |
| Simplex/Duplex | for duplex | for duplex | simplex | simplex | simplex |
| Sleeve | Phosphor bronze | Zirconia ceramic | Zirconia ceramic | Zirconia ceramic | Zirconia ceramic |
| Housing | Plastic, gray | Plastic, blue | Plastic, gray | Plastic, blue | Plastic, green |
| Operating temp. | -40°C to 75°C | -40°C to 85°C | -40°C to 85°C | -40°C to 85°C | -40°C to 85°C |