

## Variations

### Footprint Configuration

#### Four-Contact, Six-Position Unshielded

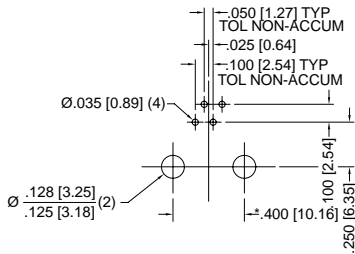

### Keying Options

#### K1-Key

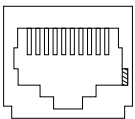

#### K2-Key

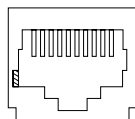

#### K3-Key

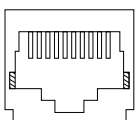

#### RMK-Key

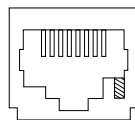

#### OST (MMJ)

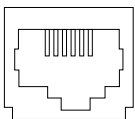

#### Cutout



### Flange Options

#### No Flange (NF)

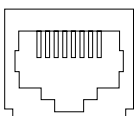

#### Panel Stop (FLS)

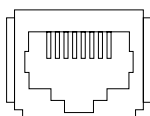

### Four-Contact, Four-Position Unshielded

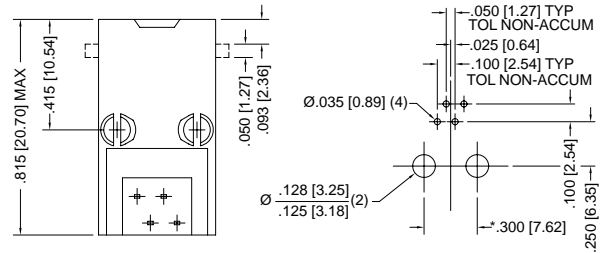
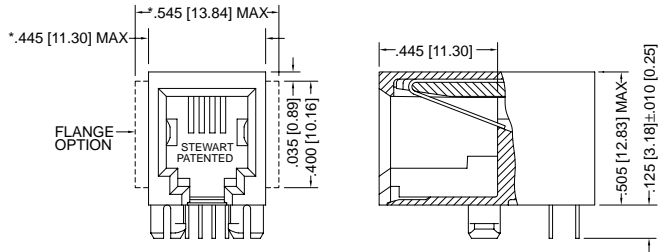

### Six-Contact, Six-Position Unshielded

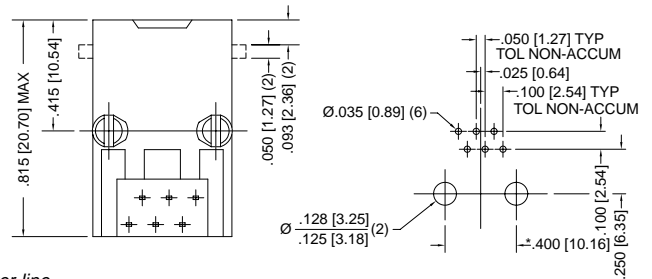
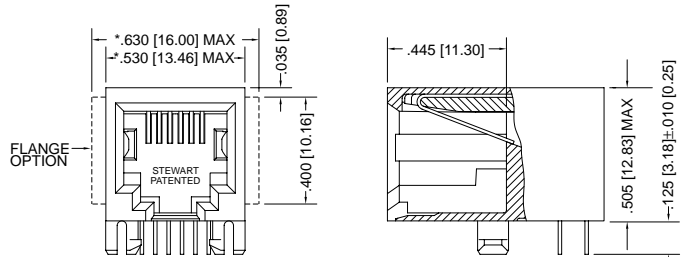

\*Dimension is central about center line.

## Quick Reference Chart

Description				Options						
	Series	Contacts Inserted	Contact Positions	Flange Options		Keying Options				
				FLS	NF	K1	K2	K3	RMK	OST (MMJ)
RJ-41 <sup>1</sup>	64	4	4	●	●					
	64	4	6	●	●					●
	64	6	6	●	●					●
RJ-45 <sup>1</sup>	64	4	8	●	●	●			●	
	64	6	8	●	●	●			●	
	64	8	8	●	●	●			●	
	64	08	10	●	●	●	●	●	●	●
64	10	10	●	●	●	●	●	●	●	

<sup>1</sup>Typical applications.

Note: Configurations shown are the most common for typical applications.

For availability of other configurations not listed, consult Stewart.

All dimensions are in inches with metric values in brackets.

# PC-Mount, Modular Jacks

• Unshielded • Low Profile

# 64 Series

## Variations

### Eight-Contact, Eight-Position Unshielded

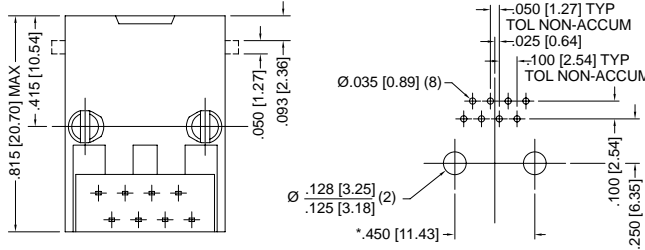
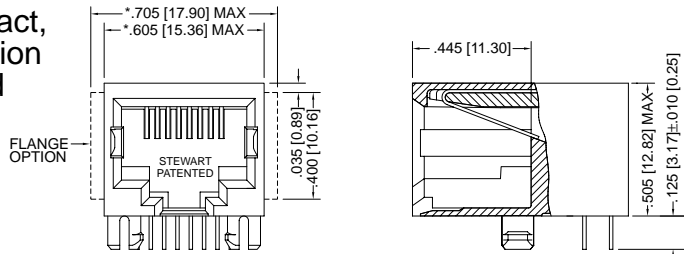

### Ten-Contact, Ten-Position Unshielded

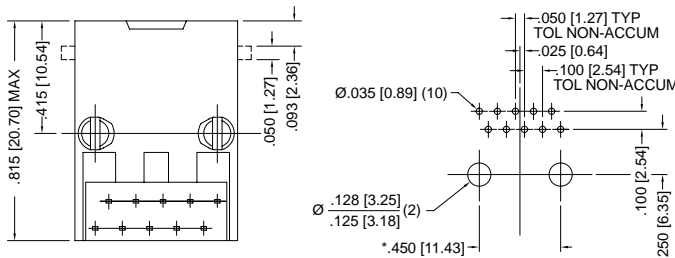
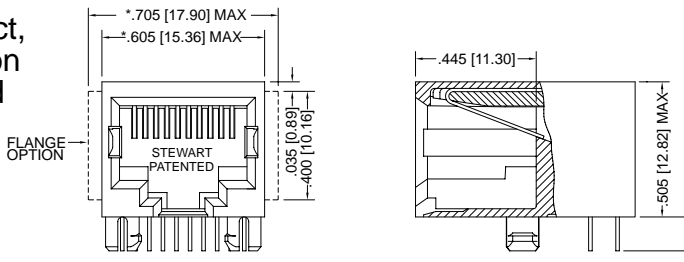

\*Dimension is central about center line.

## Footprint Configurations

### Four-Contact, Eight-Position Unshielded

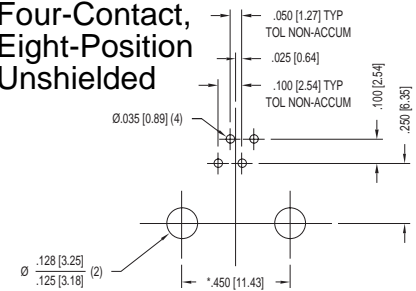

### Six-Contact, Eight-Position Unshielded

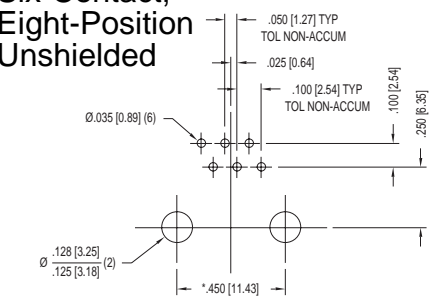

### Eight-Contact, Ten-Position Unshielded

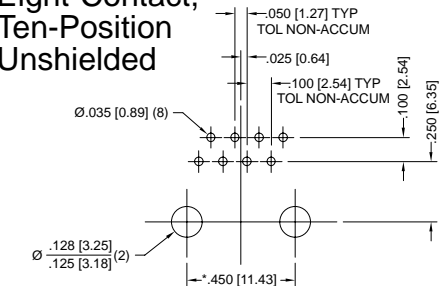

## Shorting Bars

### SB00

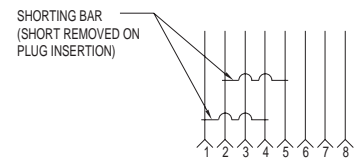

### SB02

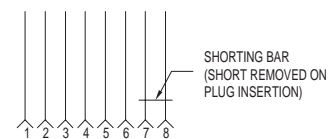

### SB04

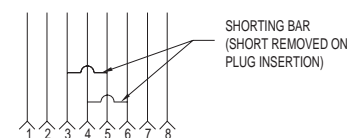

## How to Order

EXAMPLE: SS - 64 8 8 - FLS - K1 - 50 - X

Part prefix

Series number

Number of contacts inserted

- 4, 6, 8<sup>1</sup>, or 10

Number of contact positions

- 4, 6, 8, or 10

Flange options

- NF - No flange
- FLS - Panel stop

Other options (consult Stewart)

- SB00, SB02, SB04 - Shorting bars<sup>2</sup>

Plating options (microinches Au)

- Leave blank for 30
- 50

Keying options

- K1, K2, K3, RMK, OST (MMJ)

<sup>1</sup>Use 08 when referring to eight-contact, ten-position jacks.

<sup>2</sup>Available on eight-contact, eight-position jacks only.

All dimensions are in inches with metric values in brackets.