

RECOMMENDED PCB LAYOUT

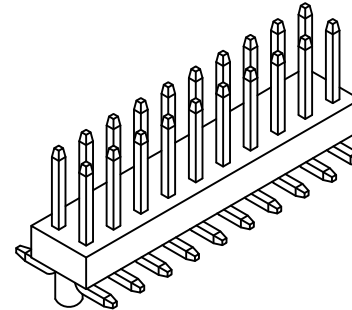

CONTACTS	DIMENSIONS		
	A	B	C
6	4.0	6.2	2.0
8	6.0	8.2	4.0
10	8.0	10.2	6.0
12	10.0	12.2	8.0
14	12.0	14.2	10.0
16	14.0	16.2	12.0
18	16.0	18.2	14.0
20	18.0	20.2	16.0
22	20.0	22.2	18.0
24	22.0	24.2	20.0
26	24.0	26.2	22.0
28	26.0	28.2	24.0
30	28.0	30.2	26.0
32	30.0	32.2	28.0
34	32.0	34.2	30.0
36	34.0	36.2	32.0
38	36.0	38.2	34.0
40	38.0	40.2	36.0
42	40.0	42.2	38.0
44	42.0	44.2	40.0
46	44.0	46.2	42.0
48	46.0	48.2	44.0
50	48.0	50.2	46.0

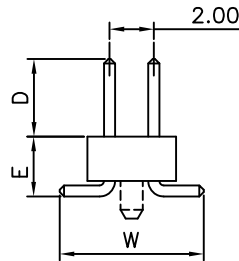
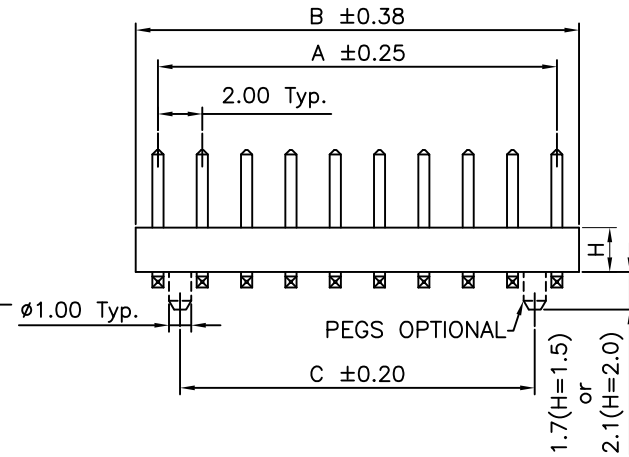

SPECIFICATIONS 规格
CURRENT RATING 电流额定值: 2 AMP
INSULATOR RESISTANCE 绝缘电阻值: 1000 MEGAOHMS MIN.
CONTACT RESISTANCE 接触电阻值: 20 mOHMS MAX.
DIELECTRIC WITHSTANDING 耐电压: AC 500 V
OPERATING TEMPERATURE 工作温度: -40°C TO +105°C
CONTACT MATERIAL 端子物料: COPPER ALLOY
INSULATOR MATERIAL 绝缘体物料:
STANDARD 标准物料: POLYAMIDE 聚酰胺, NYLON 6T, UL 94-V0
OPTIONS 可选物料: POLYESTER 聚酯, LCP, UL 94-V0
SOLDERING PROCESS 可焊性:
 NYLON 6T (STANDARD 标准物料) -
 IR REFLOW 回流焊: 260°C for 10 sec.
 WAVE 波峰焊: 230°C for 5-10 sec.
 MANUAL SOLDER 人工焊接: 350°C for 3-5 sec
 LCP (OPTION 可选物料) -
 IR REFLOW 回流焊: 260°C for 10 sec. **△**
 WAVE 波峰焊: 250°C for 5-10 sec.
 MANUAL SOLDER 人工焊接: 350°C for 3-5 sec. **△**

MATES WITH 配套之母座 (SUBJECT TO PIN LENGTH 在端子长度适合的条件下):
 BF065 BF075 BF080 BF095 BF100
 BF105 BF115 BF120

By	LYH	CB	DR	SA
DETAIL	DRAWING RELEASE	PACKING OPTIONS CHANGED	CHANGE TO SOLDER TEMP. INFORMATION	AMENDMENT TO STANDARD DIMENSIONS
REV	A	B	C	D
DATE	26/10/07	27/04/09	30/07/09	08/12/09

Ordering Grid: BF030-XXX-XX-XXXX-XXXX-XXXX-XX

REQUEST SAMPLES AND QUOTATION

- No. of Contacts: 06 to 50
- Contact Plating: A = Gold Flash All Over; B = Selective Gold Flash Contact Area/Tin On Tail; C = Tin All Over; G = 10µ" Gold Contact Area/Tin On Tail; I = 30µ" Gold Contact Area/Tin On Tail; **Standard = Gold Flash All Over**
- Locating Peg: 0 = No Peg; 1 = With Peg
- Insulator Height 'H': A = 1.50mm; B = 2.00mm; **Standard = 2.00mm**
- Dimension D (1/100mm) (Post Height): **Standard - 2.00mm = 0200**; **Standard - 4.00mm = 0400**; **Standard - 6.00mm = 0600**; Or specify Dimension D e.g. 2.50mm = 0250; TOL +/- 0.2mm
- Dimension E (1/100mm) (PCB to Top of Insulator): **'H' = 2.00mm: Standard - 2.77mm = 0277**; **'H' = 1.50mm: Standard - 2.20mm = 0220**; Or specify Dimension E e.g. 2.50mm = 0250; TOL +/- 0.2mm
- Dimension W (1/100mm) (Footprint Width): **'H' = 2.00mm: Standard - 6.00mm = 0600**; **'H' = 1.50mm: Standard - 5.50mm = 0550**; Or specify Dimension W e.g. 5.50mm = 0550; TOL +/- 0.2mm
- Insulator Material: N = Nylon 6T; **L = LCP (Standard)**
- Packing Options: **△** B = Tape & Reel with Cap (Standard); D = Tube; E = Tube with Cap



Tolerances (Except as noted)		Part Number:-	Date:-
Dimensions in mm		BF030	26 OCT 07
X: ±0.30	X': ±5°	Description:-	
XX ±0.20	X' ±2°	2.0mm PITCH PIN HEADER, DUAL ROW, SURFACE MOUNT	
XXX ±0.15	XX' ±1°	© THIS DRAWING IS CONFIDENTIAL AND MUST NOT BE COPIED OR DISCLOSED WITHOUT WRITTEN CONSENT	
XXXX ±0.10	XXX' ±0.5°	Third Angle Projection	

GCT

www.globalconnectortechology.com

Scale	Revision	Material	Drawn by	Sheet No.
NTS	D	See Note	LYH	E & OE 1/1