

Ring Terminal - non-insulated

Part No: 4S6R1

STUD SIZE #1/4

SYM.	CHANGES	BY	DATE

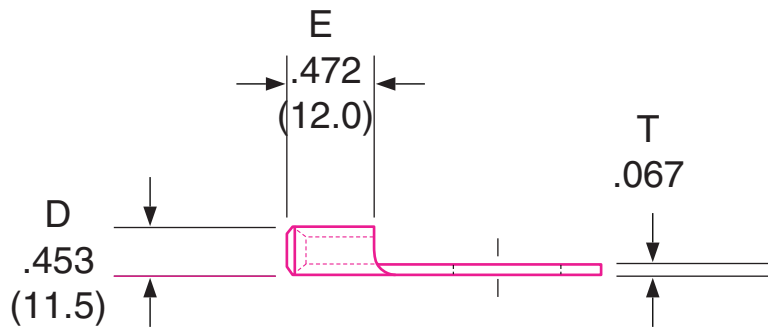
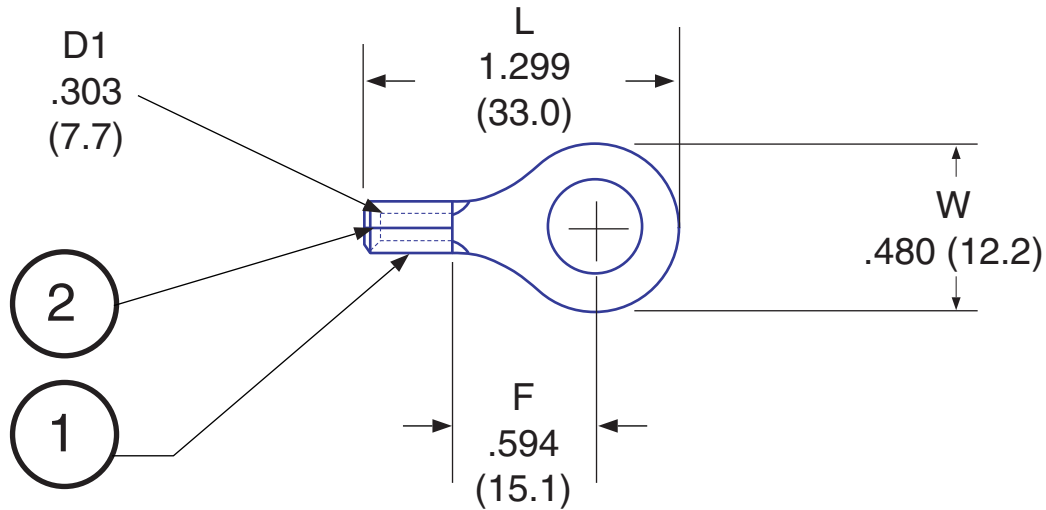

Max Electric Current: 4 AWG / 115 Amp
 Temperature Rating: 176° C
 Tolerance ±.020



HOFFMAN PRODUCTS

20700 Hubbell Avenue, Oak Park, MI 48237
 Tel: 1-800-645-2014 • Fax: 1-800-908-1295
 Web: www.hoffmanproducts.com

HOFFMAN CADFILE

NO.	1	2	3
NAME	TERMINAL	BRAZED SEAM	STUD SIZE
MAT'L.	COPPER		#1/4
REMARKS	TIN PLATED		
APPROVED BY:	CHECKED BY:	DRAWN BY:	

DATE:	TITLE: RING TERMINAL		
SCALE: FREE	PART NO. 4S6R1		
DRAWING NO. H90449	PART NAME	ISSUE	