

Anna-40-4 series



Ordering number C11793
Description C11793_Anna-40-4-S-OSL
 Family Anna-40-4 FWHM degrees
 Type Lens Efficiency -
 LED Oslon SSL 80 cd/lm -
 Color Transparent Gerber File Available
 Diameter 40 mm
 Height 10.7 mm
 Style Round
 Optic Material PMMA
 Holder Material -
 Fastening Glue, pin
 Status Ready



Ordering number C11794
Description C11794_Anna-40-4-M-OSL
 Family Anna-40-4 FWHM degrees
 Type Lens Efficiency -
 LED Oslon SSL 80 cd/lm -
 Color Transparent Gerber File Available
 Diameter 40 mm
 Height 10.7 mm
 Style Round
 Optic Material PMMA
 Holder Material -
 Fastening -
 Status Ready



Ordering number C11795
Description C11795_Anna-40-4-W-OSL
 Family Anna-40-4 FWHM degrees
 Type Lens Efficiency -
 LED Oslon SSL 80 cd/lm -
 Color Transparent Gerber File Available
 Diameter 40 mm
 Height 10.7 mm
 Style Round
 Optic Material PMMA
 Holder Material -
 Fastening -
 Status Ready

D

C

B

A

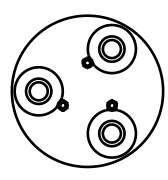

Anna-3

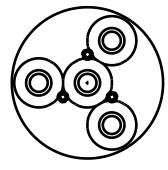

Anna-4

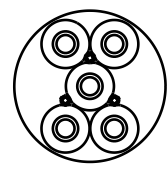

Anna-5

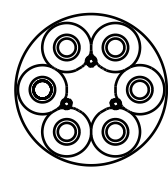

Anna-6

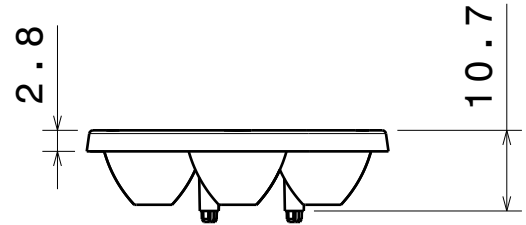

Anna-7

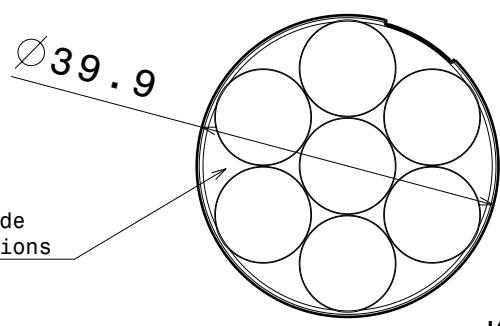

Same top side in all versions

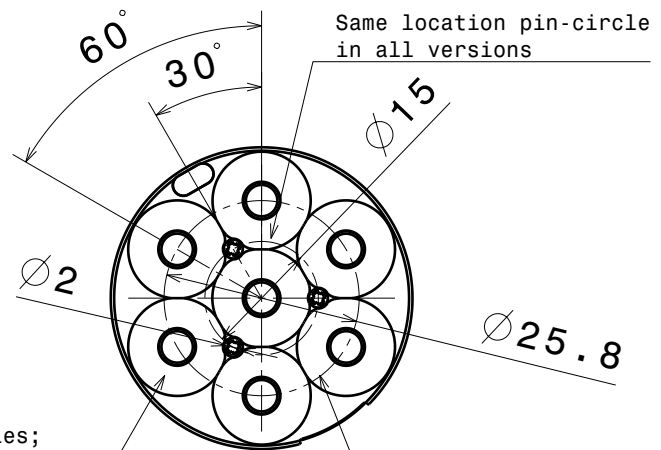
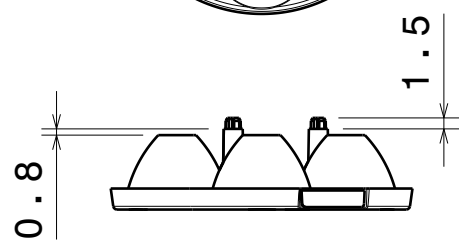

Same location pin-circle in all versions

Number of cones varies; 3, 4, 5, 6 and 7pcs on bottom side depending the version.

Same led-circle in all versions

Material: PMMA

- Versions:
- Anna-3-S
 - Anna-3-M
 - Anna-3-W
 - Anna-4-S
 - Anna-4-M
 - Anna-4-W
 - Anna-5-S
 - Anna-5-M
 - Anna-5-W
 - Anna-6-S
 - Anna-6-M
 - Anna-6-W
 - Anna-7-S
 - Anna-7-M
 - Anna-7-W

This drawing is our property. It can't be reproduced or communicated without our written agreement.



L T F e e i n

DRAWING TITLE

Datasheet Anna40-series Lens

DRAWN BY p DATE 12.10.2010

CHECKED BY s n DATE 12.10.2010

DESIGNED BY hh DATE 30.07.2010

SIZE A4 DRAWING NUMBER - REV 1

SCALE 1:1 WEIGHT (g) SHEET 1/1

D

A

4

4

3

3

2

2

1

1