

FLAT BASE

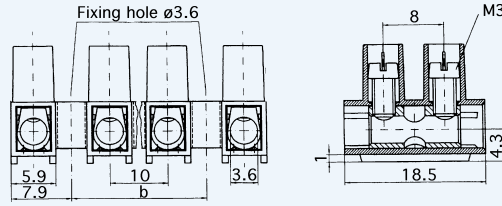

RAISED BASE

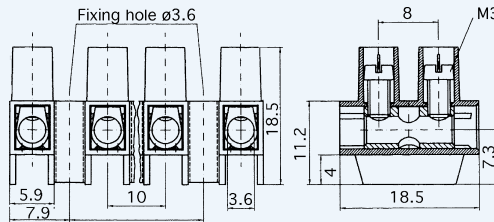

Length = number of poles x 10 less 3.4

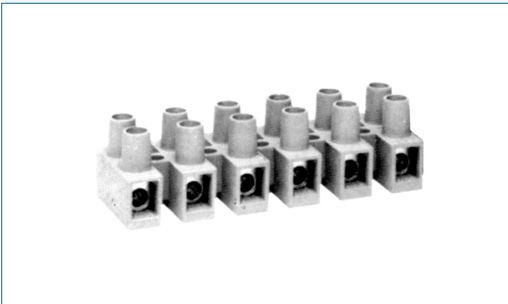

SECTION 1C

TERMINAL BLOCKS - STRIP TYPE

TECHNICAL DATA

Mouldings:	Nylon 6.6, white, UL94 V2
	Nylon 6.6, brown, UL94 V0
Inserts:	Brass, nickel plated
Screws:	M3, steel, zinc plated and passivated
Wire protectors:	Stainless steel
Maximum working temp:	Nylon 6 100°C
	Nylon 6.6 (T type) 160°C
Current rating:	10 amp - to EN60598 - 1
	18 amp - to EN60335
Voltage rating:	400V ~
Conductor size:	Without protector 6mm ²
	With protector 2.5mm ²

FEATURES

Series 400 terminal blocks are available in standard height and raised base (suffixed K) which are suitable for applications where creepage and clearance distances must be observed. They are also available in two grades of material, Nylon 6 or Nylon 6.6 which is suitable for high temperature applications. Supplied with and without wire protectors, with captive screws fitted as standard.

OPTIONS

Marking: special printing available. Please provide sketch.

Cut lengths: standard 12 pole lengths can be cut to shorter lengths.

APPROVALS

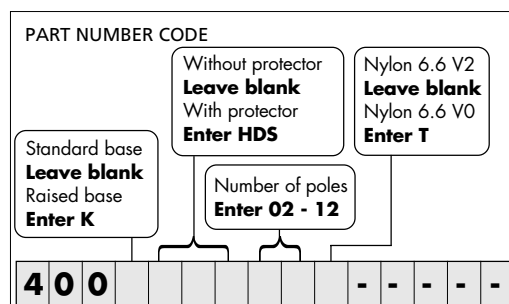

01273 431600



01273 439288



sales@metway.co.uk