

WIRING DIAGRAM

Hall Vcc	Hall A	Hall B	Hall C	GND	Phase A	Phase B	Phase C
RED/WHT	BLUE	GREEN	WHITE	BLK/WHT	YELLOW	RED	BLACK

UL 1007 / 22AWG

- ALL MATERIALS MUST BE ROHS COMPLIANT
- ROHS C.O.C. REQUIRED FOR EACH SHIPMENT

REVISION HISTORY

ECN	REV	DATE	DESCRIPTION	INIT
19009	A	10-21-2009	ORIGINAL	HP

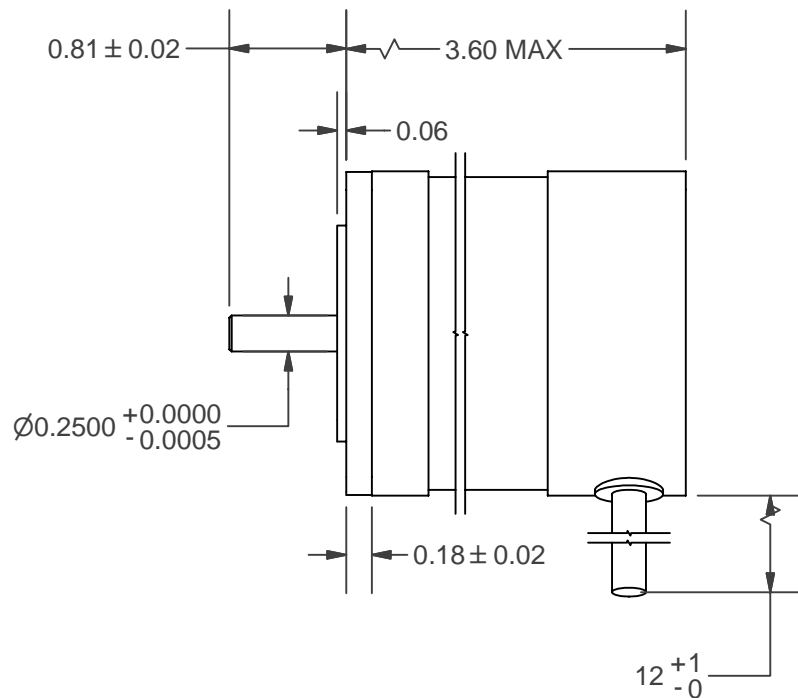
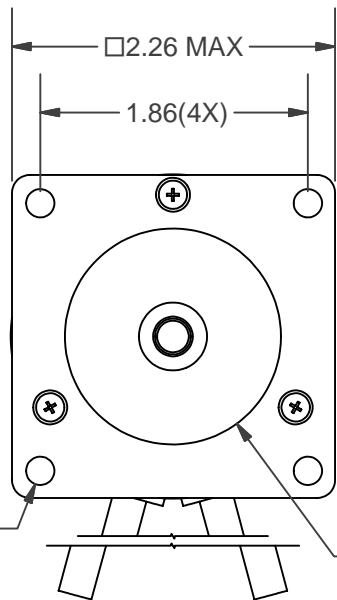

NUMBER OF ROTOR POLES	4
RATED VOLTAGE	36 V
LINE TO LINE RESIST.	(0.50) Ohm
LINE TO LINE INDUCT.	1.15 mH
RATED TORQUE	67.5 oz-in
RATED SPEED	4000 RPM
TORQUE CONSTANT	9.24 oz-in/A
INSULATION CLASS	B

UNLESS OTHERWISE SPECIFIED DEBURR ALL EDGES 0.005" MAX

TITLE

BLDC MOTOR OUTLINE

DO NOT SCALE DRAWING

Ⓞ IDENTIFIES FEATURE(S) THAT REQUIRE SPECIAL QUALITY ATTENTION

MOTOR NUMBER

BL24B36-02-RO



Unless Otherwise Specified
Dimensions Are In:
Inches [mm]
Tolerances Are:

APPROVALS

DATE

DRWN: HungPham

10/21/2009

MATERIAL

CHKD:

APRV:

SIZE

A

DRAWING NO. 001-07703

SCALE

0.75 : 1

SHEET

1 OF 1

1990 Russell Ave - Santa Clara, CA 95054

Phone: (408) 919-0200 - Fax: (408) 919-0201

www.linengineering.com