

1

2

3

4

5

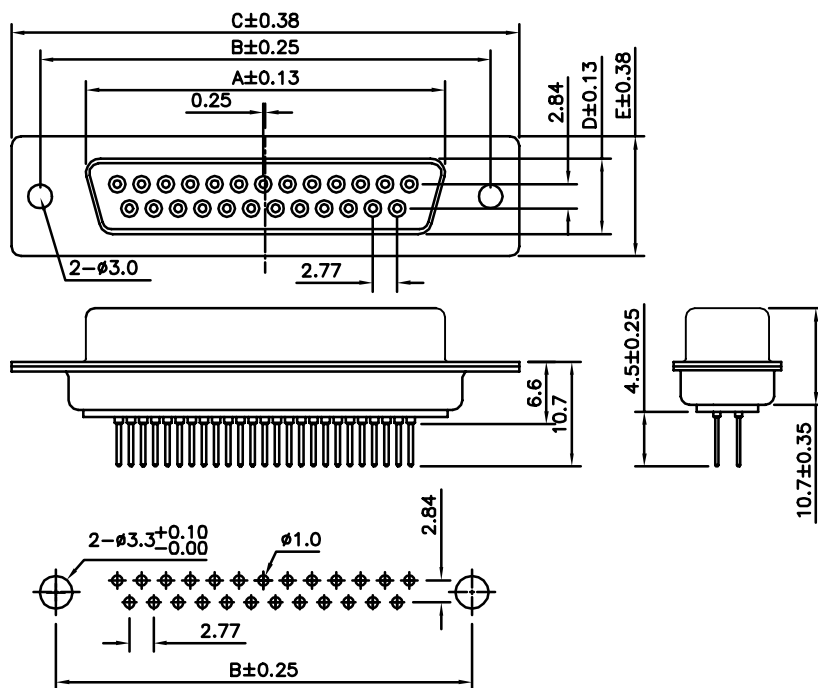

## TECHNICAL CHARACTERISTICS

MATERIAL  
 INSULATOR: PBT  
 MAX TEMPERATURE: 220°C 10 S  
 COLOR: WHITE  
 CONTACT MATERIAL: COPPER ALLOY  
 CONTACT TYPE: STAMPED  
 CONTACT PLATING: GOLD  
 SHIELDING: STEEL TIN PLATED  
 QUALITY CLASS: 3 AS PER IEC60 603-13

ENVIRONMENTAL  
 OPERATING TEMPERATURE: -40 UP TO 85°C  
 FLAMABILITY RATING: UL94-V0  
 COMPLIANCE: LEAD FREE AND ROHS

ELECTRICAL  
 CURRENT RATING: 3A  
 WORKING VOLTAGE: 250V AC  
 INSULATOR RESISTANCE: >5000 MOHM  
 DIELECTRIC WITHSTANDING VOLTAGE: 1000V AC/MN  
 CONTACT RESISTANCE: 300 mOHM MAX

SOLDERING  
 SOLDER TEMP.: JEDEC LEAD FREE WAVE SOLDERING

PACKAGING  
 TRAY

## DIMENSION

PINS □	A □	B □	C □	D □	E □
9	16.33	24.99	30.81	7.90	12.50
15	24.66	33.32	39.14	7.90	12.50
25	38.38	47.04	53.04	7.90	12.50
37	54.84	63.50	69.32	7.90	12.50

RoHS Compliant

PROJECTION:

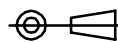

GENERAL TOLERANCE

.X = <sup>+/-</sup> 0.2.XX = <sup>+/-</sup> 0.15

APPROVAL: RJ

UNIT: MM

SCALE:

SHEET: 1/1

DRAW: PEARL

DESCRIPTION: FEMALE PCB CONNECTOR

WERI PART NO: 6180 xx 25123

SIZE

**A4**

REV	DATE	FILE	BY
G			
F			
E			
D			
C □	21-FEB-07 □	DRAW □	EC
B □	30-MAR-04 □	LEAD FREE □	JP
A □	14-JUN-99 □	PDF □ □	JP