

1

2

3

4

5

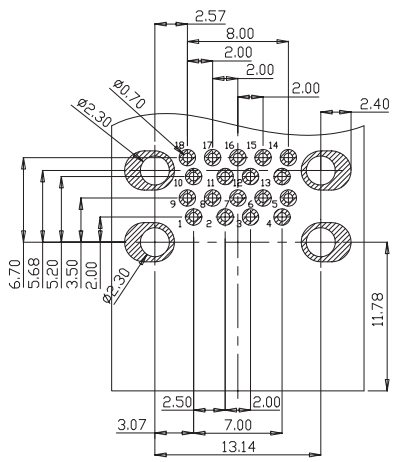
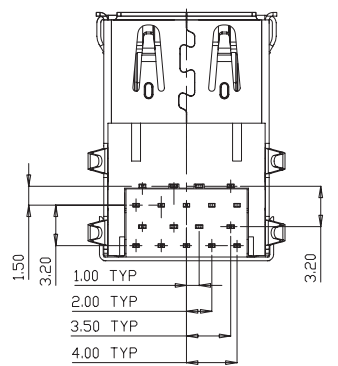
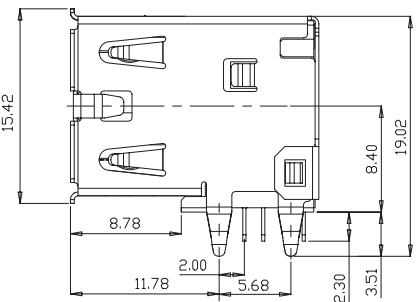
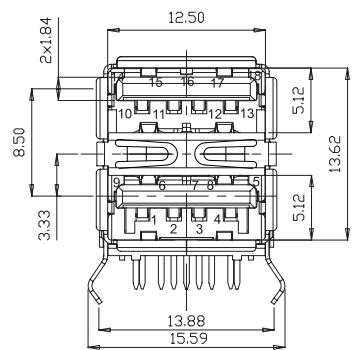
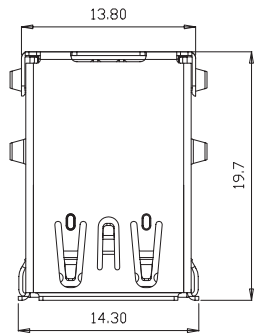

PCB LAYOUT - COMPONENT VIEW

TECHNICAL CHARACTERISTICS

MATERIAL  
 INSULATOR: LCP  
 FLAMABILITY RATING: UL94-V0  
 COLOR: BLUE  
 CONTACT MATERIAL: PHOSPHORE BRONZE  
 CONTACT TYPE: STAMPED  
 CONTACT PLATING: UNDERPLATE 1.27 to 2.54 µm Ni  
 CONTACT AREA 0.76 µm Gold  
 SOLDER TAIL AREA 2.54 to 5.08 µm Matt Tin  
 SHIELDING: BRASS MATT TIN PLATED

ENVIRONMENTAL  
 OPERATING TEMPERATURE: -20 up to +85°C  
 COMPLIANCE: RoHS & LEAD FREE AS PER DIRECTIVE 2002/95/EC  
 HALOGEN FREE COMPLIANT AS PER IEC 61249-2-21

ELECTRICAL  
 CURRENT RATING:  
 - PIN 1 & PIN 4 (Vbus & corresponding ground PIN) 1.8A Max  
 - OTHER PINS 0.25 A min  
 WORKING VOLTAGE: 30Vac  
 DIELECTRIC WITHSTANDING VOLTAGE: 100Vac/min  
 INSULATION RESISTANCE: > 100MΩ  
 CONTACT RESISTANCE:  
 - PIN 1 & PIN 4: 30mΩ Max  
 - OTHER PINS: 50mΩ Max  
 IMPEDANCE: 90Ω +/- 15Ω @ 50ps RISE TIME (20~80%)

STANDARD  
 CERTIFIED: E323964 / MODEL NUMBER 692141030100

MECHANICAL  
 INSERTION FORCE: 35.0N Max  
 EXTRACTION FORCE: 10.0N min  
 QUALITY CLASS: 5000 MATING CYCLES

SOLDERING  
 WAVE & REFLOW PROCESS AS PER JEDEC J-STD-020D

PACKAGING  
 TRAY

RoHS Compliant			
G			
F			
E			
D			
C			
B	10-MAY-11	UL	GG
A	04-AUG-10	PDF	JP
REV	DATE	FILE	BY

PROJECTION:

APPROVAL: RJ

GENERAL TOLERANCE  
 .X = +/- 0.2  
 .XX = +/- 0.15

UNIT: MM  
 SCALE:  
 SHEET: 1/2  
 DRAW: JOE

DESCRIPTION: USB 3.0 STACKED TYPE A

WERI PART NO: 692 141 030 100

SIZE  
**A4**

A

B

C

D

1

2

3

4

5

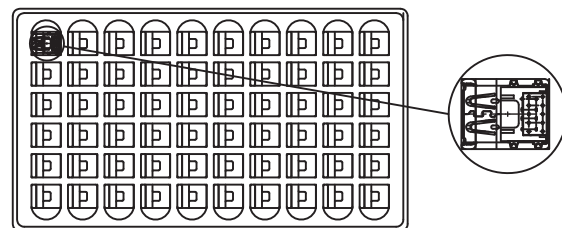
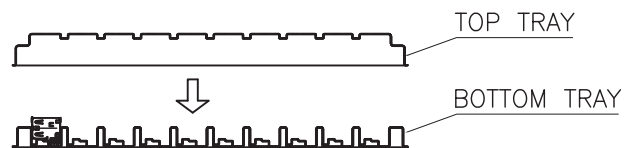

60PCS/TRAY.26TRAY/CARTON  
(1560PCS/CARTON)

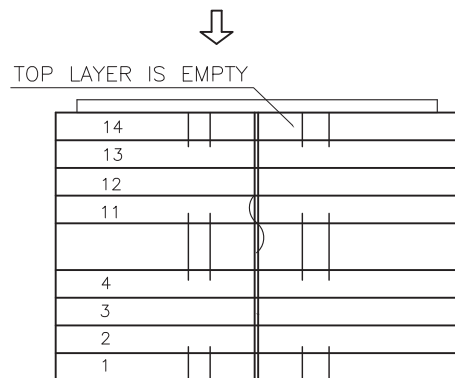

13 TRAY 780 PCS

NOTES

1. MATERIALS: PVC
2. PACKING:60PCS/TRAY,1560PCS/CARTON

All Material in According With The Rohs Environment  
Related Substances List Controlled.

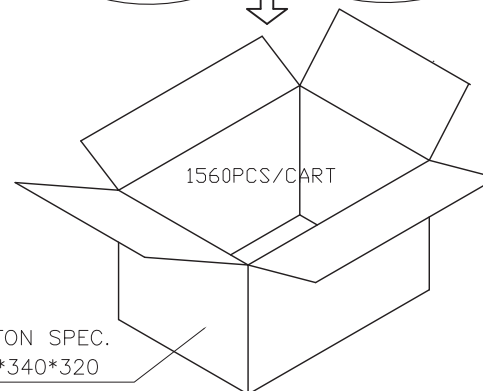
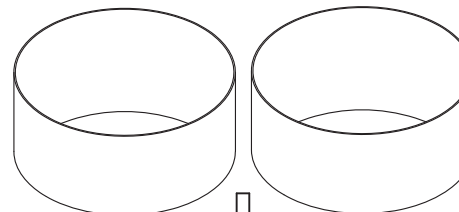
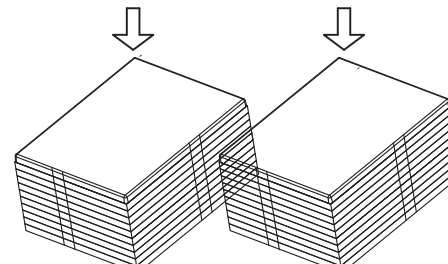
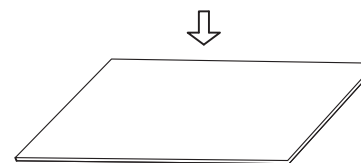

CARTON SPEC.  
350\*340\*320

RoHS Compliant

PROJECTION:

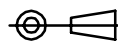

GENERAL TOLERANCE

.X =  $\pm$  0.2

.XX =  $\pm$  0.15



APPROVAL: RJ

UNIT: MM

DESCRIPTION: USB 3.0 STACKED TYPE A

SIZE

SCALE:

SHEET: 1/2

WERI PART NO: 692 141 030 100

**A4**

DRAW: JOE

G			
F			
E			
D			
C			
B			
A	02-APR-10	PROVISOIRE SHEET	JP
REV	DATE	FILE	BY