

FEMALE FACE VIEW

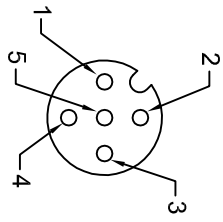

- 1 - BROWN
- 2 - WHITE
- 3 - BLUE
- 4 - BLACK
- 5 - NOT USED

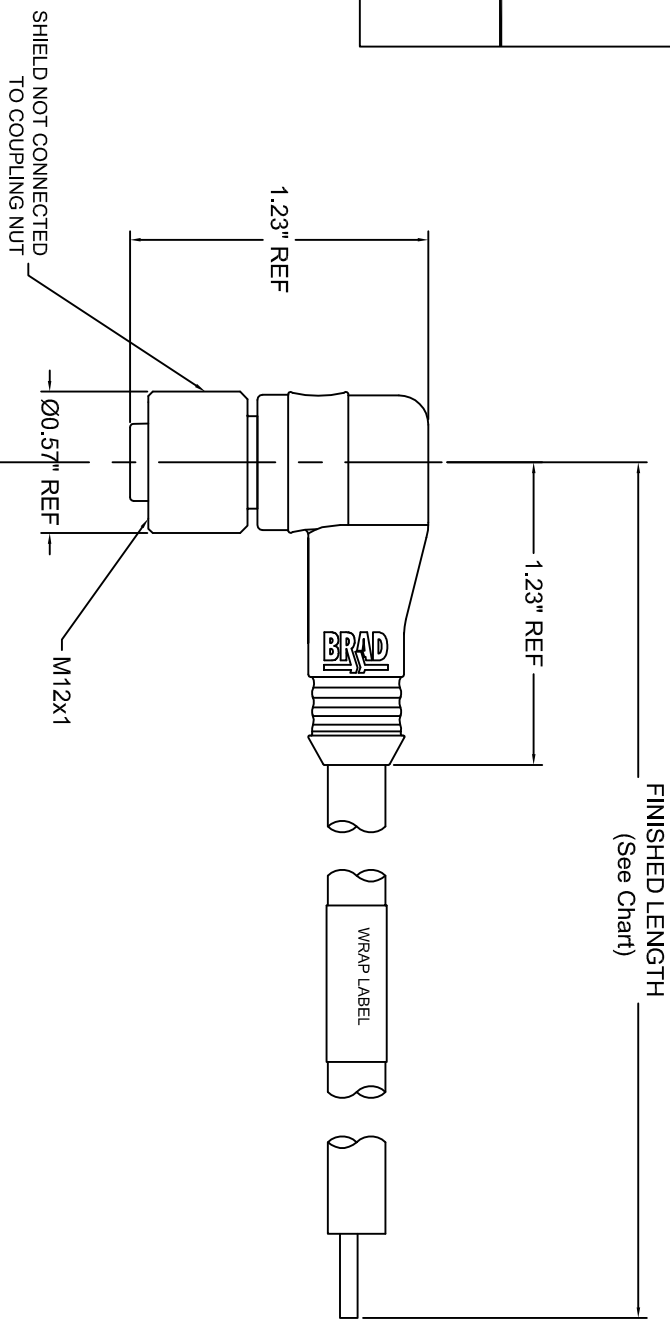

FINISHED LENGTH
(See Chart)

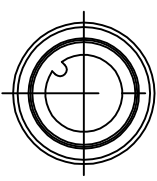

REFERENCE
USE ONLY

MATERIAL #	ENGINEERING #	LENGTH
1200651576	804001A15M020	2.0M (+88.9mm / -0)
1200651578	804001A15M040	4.0M (+165.1mm / -0)
1200651580	804001A15M050	5.0M (+165.1mm / -0)
1200651581	804001A15M060	6.0M (+165.1mm / -0)
1200651583	804001A15M100	10.0M (317.5mm / -0)

GENERAL TOLERANCES
(UNLESS SPECIFIED)

	MM	INCH
4 PLACES		
3 PLACES		
2 PLACES		
1 PLACE		

DIMENSION STYLE

DRAWN BY	DATE	TITLE	SCALE	DESIGN UNITS	THIRD ANGLE PROJECTION
RB		BRAD CONNECTIVITY MICRO-CHANGE M12 4-POLE FEMALE 90			
CHECKED BY	DATE				
APPROVED BY	DATE				

SPECS:
 OVERMOLD: YELLOW PUR
 INSERT: BLACK PUR
 CONTACTS: COPPER ALLOY, GOLD OVER NICKEL
 COUPLING NUT: NICKEL PLATED BRASS
 CABLE: #22-4 YELLOW PVC w/ FOIL SHIELD & DRAIN WIRE
 ELECTRICAL: 250V AC/DC, 4A

REV	DESCRIPTION	MATERIAL NO.	DOCUMENT	SHEET NO.
	DRAFT WHERE APPLICABLE MUST REMAIN WITHIN DIMENSIONS	SEE CHART	804001A15MXXX	1 OF 1
		SIZE		
		THIS DRAWING CONTAINS INFORMATION THAT IS PROPRIETARY TO MOLEX INCORPORATED AND SHOULD NOT BE USED WITHOUT WRITTEN PERMISSION		

