



TYPE - CFS90IP68



Contact your local Sales Representative
[Click Here for Printable Version](#)

Cat #	US Trade Size	MM	NW	NPT Thread Size	Threaded Unit Pack	Fittings Part #	Standard Carton	Part #
CFS-140A	1/4"	10	7	PG-7	1	90821	-	-
CFS-516A	5/16"	12	10	PG-9	1	90823	-	-
CFS-20	3/8"	16	12	1/2" NPT	25	90901	100	90902
CFS-21	1/2"	20	17	1/2" NPT	25	90911	100	90912
CFS-22	3/4"	25	23	3/4" NPT	10	90921	50	90922
CFS-23	1"	32	29	1" NPT	10	90931	30	90932
CFS-24	1-1/4"	40	36	1-1/4" NPT	5	90941	20	90942
CFS-25	1-1/2"	50	48	1-1/2" NPT	2	90951	10	90952

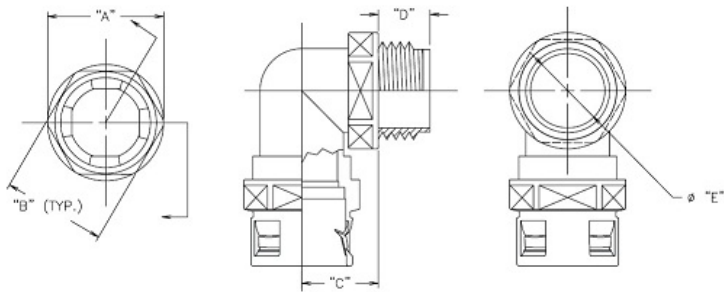

Cat #	U.S. Trade Size	Thread Size	A	B	C	D	E
CF-140A	1/4"	PG-7					
CF-516A	5/16"	PG-9	.775	.735	.665	.360	.410
CF-20	3/8"	1/2" NPT	.920	.820	.750	.480	.560
CF-21	1/2"	1/2" NPT	1.160	1.085	.800	.510	.650
CF-22	3/4"	3/4" NPT	1.525	1.140	.970	.600	.820
CF-23	1"	1" NPT	1.730	1.570	1.180	.570	1.030
CF-24	1-1/4"	1-1/4" NPT	2.085	1.965	1.600	.690	1.390
CF-25	1-1/2"	1-1/2" NPT	2.680	2.575	1.940	.710	1.475

TYPE - CFS90IP68

IP 68 is the equivalent to NEMA 6 and can withstand water from entering during submersion

Plastic Used: NYLON [See the Chemical Resistance Guide](#)

High Mech. Strength	Listed For Direct Burial	Halogen Free	Low Fire Hazard	Accepts Standard Liquidtight Fittings	Self Extinguish	EMI/RFI Shielding	Oil Resistance	Acid Resistance