

# Silicon Power Transistor



## Features:

- Darlington complementary
- High DC current gain at  $I_C = 10\text{ A}$ :  $h_{FE} = 4,000$
- Collector - emitter sustaining voltage  $V_{CEO(sus)} = 100\text{ V}$ (Minimum)
- Monolithic construction with built-in base - emitter shunt resistor

## Application:

Designed for use general-purpose amplifier and low -frequency switching applications

### TO-3

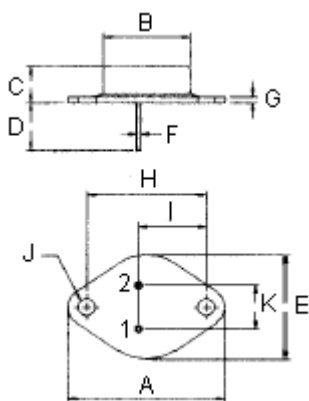

- Pin**
1. Base
  2. Emitter
  3. Collector (Case)

Dimension	Millimetres	
	Minimum	Maximum
A	38.75	39.96
B	19.28	22.23
C	7.96	9.28
D	11.18	12.19
E	25.2	26.67
F	0.92	1.09
G	1.38	1.62
H	29.9	30.4
I	16.64	17.3
J	3.88	4.36
K	10.67	11.18

Dimensions : Millimetres

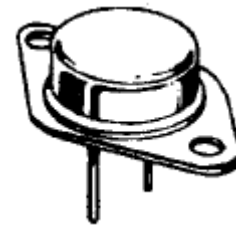

**TO-3**  
**Darlington**  
**20 Amperes**  
**Complementary Silicon**  
**Power Transistor**

## Maximum Ratings

Characteristic	Symbol	2N6287	Unit
Collector - emitter voltage	$V_{CEO}$	100	V
Emitter - base voltage	$V_{CBO}$	100	V
Collector - emitter voltage	$V_{EBO}$	5	V
Collector current - continuous - Peak	$I_C$	20 40	A
Base current	$I_B$	0.5	A
Total power dissipation at $T_C = 25^\circ\text{C}$ Derate above $25^\circ\text{C}$	$P_D$	160 0.915	W W/ $^\circ\text{C}$
Operating and storage junction temperature range	$T_J, T_{STG}$	-65 to +200	$^\circ\text{C}$

# Silicon Power Transistor

## Thermal Characteristics

Characteristic	Symbol	Maximum	Unit
Thermal resistance junction to case	$R_{\theta jc}$	1.09	$^{\circ}C/W$

Figure-1 Power Derating

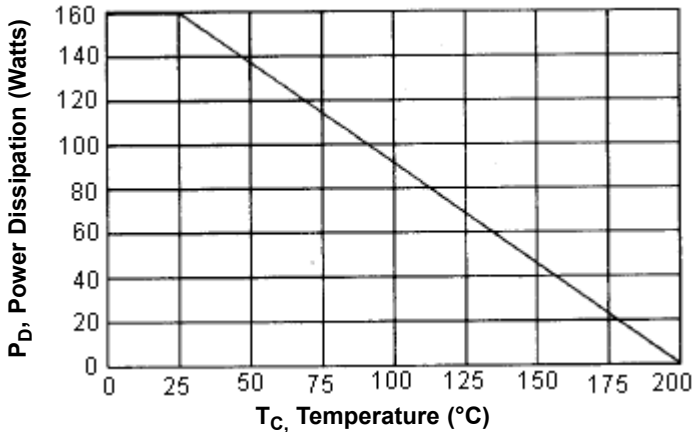

## Electrical Characteristics ( $T_C = 25^{\circ}C$ Unless Otherwise Noted)

Characteristic	Symbol	Minimum	Maximum	Unit
<b>OFF Characteristics</b>				
Collector - emitter sustaining voltage (1) ( $I_C = 100$ mA, $I_B = 0$ )	$V_{CEO (SUS)}$	100	-	V
Collector - emitter breakdown voltage (1) ( $V_{CE} = 50$ V, $I_B = 0$ )	$I_{CEO}$	-	1	mA
Collector cut off current ( $V_{CE} = 100$ V, $V_{BE (off)} = 1.5$ V) ( $V_{CE} = 100$ V, $V_{BE (off)} = 1.5$ V, $T_C = 150^{\circ}C$ )	$I_{CEX}$	-	0.5 5	mA
Emitter cut off current ( $V_{EB} = 5$ V, $I_C = 0$ )	$I_{EBO}$	-	2	mA
<b>ON Characteristics (1)</b>				
DC current gain ( $I_C = 7.5$ A, $V_{CE} = 3$ V) ( $I_C = 20$ A, $V_{CE} = 3$ V)	$h_{FE}$	75 100	18,000	-
Collector - emitter saturation voltage ( $I_C = 10$ A, $I_B = 40$ mA) ( $I_C = 20$ A, $I_B = 200$ mA)	$V_{CE (sat)}$	-	2 3	V
Base - emitter saturation voltage ( $I_C = 20$ A, $I_B = 200$ mA)	$V_{BE (sat)}$	-	4	
Base - emitter on voltage ( $I_C = 10$ A, $V_{CE} = 3$ V)	$V_{BE (on)}$	-	2.8	V
<b>Dynamic Characteristics</b>				
Current capacitance ( $V_{CB} = 10$ V, $I_E = 0$ , $f = 1$ MHz)	$C_{ob}$	-	600	pF
Small - signal current gain ( $I_C = 10$ A, $V_{CE} = 3$ V, $f = 1$ KHZ )	$h_{fe}$	300	-	-

(1) Pulse Test: Pulse width  $\leq 300$   $\mu s$ , Duty Cycle  $\leq 2\%$

# Silicon Power Transistor



Switching Time

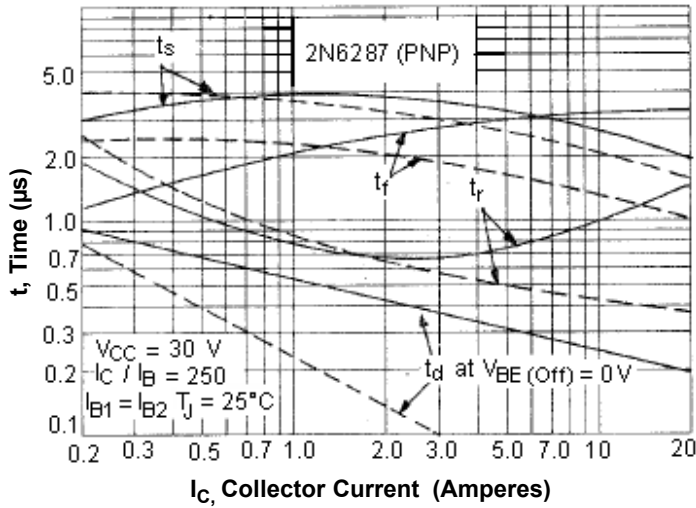

Capacitances

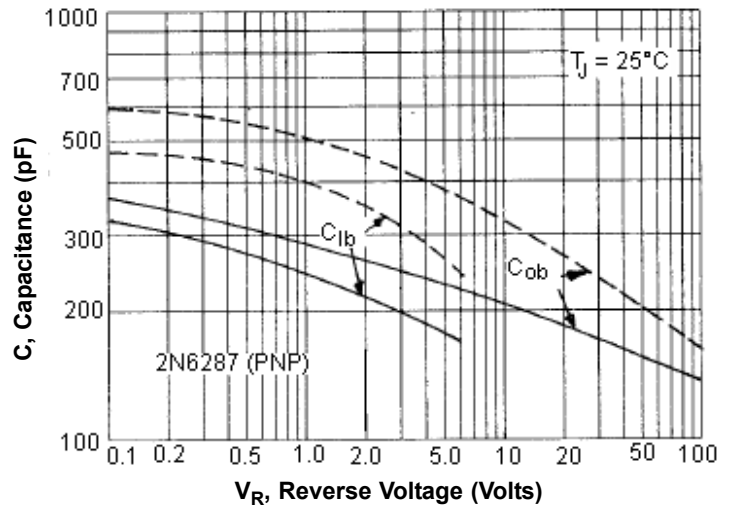

Active - Region Safe Operating Area (SOA)

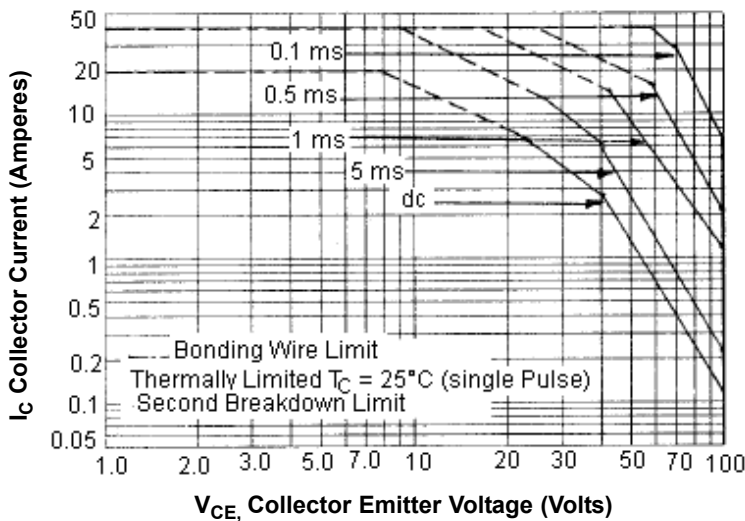

There are two limitation on the power handling ability of a transistor: average junction temperature and second breakdown safe operating area curves indicate  $I_C$ - $V_{CE}$  limits of the transistor that must be observed for reliable operation i.e., the transistor must not be subjected to greater dissipation than curves indicate. The data of SOA curve is base on  $T_{J(PK)} = 200^\circ C$ ;  $T_C$  is variable depending on conditions, second breakdown pulse limits are valid for duty cycles to 10% provided  $T_{J(PK)} < 200^\circ C$ , at high case temperatures, thermal limitation will reduce the power that can be handled to values less than the limitations imposed by second breakdown.

DC Current Gain

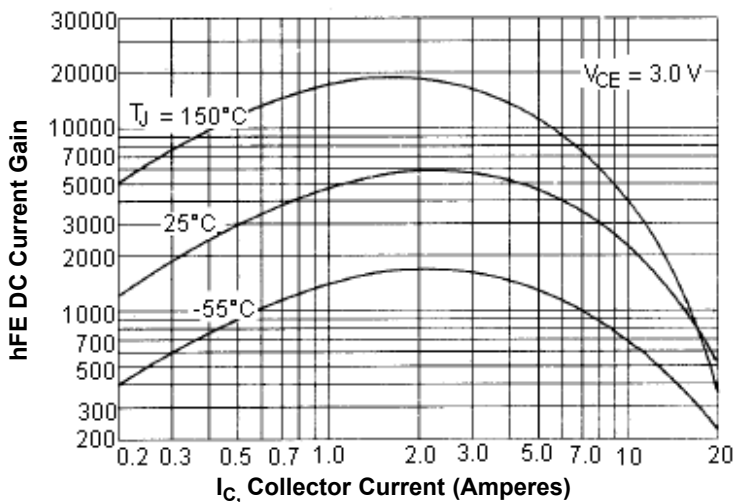

Collector Saturation Region

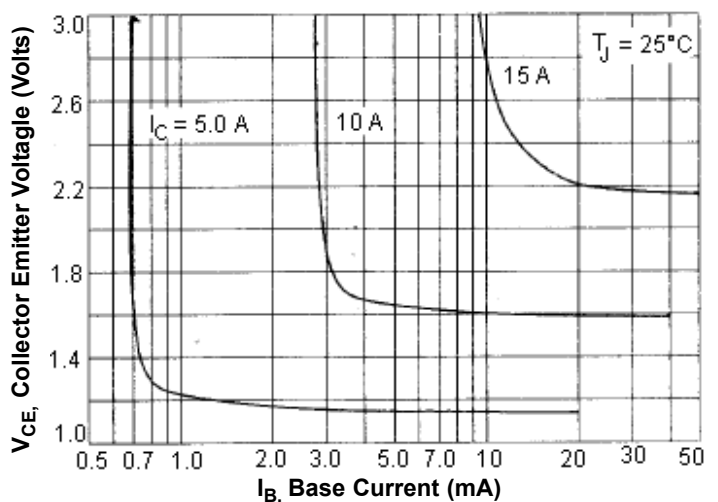

# Silicon Power Transistor

“ON” Voltages

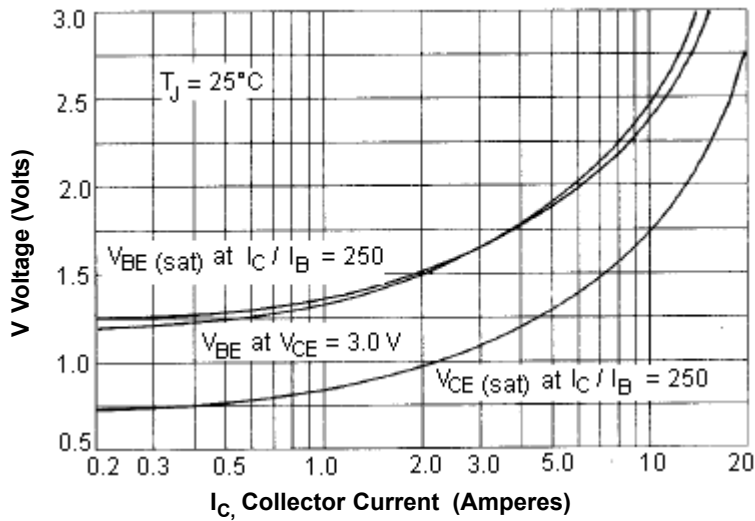

## Part Number Table

Description	Part Number
Silicon Power Transistor	2N6287

**Important Notice :** This data sheet and its contents (the "Information") belong to the members of the Premier Farnell group of companies (the "Group") or are licensed to it. No licence is granted for the use of it other than for information purposes in connection with the products to which it relates. No licence of any intellectual property rights is granted. The Information is subject to change without notice and replaces all data sheets previously supplied. The Information supplied is believed to be accurate but the Group assumes no responsibility for its accuracy or completeness, any error in or omission from it or for any use made of it. Users of this data sheet should check for themselves the Information and the suitability of the products for their purpose and not make any assumptions based on information included or omitted. Liability for loss or damage resulting from any reliance on the Information or use of it (including liability resulting from negligence or where the Group was aware of the possibility of such loss or damage arising) is excluded. This will not operate to limit or restrict the Group's liability for death or personal injury resulting from its negligence. Multicomp is the registered trademark of the Group. © Premier Farnell plc 2011.