

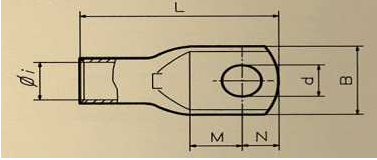

- * Designed for use with low stranded copper conductors
- * Annealed to guarantee optimum ductility and electrolytically tin plated to avoid oxidation.
- * Inspection hole facilitates the full insertion of the copper conductor.



STRAIGHT LUGS (LOW STRANDED)

Conductor Size / mm ²	Stud Size / mm	Lug Dimensions / mm						Angle	Pack Qty.	Price / 100	Part No.
		φ _i	B	M	N	L	d				
10.0	5	4.6	10.0	6.5	6.0	26.0	5.3	Straight	100	£23.81	A2-M5
	6	4.6	11.0	7.0	6.0	26.5	6.4	Straight	100	£23.81	A2-M6
	8	4.6	15.0	9.0	8.0	30.5	8.4	Straight	100	£23.81	A2-M8
	10	4.6	18.0	11.0	10.0	34.5	10.5	Straight	100	£27.31	A2-M10
	12	4.6	19.0	14.0	12.0	39.5	13.2	Straight	100	£31.91	A2-M12
16.0	5	5.8	11.5	6.5	6.0	29.0	5.3	Straight	100	£26.66	A3-M5
	6	5.8	11.5	7.0	6.0	29.5	6.4	Straight	100	£29.05	A3-M6
	8	5.8	15.0	9.0	8.0	33.5	8.4	Straight	100	£29.05	A3-M8
	10	5.8	18.0	11.0	10.0	37.5	10.5	Straight	100	£30.81	A3-M10
	12	5.8	20.0	14.0	12.0	42.5	13.2	Straight	100	£39.11	A3-M12
25.0	5	7.0	14.0	6.5	6.0	31.5	5.3	Straight	100	£34.30	A5-M5
	6	7.0	14.0	7.0	6.0	32.0	6.4	Straight	100	£34.30	A5-M6
	8	7.0	15.0	9.0	8.0	36.0	8.4	Straight	100	£37.13	A5-M8
	10	7.0	18.0	11.0	10.0	40.0	10.5	Straight	100	£39.33	A5-M10
	12	7.0	21.0	14.0	12.0	45.0	13.2	Straight	100	£44.78	A5-M12
35.0	5	8.9	17.0	6.5	6.0	34.0	5.3	Straight	100	£54.62	A7-M5
	6	8.9	17.0	7.0	6.0	34.5	6.4	Straight	100	£54.62	A7-M6
	8	8.9	17.0	9.0	8.0	38.5	8.4	Straight	100	£54.62	A7-M8
	10	8.9	19.0	11.0	10.0	42.5	10.5	Straight	100	£60.96	A7-M10
	12	8.9	21.0	14.0	12.0	47.5	13.2	Straight	100	£65.99	A7-M12
50.0	6	10.0	19.0	8.0	7.0	40.5	6.4	Straight	50	£84.33	A10-M6
	8	10.0	19.0	9.0	8.0	42.5	8.4	Straight	50	£84.33	A10-M8
	10	10.0	20.0	11.0	10.0	46.5	10.5	Straight	50	£87.17	A10-M10
	12	10.0	21.0	14.0	12.0	51.5	13.2	Straight	50	£87.17	A10-M12
	14	10.0	25.0	16.0	14.0	56.5	15.0	Straight	50	£95.26	A10-M14
70.0	16	10.0	26.0	18.0	16.0	59.5	17.0	Straight	50	£95.26	A10-M16
	6	11.3	21.0	8.0	7.0	44.0	6.4	Straight	50	#####	A14-M6
	8	11.3	21.0	8.0	8.0	46.0	8.4	Straight	50	#####	A14-M8
	10	11.3	21.0	11.0	10.0	50.0	10.5	Straight	50	#####	A14-M10
	12	11.3	22.0	14.0	12.0	55.0	13.2	Straight	50	#####	A14-M12
95.0	14	11.3	25.0	16.0	14.0	59.0	15.0	Straight	50	#####	A14-M14
	16	11.3	26.0	18.0	16.0	63.0	17.0	Straight	50	#####	A14-M16
	6	13.5	25.0	8.0	7.0	50.5	6.4	Straight	25	#####	A19-M6
	8	13.5	25.0	9.0	8.0	52.5	8.4	Straight	25	#####	A19-M8
	10	13.5	25.0	11.0	10.0	56.5	10.5	Straight	25	#####	A19-M10
120.0	12	13.5	25.0	14.0	12.0	61.5	13.2	Straight	25	#####	A19-M12
	14	13.5	25.0	16.0	14.0	65.5	15.0	Straight	25	#####	A19-M14
	16	13.5	27.0	18.0	16.0	69.5	17.0	Straight	25	#####	A19-M16
	20	13.5	29.5	22.0	20.0	77.5	21.0	Straight	25	#####	A19-M20
	8	15.2	28.5	9.0	8.0	54.0	8.4	Straight	25	#####	A24-M8
10	15.2	28.5	11.0	10.0	58.0	10.5	Straight	25	#####	A24-M10	
12	15.2	28.5	14.0	12.0	63.0	13.2	Straight	25	#####	A24-M12	
14	15.2	28.5	16.0	14.0	67.0	15.0	Straight	25	#####	A24-M14	
16	15.2	28.5	18.0	16.0	71.0	17.0	Straight	25	#####	A24-M16	
20	15.2	30.0	22.0	20.0	79.0	21.0	Straight	25	#####	A24-M20	