

RockStar® accessories

RockStar® accessories	Crimp contacts	G.2
	Tools	G.10
	Coding	G.14
	Adapter plates / Cover plates	G.16
	Other accessories	G.17

Crimp contacts

Overview



G

Crimp contacts

Crimping is an electrically and mechanically safe and reliable connection between conductor and contact. An ideal crimp connection is gas-proof and resistant to corrosion.

Weidmüller crimp contacts are supplied in solid, turned form and are optionally available with gold or silver surface.

Fiber optic contacts

Optical fibers guarantee interference-free transmission without any feedback – and this without additional overvoltage and explosion protection.

Fiber optic contacts can be used without any EMC problems. Their geometry is the same as the HD contacts so they can be used in HD series inserts and the ConCept modular system.

Fixed pole inserts

Technical data

	for HD and HDD inserts	for HE and HEE inserts
Material	Copper alloy	Copper alloy
Surface hard gold-plated	0.8 µm	0.8 µm
Surface hard silver-plated	3 µm	3 µm
Contact resistance	≤ 4 mΩ	≤ 4 mΩ
Clamping range	0.14 ... 2.5 mm ²	0.5 ... 4.0 mm ²
	26 ... 14 AWG	20 ... 12 AWG
Stripping length	8 mm	7.5 mm

For HD and HDD inserts

Crimp contacts

Surface Silver



Surface Gold



Qty	Male	Order No.	Female	Order No.
100	HDC-C-HD-SM0.14-0.37AG	1651520000	HDC-C-HD-BM0.14-0.37AG	1651570000
100	HDC-C-HD-SM0.5AG	1651530000	HDC-C-HD-BM0.5AG	1651580000
100	HDC-C-HD-SM0.75-1.00AG	1601750000	HDC-C-HD-BM0.75-1.00AG	1601760000
100	HDC-C-HD-SM1.5AG	1651550000	HDC-C-HD-BM1.5AG	1651600000
100	HDC-C-HD-SM2.5AG	1651560000	HDC-C-HD-BM2.5AG	1651610000
<hr/>				
100	HDC-C-HD-SM0.14-0.37AU	1651620000	HDC-C-HD-BM0.14-0.37AU	1651670000
100	HDC-C-HD-SM0.5AU	1651630000	HDC-C-HD-BM0.5AU	1651680000
100	HDC-C-HD-SM0.75-1.00AU	1651640000	HDC-C-HD-BM0.75-1.00AU	1651690000
100	HDC-C-HD-SM1.5AU	1651650000	HDC-C-HD-BM1.5AU	1651700000
100	HDC-C-HD-SM2.5AU	1651660000	HDC-C-HD-BM2.5AU	1651710000

Conductor cross-section	Insulation stripping length
0.14 – 0.37 mm ²	AWG 26-22 8 mm
0.50 mm ²	AWG 20 8 mm
0.75 – 1.00 mm ²	AWG 18 8 mm
1.50 mm ²	AWG 16 8 mm
2.50 mm ²	AWG 14 6 mm

Tools



Crimping tool	Order No.
CTX CM 1.6 / 2.5	9018490000
CTIN CM 1.6 / 2.5	9205430000
<hr/>	
Contact release tool	Order No.
Removal Tool HD	1866730000

For HE and HEE inserts and CM-HE modules

Crimp contacts

Surface Silver

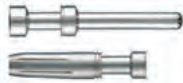

Surface Gold



Qty	Male	Order No.	Female	Order No.
100	HDC-C-HE-SM0.5AG	1200500000	HDC-C-HE-BM0.5AG	1201100000
100	HDC-C-HE-SM0.75-1.00AG	1200600000	HDC-C-HE-BM0.75-1.00AG	1201200000
100	HDC-C-HE-SM1.5AG	1200700000	HDC-C-HE-BM1.5AG	1201300000
100	HDC-C-HE-SM2.5AG	1200800000	HDC-C-HE-BM2.5AG	1201400000
100	HDC-C-HE-SM4.0AG	1200900000	HDC-C-HE-BM4.0AG	1201500000
<hr/>				
100	HDC-C-HE-SM0.5AU	1651420000	HDC-C-HE-BM0.5AU	1651470000
100	HDC-C-HE-SM0.75-1.00AU	1651430000	HDC-C-HE-BM0.75-1.00AU	1651480000
100	HDC-C-HE-SM1.5AU	1651440000	HDC-C-HE-BM1.5AU	1651490000
100	HDC-C-HE-SM2.5AU	1651450000	HDC-C-HE-BM2.5AU	1651500000
100	HDC-C-HE-SM4.0AU	1651460000	HDC-C-HE-BM4.0AU	1651510000

Conductor cross-section	Insulation stripping length
0.50 mm ²	AWG 20 7.5 mm
0.75 – 1.00 mm ²	AWG 18 7.5 mm
1.50 mm ²	AWG 16 7.5 mm
2.50 mm ²	AWG 14 7.5 mm
4.00 mm ²	AWG 12 7.5 mm

Tools



Crimping tool	Order No.
CTX CM 1.6 / 2.5	9018490000
CTIN CM 1.6 / 2.5	9205430000
<hr/>	
Crimping tools for 4.00 mm ²	Order No.
CZB 1	9012710000
<hr/>	
Contact release tool	Order No.
Removal Tool HE	1866750000

Crimp contacts

Fixed pole inserts

Technical data

For HQ and MixMate inserts	
Material	Copper alloy
Surface	Passivated silver
Contact resistance	≤ 5 mΩ
Clamping range	1.5 ... 6 mm ²
	16 ... 10 AWG
Stripping length	8 mm

Accessories

Crimp contacts

Surface Silver



Qty	Male	Order No.	Female	Order No.
25	HDC C HX SM1.5AG	1002910000	HDC C HX BM1.5AG	1002950000
25	HDC C HX SM2.5AG	1002920000	HDC C HX BM2.5AG	1002960000
25	HDC C HX SM4.0AG	1002930000	HDC C HX BM4.0AG	1002970000
25	HDC C HX SM6.0AG	1002940000	HDC C HX BM6.0AG	1002980000

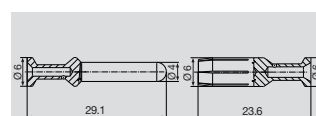

Conductor cross-section	Insulation stripping length
1.50 mm ²	AWG 16 8 mm
2.50 mm ²	AWG 14 8 mm
4.00 mm ²	AWG 12 8 mm
6.00 mm ²	AWG 10 8 mm

G

Tools



Order No.	Order No.
1002910000	1002950000
1002920000	1002960000
1002930000	1002970000
1002940000	1002980000
9205430000	1002990000

Crimp contacts

For ConCept modular system

Technical data

	CM-3	CM-5	CM-10	CM-20	CM-HE
Material	Copper alloy	Copper alloy	Copper alloy	Copper alloy	Copper alloy
Surface hard gold-plated			0.8 µm	0.1 ... 0.2 µm	0.8 µm
Surface hard silver-plated	3 µm	3 µm	3 µm		3 µm
Contact resistance	≤ 4 mΩ	≤ 4 mΩ	≤ 4 mΩ	≤ 4 mΩ	≤ 4 mΩ
Clamping range	1.5 ... 10 mm ²	0.75 ... 4.0 mm ²	0.14 ... 2.5 mm ²	0.08 ... 0.52 mm ²	0.5 ... 4.0 mm ²
	12 ... 7 AWG	20 ... 12 AWG	26 ... 14 AWG	28 ... 20 AWG	20 ... 12 AWG
Stripping length	10 mm	7 mm	8 mm (6mm)	2.5 + 0.5 mm	7.4 mm

For CM-3 modules

Crimp contacts

Surface Silver



Qty	Male	Order No.	Female	Order No.
100	HDC-C-M3-SM1.5AG	1698120000	HDC-C-M3-BM1.5AG	1698130000
100	HDC-C-M3-SM2.5AG	1698140000	HDC-C-M3-BM2.5AG	1698150000
100	HDC-C-M3-SM4.0AG	1682260000	HDC-C-M3-BM4.0AG	1682270000
100	HDC-C-M3-SM6.0AG	1682280000	HDC-C-M3-BM6.0AG	1682290000
100	HDC-C-M3-SM10.0AG	1682300000	HDC-C-M3-BM10.0AG	1682310000

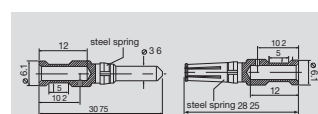

Conductor cross-section	Insulation stripping length
1.50 mm ²	AWG 16 10 mm
2.50 mm ²	AWG 14 10 mm
4.00 mm ²	AWG 12 10 mm
6.00 mm ²	AWG 10 10 mm
10.00 mm ²	AWG 7 10 mm

Tools



Order No.
9018490000
9018480000
1700890000
1866710000

For CM-5 modules

Crimp contacts

Surface Silver



Qty	Male	Order No.	Female	Order No.
100	HDC-C-M5-SM0.5AG	1682320000	HDC-C-M5-BM0.5AG	1682330000
100	HDC-C-M5-SM0.75-1.00AG	1682340000	HDC-C-M5-BM0.75-1.00AG	1682350000
100	HDC-C-M5-SM1.5AG	1682360000	HDC-C-M5-BM1.5AG	1682370000
100	HDC-C-M5-SM2.5AG	1682380000	HDC-C-M5-BM2.5AG	1682390000
100	HDC-C-M5-SM4.0AG	1682400000	HDC-C-M5-BM4.0AG	1682410000

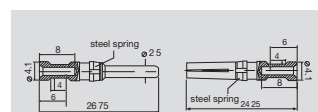

Conductor cross-section	Insulation stripping length
0.75 - 1.00 mm ²	AWG 18 7 mm
1.50 mm ²	AWG 16 7 mm
2.50 mm ²	AWG 14 7 mm
4.00 mm ²	AWG 12 7 mm

Tools



Order No.
9018490000
1866720000

For CM-10 modules

Crimp contacts

Surface Silver



Surface Gold



Qty	Male	Order No.	Female	Order No.
100	HDC-C-HD-SM0.14-0.37AG	1651520000	HDC-C-HD-BM0.14-0.37AG	1651570000
100	HDC-C-HD-SM0.5AG	1651530000	HDC-C-HD-BM0.5AG	1651580000
100	HDC-C-HD-SM0.75-1.00AG	1601750000	HDC-C-HD-BM0.75-1.00AG	1601760000
100	HDC-C-HD-SM1.5AG	1651550000	HDC-C-HD-BM1.5AG	1651600000
100	HDC-C-HD-SM2.5AG	1651560000	HDC-C-HD-BM2.5AG	1651610000
100	HDC-C-HD-SM0.14-0.37AU	1651620000	HDC-C-HD-BM0.14-0.37AU	1651670000
100	HDC-C-HD-SM0.5AU	1651630000	HDC-C-HD-BM0.5AU	1651680000
100	HDC-C-HD-SM0.75-1.00AU	1651640000	HDC-C-HD-BM0.75-1.00AU	1651690000
100	HDC-C-HD-SM1.5AU	1651650000	HDC-C-HD-BM1.5AU	1651700000
100	HDC-C-HD-SM2.5AU	1651660000	HDC-C-HD-BM2.5AU	1651710000

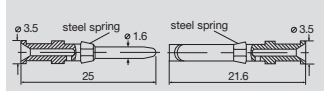

Conductor cross-section	Insulation stripping length
0.14 – 0.37 mm ²	AWG 26-22 8 mm
0.50 mm ²	AWG 20 8 mm
0.75 – 1.00 mm ²	AWG 18 8 mm
1.50 mm ²	AWG 16 8 mm
2.50 mm ²	AWG 14 6 mm

Tools



Crimping tool	Order No.
CTX CM 1.6 / 2.5	9018490000
Contact release tool	
Removal Tool HD	1866730000

For CM-20 modules

Crimp contacts

Surface Gold



Qty	Male	Order No.	Female	Order No.
300	HDC-C-M20-SCG0.08-0.2AU	1682420000	HDC-C-M20-SCG0.08-0.2AU	1682430000
300	HDC-C-M20-SCG0.2-0.52AU	1682440000	HDC-C-M20-SCG0.2-0.52AU	1682450000

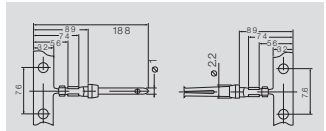

Conductor cross-section	Insulation stripping length
0.08 – 0.20 mm ²	AWG 28-24 2.5+0.5 mm
0.20 – 0.52 mm ²	AWG 24-20 2.5+0.5 mm

Note

Reel with 300 contacts

Tools



Crimping tool	Order No.
HDC-CM-20/CZC9428P	1700900000
Contact release tool	
Removal Tool CM20	1866740000

Crimp contacts

Fiber optic contacts



Fiber-optic cables guarantee interference-free transmission without any feedback.

The new fiber optic contacts enable use of fiber-optic cables in heavy-duty connectors. Their geometry is the same as the tried-and-tested HD contacts for connecting conventional copper wires, so they can be used in HD series inserts and the ConCept modular system.

It's even possible to connect optical fibers and copper wires in one connector.

The advantages at a glance:

- Immune to electromagnetic interference
- Absolute contact separation
- Weight reduction by dispensing with copper wires
- High transmission capacity and large bandwidth
- All advantages now also available for robust industrial environment

G

HDC-C-HD ... LWL 1.0 POF

Technical data

Connection for POF cable	
Maximum outer diameter	2.2 mm
Polymer fiber diameter	1.0 mm
Attenuation	
- Requirement to DIN IEC Part 7 Section 2/05.94:	< 3 dB
- the HDC-C-HD LWL contacts in plugged-in state:	< 2 dB
Material	
Temperature range	-40°C to +85°C
Contact material	Nickel-silver
Over-spring	Copper alloy

Ordering data



Qty	Male	Order No.	Female	Order No.
5	HDC-C-HD-S-LWL 1.0 POF	1773630000	HDC-C-HD-B-LWL 1.0 POF	1773640000

HD inserts must be ordered separately

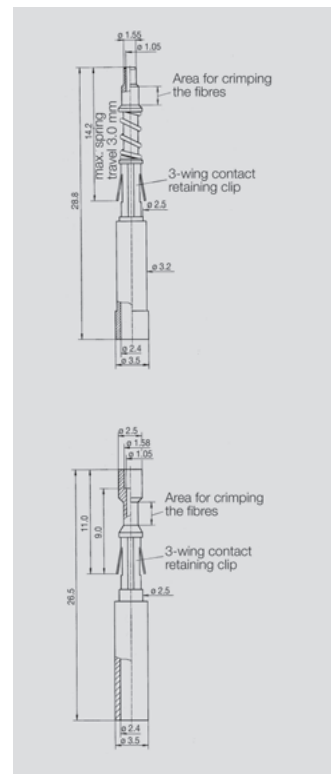

Instructions for assembling fiber optic contacts

1. Cut POF cable (polymer optical fiber) to the required length with cutting tool (we recommend the KT 8).
2. The end face of the fiber of 2.2 mm POF cables must be polished before crimping onto the fiber optic contact. Insert end of POF cable into polishing disc and polish with polishing sheet placed on a smooth surface (e.g. glass plate). Wipe away any residues after polishing. The best optical attenuation values are obtained with wet polishing.
3. Strip sheath of 2.2 mm POF cable to at least 14 mm for female contacts (HDC-C-HD-B-LWL) and at least 19 mm for male contacts (HDC-C-HD-S-LWL).
4. Crimping:
 - A. Insert POF cable into male contact, then both together into the crimping die.
 - B. The female contact has to be inserted angled slightly downwards into the die.
Make sure the end face of the contact and the plastic fiber press against the locator.
 - C. Squeeze the hand levers until the tool unlocks.
 - D. Release option in case of incorrect operation.

A. Male

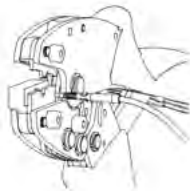

B. Female

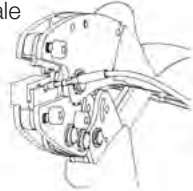

C.

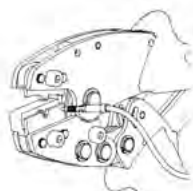

D.

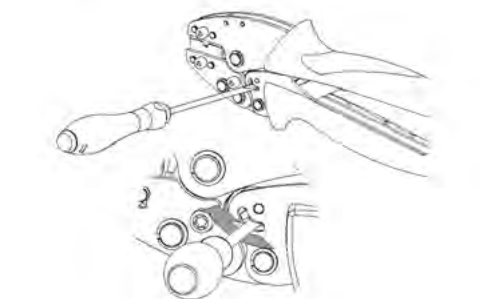

Cutting tool

including positioning sleeve



Type	Qty	Order No.
KT 8	1	9002650000

Polishing disc for fiber-optic cable

Polishing sheet, 1000 grit size

2.2 mm POF cable



Type	Qty	Order No.
PS LWL/POF	1	9020390000
PB LWL/POF	1	9020400000

Stripping tool

for fiber-optic cable



Type	Qty	Order No.
AM LWL/POF	1	9020360000

Crimping tool

for fiber-optic set



Type	Qty	Order No.
HTX-HDC/POF	1	9010950000

Contact release tool

for removing machined HD and fiber-optic contacts



Type	Qty	Order No.
Removal Tool HD	1	1866730000

Tools

Crimping tools

- Automatic lock guarantees quality crimp
- Release option in case of incorrect operation
- With stop for exact positioning of contacts

CTX CM 1.6 / 2.5 + CM 3.6

0.14 ... 10 mm²



CTX CM 1.6/2.5 (0.14 ... 4 mm²)

- turned HD contacts
- turned HE contacts
- ConCept contacts

CTX CM 3.6 (4.0 ... 10.0 mm²)

- ConCept M3 contacts and similar designs

HDC-CM 20

0.08 ... 0.52 mm²



HDC-CM-20

Crimping tool for diameters of 1.0 mm. D-Sub contacts with 0.08 ... 0.52 mm² conductor size of ConCept CM-20 module

Length = 230 mm
Weight = 650 g

G



Technical data

Contact description	
Type of contact	
Crimp range	
Crimp range1 (with multiple crimping positions)	
Crimp range 2 (with multiple crimping positions)	
Crimp range 3 (with multiple crimping positions)	
Crimp range 4 (with multiple crimping positions)	
Crimp range 5 (with multiple crimping positions)	
Tools data	
Length	mm
Weight	g
Note	

CTX CM 1.6/2.5	CTX CM 3.6
turned contacts	turned contacts
0.14 ... 4 mm ²	4 ... 10 mm ²
0.14 ... 0.5 mm ²	4 mm ²
0.75 ... 1 mm ²	6 mm ²
1.5 mm ²	10 mm ²
2.5 mm ²	
4 mm ²	
250	250
730	730

HDC CM 20
Stamped Sub-D contacts
Stamped CM 20 contacts
0.08 ... 0.52 mm ²
230
650

Ordering data

Type	Qty	Order No.
CTX CM 1.6/2.5	1	9018490000
CTX CM 3.6	1	9018480000

Type	Qty	Order No.
HDC CM 20	1	1700900000

Type	Qty	Order No.
HDC CM 20	1	1700900000

CTIN CM 1.6/2.5 / CTIN 3.6

0.14 ... 10 mm²



CTIN CM 1.6/2.5

- Turned HD and HE contacts
- Turned HX contacts
- ConCept M10, M5 and M3 contacts
- 4-indent crimp
- 0.14...4.0 mm²

CTIN CM 3.6

- Turned HX contacts
- ConCept M 3 contacts
- 4-indent crimp
- 1.5...10.0 mm²



CTIN CM 1.6/2.5	CTIN CM 3.6
turned contacts	turned contacts
0.14 ... 6 mm ²	1.5 ... 10 mm ²
0.14 ... 6 mm ²	1.5 ... 10 mm ²
230	230
1220	1220

Type	Qty	Order No.
CTIN CM 1.6/2.5	1	9205430000
CTIN CM 3.6	1	9205440000

... POF

Optical fiber tools



Crimping tool for optical fiber contacts HTX HDC/POF

- One tool for male and female contacts
- Locator on tool
- No positioning of locator needed
- Release option in case of incorrect operation
- Contacts insert from the side

Contacts:

- Fiber optic HD contacts for 1.0 mm cross-section POF

Type	Qty	Order No.
HTX-HDC/POF	1	9010950000

... POF

Optical fiber tools



POF sheath stripping tool AM LWL/POF

For stripping the sheathing of polymer optical fiber cables.

- Length stop with scale integrated in the tool
- Stripping direction along the fiber
- No damage to fibers

**Polishing wheel (PS LWL/POF)
Polishing sheet (PB LWL/POF)**

for polishing the cut face of optical fibers.

Type	Qty	Order No.
AM LWL/POF	1	9020360000
PS LWL/POF	1	9020390000
PB LWL/POF	1	9020400000

Tools

Removal Tools

Contact removal tools



(a) (b) (c) (d)

Removal tools (a-c)
for contacts CM3, CM5, HD, CM20, HE and HX

HDC-DW-MOD

Module removal tool



Tool for removing ConCept modules from the frame

IS

Hex-socket wrench



Technical data

Power contacts	S 4
Stripping length	8 mm
Tightening torque	1.1 – 1.7 Nm
Hex-socket wrench	IS 2 KG
Power contacts	S 4/0
Stripping length	13 mm
Tightening torque	
Hex-socket wrench	IS 3 KG
Power contacts	S 6/12
Stripping length	8 mm
Tightening torque	1.1 – 1.7 Nm
Hex-socket wrench	IS 2 KG
Power contacts	S 6/6
Stripping length	13 mm
Tightening torque	6 ... 8 Nm
Hex-socket wrench	IS 4 KG

Ordering data

Type	Qty	Order No.
Removal Tool CM 3	1	1866710000
Removal Tool CM 5	1	1866720000
Removal Tool HD	1	1866730000
Removal Tool CM 20	1	1866740000
Removal Tool HE	1	1866750000
Removal Tool HX	1	1002990000
DW RSV 1.6	1	9004530000
HÜLSE REMOVAL TOOL CM 3	5	1044080000
HÜLSE REMOVAL TOOL CM 5	5	1044090000
HÜLSE REMOVAL TOOL CM20	5	1044120000
HÜLSE REMOVAL TOOL HD	5	1044100000
HÜLSE REMOVAL TOOL HX	5	1044130000

Ordering data

Type	Qty	Order No.
HDC-DW-MOD	1	1688200000

Ordering data

Type	Qty	Order No.
IS 2 KG	2	1806630000
IS 3 KG	2	1806650000
IS 4 KG	2	1806660000

Hydraulic sheet holes

IE-KO-HAT



- Pressure-relief valve protects against overload
- Cylinder head angled 90°
- Angled head, 360° turnable
- Ergonomic handle springs back by itself
- Waste pieces no longer become jammed thanks to the three-way splitting
- Hydraulic punch made from high-strength aluminium (approx. 40 % weight savings)

KOK



Rectangular splitting stamp for heavy-duty connectors

Technical data

Maximum steel-sheet punching performance

Square holes up to	68 x 68 mm
Rectangular holes up to	36 x 112 mm

Tool data

Length / width / height	mm
Weight	kg
Punching force	kN
Max. operating pressure	bar
Including accessories (contents)	

IE-KO-HAT

2.0 mm F = 370 N/mm ²
3.0 mm F = 370 N/mm ²
2.0 mm F = 370 N/mm ²
2.0 mm F = 370 N/mm ²
290/120/70
1.9
75
650
1 hydraulic screw Ø 19 mm
1 hydraulic screw Ø 19 x 9.5 mm
1 HSS pre-drill Ø 10 mm
1 spacer nut set (3-part)
1 bridge

Note

Ordering data

Version

Type	Qty.	Order No.
IE-KO-HAT	1	1966810000

Note

Accessories

Type	Qty.	Order No.
Tension screw KOBBS 9,5 x 50	1	9205030000
Tension screw KOBBS 19 x 55	1	9205040000
Tension screw KOBBS 19 x 75	1	9204780000

Note

Ordering data

Type	Description	Qty.	Order No.
KOK 52 x 36	6-poles	1	9204820000
KOK 65 x 36	10-poles	1	9204830000
KOK 86 x 36	16-poles	1	9204850000
KOK 112 x 36	24-poles	1	9204870000

Note: the fastening points are centre-punched.

HE coding pin

Use a coding pin to prevent plugging errors. A pin provides a simple and quick method for uniquely identifying similarly shaped connectors. The coding pin can be inserted into a single contact chamber (instead of a crimp contact) on both the male and female side of the connector. The opposite mated contact then remains free. The HE coding pin can be used to code all inserts and modules using HE-series crimp contacts.

These include the following:

- HA crimp inserts
- HE crimp inserts
- HEE inserts
- HQ 5 insert
- HQ 8 insert
- CM-HE module

Ordering data

Type	Qty	Order No.
HDC HE CP	100	1003240000

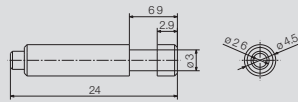

HQ 7 coding system

You can protect 7-pole HQ connectors against false insertions by using the HQ 7 coding system. Both a coding pin and socket are used for protection. Six different variants are

permitted by the shape of the optional coding which is aligned centrally in the connector. Refer to the coding diagram for the layout.

Ordering data

Type	Qty	Order No.
HDC HQP7 CPM	50	1003230000
HDC HQP7 CPF	50	1003220000



Note: six-way coding is possible with a coding pin.

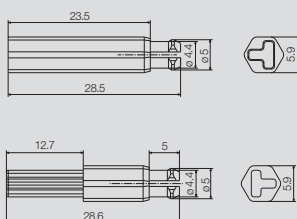

Coding arrangement for coding pins/sockets

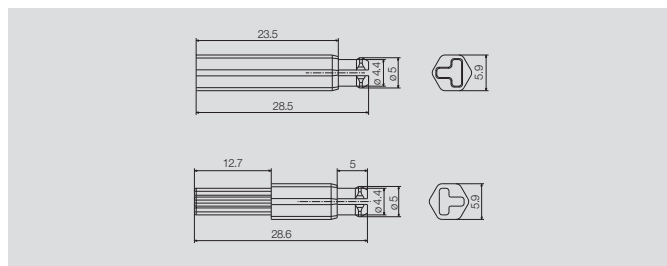
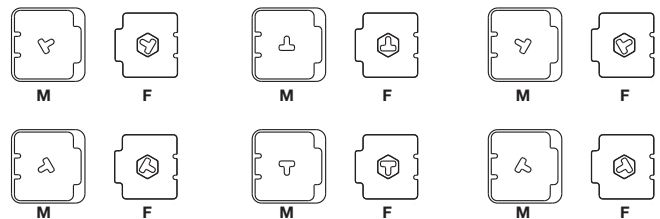

Adapter plates / Cover plates

Adapter plates, plastic



Cover plates



Adapter plates, SUB-D

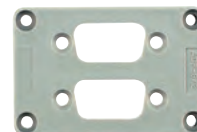

G

Technical data

Adapter plates, plastic	
Material	PA6
Sealing material	TPE-S
Color	orange/gray
Temperature range	-30 °C to +110 °C
Class of protection	IP 65

Cover plates	
Material	PA6 / FE
Sealing material	TPE-S
Color	orange/gray
Temperature range	-30 °C to +110 °C
Class of protection	IP 65

Adapter plates, SUB-D	
Material	PA6
Sealing material	
Color	gray
Temperature range	-30 °C to +110 °C
Class of protection	

Ordering data

Type	Size	Qty	Order No.
orange			
ADP-8/3-OR	3	10	1664980000
ADP-8/4-OR	4	10	1665000000
ADP-8/6-OR	6	10	1665020000
gray			
ADP-8/3-GR	3	10	1664990000
ADP-8/4-GR	4	10	1665010000
ADP-8/6-GR	6	10	1665030000

Type	Size	Qty	Order No.
Sheet steel			
ABD-1 sheet steel	1	10	9457300000
Plastic, gray			
ABD-2-GR	2	10	1664330000
ABD-3-GR	3	10	1664350000
ABD-4-GR	4	10	1664360000
ABD-5-GR	5	10	1664370000
ABD-6-GR	6	10	1664390000
ABD-8-GR	8	10	1664970000
Plastic, orange			
ABD-8-OR	8	10	1664960000

Type	Aperture	Qty	Order No.
Size 3 / Plastic			
ADS/6-1/9	1 x SUB-D 9	10	1665940000
ADS/6-2/9	2 x SUB-D 9	10	1665950000
ADS/6-1/15	1 x SUB-D 15	10	1666200000
ADS/6-2/15	2 x SUB-D 15	10	1666210000
Size 4 / Plastic			
ADS/10-1/25	1 x SUB-D 25	10	1666220000
ADS/10-2/25	2 x SUB-D 25	10	1666230000
Size 6 / Plastic			
ADS/16-1/25	1 x SUB-D 25	10	1666320000
ADS/16-2/25	2 x SUB-D 25	10	1666330000
ADS/16-1/37	1 x SUB-D 37	10	1666340000
ADS/16-2/37	2 x SUB-D 37	10	1666350000
ADS/16-1/50	1 x SUB-D 50	10	1666460000

Moulded gasket seals

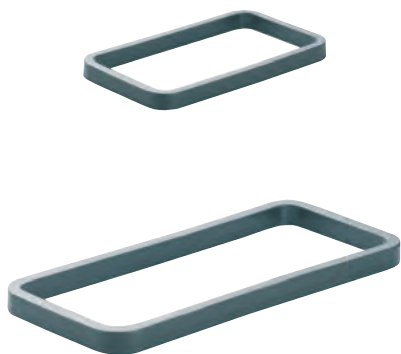

Gaskets



Ordering data

Type	Size	Qty	Order No.
HDC DG 06B	3	5	1044610000
HDC DG 07A	1	5	1044580000
HDC DG 10A	2	5	1044590000
HDC DG 10B	4	5	1044620000
HDC DG 16A	5	5	1044600000
HDC DG 16B	6	5	1044630000
HDC DG 24B	8	5	1044650000
HDC DG 32A	7	5	1044640000
HDC DG 48A 32B	9/10	5	1044660000
HDC DG 48B	12	5	1044670000

Note:
for bulkhead and coupling housings

Type	Size	Qty	Order No.
HDC FLDG 04A	1	5	1044480000
HDC FLDG 06B	3	5	1044500000
HDC FLDG 10A	2	5	1044490000
HDC FLDG 10B	4	5	1044510000
HDC FLDG 16A	5	5	1044520000
HDC FLDG 16B	6	5	1044530000
HDC FLDG 24B	8	5	1044550000
HDC FLDG 32A	7	5	1044540000
HDC FLDG 32B	10	5	1044560000
HDC FLDG 48B	12	5	1044570000
HDC-HB10 AWVL FD	HB-10 AWVL	500	1855680000

Note:
for bulkhead housings

Other accessories

Locking foot for TS 35 mounting rail

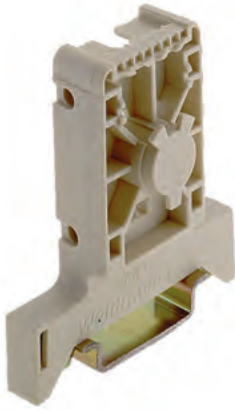

Locking hook



Example: DSTV-TS

Type	Qty	Order No.
DSTV-TS 6-24	10	1595220000

Type	Qty	Order No.
DSTV-TS 6 VH	10	1595230000
DSTV-TS 10-24 VH	10	1595240000

Note:
For all inserts apart from HA and all inserts of size 1

Note:
For all inserts apart from HA and all inserts of size 1

**Shield lever for sizes 3 (06B), 4 (10B), 6 (16B) and 8 (24B)
for fitting of shield clamps or KLBÜ 3–8 SC**

Technical data

Use	Clamping of the shield
Fastening of shield lever	To PE terminal, both sides, 2nd screw for fixing
Cable connection system	Shield clamp or KLBÜ clamping yoke
No. shield clamps or KLBÜ clamping yokes	
Size 3 (06B)	1* or 1
Size 4 (10B)	2* or 2
Size 6 (16B)	3* or 3
Size 8 (24B)	5* or 5
	* Fastening points of shield clamp, 16 mm spacing
Clamping range shield clamp	see page G.16
Material	Steel
Surface	Galvanized
Temperature range	-40 °C ... +125 °C

Shield lever

for standard inserts and the ConCept modular system (plastic frame)

HDC SHIELD LEVER 3 SC



Type	Size	Qty	Order No.
HDC SHIELD LEVER 3 SC	3	1	1867390000

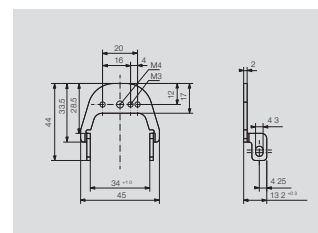

HDC SHIELD LEVER 4 SC



Type	Size	Qty	Order No.
HDC SHIELD LEVER 4 SC	4	1	1867370000

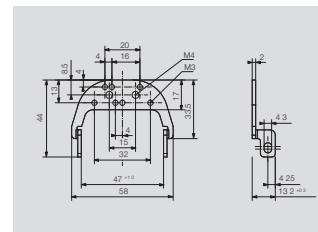

HDC SHIELD LEVER 6 SC



Type	Size	Qty	Order No.
HDC SHIELD LEVER 6 SC	6	1	1867380000

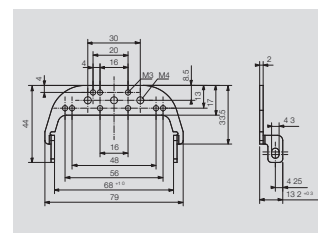

HDC SHIELD LEVER 8 SC



Type	Size	Qty	Order No.
HDC SHIELD LEVER 8 SC	8	1	1867360000

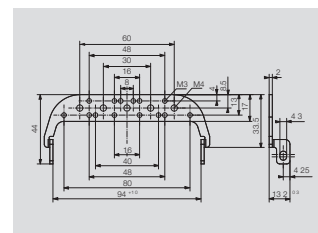

Other accessories

Shield lever

for standard inserts and the ConCept modular system (plastic frame) – special versions

SHIELD LEVER 8 MOD 35mm



Type	Size	Qty	Order No.
SHIELD LEVER 8 MOD 35mm	8	1	1000950001

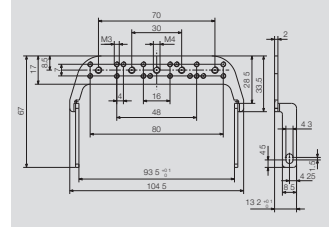

SHIELD LEVER 8 MOD HIGH



Type	Size	Qty	Order No.
SHIELD LEVER 8 MOD HIGH	8	1	1009310000

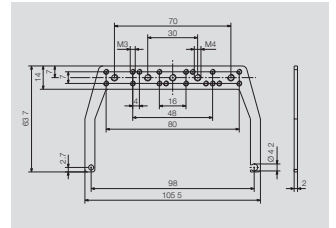

HDC SHIELD LEVER 8 LL



Type	Size	Qty	Order No.
HDC SHIELD LEVER 8 LL	8	1	1011380000

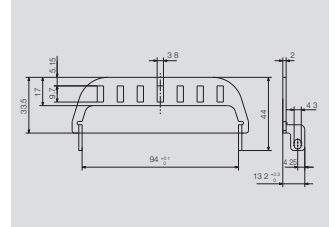

Shield lever

for the ConCept modular system (metal frame) – straight version

SHIELD LEVER 3 MOD



Type	Size	Qty	Order No.
SHIELD LEVER 3 MOD	3	1	1983910000

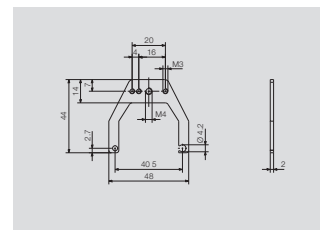

SHIELD LEVER 4 MOD



Type	Size	Qty	Order No.
SHIELD LEVER 4 MOD	4	1	1983920000

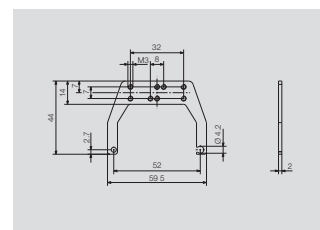

SHIELD LEVER 6 MOD



Type	Size	Qty	Order No.
SHIELD LEVER 6 MOD	6	1	1983930000

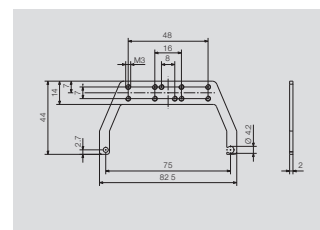

SHIELD LEVER 8 MOD



Type	Size	Qty	Order No.
SHIELD LEVER 8 MOD	8	1	1983940000

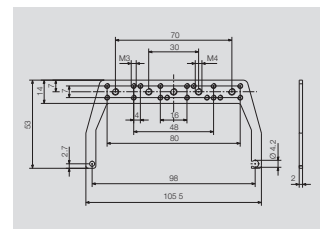

SHIELD LEVER 8 MOD HIGH



Type	Size	Qty	Order No.
SHIELD LEVER 8 MOD HIGH	8	1	1009310000

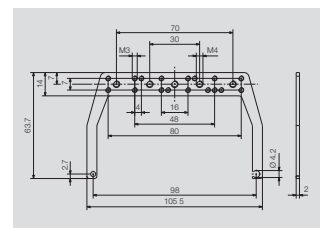

Other accessories

Shield lever

for the ConCept modular system (metal frame) – 45° angled version

SHIELD LEVER 3 CSB 45°



Type	Size	Qty	Order No.
SHIELD LEVER 3 CSB 45°	3	1	1017040000

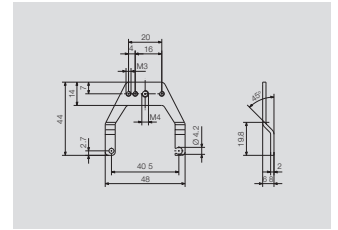

SHIELD LEVER 4 CSB 45°



Type	Size	Qty	Order No.
SHIELD LEVER 4 CSB 45°	4	1	1017050000

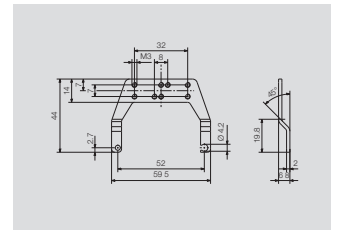

SHIELD LEVER 6 CSB 45°



Type	Size	Qty	Order No.
SHIELD LEVER 6 CSB 45°	6	1	1017060000

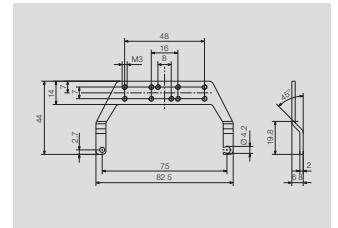

G

SHIELD LEVER 8 CSB 45°



Type	Size	Qty	Order No.
SHIELD LEVER 8 CSB 45°	8	1	1017070000

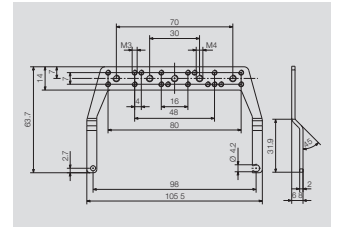

SHIELD LEVER 8 CSB 45°L



Type	Size	Qty	Order No.
SHIELD LEVER 8 CSB 45°L	8	1	1018760000

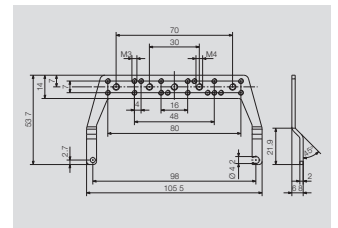

**Shield clamps for shield levers
of size 3 (06B), 4 (10B), 6 (16B) and 8 (24B)**

Technical data

Use	Clamps shield on the shield lever	
Fastening of shield lever	With supplied fastening accessories	
Clamping range shield clamp	Cable diameter mm	Gauge of fastening holes mm
Shield clamp 10 mm	10	20
Shield clamp 9 mm	9	20
Shield clamp 8 mm	8	20
Shield clamp 7 mm	7	20
Shield clamp 6 mm	6	16
Shield clamp 5 mm	5	16
Shield clamp 4.5 mm	4.5	16
Material	Steel	
Surface	Galvanized	
Temperature range	-40 °C ... +125 °C	

Shield clamps



Type	Qty	Order No.
SHIELD CLAMP 4.5 WO S	100	1018120000
SHIELD CLAMP 5 WO S	100	1018130000
SHIELD CLAMP 6 WO S	100	1018150000
SHIELD CLAMP 7 WO S	100	1018160000
SHIELD CLAMP 8 WO S	100	1018170000
SHIELD CLAMP 9 WO S	100	1018180000
SHIELD CLAMP 10 WO S	100	1018190000
SHIELD CLAMP 14 WO S	100	1041490000

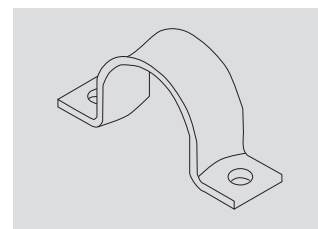

G

Shield contact clips with fitting materials



Type	Qty	Order No.
HDC SHIELD CLAMP 4.5	100	1912190000
HDC SHIELD CLAMP 5.0	100	1912200000
HDC SHIELD CLAMP 6.0	100	1912210000
HDC SHIELD CLAMP 7.0	100	1912220000
HDC SHIELD CLAMP 8.0	100	1912230000
HDC SHIELD CLAMP 9.0	100	1912240000
HDC SHIELD CLAMP 10.0	100	1912250000
HDC SHIELD CLAMP 14.0	1	1002820000

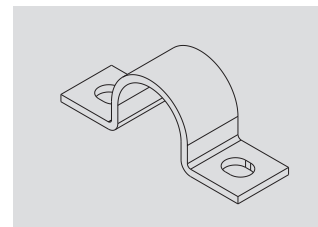

Other accessories

HDC GRIP PANEL 8 SC

Technical data

Use	To establish direct contact to bulkhead Fastened with integrated M5 screws
Advantages	Broad contact surface gives large-area contact Low contact resistance; high torsional rigidity Shield can be connected to grip panel

Material data Grip Panel 8 SC

Material	Steel
Surface	Galvanized
Temperature range	-40 °C to +125 °C

System data

Size	24B or 8 KLBÜ and shield clamps can be used Cable ties can be used for fixing cable
------	---

Grip panel



Type	Qty	Order No.
HDC GRIP PANEL 8 SC	5	1934770000

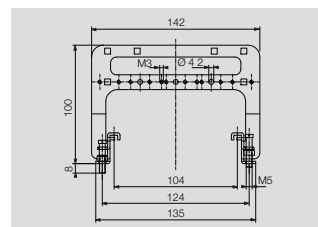

PE screws



Type	Qty	Order No.
HDC FIXING SCREW M3x10	50	1029510000
HDC PE CONCEPT SCREW M4	50	1029460000
HDC PE HD SCREW M4x6	50	1029440000
HDC PE HDD SCREW M4x6.5	50	1029450000
HDC PE HSB SCREW M5x6.8	50	1029490000
HDC PE S SCREW M5x8	50	1029470000
HDC PE S6/6 SCREW M4x8	50	1029520000