

MC 1,5/10-G-3,81 P26 THR

Order No.: 1722066

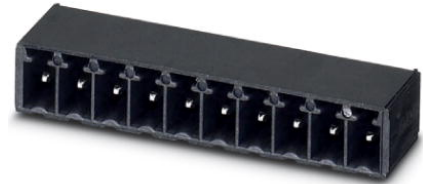

<http://eshop.phoenixcontact.co.uk/phoenix/treeViewClick.do?UID=1722066>

Header, Nominal current: 8 A, Number of positions: 10, Pitch: 3.81 mm, Color: Black, Contact surface: Tin, Assembly: SMD/THT/THR

Commercial data

EAN	 4 046356 116985
Note	Made-to-order
Pack	50
Customs tariff	85366930
Product key	AAAECB
Country of Origin	DE
Catalog page information	Page 199 (CC-2011)

Product notes

WEEE/RoHS-compliant since:
19/12/2005



Please note that the data given here has been taken from the online catalog. For comprehensive information and data, please refer to the user documentation at <http://www.download.phoenixcontact.com>. The General Terms and Conditions of Use apply to Internet downloads.

Technical data

Dimensions / positions

Pitch	3.81 mm
Dimension a	34.29 mm
Number of positions	10

Technical data

Range of articles	MC 1,5/...-G-THR
Connection in acc. with standard	EN-VDE

Nominal current I_N	8 A
Nominal voltage U_N	160 V
Color	Black
Nominal voltage, UL/CUL Use Group B	300 V
Nominal current, UL/CUL Use Group B	8 A
Nominal voltage, UL/CUL Use Group D	300 V
Nominal current, UL/CUL Use Group D	8 A

Certificates

Certification CUL, UL

Drawings

Drilling plan/solder pad geometry

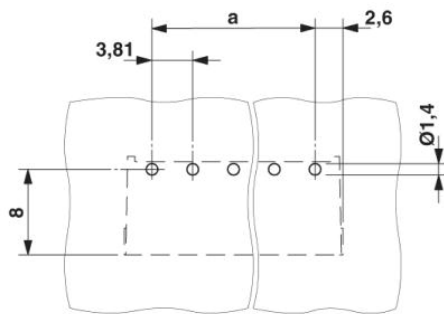

Dimensioned drawing

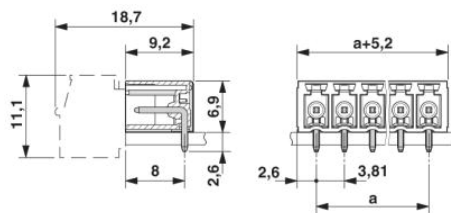

Address

PHOENIX CONTACT Ltd
Halesfield 13
Telford / Shropshire / TF7 4PG,England
Phone 01952 681 700
Fax 01952 681 799
<http://www.phoenixcontact.co.uk>



Phoenix Contact Ltd.
Technical modifications reserved;