

Part Number : **1903X00W**

Type	Size	IP Rating	Description
LED	M6	40	Recessed bezel panel indicator w/o resistor

Dimensions(mm):

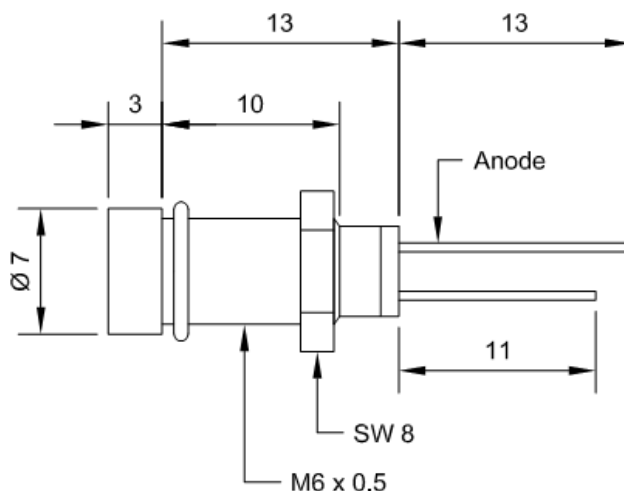

Part #	Colour	Voltage(V)	Current	Intensity(mcd nom)
1903X00W	Cool white	3.2Vdc	30mA max	1200@20mA

Notes:

1. Bezel codes : X=0(satin),1(black),or 2(matt) chrome
2. Storage temperature -25 °C to +80°C
3. Application temperature -20 °C to +60°C
4. Voltage tolerance  $\pm 10\%$
5. The plastic(polycarbonate) has limited chemical resistance
6. RoHS & REACH SVHC compliant

Issue # 1 : 13 Feb 12