

BL/SL 5.08 series
BLZ 5.08/12/270 SN BK BX

Weidmüller Interface GmbH & Co. KG
 Klingenbergstraße 16
 D-32758 Detmold
 Germany
 Fon: +49 5231 14-0
 Fax: +49 5231 14-2083
 www.weidmueller.com

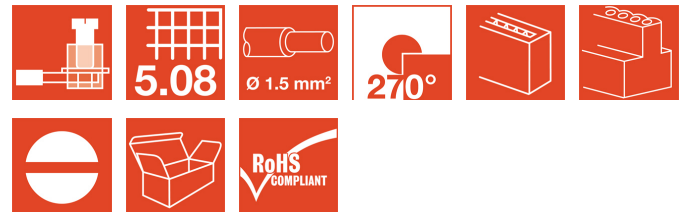

Female plugs with clamping-yoke screw connection. The female plugs provide space for labelling and can be coded.

- 0.2 - 2.5 mm² (IEC) / 26 - 12 AWG (UL)
- 400 V (IEC) / 300 V (UL)
- 15 A (IEC) / 10 A (UL)

General ordering data

Order No.	1558310000
Type	BLZ 5.08/12/270 SN BK BX
Version	PCB plug-in connector, female plug, No. of poles: 12, 270°, Clamping yoke connection, Clamping range, rated connection, max.: 3.31 mm ² , Box
Product data	IEC: 400 V / 15 A / 0.2 - 2.5 mm ² UL: 300 V / 10 A / AWG 26 - AWG 12
GTIN (EAN)	4008190269524
Qty.	30 pc(s).
Packaging	Box

Creation date March 13, 2012 10:37:45 AM CET

BL/SL 5.08 series
BLZ 5.08/12/270 SN BK BX

Weidmüller Interface GmbH & Co. KG
 Klingenbergstraße 16
 D-32758 Detmold
 Germany
 Fon: +49 5231 14-0
 Fax: +49 5231 14-2083
 www.weidmueller.com

Technical data**System parameters**

Product family	BL/SL 5.08 series	Conductor connection system	Clamping yoke connection
Outgoing direction of conductor	270°	Pitch in inches (P)	0.2 inch
No. of poles	12	Number of rows	1
Screwdriver blade		Screwdriver blade standard	DIN 5264, ISO 8764/2-PH, ISO 8764/2-PZ
	0.6 x 3.5	Tightening torque, max.	0.5 Nm
Tightening torque, min.	0.4 Nm	Stripping length	7 mm
Clamping screw	M 2.5	L1 in inches	2.2 inch
L1 in mm	55.88 mm		
Touch-safe protection acc. to DIN VDE 57 106	Safe from finger touch		

Material data

Insulating material	PBT	Colour	Black
Colour chart	Similar to RAL 9011	Flammability class UL 94	V-0
CTI	≥ 200	Contact material	Copper alloy
Contact surface	tinned	Continuous operating temp., min.	-25 °C
Continuous operating temp., max.	100 °C		

Connectable conductors

Clamping range, rated connection, min.	0.13 mm ²	Clamping range, rated connection, max.	3.31 mm ²
Wire connection cross section AWG, min.	AWG 26	Wire connection cross section AWG, max.	AWG 12
Solid, min. H05(07) V-U	0.2 mm ²	Solid, max. H05(07) V-U	2.5 mm ²
Flexible, min. H05(07) V-K	0.2 mm ²	Flexible, max. H05(07) V-K	2.5 mm ²
w. wire end ferrule, DIN 46228 pt 1, min.	0.2 mm ²	w. wire end ferrule, DIN 46228 pt 1, max.	2.5 mm ²
w. plastic collar ferrule, DIN 46228 pt 4, min.	0.2 mm ²	w. plastic collar ferrule, DIN 46228 pt 4, max.	2.5 mm ²
Plug gauge acc. to EN 60999 a x b; ø	2.8 mm x 2.0 mm; 2.4 mm		

DIN IEC rating data

Rated current, min. no. of poles (Tu=20°C)	15 A	Rated current, max. no. of poles (Tu=20°C)	12 A
Rated current, number of poles (Tu=40°C), min.	12 A	Rated current, number of poles (Tu=40°C), max.	10 A
Rated voltage for surge voltage class / pollution degree II/2	400 V	Rated voltage for surge voltage class / pollution degree III/2	320 V
Rated voltage for surge voltage class / pollution degree III/3	250 V	Rated impulse voltage for surge voltage class/ pollution degree II/2	4 kV
Rated impulse voltage for surge voltage class/ pollution degree III/2	4 kV	Rated impulse voltage for surge voltage class/ contamination degree III/3	4 kV
Short-time withstand current resistance	3 x 1s with 120 A		

CSA rating data

Institute (CSA)		Rated voltage (Use group B)	300 V
Rated current (use group B)	10 A	Rated voltage (use group D)	300 V
Rated current (use group D)	10 A	Wire cross-section, AWG, min.	AWG 26
Wire cross-section, AWG, max.	AWG 12		

BL/SL 5.08 series
BLZ 5.08/12/270 SN BK BX

Weidmüller Interface GmbH & Co. KG
 Klingenbergstraße 16
 D-32758 Detmold
 Germany
 Fon: +49 5231 14-0
 Fax: +49 5231 14-2083
 www.weidmueller.com

Technical data

UL 1059 rating data

Institute (UR)



Rated voltage (use group B)

300 V

Rated current (use group B)	10 A
Rated current (use group D)	10 A
Wire cross-section, AWG, max.	AWG 12

Rated voltage (use group D)	300 V
Wire cross-section, AWG, min.	AWG 26

Classifications

ETIM 3.0	EC001284	ETIM 4.0	EC002637
UNSPSC	30-21-18-10	eClass 4.1	27-26-07-01
eClass 5.1	27-26-07-04	eClass 6.0	27-26-07-04
eClass 7.0	27-44-04-02		

Notes

Notes

- Additional colours on request
- Gold-plated contact surfaces on request
- Rated current related to rated cross-section and min. No. of poles.
- Wire end ferrule without plastic collar to DIN 46228/1
- Wire end ferrule with plastic collar to DIN 46228/4
- P on drg. = pitch
- Rated data refer only to the component itself. Clearance and creepage distances to other components are to be designed in accordance with the relevant application standards.

Approvals

Approvals



Data sheet...

BL/SL 5.08 series
BLZ 5.08/12/270 SN BK BX

Weidmüller Interface GmbH & Co. KG
Klingenbergstraße 16
D-32758 Detmold
Germany
Fon: +49 5231 14-0
Fax: +49 5231 14-2083
www.weidmueller.com

Drawings

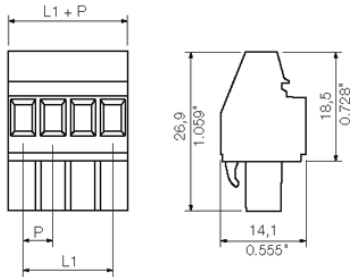

BL/SL 5.08 series
BLZ 5.08/12/270 SN BK BX

Weidmüller Interface GmbH & Co. KG

Klingenbergstraße 16

D-32758 Detmold

Germany

Fon: +49 5231 14-0

Fax: +49 5231 14-2083

www.weidmueller.com

Mating connector (fully pluggable)
SL 5.08/135

Male connectors with 135° outlet direction. The solder pin length is optimised for wave flow soldering. The pin headers provide space for labelling and can be coded.

- 400 V (IEC) / 300 V (UL)
- 17 A (IEC) / 15 A (UL)

General ordering data

Order No.	Type	Version	Product data	GTIN (EAN)	Qty.	Packaging
1603160000	SL 5.08/12/135 3.2SN OR BX	PCB plug-in connector, male header, open side, Solder connection, 5.08 mm, No. of poles: 12, 135°, Solder pin length (l): 3.2 mm, tinned, Orange, Box	IEC: 400 V / 17 A UL: 300 V / 15 A	4008190094638	50 pc(s).	Box

SL-SMT 5.08/180G Box

High-temperature-resistant male header, packed in box or tape. In tape with 1.5 mm solder pin optimised for automatic assembly. 3.2 mm solder pin suitable for reflow and wave soldering. These male connectors provide space for labelling and can be coded.

- 400 V (IEC) / 300 V (UL)
- 19 A (IEC) / 15 A (UL)

General ordering data

Order No.	Type	Version	Product data	GTIN (EAN)	Qty.	Packaging
1776022001	SL-SMT 5.08/12/180G 1.5SN BK BX	PCB plug-in connector, male header, closed side, Reflow solder connection, 5.08 mm, No. of poles: 12, 180°, Solder pin length (l): 1.5 mm, tinned, Box	IEC: 400 V / 19 A UL: 300 V / 15 A	4032248159017	50 pc(s).	Box
1838310000	SL-SMT 5.08/12/180G 3.2SN BK BX	PCB plug-in connector, male header, closed side, Reflow solder connection, 5.08 mm, No. of poles: 12, 180°, Solder pin length (l): 3.2 mm, tinned, Box	IEC: 400 V / 19 A UL: 300 V / 15 A	4032248348374	50 pc(s).	Box

**BL/SL 5.08 series
BLZ 5.08/12/270 SN BK BX**

Weidmüller Interface GmbH & Co. KG
Klingenbergstraße 16
D-32758 Detmold
Germany
Fon: +49 5231 14-0
Fax: +49 5231 14-2083
www.weidmueller.com

Mating connector (fully pluggable)
SLD 5.08/90G

2-tier male header with parallel pin arrangement. The solder pin length is optimised for wave flow soldering. The pin headers provide space for labelling and can be coded.

- 400 V (IEC) / 300 V (UL)
- 11 A (IEC) / 10 A (UL)

General ordering data

Order No.	Type	Version	Product data	GTIN (EAN)	Qty.	Packaging
1601890000	SLD 5.08/24/90G 3.2SN OR BX	PCB plug-in connector, male header, closed side, Solder connection, 5.08 mm, No. of poles: 24, 90°, Solder pin length (l): 3.2 mm, tinned, Orange, Box	IEC: 400 V / 11 A UL: 300 V / 10 A	4008190132835	10 pc(s).	Box

SL-SMT 5.08/90G Box

High-temperature-resistant male header, packed in box or tape. In tape with 1.5 mm solder pin optimised for automatic assembly. 3.2 mm solder pin suitable for reflow and wave soldering. These male connectors provide space for labelling and can be coded.

- 400 V (IEC) / 300 V (UL)
- 19 A (IEC) / 15 A (UL)

General ordering data

Order No.	Type	Version	Product data	GTIN (EAN)	Qty.	Packaging
1780280000	SL-SMT 5.08/12/90G 3.2SN BK BX	PCB plug-in connector, male header, closed side, Reflow solder connection, 5.08 mm, No. of poles: 12, 90°, Solder pin length (l): 3.2 mm, tinned, Black, Box	IEC: 400 V / 19 A UL: 300 V / 15 A	4032248165605	50 pc(s).	Box
1775102001	SL-SMT 5.08/12/90G 1.5SN BK BX	PCB plug-in connector, male header, closed side, Reflow solder connection, 5.08 mm, No. of poles: 12, 90°, Solder pin length (l): 1.5 mm, tinned, Black, Box	IEC: 400 V / 19 A UL: 300 V / 15 A	4032248156573	50 pc(s).	Box

**BL/SL 5.08 series
BLZ 5.08/12/270 SN BK BX**

Weidmüller Interface GmbH & Co. KG
 Klingenbergstraße 16
 D-32758 Detmold
 Germany
 Fon: +49 5231 14-0
 Fax: +49 5231 14-2083
 www.weidmueller.com

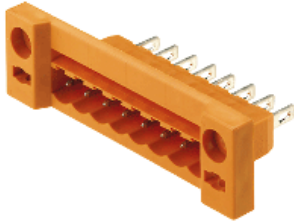
Mating connector (fully pluggable)
SLDF 5.08

Male connector for through-panel mounting with optional locking function. Internal connection as flat-blade or solder connection. These male connectors provide space for labelling and can be coded.

- 400 V (IEC) / 300 V (UL)
- 15 A (IEC) / 10 A (UL)

General ordering data

Order No.	Type	Version	Product data	GTIN (EAN)	Qty.	Packaging
1599230000	SLDF 5.08 L/F 12 SN OR BX	PCB plug-in connector, male header, 5.08 mm, No. of poles: 12, 180°, Box	IEC: 400 V / 15 A UL: 300 V / 10 A	4008190155100	50 pc(s).	Box

SL 5.08/90

Male connectors with 90° outlet direction. The solder pin length is optimised for wave flow soldering. The pin headers provide space for labelling and can be coded.

- 400 V (IEC) / 300 V (UL)
- 18 A (IEC) / 15 A (UL)

General ordering data

Order No.	Type	Version	Product data	GTIN (EAN)	Qty.	Packaging
1509060000	SL 5.08/12/90 3.2SN OR BX	PCB plug-in connector, male header, open side, Solder connection, 5.08 mm, No. of poles: 12, 90°, Solder pin length (l): 3.2 mm, tinned, Orange, Box	IEC: 400 V / 18 A UL: 300 V / 15 A	4008190105983	50 pc(s).	Box

**BL/SL 5.08 series
BLZ 5.08/12/270 SN BK BX**

Weidmüller Interface GmbH & Co. KG
 Klingenbergstraße 16
 D-32758 Detmold
 Germany
 Fon: +49 5231 14-0
 Fax: +49 5231 14-2083
 www.weidmueller.com

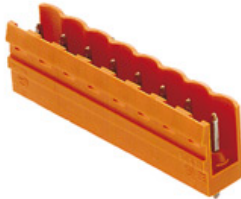
Mating connector (fully pluggable)
SL 5.08/180

Male connectors with straight outlet direction. The solder pin length is optimised for wave flow soldering. The pin headers provide space for labelling and can be coded.

- 400 V (IEC) / 300 V (UL)
- 18 A (IEC) / 15 A (UL)

General ordering data

Order No.	Type	Version	Product data	GTIN (EAN)	Qty.	Packaging
1518260000	SL 5.08/12/180 3.2 SN OR BX	PCB plug-in connector, male header, open side, Solder connection, 5.08 mm, No. of poles: 12, 180°, Solder pin length (l): 3.2 mm, tinned, Orange, Box	IEC: 400 V / 18 A UL: 300 V / 15 A	4008190070991	50 pc(s).	Box

SLD 5.08/180G

2-tier male header with parallel pin arrangement. The solder pin length is optimised for wave flow soldering. The pin headers provide space for labelling and can be coded.

- 400 V (IEC) / 300 V (UL)
- 11 A (IEC) / 10 A (UL)

General ordering data

Order No.	Type	Version	Product data	GTIN (EAN)	Qty.	Packaging
1602490000	SLD 5.08/24/180G 3.2SN OR BX	PCB plug-in connector, male header, closed side, Solder connection, 5.08 mm, No. of poles: 24, 180°, Solder pin length (l): 3.2 mm, tinned, Orange, Box	IEC: 400 V / 11 A UL: 300 V / 10 A	4008190183233	10 pc(s).	Box

BL/SL 5.08 series
BLZ 5.08/12/270 SN BK BX

Weidmüller Interface GmbH & Co. KG

Klingenbergstraße 16

D-32758 Detmold

Germany

Fon: +49 5231 14-0

Fax: +49 5231 14-2083

www.weidmueller.com

Mating connector (fully pluggable)
SL 5.00/90

Male connectors with 90° outlet direction. The solder pin length is optimised for wave flow soldering. The pin headers provide space for labelling and can be coded.

- 400 V (IEC) / 300 V (UL)
- 18 A (IEC) / 15 A (UL)

General ordering data

Order No.	Type	Version	Product data	GTIN (EAN)	Qty.	Packaging
1571110000	SL 5.00/12/90 3.2SN OR BX	PCB plug-in connector, male header, open side, Solder connection, 5.00 mm, No. of poles: 12, 90°, Solder pin length (l): 3.2 mm, tinned, Orange, Box	IEC: 400 V / 18 A UL: 300 V / 15 A	4008190140106	50 pc(s).	Box
1626080000	SL 5.00/12/90 4.5SN BK BX	PCB plug-in connector, male header, open side, Solder connection, 5.00 mm, No. of poles: 12, 90°, Solder pin length (l): 4.5 mm, tinned, Black, Box	IEC: 400 V / 18 A UL: 300 V / 15 A	4008190197384	50 pc(s).	Box

SL-SMT 5.08/180 Box

High-temperature-resistant, straight, open ended male header. Packed in box or tape. In tape with 1.5 mm solder pin optimised for automatic assembly. 3.2 mm solder pin suitable for reflow and wave soldering. These male connectors provide space for labelling and can be coded.

- 400 V (IEC) / 300 V (UL)
- 19 A (IEC) / 15 A (UL)

General ordering data

Order No.	Type	Version	Product data	GTIN (EAN)	Qty.	Packaging
1838080000	SL-SMT 5.08/12/180 3.2SN BK BX	PCB plug-in connector, male header, open side, Reflow solder connection, 5.08 mm, No. of poles: 12, 180°, Solder pin length (l): 3.2 mm, tinned, Box	IEC: 400 V / 19 A UL: 300 V / 15 A	4032248348145	50 pc(s).	Box
1775702001	SL-SMT 5.08/12/180 1.5SN BK BX	PCB plug-in connector, male header, open side, Reflow solder connection, 5.08 mm, No. of poles: 12, 180°, Solder	IEC: 400 V / 19 A UL: 300 V / 15 A	4032248158348	50 pc(s).	Box

**BL/SL 5.08 series
BLZ 5.08/12/270 SN BK BX**

Weidmüller Interface GmbH & Co. KG
 Klingenbergstraße 16
 D-32758 Detmold
 Germany
 Fon: +49 5231 14-0
 Fax: +49 5231 14-2083
 www.weidmueller.com

Mating connector (fully pluggable)

pin length (l): 1.5 mm, tinned,
 Box

SL-SMT 5.08/90 Box

High-temperature-resistant, 90° angled, open male header
 Packed in box or tape. In tape with 1.5 mm solder pin
 optimised for automatic assembly. 3.2 mm solder pin suitable
 for reflow and wave soldering. These male connectors provide
 space for labelling and can be coded.

- 400 V (IEC) / 300 V (UL)
- 19 A (IEC) / 15 A (UL)

General ordering data

Order No.	Type	Version	Product data	GTIN (EAN)	Qty.	Packaging
1774862001	SL-SMT 5.08/12/90 1.5SN BK BX	PCB plug-in connector, male header, open side, Reflow solder connection, 5.08 mm, No. of poles: 12, 90°, Solder pin length (l): 1.5 mm, tinned, Black, Box	IEC: 400 V / 19 A UL: 300 V / 15 A	4032248155903	50 pc(s).	Box
1780050000	SL-SMT 5.08/12/90 3.2SN BK BX	PCB plug-in connector, male header, open side, Reflow solder connection, 5.08 mm, No. of poles: 12, 90°, Solder pin length (l): 3.2 mm, tinned, Black, Box	IEC: 400 V / 19 A UL: 300 V / 15 A	4032248165377	50 pc(s).	Box

**BL/SL 5.08 series
BLZ 5.08/12/270 SN BK BX**

Weidmüller Interface GmbH & Co. KG
 Klingenbergstraße 16
 D-32758 Detmold
 Germany
 Fon: +49 5231 14-0
 Fax: +49 5231 14-2083
 www.weidmueller.com

Mating connector (conditionally pluggable)
SLT 5.08B

Male plugs with screw TOP wire connection. The male plug provides space for labelling and can be coded.

- 0.2 - 2.5 mm² (IEC) / 26 - 14 AWG (UL)
- 400 V (IEC) / 300 V (UL)
- 16 A (IEC) / 10 A (UL)

General ordering data

Order No.	Type	Version	Product data	GTIN (EAN)	Qty.	Packaging
1611810000	SLT 5.08/12/180B SN OR BX	PCB plug-in connector, male plug, 5.08 mm, No. of poles: 12, 180°, TOP connection, Clamping range, rated connection, max.: 2.5 mm ² , Box	IEC: 400 V / 16 A / 0.2 - 2.5 mm ² UL: 300 V / 10 A / AWG 26 - AWG 14	4008190192693	50 pc(s).	Box

SLZF 5.08/180FI

Male plugs with tension-clamp wire connection. The male plugs provide space for labelling and can be coded.

- 0.2 - 2.5 mm² (IEC) / 26 - 14 AWG (UL)
- 400 V (IEC) / 300 V (UL)
- 23 A (IEC) / 15 A (UL)

General ordering data

Order No.	Type	Version	Product data	GTIN (EAN)	Qty.	Packaging
1846610000	SLZF 5.08/12/180FI SN OR BX	PCB plug-in connector, male plug, 5.08 mm, No. of poles: 12, 180°, Tension clamp connection, Clamping range, rated connection, max.: 3.31 mm ² , Box	IEC: 400 V / 23 A / 0.2 - 2.5 mm ² UL: 300 V / 15 A / AWG 26 - AWG 12	4032248362912	50 pc(s).	Box

BL/SL 5.08 series
BLZ 5.08/12/270 SN BK BX

Weidmüller Interface GmbH & Co. KG
 Klingenbergstraße 16
 D-32758 Detmold
 Germany
 Fon: +49 5231 14-0
 Fax: +49 5231 14-2083
 www.weidmueller.com

Mating connector (conditionally pluggable)
SL-SMT 5.08/180LF Box

High-temperature-resistant male header, packed in box or tape. In tape with 1.5 mm solder pin optimised for automatic assembly. 3.2 mm solder pin suitable for reflow and wave soldering. These male connectors provide space for labelling and can be coded.

- 400 V (IEC) / 300 V (UL)
- 19 A (IEC) / 15 A (UL)

General ordering data

Order No.	Type	Version	Product data	GTIN (EAN)	Qty.	Packaging
1838540000	SL-SMT 5.08/12/180LF 3.2SN BK BX	PCB plug-in connector, male header, Solder flange, Reflow solder connection, 5.08 mm, No. of poles: 12, 180°, Solder pin length (l): 3.2 mm, tinned, Black, Box	IEC: 400 V / 19 A UL: 300 V / 15 A	4032248348602	50 pc(s).	Box
1776462001	SL-SMT 5.08/12/180LF 1.5SN BK BX	PCB plug-in connector, male header, Solder flange, Reflow solder connection, 5.08 mm, No. of poles: 12, 180°, Solder pin length (l): 1.5 mm, tinned, Black, Box	IEC: 400 V / 19 A UL: 300 V / 15 A	4032248159345	50 pc(s).	Box

SLDV-THR 5.08/180F

High-temperature resistant, double level, laterally offset, male connector with flange or solder flange. 1.5 mm solder pin is suitable for reflow soldering. 3.2 mm solder pin suitable for reflow and wave soldering. The pin headers provide space for labelling and can be coded.

- 400 V (IEC) / 300 V (UL)
- 15 A (IEC) / 10 A (UL)

General ordering data

Order No.	Type	Version	Product data	GTIN (EAN)	Qty.	Packaging
1828990000	SLDV-THR 5.08/24/180F 1.5SN BK BX	PCB plug-in connector, male header, Flange, Reflow solder connection, 5.08 mm, No. of poles: 24, 180°, Solder pin length (l): 1.5 mm, tinned, Box	IEC: 400 V / 15 A UL: 300 V / 10 A	4032248335688	10 pc(s).	Box
1828870000	SLDV-THR 5.08/24/180F 3.2SN BK BX	PCB plug-in connector, male header, Flange, Reflow solder connection, 5.08 mm, No. of poles: 24, 180°, Solder pin length (l): 3.2 mm, tinned, Box	IEC: 400 V / 15 A UL: 300 V / 10 A	4032248335665	10 pc(s).	Box

**BL/SL 5.08 series
BLZ 5.08/12/270 SN BK BX**

Weidmüller Interface GmbH & Co. KG
Klingenbergstraße 16
D-32758 Detmold
Germany
Fon: +49 5231 14-0
Fax: +49 5231 14-2083
www.weidmueller.com

Mating connector (conditionally pluggable)
SLDV-THR 5.08/180FLF

High-temperature resistant, double level, laterally offset, male connector with flange or solder flange. 1.5 mm solder pin is suitable for reflow soldering. 3.2 mm solder pin suitable for reflow and wave soldering. The pin headers provide space for labelling and can be coded.

- 400 V (IEC) / 300 V (UL)
- 15 A (IEC) / 10 A (UL)

General ordering data

Order No.	Type	Version	Product data	GTIN (EAN)	Qty.	Packaging
1829230000	SLDV-THR 5.08/24/180FLF 1.5SN BK BX	PCB plug-in connector, male header, Flange / Solder flange, Reflow solder connection, 5.08 mm, No. of poles: 24, 180°, Solder pin length (l): 1.5 mm, tinned, Box	IEC: 400 V / 15 A UL: 300 V / 10 A	4032248335923	10 pc(s).	Box
1829110000	SLDV-THR 5.08/24/180FLF 3.2SN BK BX	PCB plug-in connector, male header, Flange / Solder flange, Reflow solder connection, 5.08 mm, No. of poles: 24, 180°, Solder pin length (l): 3.2 mm, tinned, Box	IEC: 400 V / 15 A UL: 300 V / 10 A	4032248335800	10 pc(s).	Box

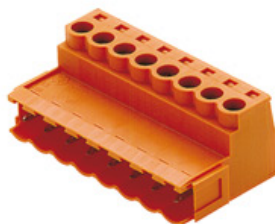
SLS 5.08/180B

Male plugs with clamping-yoke screw wire-connect system. The male plugs provide space for labelling and can be coded.

- 0.2 - 2.5 mm² (IEC) / 26 - 12 AWG (UL)
- 400 V (IEC) / 300 V (UL)
- 21.5 A (IEC) / 15 A (UL)

General ordering data

Order No.	Type	Version	Product data	GTIN (EAN)	Qty.	Packaging
1627340000	SLS 5.08/12/180B SN OR BX	PCB plug-in connector, male plug, 5.08 mm, No. of poles: 12, 180°, Clamping yoke connection, Clamping range, rated connection, max.: 3.31 mm ² , Box	IEC: 400 V / 21.5 A / AWG 26 - AWG 12 UL: 300 V / 15 A / AWG 26 - AWG 12	4008190199852	50 pc(s).	Box

**BL/SL 5.08 series
BLZ 5.08/12/270 SN BK BX**

Weidmüller Interface GmbH & Co. KG
Klingenbergstraße 16
D-32758 Detmold
Germany
Fon: +49 5231 14-0
Fax: +49 5231 14-2083
www.weidmueller.com

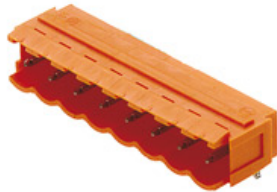
Mating connector (conditionally pluggable)
SL 5.00/90B

Male connectors with 90° outlet direction. The solder pin length is optimised for wave flow soldering. The pin headers provide space for labelling and can be coded.

- 400 V (IEC) / 300 V (UL)
- 18 A (IEC) / 15 A (UL)

General ordering data

Order No.	Type	Version	Product data	GTIN (EAN)	Qty.	Packaging
1580960000	SL 5.00/12/90B 3.2SN OR BX	PCB plug-in connector, male header, Dovetails for fixing blocks, Solder connection, 5.00 mm, No. of poles: 12, 90°, Solder pin length (l): 3.2 mm, tinned, Orange, Box	IEC: 400 V / 18 A UL: 300 V / 15 A	4008190071851	50 pc(s).	Box

SL-SMT 5.08/90F Box

High-temperature-resistant male header, packed in box or tape. In tape with 1.5 mm solder pin optimised for automatic assembly. 3.2 mm solder pin suitable for reflow and wave soldering. These male connectors provide space for labelling and can be coded.

- 400 V (IEC) / 300 V (UL)
- 19 A (IEC) / 15 A (UL)

General ordering data

Order No.	Type	Version	Product data	GTIN (EAN)	Qty.	Packaging
1837730000	SL-SMT 5.08/12/90F 3.2SN BK BX	PCB plug-in connector, male header, Flange, Reflow solder connection, 5.08 mm, No. of poles: 12, 90°, Solder pin length (l): 3.2 mm, tinned, Black, Box	IEC: 400 V / 19 A UL: 300 V / 15 A	4032248347544	50 pc(s).	Box

**BL/SL 5.08 series
BLZ 5.08/12/270 SN BK BX**

Weidmüller Interface GmbH & Co. KG
Klingenbergstraße 16
D-32758 Detmold
Germany
Fon: +49 5231 14-0
Fax: +49 5231 14-2083
www.weidmueller.com

Mating connector (conditionally pluggable)
SL-SMT 5.08/180F Box

High-temperature-resistant male header, packed in box or tape. In tape with 1.5 mm solder pin optimised for automatic assembly. 3.2 mm solder pin suitable for reflow and wave soldering. These male connectors provide space for labelling and can be coded.

- 400 V (IEC) / 300 V (UL)
- 19 A (IEC) / 15 A (UL)

General ordering data

Order No.	Type	Version	Product data	GTIN (EAN)	Qty.	Packaging
1820630000	SL-SMT 5.08/12/180F 3.2SN BK BX	PCB plug-in connector, male header, Flange, Reflow solder connection, 5.08 mm, No. of poles: 12, 180°, Solder pin length (l): 3.2 mm, tinned, Black, Box	IEC: 400 V / 19 A UL: 300 V / 15 A	4032248316595	50 pc(s).	Box

SL 5.08/180B

Male connectors with straight outlet direction. The solder pin length is optimised for wave flow soldering. The pin headers provide space for labelling and can be coded.

- 400 V (IEC) / 300 V (UL)
- 18 A (IEC) / 15 A (UL)

General ordering data

Order No.	Type	Version	Product data	GTIN (EAN)	Qty.	Packaging
1520560000	SL 5.08/12/180B 3.2 SN OR BX	PCB plug-in connector, male header, Dovetails for fixing blocks, Solder connection, 5.08 mm, No. of poles: 12, Solder pin length (l): 3.2 mm, tinned, Orange, Box	IEC: 400 V / 18 A UL: 300 V / 15 A	4008190169077	50 pc(s).	Box

**BL/SL 5.08 series
BLZ 5.08/12/270 SN BK BX**

Weidmüller Interface GmbH & Co. KG
Klingenbergstraße 16
D-32758 Detmold
Germany
Fon: +49 5231 14-0
Fax: +49 5231 14-2083
www.weidmueller.com

Mating connector (conditionally pluggable)
SLS 5.08TB KF35

Male plugs with clamping-yoke screw wire-connect system. With clip-on feet for attaching the male plugs on rail. The male plugs provide space for labelling and can be coded.

- 0.2 - 2.5 mm² (IEC) / 26 - 12 AWG (UL)
- 400 V (IEC) / 300 V (UL)
- 21.5 A (IEC) / 15 A (UL)

General ordering data

Order No.	Type	Version	Product data	GTIN (EAN)	Qty.	Packaging
1846170000	SLS 5.08/12/180TB KF SN OR BX	PCB plug-in connector, male plug, 5.08 mm, No. of poles: 12, 180°, Clamping yoke connection, Clamping range, rated connection, max.: 3.31 mm ² , Box	IEC: 400 V / 21.5 A / 0.2 - 2.5 mm ² UL: 300 V / 15 A / AWG 26 - AWG 12	4032248362455	10 pc(s).	Box

SL 5.08/90B

Male connectors with 90° outlet direction. The solder pin length is optimised for wave flow soldering. The pin headers provide space for labelling and can be coded.

- 400 V (IEC) / 300 V (UL)
- 18 A (IEC) / 15 A (UL)

General ordering data

Order No.	Type	Version	Product data	GTIN (EAN)	Qty.	Packaging
1511360000	SL 5.08/12/90B 3.2SN OR BX	PCB plug-in connector, male header, Dovetails for fixing blocks, Solder connection, 5.08 mm, No. of poles: 12, Solder pin length (l): 3.2 mm, tinned, Orange, Box	IEC: 400 V / 18 A UL: 300 V / 15 A	4008190015985	50 pc(s).	Box

**BL/SL 5.08 series
BLZ 5.08/12/270 SN BK BX**

Weidmüller Interface GmbH & Co. KG
Klingenbergstraße 16
D-32758 Detmold
Germany
Fon: +49 5231 14-0
Fax: +49 5231 14-2083
www.weidmueller.com

Mating connector (conditionally pluggable)
SLZF 5.08/180F

Male plugs with tension-clamp wire connection. The male plugs provide space for labelling and can be coded.

- 0.2 - 2.5 mm² (IEC) / 26 - 14 AWG (UL)
- 400 V (IEC) / 300 V (UL)
- 23 A (IEC) / 15 A (UL)

General ordering data

Order No.	Type	Version	Product data	GTIN (EAN)	Qty.	Packaging
1847080000	SLZF 5.08/12/180F SN OR BX	PCB plug-in connector, male plug, 5.08 mm, No. of poles: 12, 180°, Tension clamp connection, Clamping range, rated connection, max.: 3.31 mm ² , Box	IEC: 400 V / 23 A / 0.2 - 2.5 mm ² UL: 300 V / 15 A / AWG 26 - AWG 12	4032248363216	50 pc(s).	Box

SL-SMT 5.08/90LF Box

High-temperature-resistant male header, packed in box or tape. In tape with 1.5 mm solder pin optimised for automatic assembly. 3.2 mm solder pin suitable for reflow and wave soldering. These male connectors provide space for labelling and can be coded.

- 400 V (IEC) / 300 V (UL)
- 19 A (IEC) / 15 A (UL)

General ordering data

Order No.	Type	Version	Product data	GTIN (EAN)	Qty.	Packaging
1775332001	SL-SMT 5.08/12/90LF 1.5SN BK BX	PCB plug-in connector, male header, Solder flange, Reflow solder connection, 5.08 mm, No. of poles: 12, 90°, Solder pin length (l): 1.5 mm, tinned, Black, Box	IEC: 400 V / 19 A UL: 300 V / 15 A	4032248157310	50 pc(s).	Box
1780510000	SL-SMT 5.08/12/90LF 3.2SN BK BX	PCB plug-in connector, male header, Solder flange, Reflow solder connection, 5.08 mm, No. of poles: 12, 90°, Solder pin length (l): 3.2 mm, tinned, Black, Box	IEC: 400 V / 19 A UL: 300 V / 15 A	4032248165834	50 pc(s).	Box

**BL/SL 5.08 series
BLZ 5.08/12/270 SN BK BX**

Weidmüller Interface GmbH & Co. KG
Klingenbergstraße 16
D-32758 Detmold
Germany
Fon: +49 5231 14-0
Fax: +49 5231 14-2083
www.weidmueller.com

Mating connector (conditionally pluggable)
SLZF 5.08/90B

Male plugs with tension-clamp wire connection. The male plugs provide space for labelling and can be coded.

- 0.2 - 2.5 mm² (IEC) / 26 - 14 AWG (UL)
- 400 V (IEC) / 300 V (UL)
- 23 A (IEC) / 15 A (UL)

General ordering data

Order No.	Type	Version	Product data	GTIN (EAN)	Qty.	Packaging
1673650000	SLZF 5.08/12/90B SN OR BX	PCB plug-in connector, male plug, 5.08 mm, No. of poles: 12, 90°, Tension clamp connection, Clamping range, rated connection, max.: 3.31 mm ² , Box	IEC: 400 V / 20.5 A / 0.2 - 2.5 mm ² UL: 300 V / 15 A / AWG 26 - AWG 12	4008190435363	50 pc(s).	Box

SLS 5.08/180F

Male plugs with clamping-yoke screw wire-connect system. The male plugs provide space for labelling and can be coded.

- 0.2 - 2.5 mm² (IEC) / 26 - 12 AWG (UL)
- 400 V (IEC) / 300 V (UL)
- 21.5 A (IEC) / 15 A (UL)

General ordering data

Order No.	Type	Version	Product data	GTIN (EAN)	Qty.	Packaging
1846460000	SLS 5.08/12/180F SN OR BX	PCB plug-in connector, male plug, 5.08 mm, No. of poles: 12, 180°, Clamping yoke connection, Clamping range, rated connection, max.: 3.31 mm ² , Box	IEC: 400 V / 21.5 A / 0.2 - 2.5 mm ² UL: 300 V / 15 A / AWG 26 - AWG 12	4032248362769	50 pc(s).	Box

**BL/SL 5.08 series
BLZ 5.08/12/270 SN BK BX**

Weidmüller Interface GmbH & Co. KG
Klingenbergstraße 16
D-32758 Detmold
Germany
Fon: +49 5231 14-0
Fax: +49 5231 14-2083
www.weidmueller.com

Mating connector (conditionally pluggable)
SLZF 5.08/180B

Male plugs with tension-clamp wire connection. The male plugs provide space for labelling and can be coded.

- 0.2 - 2.5 mm² (IEC) / 26 - 14 AWG (UL)
- 400 V (IEC) / 300 V (UL)
- 23 A (IEC) / 15 A (UL)

General ordering data

Order No.	Type	Version	Product data	GTIN (EAN)	Qty.	Packaging
1710310000	SLZF 5.08/12/180B SN OR BX	PCB plug-in connector, male plug, 5.08 mm, No. of poles: 12, 180°, Tension clamp connection, Clamping range, rated connection, max.: 3.31 mm ² , Box	IEC: 400 V / 23 A / 0.2 - 2.5 mm ² UL: 300 V / 15 A / AWG 26 - AWG 12	4008190319625	50 pc(s).	Box

SLZF 5.08/270B

Male plugs with tension-clamp wire connection. The male plugs provide space for labelling and can be coded.

- 0.2 - 2.5 mm² (IEC) / 26 - 14 AWG (UL)
- 400 V (IEC) / 300 V (UL)
- 23 A (IEC) / 15 A (UL)

General ordering data

Order No.	Type	Version	Product data	GTIN (EAN)	Qty.	Packaging
1706240000	SLZF 5.08/12/270B SN OR BX	PCB plug-in connector, male plug, 5.08 mm, No. of poles: 12, 270°, Tension clamp connection, Clamping range, rated connection, max.: 3.31 mm ² , Box	IEC: 400 V / 20.5 A / 0.2 - 2.5 mm ² UL: 300 V / 15 A / AWG 26 - AWG 12	4032248197736	50 pc(s).	Box

**BL/SL 5.08 series
BLZ 5.08/12/270 SN BK BX**

Weidmüller Interface GmbH & Co. KG
Klingenbergstraße 16
D-32758 Detmold
Germany
Fon: +49 5231 14-0
Fax: +49 5231 14-2083
www.weidmueller.com

Mating connector (conditionally pluggable)
SL-SMT 5.00/90LF Box

High-temperature-resistant male header, packed in box or tape. In tape with 1.5 mm solder pin optimised for automatic assembly. 3.2 mm solder pin suitable for reflow and wave soldering. These male connectors provide space for labelling and can be coded.

- 400 V (IEC) / 300 V (UL)
- 19 A (IEC) / 15 A (UL)

General ordering data

Order No.	Type	Version	Product data	GTIN (EAN)	Qty.	Packaging
1797330000	SL-SMT 5.00/12/90LF 1.5SN BK BX	PCB plug-in connector, male header, Solder flange, Reflow solder connection, 5.00 mm, No. of poles: 12, 90°, Solder pin length (l): 1.5 mm, tinned, Box	IEC: 400 V / 19 A UL: 300 V / 15 A	4032248238118	50 pc(s).	Box
1840450000	SL-SMT 5.00/12/90LF 3.2SN BK BX	PCB plug-in connector, male header, Solder flange, Reflow solder connection, 5.00 mm, No. of poles: 12, 90°, Solder pin length (l): 3.2 mm, tinned, Box	IEC: 400 V / 19 A UL: 300 V / 15 A	4032248351299	50 pc(s).	Box

SL 5.08/135B

Male connectors with 135° outlet direction. The solder pin length is optimised for wave flow soldering. The pin headers provide space for labelling and can be coded.

- 400 V (IEC) / 300 V (UL)
- 17 A (IEC) / 15 A (UL)

General ordering data

Order No.	Type	Version	Product data	GTIN (EAN)	Qty.	Packaging
1605630000	SL 5.08/12/135B 3.2SN OR BX	PCB plug-in connector, male header, Dovetails for fixing blocks, Solder connection, 5.08 mm, No. of poles: 12, 135°, Solder pin length (l): 3.2 mm, tinned, Orange, Box	IEC: 400 V / 17 A UL: 300 V / 15 A	4008190068738	50 pc(s).	Box

BL/SL 5.08 series
BLZ 5.08/12/270 SN BK BX

Weidmüller Interface GmbH & Co. KG
 Klingenbergstraße 16
 D-32758 Detmold
 Germany
 Fon: +49 5231 14-0
 Fax: +49 5231 14-2083
 www.weidmueller.com

Mating connector (conditionally pluggable)

SLS 5.08TB RF15



Male plugs with clamping-yoke screw wire-connect system. With clip-on feet for attaching the male plugs on rail. The male plugs provide space for labelling and can be coded.

- 0.2 - 2.5 mm² (IEC) / 26 - 12 AWG (UL)
- 400 V (IEC) / 300 V (UL)
- 21.5 A (IEC) / 15 A (UL)

General ordering data

Order No.	Type	Version	Product data	GTIN (EAN)	Qty.	Packaging
1846090000	SLS 5.08/12/180TB RF15 SN OR BX	PCB plug-in connector, male plug, 5.08 mm, No. of poles: 12, 180°, Clamping yoke connection, Clamping range, rated connection, max.: 3.31 mm ² , Box	IEC: 400 V / 21.5 A / 0.2 - 2.5 mm ² UL: 300 V / 15 A / AWG 26 - AWG 12	4032248362370	10 pc(s).	Box

SLS 5.08/180FI



Male plugs with clamping-yoke screw wire-connect system. The male plugs provide space for labelling and can be coded.

- 0.2 - 2.5 mm² (IEC) / 26 - 12 AWG (UL)
- 400 V (IEC) / 300 V (UL)
- 21.5 A (IEC) / 15 A (UL)

General ordering data

Order No.	Type	Version	Product data	GTIN (EAN)	Qty.	Packaging
1846310000	SLS 5.08/12/180FI SN OR BX	PCB plug-in connector, male plug, 5.08 mm, No. of poles: 12, 180°, Clamping yoke connection, Clamping range, rated connection, max.: 3.31 mm ² , Box	IEC: 400 V / 21.5 A / 0.2 - 2.5 mm ² UL: 300 V / 15 A / AWG 26 - AWG 12	4032248362592	50 pc(s).	Box

