

LEDs, 9 mm and 15 mm Base

(Tower LEDs)



Features:

- Ultra-energy-efficient replacement for incandescent auto lamps
- 40,000 hours average lifetime : Less maintenance
- No mercury
- Consumes as low as 3.6 W power
- BA9S, BA15S, BAY15D, BA15D bases available
- No UV, IR

Applications:

- Tail light
- Instrument light
- Dome light
- Under hood light

BA9S Base, 6 LEDs

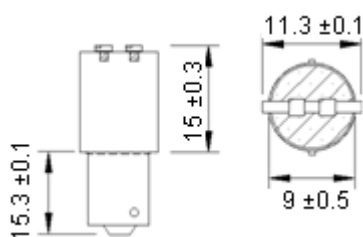

Dimensions : Millimetres

Designed as a replacement of traditional auto bulbs

Specification Table

CCT / Colour	Voltage	LED Quantity	CRI	Watts (Typical)	Lumens (Typical)	Part Number
Cool White 6,000 to 7,000 K	10 to 16 V dc	6	-	0.5	42	MC9S6SSTP12DCW
Warm White 2,800 to 3,200 K	10 to 16 V dc	6	-	0.5	35	MC9S6SSTP12DWW

18 LEDs, SMD5050

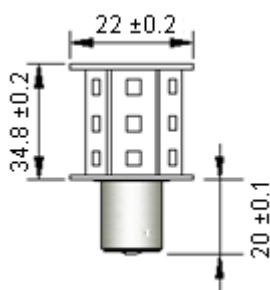

Dimensions : Millimetres

Features:

- Ultra-energy-efficient replacement for incandescent auto lamps
- 40,000 hours average lifetime : Less maintenance
- No mercury
- Consumes as low as 3.6 W power
- BA15S, BAY15D, BA15D bases available
- No UV, IR

LEDs, 9 mm and 15 mm Base

(Tower LEDs)



Applications:

- Tail light
- Instrument light
- Dome light
- Under hood light

The use of these LEDs as a light source in navigation fixtures has not been evaluated for compliance to USCG, COLREG, or any other navigational lighting standards or regulations

Cool White is recommended behind clear lenses due to its higher luminous output. Warm white is recommended where a more pleasing light to the eye is desired. Because LEDs have a narrow spectrum the colour of the LED should match the colour of the lens

Specifications:

Fits Socket	: BA15S (Single contact) BAY15D (double contact, offset pins) BA15D (double contact)
Dimensions	: 0.88 inches (22 mm) Diameter × 1.36 inches (34 mm) + Socket
Input Voltage	: 10 to 30 V dc
LED Type / Quantity	: 18 × SMD
Beam Angle	: 120° (five directions) 360° pattern

Specification Table

Base	CCT / Colour	Voltage	LED Quantity	CRI	Watts (Typical)	Lumens (Typical)	Part Number
BA15S	Cool White 6,000 to 7,000 K	10 to 30 V dc	18	-	3	250	MC15S18BS30DCW
BA15S	Warm White 2,800 to 3,200 K	10 to 30 V dc	18	-	3.2	212	MC15S18BS30DWW
BA15S	Red	10 to 30 V dc	18	-	2.52	-	MC15S18BS30DRD
BA15S	Green	10 to 30 V dc	18	-	3.2	-	MC15S18BS30DGN
BAY15D	Cool White 6,000 to 7,000 K	10 to 30 V dc	18	-	3.2	266	MCY15D18BS30DCW
BAY15D	Warm White 2,800 to 3,200 K	10 to 30 V dc	18	-	3.2	231	MCY15D18BS30DWW
BAY15D	Red	10 to 30 V dc	18	-	2.52	-	MCY15D18BS30DRD
BAY15D	Green	10 to 30 V dc	18	-	3.2	-	MCY15D18BS30DGN
BA15D	Cool White 6,000 to 7,000 K	10 to 30 V dc	18	-	3.2	266	MC15D18BS30DCW
BA15D	Warm White 2,800 to 3,200 K	10 to 30 V dc	18	-	3.2	231	MC15D18BS30DWW
BA15D	Red	10 to 30 V dc	18	-	2.52	-	MC15D18BS30DRD
BA15D	Green	10 to 30 V dc	18	-	3.2	-	MC15D18BS30DGN

Ideal for wall appliques and table lamps which use the # 1142 double-contact BA15D bayonet bulbs (non indexed level side pins). Check available space dimensions

Testing of Navigation lights for certification is done with the bulb in the fixture. The purchaser assumes all liability for the use of these bulbs when using them as a replacement for the original approved light source

LEDs, 9 mm and 15 mm Base

(Tower LEDs)



60 LEDs, 15mm

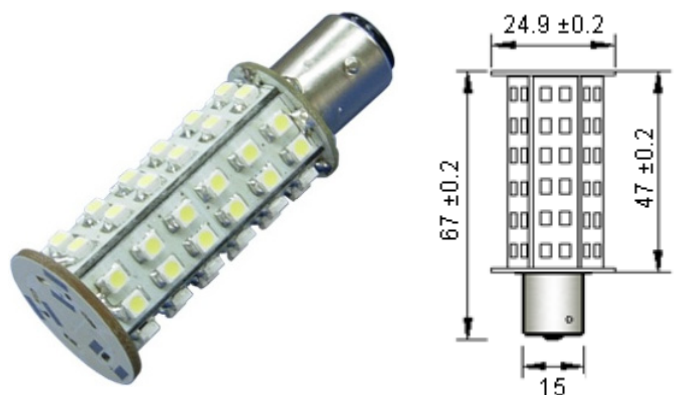

Dimensions : Millimetres

Specifications:

Fits Socket	: BA15S (Single contact) BAY15D (double contact, offset pins) BA15D (double contact)
Dimensions	: 0.88 inches (22 mm) Diameter × 1.36 inches (47 mm) + Socket (67 mm total length)
Input Voltage	: 10 to 30 V dc
LED Type / Quantity	: 18 × SMD
Beam Angle	: 120° (five directions) 360° pattern

The use of these LEDs as a light source in navigation fixtures has not been evaluated for compliance to USCG, COLREG, or any other navigational lighting standards or regulations

Cool White is recommended behind clear lenses due to its higher luminous output. Warm white is recommended where a more pleasing light to the eye is desired. Because LEDs have a narrow spectrum the colour of the LED should match the colour of the lens

Specification Table

Base	CCT / Colour	Voltage	LED Quantity	CRI	Watts (Typical)	Lumens (Typical)	Part Number
BA15S	Cool White 6,000 to 7,000 K	10 to 30 V dc	60	-	5	420	MC15S60SS30DCW
BA15S	Warm White 2,800 to 3,200 K	10 to 30 V dc	60	-	5	300	MC15S60SS30DWW
BAY15D	Cool White 6,000 to 7,000 K	10 to 30 V dc	60	-	5	420	MCY15D60SS30DCW
BAY15D	Warm White 2,800 to 3,200 K	10 to 30 V dc	60	-	5	300	MCY15D60SS30DWW
BA15D	Cool White 6,000 to 7,000 K	10 to 30 V dc	60	-	5.1	450	MC15D60SS30DCW
BA15D	Warm White 2,800 to 3,200 K	10 to 30 V dc	60	-	5.1	413	MC15D60SS30DWW

Testing of Navigation lights for certification is done with the bulb in the fixture. The purchaser assumes all liability for the use of these bulbs when using them as a replacement for the original approved light source

Important Notice : This data sheet and its contents (the "Information") belong to the members of the Premier Farnell group of companies (the "Group") or are licensed to it. No licence is granted for the use of it other than for information purposes in connection with the products to which it relates. No licence of any intellectual property rights is granted. The Information is subject to change without notice and replaces all data sheets previously supplied. The Information supplied is believed to be accurate but the Group assumes no responsibility for its accuracy or completeness, any error in or omission from it or for any use made of it. Users of this data sheet should check for themselves the Information and the suitability of the products for their purpose and not make any assumptions based on information included or omitted. Liability for loss or damage resulting from any reliance on the Information or use of it (including liability resulting from negligence or where the Group was aware of the possibility of such loss or damage arising) is excluded. This will not operate to limit or restrict the Group's liability for death or personal injury resulting from its negligence. Multicomp is the registered trademark of the Group. © Premier Farnell plc 2012.