

In This Section...

Sta-Kon® Terminal Products and Tools



Terminals	
Overview	C2-C5
Nylon Insulated Ring	C6-C8
Vinyl Insulated Ring	C9
Non-Insulated Ring	C10-C11
Heavy-Duty Ring	C12
High Temperature Non-Insulated	C13
TEFZEL® Insulated Ring	C13
Rectangular Rings	C14
Flag Terminals	C15
Fork Terminals	
Nylon Insulated Fork	C16
Vinyl Insulated Fork	C17
Non-Insulated Fork	C18
Locking Fork Terminals	
Nylon Insulated Fork	C18
Vinyl Insulated Fork	C19
Heat-Shrinkable Fork	C20
Non-Insulated Fork	C20
Pin Terminals	C20
Insulated Ferrules	C21-C22
Non-Insulated Ferrules	C23
Heat-Shrinkable Terminals, Splices, Disconnects	C24-C25
Splice Connectors	C26-C27
Disconnects	
Female (250 Series)	C28
Piggy Back (250 Series)	C29
Female (187 Series)	C29
Male (250 Series)	C30
Male (187 Series and 110 Series)	C30
250 Series Adapters and Coupler	C30
Wristlock Disconnects	C31
Male (110 Series)	C31
Pin Terminals/Vinyl Terminals (Mini-Pack)	C31
Wire Joints – Nylon Insulated	C32
Installation Kits	C33
Application Tools	
Sta-Kon Wire Stripping/Cutting Tool	C33
Plier Tools	C34
Comfort Crimp	C35
Ratchet Hand Tools	C36-C38
Flag Type	C38
TBM60RS Short Handle	C38
Toggle Type	C39
Shure-Stake® Auto Feed	C40
Battery-Powered Crimping	C41
Air Operated	C42
Air Hydraulic	C42-43
Electric Hydraulic Pump	C44
Twelve Ton Crimping	C44-45
Installation Dies	C45
Tool Charts	C46-C48
Stud Size and Clearance Hole Chart	C48
Wire Guide Tables	C49-C51
Military Cross Reference	C52
Cross Reference for Packaging	C54

Sta-Kon® Terminal Products and Tools

Thomas & Betts

United States
Tel: 901.252.8000
Fax: 901.252.1354

Canada
Tel: 450.347.5318
Fax: 450.347.1976

Technical Services
Tel: 888.862.3289

www.tnb.com

Overview — Why Sta-Kon® Terminals Are Better

Experience the Sta-Kon® advantage!

Thomas & Betts developed the first tool-applied solderless terminals and connectors more than 60 years ago in response to industry awareness of the need for better performance of electrical systems.

Deep Internal Serrations

After the insertion of a wire into the terminal's barrel, a deep, serrated interior ensures a large area of contact that lowers the resistance of a connection. With the mechanical force of the tool, the wire strands cold flow into the serrated interior. This guarantees electrical resistance lower than the wire to which it is applied. This feature also prevents pullout from vibration and mechanical strain. Deep internal serrations can be compared to the effective holding power of a well-treaded tire on a wet highway.

Chamfered/Funneled Terminal Barrel Entry

This feature makes wire insertion faster and easier. Chamfering eliminates wire strand "hang up" and departure upon insertion into the terminal's barrel. The loss of even a couple of wire strands can have negative results on electrical efficiency and resistance to mechanical strain.

Sta-Kon® Long Barrel Design

If lowering electrical resistance, preventing wire pullout, eliminating a "missed" crimp, and an insulator that stays on the barrel during installation are your goals, then you must design a terminal with a long barrel. Most competitive barrel lengths range from 20–50% shorter than Sta-Kon® terminals. The results are usually a stream of electrical failure, rework, and added expense. This also provides the insulator with additional surface area, holding tight to the barrel. Many competitive insulators come off during crimping due to a limited barrel length.

Brazed or Overlapped Seam

A long barrel design is of little value unless it is one solid piece. That is why Thomas & Betts brazes the seam on our vinyl insulated Sta-Kon® and overlaps the seam on nylon insulated terminals. Many competitive terminals have butted seams. This means increased chances for wirestrand loss, poor resistance, wire pullout, and electrical failure. If the installer doesn't position the tool exactly on the correct spot on the barrel, there's likely going to be an improper termination. The butted seam can also fold due to tool-applied pressure piercing the terminals insulation from the inside out. With a brazed or overlapped seam, the installer can crimp anywhere along the barrel's surface. This provides up to 2.5 times the tensile strength of a butted seam terminal, guaranteeing proper electrical flow, void free.

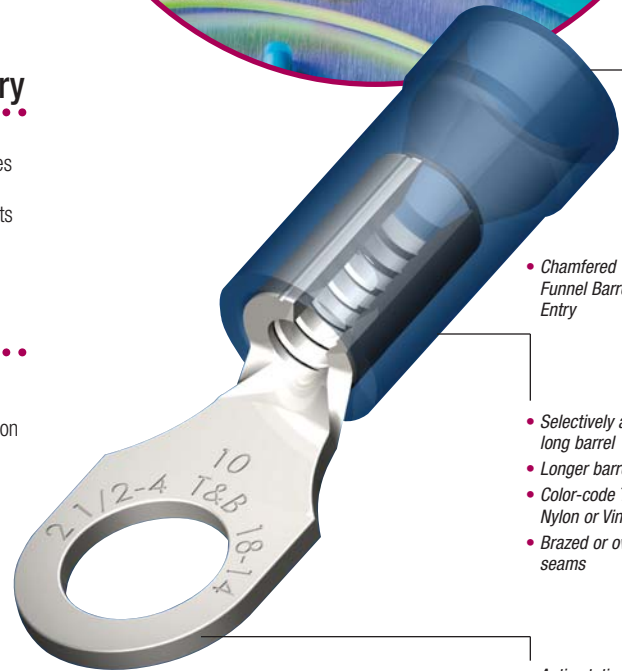

• Chamfered Funnel Barrel Entry

- Selectively annealed long barrel
- Longer barrel design
- Color-code Tefzel®, Nylon or Vinyl Insulators
- Brazed or overlapping seams

- Anti-rotational tongue
- Hardened tongue
- Complete wire and stud size identification



Strands enter as a homogeneous group and compact tightly under compression due to fully brazed seam

Overview — Why Sta-Kon® Terminals Are Better

Superior terminals for superior connections!

Selective Annealing

Because of the mechanical strength of copper, an installer can experience fatigue associated with repeated installations. For this reason, Thomas & Betts puts its terminals through one more step called selective annealing. This process leaves the barrel soft enough to crimp and form around the wire. However, we “cold form” the tongue during the manufacturing process so it remains strong. This is done so the tongue can withstand repeated bends and bolt tightening strain common in most electrical installations. Many competitors attempt to accomplish similar goals by removing valuable material or using a softer copper, which has lower conductivity. This increases electrical resistance as well as the odds for shorting and downtime.

Anti-Rotational Tongues

This is a unique feature to the Thomas & Betts ring tongue terminal. This design prevents terminal shorting by keeping the terminal secure in the terminal block. The installer can place a greater number of terminals closer together without worry.

Proper Identification

We identify all terminals with Thomas & Betts initials, T & B. We also indicate wire and stud sizes. These markings are clearly visible on the surface of the tongue, taking any guesswork out of replacing or reordering additional parts. Our superior bright plating also assists in visibility.

All Sta-Kon® Terminals Are Deburred and Degreased

To ensure a Sta-Kon® terminal is properly plated and insulated, all our parts are put through a process that cleans and smooths the terminal of any manufacturing by-products — mainly grease, oils, and sharp edges. Many competitive products do not put their product through such rigorous finishing.



- Deep Internal Serrations
- Flat bottom box
- Electro-tin plating
- Center reinforced spring detent for minimum insertion force
- Compound Spring Rails provide positive contact after repeated insertions

Platings/Finish

Electroplated-Tin is standard. All others require minimum order quantities and are generally not stocked. Alternative platings are as follows: Gold, Silver, Tin-Alloys, Nickel, etc.

The following finishes are available on most one-piece Sta-Kon® terminals:

FINISH	SUFFIX	SPEC.
Gold Plate	GP	MIL-G-45204 Type II, Grade B, C, D, Class O
Nickel Plate	NP	QQ-N-290 Class 2, Grade G
Plain Finish	PF	None
Silver Plate	SP	MIL-T-16366 Type I or II, 400° F, 204° C
Tin Plate	TP	MIL-T-10727 Type I

Listing

Sta-Kon® Rings, Fork, and Locking Forks are tested and listed to UL® 486A, two-way splices to UL 486C, disconnects to UL 310, and all applicable products to CSA 22.2.

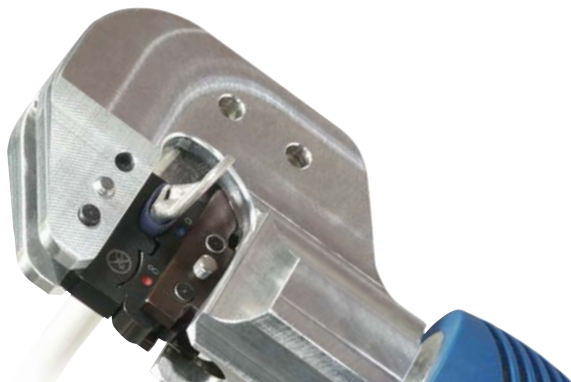

Sta-Kon Terminal Products and Tools

Overview — Sta-Kon® Terminals

Sta-Kon Terminal Products and Tools

The tools and terminals you need!

Sta-Kon® Ring, Fork, and Locking Fork

- Complete line of installing tools engineered to match tool with terminal
- First to gain military approval for pressure connections...many styles available for military applications
- Sta-Kon® products exceed test specification requirements of military, UL®, and CSA
- Tefzel® and Nylon Terminals provided with extra metal sleeve to grip insulation
- Vinyl insulated and bare Sta-Kon® terminals feature brazed seam wire barrels that can be crimped at any place on the barrel circumference



Sta-Kon® Disconnects

- Internal barrel serrations and long barrel provide for maximum tensile strength
- Complete line of installing tools, engineered to match tool with terminal
- Funnel entry insulators enable easier inserting of wire into barrel
- Color-coded for easy installation

The Sta-Kon® Terminal Numbering System

(Distributor Package 100/50 or Bulk "O.E.M." Packaged 1,000/500)

Common to Both Packages

- Letter **A** denotes 22–18 AWG wire range
- Letter **B** denotes 16–14 AWG wire range
- Letter **C** denotes 12–10 AWG wire range
- Letter **R** preceding the above letters indicates the terminal is insulated
- No letter **R**... no insulation ... no exception!

Distributor Packaged

Part numbers are very descriptive, indicating insulation and type, stud size, tongue style, and the largest maximum wire that can be put inside.

- If the letter **R** precedes the number the part is nylon insulated — **RA18-6**
- If the letter **R** follows the number the part is vinyl insulated — **14RB-8**

EXAMPLE: 10RC-8F

- C** – Indicates 12–10 AWG
- 10RC** – Vinyl Insulated
- 8** – Indicates stud size
- F** – Indicates a fork tongue terminal
- FL** – Indicates a locking fork

EXAMPLE: 2RA18X

- 2** – Indicates a 2-way or butt-style connector
- X** – Indicates expanded insulation

Tefzel® is a registered trademark of DuPont.



ERG-2001

The Shure-Stake® tools are matched to terminals.

The Shure-Stake® mechanism prevents the dies from releasing the terminal until the proper compression has been completed. With this method, an operator achieves a reliable crimp every time. Thomas & Betts tooling techniques correctly match tools, wire size, and terminal to produce optimum mechanical and electrical performance.

Overview — Sta-Kon® Terminals

Sta-Kon® Technical Data

TERMINALS & SPLICES INSULATION RATING	UL® 94 FLAMMABILITY	VOLTAGE	TEMPERATURE
Nylon	V-2	600V**	105° C
Vinyl	V-0	600V**	105° C
Tefzel®	V-0	600V**	150° C
**1000V fixture or sign			
Disconnects		300V	105° C
Non-Insulated	—	600V	150° C

Recommended Tools

The Shure-Stake® mechanism prevents the dies from releasing the terminal until the proper compression has been completed. With this method, an operator achieves a reliable crimp every time. Thomas & Betts tooling techniques correctly match tools, wire size, and terminal to produce optimum mechanical and electrical performance.

Plier type if installations are fewer than 20 per day



WT112M

Ratchet type if installations are more than 20 per day



ERG-2001

Power type if installations are more than 200 per day



12050

The proper installation procedure for the quality assured connection!

The proper installation of terminals, splices, and connectors is very important to the efficient performance of an electrical system. The properly installed connector will enable good conductivity through the termination. A poor termination results in a high-resistance connection. A poor connector installation may cause damage or failure of an entire system. Certain basic requirements must be met to make a good termination.

1. Before the connector or terminal is installed on the conductor, follow these recommended practices:
 - Strip the insulation carefully to avoid nicking or cutting conductor strands
 - Strip the insulation to the proper length so the conductors can be inserted fully into the connector barrel; the wire/cable should be visible in the inspection hole of the lug; the proper strip length can be found on **page C-??**.
2. Thomas & Betts wire strippers will help eliminate these problems by properly gauging and measuring the depth and length requirements for the conductor. See **page C-??** for wire strippers.

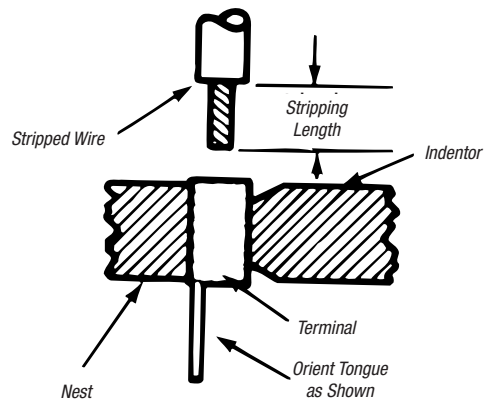

The terminal must be properly installed.

Installation Procedure

1. Train the wires to eliminate fanning of strands.
2. Open handles fully.
3. Insert terminal in proper die nest and locate it as shown above. When crimping a butt splice, position in proper die nest with window facing indentor.
4. Close handles slightly to secure terminal. Do not deform terminal.
5. Insert properly stripped wire into terminal.
6. Complete crimp by closing handles.

Nylon Insulated Ring Terminals

Recommended for temperatures up to 221° F.

Nylon Insulated Ring Terminals — Insulation Grip

- High dielectric-strength nylon sleeves
- Inner bronze insulation grip sleeve lengthens the flexing radius of the conductor and eliminates conductor creep

Stock thickness:

RZ & RAX stock thickness: .02
 RA & RB stock thickness: .03
 RC stock thickness: .04

The nylon jacket is color-coded:

Color Code	Wire Range
Yellow	26-22
Red	22-16
Blue	18-14
Yellow	12-10

Most standard bulk catalog numbers can be put on mylar tape for reel fed applications (i.e., tool and application dies). Add "M" to suffix for mylar tape (ex. RA2573M) Bulk numbers are 1,000 and 500 packages.

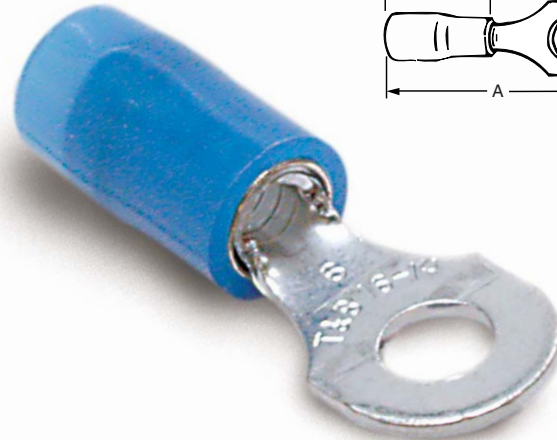
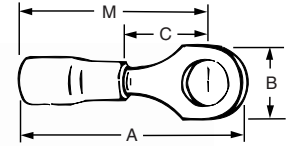

CAT. NO.	PKG. QTY.	WIRE RANGE	MAX. INS.	BOLT HOLE	WT./LBS. PER 1,000	DIMENSIONS			
						A	B	C	M
RZ22-2**	100	26-22	.083	#2	1	.57	.14	.13	.49
RZ22-4**	100	26-22	.083	#4	1	.65	.21	.20	.54
RZ22-6**	100	26-22	.083	#6	1	.65	.21	.20	.54
RZ22-8**	100	26-22	.083	#8	1	.75	.25	.23	.62
RZ22-10**	100	26-22	.083	#10	1	.75	.25	.23	.62
RAX23*	1,000	26-24	.125	#2	3	.66	.14	.14	.59
RAX43*	1,000	26-24	.125	#4	3	.74	.20	.19	.64
RAX63*	1,000	26-24	.125	#6	3	.84	.25	.22	.72
RAX83*	1,000	26-24	.125	#8	3	.84	.25	.22	.72
RAX103*	1,000	26-24	.125	#10	3	.84	.25	.24	.72
RA18-4	100	22-16	.136	#4	2	.70	.23	.14	.59
RA323	1,000	22-16	.136	#4	2	.70	.23	.14	.59
RA333	1,000	22-16	.136	#6	2	.70	.23	.14	.59
RA18-6	100	22-16	.136	#6	2	.83	.26	.25	.71
RA853	1,000	22-16	.136	#6	2	.83	.26	.25	.71
RA18-8	100	22-16	.136	#8	3	.83	.26	.25	.71
RA833	1,000	22-16	.136	#8	3	.83	.26	.25	.71
RA863	1,000	22-16	.136	#8	3	.83	.26	.25	.71
RA18-10	100	22-16	.136	#10	2	.86	.31	.25	.71
RA873	1,000	22-16	.136	#10	2	.86	.31	.25	.71
RA18-14	100	22-16	.136	1/4"	3	1.07	.46	.31	.84
RA713	1,000	22-16	.136	1/4"	3	1.07	.46	.31	.84
RA18-516	100	22-16	.136	5/16"	3	1.07	.46	.31	.84
RA723	1,000	22-16	.136	5/16"	3	1.07	.46	.31	.84
RA18-38	100	22-16	.136	3/8"	3	1.17	.53	.35	.87
RA733	1,000	22-16	.136	3/8"	3	1.17	.53	.35	.87
RA18-12	100	22-16	.136	1/2"	3	1.27	.72	.50	.92
RA753	1,000	22-16	.136	1/2"	3	1.27	.72	.50	.92
RB14-4	100	18-14	.162	#4	2 1/2	.72	.26	.14	.59
RB1323	1,000	18-14	.162	#4	2 1/2	.72	.26	.14	.59

* Not listed by UL® CSA ** CSA Listed only UL® Listed E9809

CAT. NO.	PKG. QTY.	WIRE RANGE	MAX. INS.	BOLT HOLE	WT./LBS. PER 1,000	DIMENSIONS			
						A	B	C	M
RB14-6	100	18-14	.162	#6	3	.89	.31	.25	.71
RB853	1,000	18-14	.162	#6	3	.89	.31	.25	.71
RB1333	1,000	18-14	.162	#6	3	.74	.26	.14	.59
RB14-8	100	18-14	.162	#8	3	.89	.31	.25	.71
RB863	1,000	18-14	.162	#8	3	.89	.31	.25	.71
RB14-10	100	18-14	.162	#10	3 1/2	.89	.31	.25	.71
RB873	1,000	18-14	.162	#10	3 1/2	.89	.31	.25	.71
RB14-14	100	18-14	.162	1/4"	3 1/2	1.08	.47	.31	.81
RB713	1,000	18-14	.162	1/4"	3 1/2	1.08	.47	.31	.81
RB14-516	100	18-14	.162	5/16"	3 1/2	1.08	.47	.31	.84
RB723	1,000	18-14	.162	5/16"	3 1/2	1.08	.47	.31	.84
RB14-38	100	18-14	.162	3/8"	3 1/2	1.17	.53	.35	.87
RB733	1,000	18-14	.162	3/8"	3 1/2	1.17	.53	.35	.87
RB14-12	100	18-14	.162	1/2"	4	1.25	.72	.50	.90
RB753	1,000	18-14	.162	1/2"	4	1.25	.72	.50	.90
RC10-6	50	12-10	.210	#6	3	1.00	.37	.27	.81
RC333	500	12-10	.210	#6	3	1.00	.37	.27	.81
RC10-8	50	12-10	.210	#8	5	1.00	.37	.27	.81
RC863	500	12-10	.210	#8	5	1.00	.37	.27	.81
RC10-10	50	12-10	.210	#10	5	1.00	.37	.27	.81
RC363	500	12-10	.210	#10	5	1.00	.37	.27	.81
RC10-14	50	12-10	.210	1/4"	6	1.12	.53	.32	.86
RC713	500	12-10	.210	1/4"	6	1.12	.53	.32	.86
RC10-516	50	12-10	.210	5/16"	6	1.21	.53	.31	.94
RC703	500	12-10	.210	5/16"	6	1.21	.53	.31	.94
RC10-38	50	12-10	.210	3/8"	6	1.27	.59	.35	.98
RC733	500	12-10	.210	3/8"	6	1.27	.59	.35	.98
RC10-12	50	12-10	.210	1/2"	6	1.37	.72	.52	1.02
RC753	500	12-10	.210	1/2"	6	1.37	.72	.52	1.02

Installation tools: WT2000, WT112M, WT145C, ERG-2001, ERG-2003, WT145A.

Installation tool: WT1452 is for RZ series only.

Nylon Insulated Ring Terminals

A wider wire entry to accommodate heavy-wall insulation.

Nylon Insulated Ring Terminals — Expanded Insulation Grip

- Ring terminals won't fall free even if the mounting screw loosens
- Suffix "X" indicates an expanded insulation grip

Most standard bulk catalog numbers can be put on mylar tape for reel fed applications (i.e., tool and application dies). Add "M" to suffix for mylar tape (ex. RA2573M) Bulk numbers are 1,000 and 500 packages.

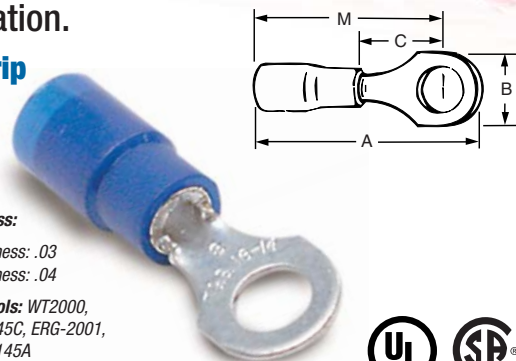

Stock thickness:

RB stock thickness: .03

RC stock thickness: .04

Installation tools: WT2000, WT112M, WT145C, ERG-2001, ERG-2003, WT145A



CAT. NO.	PKG. QTY.	WIRE RANGE	MAX. INS.	BOLT HOLE	WT./LBS. PER 1,000	DIMENSIONS			
						A	B	C	M
RB14-4X	100	18-14	.190	#4	4	.80	.26	.14	.67
RB1324	1,000	18-14	.190	#4	4	.80	.26	.14	.67
RB14-6X	100	18-14	.190	#6	4	.95	.31	.25	.79
RB854	1,000	18-14	.190	#6	4	.95	.31	.25	.79
RB14-8X	100	18-14	.190	#8	5	.95	.31	.25	.79
RB864	1,000	18-14	.190	#8	5	.95	.31	.25	.79
RB14-10X	100	18-14	.190	#10	5	.95	.31	.25	.79
RB874	1,000	18-14	.190	#10	5	.95	.31	.25	.79
RB14-14X	100	18-14	.190	1/4"	6	1.16	.47	.31	.92
RB714	1,000	18-14	.190	1/4"	6	1.16	.47	.31	.92
RB14-516X	100	18-14	.190	5/16"	6	1.16	.47	.31	.92
RB724	1,000	18-14	.190	5/16"	6	1.16	.47	.31	.92
RB14-38X	100	18-14	.190	3/8"	6	1.25	.53	.42	.95
RB734	1,000	18-14	.190	3/8"	6	1.25	.53	.42	.95

UL® Listed E9809

CAT. NO.	PKG. QTY.	WIRE RANGE	MAX. INS.	BOLT HOLE	WT./LBS. PER 1000	DIMENSIONS			
						A	B	C	M
RC10-6X	50	12-10	.250	#6	5	1.10	.37	.27	.91
RC334	500	12-10	.250	#6	5	1.10	.37	.27	.91
RC10-8X	50	12-10	.250	#8	5	1.10	.37	.27	.91
RC864	500	12-10	.250	#8	5	1.10	.37	.27	.91
RC10-10X	50	12-10	.250	#10	5	1.10	.37	.27	.91
RC364	500	12-10	.250	#10	5	1.10	.37	.27	.91
RC10-14X	50	12-10	.250	1/4"	6	1.22	.53	.32	.96
RC714	500	12-10	.250	1/4"	6	1.22	.53	.32	.96
RC10-516X	50	12-10	.250	5/16"	6	1.32	.53	.31	1.05
RC704	500	12-10	.250	5/16"	6	1.32	.53	.31	1.05
RC10-38X	50	12-10	.250	3/8"	6	1.38	.59	.48	1.09
RC734	500	12-10	.250	3/8"	6	1.38	.59	.48	1.09
RC10-12X	50	12-10	.250	1/2"	6	1.48	.72	.52	1.13

Heat-shrinkable polyolefin and an internally coated sealant offer more insulated support.

Heat-Shrinkable Ring Terminals — Expanded Insulation Support

- A fully sealed connection is achieved upon completed installation to protect the joint against the degrading effects of galvanic action, corrosion, and environmental exposure

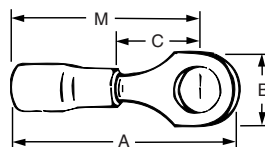

Stock thickness:

RAS & RBS stock thickness: .03

RCS stock thickness: .04

Installation tool: WT1255

CAT. NO.	PKG. QTY.	WIRE RANGE	MAX. INS.	BOLT HOLE	WT./LBS. PER 1,000	DIMENSIONS			
						A	B	C	M
RAS18-6X	100	22-18	.170	#6	2	1.23	.25	.27	1.10
RAS18-8X	100	22-18	.170	#8	3	1.26	.31	.27	1.10
RAS18-10X	100	22-18	.170	#10	2	1.26	.31	.27	1.10
RBS14-6X	100	16-14	.200	#6	3	1.23	.25	.27	1.10
RBS14-8X	100	16-14	.200	#8	3	1.23	.25	.27	1.10
RBS14-10X	100	16-14	.200	#10	3 1/2	1.26	.31	.27	1.10
RCS10-6X	50	12-10	.250	#6	3	1.34	.31	.27	1.15
RCS10-8X	50	12-10	.250	#8	5	1.34	.37	.27	1.15
RCS10-10X	50	12-10	.250	#10	5	1.34	.37	.27	1.15
RCS10-14X	50	12-10	.250	1/4"	6	1.34	.49	.32	1.15

UL® Listed E9809

NOTE: Not available on mylar tape.

Nylon-Insulated Ring Terminals

Nylon construction offers insulation from electrical dangers.

Nylon-Insulated Ring Terminals

- A wide variety of wire ranges to choose from to suit the right application



Stock Thickness:

RD: .04 RG: .05* RK: .06
 RE: .04 RH: .05 RL: .07
 RF: .04 RJ: .06 RM: .07

*Braze Seam, Lollipop-Style Tongue.

Installation Tools: TBM6/TBM6S, ERG-2007,
 (RD & RE except Braze Seam)

AN – Aircraft Wire. UL Listed E9809.

NOTE: Not available on Mylar Tape.

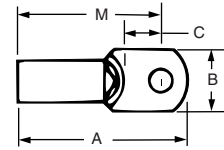

Sta-Kon Terminal Products and Tools

CAT. NO.	PKG. QTY.	WIRE RANGE	MAX. INS.	BOLT HOLE	WT./LBS. PER 1,000	DIMENSIONS			
						A	B	C	M
RD167	200	8	.340	#8	12	1.48	.42	.28	1.29
RD8-10	25	8	.340	#10	12	1.48	.42	.28	1.29
RD367	200	8	.340	#10	12	1.48	.42	.28	1.29
RD8-14	25	8	.340	1/4"	12	1.54	.46	.36	1.32
RD717	200	8	.340	1/4"	12	1.54	.46	.36	1.32
RD8-516	25	8	.340	5/16"	12	1.63	.57	.36	1.35
RD727	200	8	.340	5/16"	12	1.63	.57	.36	1.35
RD8-38	25	8	.340	3/8"	12	1.63	.57	.36	1.35
RD737	200	8	.340	3/8"	12	1.63	.57	.36	1.35
RD8-12	25	8	.310	1/2"	12	1.79	.82	.55	1.39
RD757*	200	8	.310	1/2"	12	1.79	.82	.55	1.39
RD10161	200	8AN	.270	#8	12	1.40	.41	.24	1.20
RD10361	200	8AN	.270	#10	12	1.40	.41	.24	1.20
RD10711	200	8AN	.270	1/4"	12	1.45	.45	.34	1.22
RD10721	200	8AN	.270	5/16"	12	1.53	.56	.34	1.25
RD10731	200	8AN	.270	3/8"	12	1.53	.56	.34	1.25
RE6-10	20	6	.420	#10	16	1.65	.49	.28	1.40
RE267	200	6	.420	#10	16	1.65	.49	.28	1.40
RE6-14	20	6	.420	1/4"	16	1.65	.49	.28	1.40
RE717	200	6	.420	1/4"	16	1.65	.49	.28	1.40
RE6-516	20	6	.420	5/16"	16	1.76	.61	.34	1.47
RE727	200	6	.420	5/16"	16	1.76	.61	.34	1.47
RE6-38	20	6	.420	3/8"	16	1.76	.61	.34	1.47
RE737	200	6	.420	3/8"	16	1.76	.61	.34	1.47
RE6-12	20	6	.395	1/2"	16	1.83	.82	.55	1.43
RE757*	200	6	.395	1/2"	16	1.83	.82	.55	1.43
RE10261	200	6AN	.315	#10	16	1.55	.49	.24	1.31
RE10711	200	6AN	.315	1/4"	16	1.55	.49	.27	1.31
RE10721	200	6AN	.315	5/16"	16	1.70	.60	.34	1.40
RE10731	200	6AN	.315	3/8"	16	1.70	.60	.34	1.40
RF4-10	15	4	.510	#10	21	1.76	.56	.36	1.49
RF267	200	4	.510	#10	21	1.76	.56	.36	1.49
RF4-14	15	4	.510	1/4"	21	1.76	.56	.36	1.49
RF717	200	4	.510	1/4"	21	1.76	.56	.36	1.49
RF4-516	15	4	.510	5/16"	21	1.84	.62	.35	1.53
RF727	200	4	.510	5/16"	21	1.84	.62	.35	1.53
RF4-38	15	4	.510	3/8"	23	1.84	.62	.35	1.53
RF737	200	4	.510	3/8"	23	1.84	.62	.35	1.53
RF757*	200	4	.500	1/2"	23	1.90	.82	.55	1.49
RF10261	200	4AN	.380	#10	26	1.78	.55	.30	1.51
RF10711	200	4AN	.380	1/4"	26	1.78	.55	.30	1.51
RF10721	200	4AN	.380	5/16"	26	1.80	.62	.34	1.49

CAT. NO.	PKG. QTY.	WIRE RANGE	MAX. INS.	BOLT HOLE	WT./LBS. PER 1,000	DIMENSIONS			
						A	B	C	M
RF10731	200	4AN	.380	1/4"	26	1.80	.62	.34	1.49
RG2-10	10	2	.588	#10	42	2.15	.69	.40	1.83
RG267	100	2	.588	#10	42	2.15	.69	.40	1.83
RG2-14	10	2	.588	1/4"	42	2.15	.69	.40	1.83
RG717	100	2	.588	1/4"	42	2.15	.69	.40	1.83
RG2-516	10	2	.588	5/16"	42	2.15	.69	.40	1.83
RG727	100	2	.588	5/16"	42	2.15	.69	.40	1.83
RG2-38	10	2	.588	3/8"	42	2.15	.69	.40	1.83
RG737	100	2	.588	3/8"	42	2.15	.69	.40	1.83
RG2-12	10	2	.588	1/2"	42	2.35	.80	.49	1.93
RG757	100	2	.588	1/2"	42	2.35	.80	.49	1.93
RG9711	100	1AN	.453	1/4"	48	2.07	.69	.40	1.74
RG9731	100	1AN	.453	5/16"	48	2.07	.69	.40	1.74
RG9751	100	1AN	.453	1/2"	48	2.26	.80	.49	1.84
RH9711	100	1AN	.500	1/4"	54	2.14	.77	.44	1.81
RH9731	100	1AN	.500	5/16"	54	2.14	.77	.44	1.81
RH9751	100	1AN	.500	1/2"	54	2.34	.77	.54	1.90
RJ9711	100	1/OAN	.550	1/4"	80	2.35	.83	.46	1.97
RJ9731	100	1/OAN	.550	5/16"	80	2.35	.83	.46	1.97
RJ9751	100	1/OAN	.550	1/2"	80	2.49	.89	.55	2.04
RH717	100	1/0	.629	1/4"	80	2.14	.77	.43	1.81
RH727	100	1/0	.629	5/16"	80	2.14	.77	.43	1.81
RH737	100	1/0	.629	3/8"	80	2.14	.77	.43	1.81
RH757	100	1/0	.629	1/2"	80	2.34	.77	.54	1.90
RK9731	100	2/OAN	.610	5/16"	70	2.52	.93	.55	2.14
RK9751	100	2/OAN	.610	1/2"	70	2.60	.93	.55	2.15
RJ717	100	2/0	.675	1/4"	80	2.34	.83	.46	1.96
RJ727	100	2/0	.675	5/16"	80	2.34	.83	.46	1.96
RJ737	100	2/0	.675	3/8"	80	2.34	.83	.46	1.96
RJ757	100	2/0	.675	1/2"	80	2.48	.89	.54	2.03
RL9731	100	3/OAN	.680	5/16"	120	2.83	1.04	.57	2.36
RL9751	100	3/OAN	.680	1/2"	120	2.83	1.04	.57	2.36
RK717	100	3/0	.765	1/4"	84	2.60	.93	.54	2.21
RK727	100	3/0	.765	5/16"	84	2.60	.93	.54	2.21
RK737	100	3/0	.765	3/8"	84	2.60	.93	.54	2.21
RM9731	100	4/OAN	.750	5/16"	160	3.00	1.13	.66	2.51
RM9751	100	4/OAN	.750	1/2"	160	3.00	1.13	.66	2.51
RL737	100	4/0	.785	5/16"	130	2.83	1.04	.57	2.35
RL757	100	4/0	.785	1/2"	130	2.83	1.04	.57	2.35
RM737	100	250MCM	.868	3/8"	130	3.00	1.13	.65	2.51
RM747	100	250MCM	.868	5/16"	130	3.00	1.13	.65	2.51
RM757	100	250MCM	.868	1/2"	130	3.00	1.13	.65	2.51

Vinyl-Insulated Ring Terminals

A wider wire entry for heavy-wall insulation.

Vinyl-Insulated Ring Terminals — Expanded Insulation Support



Stock thickness:

RA & RB: .03
RC: .04

- Ring terminals won't fall free even if the mounting screw loosens
- Suffix X indicates an expanded insulation support

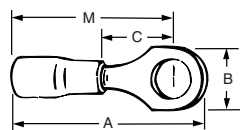

Most standard bulk catalog numbers can be put on mylar tape for reel-fed applications (i.e., tool and application dies).

Add "M" to suffix for mylar tape (ex. RA2573M). Bulk numbers are 1,000 and 500 packages.



CAT. NO.	PKG. QTY.	WIRE RANGE	MAX. INS.	BOLT HOLE	WT./LBS. PER 1,000	DIMENSIONS			
						A	B	C	M
18RA-6X	100	22-16	.170	#6	3	.97	.31	.27	.81
18RA-8X	100	22-16	.170	#8	3	.97	.31	.27	.81
RA867-170	1,000	22-16	.170	#8	3	.97	.31	.27	.81
18RA-10X	100	22-16	.170	#10	3	.97	.31	.27	.81
RA877-170	1,000	22-16	.170	#10	3	.97	.31	.27	.81
18RA-14X	100	22-16	.170	1/4"	4	1.13	.50	.37	.88
RA727-170	1,000	22-16	.170	5/16"	4	1.13	.50	.37	.88
14RB-4X	100	18-14	.200	#4	3	.94	.25	.27	.81
14RB-6X	100	18-14	.200	#6	3	.97	.31	.27	.81
RB857-200	1,000	18-14	.200	#6	3	.97	.31	.27	.81
14RB-8X	100	18-14	.200	#8	3	.97	.31	.27	.81
RB867-200	1,000	18-14	.200	#8	3	.97	.31	.27	.81
14RB-10X	100	18-14	.200	#10	3	.97	.31	.27	.81
RB877-200	1,000	18-14	.200	#10	3	.97	.31	.27	.81
14RB-14X	100	18-14	.200	1/4"	4	1.14	.50	.38	.89
RB717-200	1,000	18-14	.200	1/4"	4	1.14	.50	.38	.89
14RB-516X	100	18-14	.200	5/16"	4	1.15	.50	.38	.89
14RB-38X	100	18-14	.200	3/8"	4	1.16	.54	.35	.91
10RC-6X	50	12-10	.250	#6	5	1.06	.31	.27	.90
RC337-250	500	12-10	.250	#6	5	1.06	.31	.27	.90
10RC-8X	50	12-10	.250	#8	5	1.06	.31	.27	.90
RC777-250	500	12-10	.250	#8	5	1.06	.31	.27	.90
10RC-10X	50	12-10	.250	#10	5	1.06	.31	.27	.90
RC367-250	500	12-10	.250	#10	5	1.06	.31	.27	.90
10RC-14X	50	12-10	.250	1/4"	6	1.16	.50	.27	.90
RC717-250	500	12-10	.250	1/4"	6	1.16	.50	.27	.90
10RC-516X	50	12-10	.250	5/16"	6	1.17	.50	.37	.92
10RC-38X	50	12-10	.250	3/8"	6	1.29	.59	.44	.99
RC737-250	500	12-10	.250	3/8"	6	1.29	.59	.44	.99

UL Listed E9809

Installation Tools: WT145C, WT2000, WT112M, ERG-2001, ERG-2003

Extra-length PVC sleeve offers extra protection.

Vinyl-Insulated Ring Terminals — Insulation Grip



Insulation material is color-coded:

Stock thickness:	Color Code	Wire Range
RA & RB: .03	Red	22-16
RC: .04	Blue	18-14
	Yellow	12-10

- Brazed seam barrel is serrated to obtain high pull-out value
- Made of high-conductivity electrolytic copper, electro-tin plated

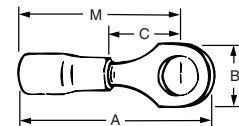

Most standard bulk catalog numbers can be put on mylar tape for reel-fed applications (i.e., tool and application dies).

Add "M" to suffix for mylar tape (ex. RA2573M). Bulk numbers are 1,000 and 500 packages.



CAT. NO.	PKG. QTY.	WIRE RANGE	MAX. INS.	BOLT HOLE	WT./LBS. PER 1,000	DIMENSIONS			
						A	B	C	M
18RA-4	100	22-16	.150	#4	3	.97	.31	.27	.81
RA77	1,000	22-16	.150	#4	3	.97	.31	.27	.81
18RA-6	100	22-16	.150	#6	3	.94	.25	.27	.81
RA857	1,000	22-16	.150	#6	3	.94	.25	.27	.81
18RA-8	100	22-16	.150	#8	3	.97	.31	.27	.81
RA867	1,000	22-16	.150	#8	3	.97	.31	.27	.81
18RA-10	100	22-16	.150	#10	3	.97	.31	.27	.81
RA877	1,000	22-16	.150	#10	3	.97	.31	.27	.81
18RA-14	100	22-16	.150	1/4"	4	1.13	.50	.37	.88
RA717	1,000	22-16	.150	1/4"	4	1.13	.50	.37	.88
18RA-516	100	22-16	.150	5/16"	4	1.13	.50	.37	.88
RA727	1,000	22-16	.150	5/16"	4	1.13	.50	.37	.88
18RA-38	100	22-16	.150	3/8"	4	1.24	.54	.37	.91
RA737	1,000	22-16	.150	3/8"	4	1.24	.54	.37	.91
14RB-4	100	18-14	.170	#4	3	.94	.25	.27	.81
RB1327	1,000	18-14	.170	#4	3	.94	.25	.27	.81
14RB-6	100	18-14	.170	#6	3	.97	.31	.27	.81
RB857	1,000	18-14	.170	#6	3	.97	.31	.27	.81
14RB-8	100	18-14	.170	#8	3	.97	.31	.27	.81
RB867	1,000	18-14	.170	#8	3	.97	.31	.27	.81
14RB-10	100	18-14	.170	#10	3	.97	.31	.27	.81
RB877	1,000	18-14	.170	#10	3	.97	.31	.27	.81
14RB-14	100	18-14	.170	1/4"	4	1.14	.50	.38	.89
RB717	1,000	18-14	.170	1/4"	4	1.14	.50	.38	.89
14RB-516	100	18-14	.170	5/16"	4	1.15	.50	.38	.89
RB727	1,000	18-14	.170	5/16"	4	1.15	.50	.38	.89
14RB-38	100	18-14	.170	3/8"	4	1.16	.54	.38	.91
RB-737	1,000	18-14	.170	3/8"	4	1.16	.54	.38	.91
10RC-6	50	12-10	.210	#6	5	1.06	.31	.27	.90
RC337	500	12-10	.210	#6	5	1.06	.31	.27	.90
10RC-8	50	12-10	.210	#8	5	1.06	.31	.27	.90
RC777	500	12-10	.210	#8	5	1.06	.31	.27	.90
10RC-10	50	12-10	.210	#10	5	1.06	.31	.27	.90
RC367	500	12-10	.210	#10	5	1.06	.31	.27	.90
10RC-14	50	12-10	.210	1/4"	6	1.16	.50	.27	.90
RC717	500	12-10	.210	1/4"	6	1.16	.50	.27	.90
10RC-516	50	12-10	.210	5/16"	6	1.17	.50	.37	.92
RC707	500	12-10	.210	5/16"	6	1.17	.50	.37	.92
10RC-38	50	12-10	.210	3/8"	6	1.29	.59	.44	.99
RC737	500	12-10	.210	3/8"	6	1.29	.59	.44	.99

UL Listed E9809

Installation Tools: WT145C, WT2000, WT112M, ERG-2001, ERG-2003

Insulated and Non-Insulated Ring Terminals

Constructed of electrolytic copper for high conductivity!



Non-Insulated Ring

- Can be installed with crimping tools having a single indentor or double indentor (recommended for solid wire)
- Serrated barrel increases grip on wire
- Wire range identification on the tongue of each terminal

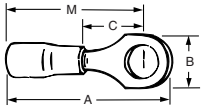

Stock Thickness: Most standard bulk catalog numbers can be put on Mylar Tape for reel-fed applications (i.e., 12050 tool and applicator dies). Please put the suffix "M" for Mylar Tape RA2573M.

A & B = .03
BC = .05
C = .04

Vinyl construction offers protection from frayed and dangerous wires.

Vinyl-Insulated Ring Terminals

- Two wire ranges available

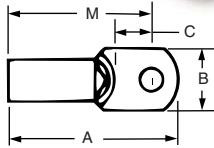

Stock Thickness: .04



CAT. NO.	STUD SIZE	MAX. INS. DIA.	WIRE RANGE	DIMENSIONS			
				A	B	C	M
Code Wire AWG							
RDV167	#8	.340	8	1.48	.42	.28	1.17
RDV367	#10	.340	8	1.48	.42	.28	1.17
RDV717	1/4"	.340	8	1.54	.46	.36	1.20
RDV727	5/16"	.340	8	1.63	.57	.36	1.23
RDV737	3/8"	.340	8	1.63	.57	.36	1.23
RDV757*	1/2"	.310	8	1.79	.82	.55	1.27
REV267	#10	.420	6	1.65	.45	.28	1.23
REV717	1/4"	.420	6	1.65	.49	.28	1.23
REV727	5/16"	.420	6	1.76	.61	.34	1.30
REV737	3/8"	.420	6	1.76	.61	.34	1.30
REV757*	1/2"	.395	6	1.83	.82	.55	1.26

*Braze Seam, Lollipop-Style Tongue

Installation Tools: ERG-2007 (RD & RE except Braze Seam), TBN6/65

NOTE: Not available on mylar tape.

CAT. NO.	PKG. QTY.	WIRE RANGE	BOLT HOLE	WT./LBS. PER 1,000	DIMENSIONS			
					A	B	C	M
A18-4	100	22-16	#4	2	.75	.31	.27	.59
A18-6	100	22-16	#6	2	.72	.25	.27	.59
A85	1,000	22-16	#6	2	.72	.25	.27	.59
A18-8	100	22-16	#8	2	.75	.31	.27	.59
A86	1,000	22-16	#8	2	.75	.31	.27	.59
A18-10	100	22-16	#10	2	.75	.31	.27	.59
A87	1,000	22-16	#10	2	.75	.31	.27	.59
A18-14	100	22-16	1/4"	3	.92	.50	.37	.67
A71	1,000	22-16	1/4"	3	.92	.50	.37	.67
A18-516	100	22-16	5/16"	3	.92	.50	.37	.67
A72	1,000	22-16	5/16"	3	.92	.50	.37	.67
A18-38	100	22-16	3/8"	3	.99	.54	.35	.67
A73	1,000	22-16	3/8"	3	.99	.54	.35	.67
A18-12	100	22-16	1/2"	3	1.06	.72	.38	.70
A75	1,000	22-16	1/2"	3	1.06	.72	.38	.70
B14-4	100	18-14	#4	2	.72	.25	.27	.59
B132	1,000	18-14	#4	2	.72	.25	.27	.59
B14-6	100	18-14	#6	2	.72	.25	.27	.59
B133	1,000	18-14	#6	2	.72	.25	.27	.59
B14-8	100	18-14	#8	3	.75	.31	.27	.59
B86	1,000	18-14	#8	3	.75	.31	.27	.59
B14-10	100	18-14	#10	3	.75	.31	.27	.59
B87	1,000	18-14	#10	3	.75	.31	.27	.59
B14-14	100	18-14	1/4"	6	.93	.50	.38	.68
B71	1,000	18-14	1/4"	6	.93	.50	.38	.68
B14-516	100	18-14	5/16"	6	.93	.50	.38	.68
B72	1,000	18-14	5/16"	6	.93	.50	.38	.68
B14-38	100	18-14	3/8"	6	.96	.54	.35	.68
B73	1,000	18-14	3/8"	6	.96	.54	.35	.68
B14-12	100	18-14	1/2"	6	1.06	.72	.38	.70
B75	1,000	18-14	1/2"	6	1.06	.72	.38	.70
B85	1,000	18-14	#6	6	.75	.31	.27	.59
B134	1,000	18-14	#8	6	.72	.25	.27	.59
BC14-6	50	Heavy Duty 16-14	#6	4	.81	.25	.29	.68
BC85	500	Use C Tooling	#6	4	.81	.25	.29	.68
BC14-8	50	Heavy Duty 16-14	#8	4	.87	.39	.29	.68
BC86	500	Use C Tooling	#8	4	.87	.39	.29	.68
BC14-10	50	Heavy Duty 16-14	#10	5	.87	.39	.29	.68
BC87	500	Use C Tooling	#10	5	.87	.39	.29	.68
BC14-14	50	Heavy Duty 16-14	1/4"	5	.93	.51	.29	.68
BC71	500	Use C Tooling	1/4"	5	.93	.51	.29	.68
BC14-516	50	Heavy Duty 16-14	5/16"	6	1.04	.54	.38	.77
BC72	500	Use C Tooling	5/16"	6	1.04	.54	.38	.77
BC14-38	50	Heavy Duty 16-14	3/8"	6	1.09	.63	.38	.77
BC79	500	Use C Tooling	3/8"	6	1.09	.63	.38	.77
BC14-12	50	Heavy Duty 16-14	1/2"	6	1.32	.76	.54	.94
BC75	500	Use C Tooling	1/2"	6	1.32	.76	.54	.94
C10-6	50	12-10	#6	4	.82	.31	.27	.66
C33	500	12-10	#6	4	.82	.31	.27	.66
C10-8	50	12-10	#8	5	.82	.31	.27	.66
C77	500	12-10	#8	5	.82	.31	.27	.66
C10-10	50	12-10	#10	5	.85	.38	.27	.66
C26	500	12-10	#10	5	.85	.38	.27	.66
C36	1,000	12-10	#10	7	.82	.31	.27	.66
C10-14	50	12-10	1/4"	7	.91	.50	.27	.66
C71	500	12-10	1/4"	7	.91	.50	.27	.66
C10-516	50	12-10	5/16"	8	.98	.50	.38	.73
C70	500	12-10	5/16"	8	.98	.50	.38	.73
C72	1,000	12-10	5/16"	7	1.10	.59	.45	.80
C10-38	50	12-10	3/8"	7	1.10	.59	.45	.80
C73	500	12-10	3/8"	7	1.10	.59	.45	.80
C10-12	50	12-10	1/2"	7	1.21	.72	.38	.84
C75	500	12-10	1/2"	7	1.21	.72	.38	.84

UL® Listed E9809

Installing tools: WT111M, WT112M, WT110M, ERG-2002, WT2000

Non-Insulated Ring Terminals



Select the configuration you need!

Non-Insulated Ring — Tubular

- Can be installed with crimping tools having a single indenter or double indenter (recommended for solid wire)
- Serrated barrel increases grip on wire
- Wire range identification on the tongue of each terminal

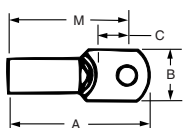

Stock Thickness:

G & H = .05
J & K = .06
L & M = .07



Serrated barrel increases grip on wire!

Non-Insulated Ring — Brazed Seam

- Can be installed with crimping tools having a single indenter or double indenter (recommended for solid wire)
- Constructed of electrolytic copper for high conductivity
- Wire range identification on the tongue of each terminal

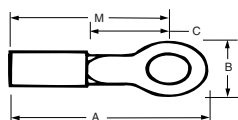

Stock Thickness:

D & E = .06
F = .07
D10, E10, F10 = .04
D975 & F975 = .04



CAT. NO.	PKG. QTY.	WIRE RANGE	BOLT HOLE	WT./LBS. PER 1,000	DIMENSIONS			
					A	B	C	M
D26	200	8	#8	16	1.13	.48	.36	.90
D8-10	25	8	#10	16	1.13	.48	.36	.90
D36	200	8	#10	16	1.13	.48	.36	.90
D8-14	25	8	1/4"	14	1.13	.48	.36	.90
D71	200	8	1/4"	14	1.13	.48	.36	.90
D8-516	25	8	5/16"	16	1.32	.59	.49	1.03
D72	200	8	5/16"	16	1.32	.59	.49	1.03
D8-38	25	8	3/8"	14	1.32	.59	.49	1.03
D73	200	8	3/8"	14	1.32	.59	.49	1.03
D8-12	25	8	1/2"	14	1.49	.82	.55	1.09
D75	200	8	1/2"	14	1.49	.82	.55	1.09
E6-10	20	6	#10	17	1.13	.48	.36	.90
E26	200	6	#10	17	1.13	.48	.36	.90
E6-14	20	6	1/4"	20	1.13	.48	.36	.90
E71	200	6	1/4"	20	1.13	.48	.36	.90
E6-516	20	6	5/16"	20	1.32	.60	.49	1.03
E72	200	6	5/16"	20	1.32	.60	.49	1.03
E6-38	20	6	3/8"	20	1.32	.60	.49	1.03
E73	200	6	3/8"	20	1.32	.60	.49	1.03
E6-12	20	6	1/2"	20	1.49	.82	.55	1.08
E75	200	6	1/2"	20	1.49	.82	.55	1.08
F4-10	20	4	#10	24	1.16	.48	.36	.93
F26	200	4	#10	24	1.16	.48	.36	.93
F4-14	20	4	1/4"	25	1.16	.48	.36	.93
F71	200	4	1/4"	25	1.16	.48	.36	.93
F4-516	20	4	5/16"	25	1.35	.60	.49	1.06
F72	200	4	5/16"	25	1.35	.60	.49	1.06
F4-38	20	4	3/8"	25	1.35	.60	.49	1.06
F73	200	4	3/8"	25	1.35	.60	.49	1.06
F4-12	20	4	1/2"	25	1.52	.82	.55	1.11
F75	200	4	1/2"	25	1.52	.82	.55	1.11

Installing tools: WT115A D, E, F, and G, TBM6/TBM6S, WT3185

NOTE: Not available on Mylar Tape.

Installing dies: 11802 INDENTOR (D-E-F-G), D-11803-NEST, E-11805-NEST, F-11806-NEST (all ordered separately)

CAT. NO.	PKG. QTY.	WIRE RANGE	BOLT HOLE	WT./LBS. PER 1,000	DIMENSIONS			
					A	B	C	M
D10161	200	8	#8	12	1.15	.41	.28	.95
D10361	200	8	#10	12	1.15	.41	.28	.95
D10711	200	8	1/4"	12	1.20	.45	.36	.97
D10721	200	8	5/16"	12	1.28	.56	.36	1.00
D10731	200	8	3/8"	12	1.28	.56	.36	1.00
D975	200	8	1/2"	12	1.46	.83	.49	1.06
E10261	200	6	#10	14	1.26	.49	.24	1.02
E10711	200	6	1/4"	14	1.26	.49	.27	.99
E10721	200	6	5/16"	14	1.38	.60	.34	1.04
E10731	200	6	3/8"	14	1.38	.60	.34	1.04
F10261	100	4	#10	20	1.37	.55	.30	1.07
F10711	100	4	1/4"	20	1.37	.55	.30	1.07
F10721	100	4	5/16"	20	1.42	.62	.34	1.08
F10731	100	4	3/8"	20	1.42	.62	.34	1.08
F975	200	4	1/2"	20	1.49	.83	.45	1.10
G926	100	2	#10	40	1.59	.69	.40	1.26
G2-14	10	2	1/4"	50	1.59	.69	.40	1.26
G971	100	2	1/4"	40	1.59	.69	.40	1.26
G2-516	10	2	5/16"	50	1.59	.69	.40	1.26
G972	100	2	5/16"	40	1.59	.69	.40	1.26
G2-38	10	2	3/8"	50	1.59	.69	.40	1.26
G973	100	2	3/8"	40	1.59	.69	.40	1.26
G2-12	10	2	1/2"	50	1.79	.80	.49	1.36
G975	100	2	1/2"	40	1.79	.80	.49	1.36
H10-14	10	1/0	1/4"	50	1.65	.77	.43	1.32
H971	100	1AN-1/0	1/4"	50	1.65	.77	.43	1.32
H972	100	1AN-1/0	5/16"	50	1.65	.77	.43	1.32
H973	100	1AN-1/0	3/8"	50	1.65	.77	.43	1.32
H975	100	1AN-1/0	1/2"	50	1.85	.77	.54	1.41
J971	50	1/0AN-2/0	1/4"	60	1.94	.84	.48	1.53
J972	50	1/0AN-2/0	5/16"	60	1.94	.84	.48	1.53
J20-38	10	2/0	3/8"	70	1.84	.83	.46	1.46
J973	50	1/0AN-2/0	3/8"	60	1.99	.84	.53	1.58
J974	50	1/0AN-2/0	7/16"	60	1.99	.89	.51	1.56
J975	50	1/0AN-2/0	1/2"	60	1.99	.89	.51	1.56
K971	50	2/0AN-3/0	1/4"	76	2.08	.93	.54	1.69
K972	50	2/0AN-3/0	5/16"	76	2.08	.93	.54	1.69
K30-38	5	3/0	3/8"	82	2.08	.93	.54	1.69
K973	50	2/0AN-3/0	3/8"	76	2.08	.93	.54	1.69
K974	50	2/0AN-3/0	7/16"	76	2.08	.93	.54	1.70
K975	50	2/0AN-3/0	1/2"	76	2.08	.93	.54	1.70
L972	50	3/0AN-4/0	5/16"	100	2.25	1.04	.57	1.77
L40-38	5	4/0	3/8"	100	2.25	1.04	.57	1.77
L973	50	3/0AN-4/0	3/8"	92	2.25	1.04	.57	1.77
L974	50	3/0AN-4/0	7/16"	92	2.25	1.04	.57	1.77
L975	50	3/0AN-4/0	1/2"	92	2.25	1.04	.57	1.77
M972	50	4/0AN-250MCM	5/16"	112	2.28	1.12	.62	1.90
M250-38	5	250MCM	3/8"	135	2.40	1.12	.65	1.91
M973	50	4/0AN-250MCM	3/8"	112	2.40	1.12	.65	1.91
M974	50	4/0AN-250MCM	7/16"	112	2.40	1.12	.65	1.91
M975	50	4/0AN-250MCM	1/2"	112	2.40	1.12	.65	1.91

AN – Aircraft Wire

Installing tools: ERG-2005, ERG 2008, TBM6/TBM6S, WT3185

NOTE: Not available on Mylar Tape.

Sta-Kon Terminal Products and Tools

Heavy-Duty Ring Terminals

Strong enough for tough applications!

Nylon & Vinyl #16-14 AWG — Heavy Duty



Sta-Kon Terminal Products and Tools

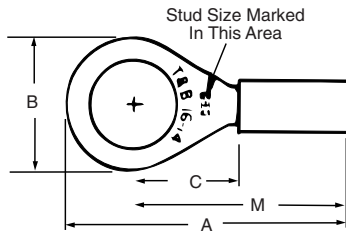

Nylon or Vinyl Insulated

..... Specifications

Material — Copper .050 thick

Finish — Electro tin-plate

Wire Range — #16-14

Color Code — Green vinyl or nylon insulator

Most standard bulk catalog numbers can be put on Mylar Tape for reel-fed applications (i.e., 12050 tool and application dies). See pages C?? - C??.

Please put the suffix "M" for Mylar Tape RA2573M.

(Bulk number 1,000 and 500 packages.)

CAT. NO.	PKG. QTY.	WIRE RANGE	MAX. INS.	BOLT HOLE	WT./LBS. PER 1,000	DIMENSIONS			
						A	B	C	M
RBC14-6	50	16-14 Heavy Duty	.210	#6	.98	.25	.29	.85	
RBC853	500	Use RC Tooling	.210	#6	.98	.25	.29	.85	
RBC14-8	50	16-14 Heavy Duty	.210	#8	1.04	.39	.29	.85	
RBC863	500	Use RC Tooling	.210	#8	1.04	.39	.29	.85	
RBC14-10	50	16-14 Heavy Duty	.210	#10	1.04	.39	.29	.85	
RBC873	500	Use RC Tooling	.210	#10	1.04	.39	.29	.85	
RBC14-14	50	16-14 Heavy Duty	.210	1/4"	1.10	.51	.29	.85	
RBC713	500	Use RC Tooling	.210	1/4"	1.10	.51	.29	.85	
RBC14-516	50	16-14 Heavy Duty	.210	5/16"	1.21	.54	.38	.94	
RBC723	500	Use RC Tooling	.210	5/16"	1.21	.54	.38	.94	
RBC14-38	50	16-14 Heavy Duty	.210	3/8"	1.26	.63	.38	.94	
RBC793	500	Use RC Tooling	.210	3/8"	1.26	.63	.38	.94	
RBC14-12	50	16-14 Heavy Duty	.210	1/2"	1.49	.76	.54	1.11	
RBC753	500	Use RC Tooling	.210	1/2"	1.49	.76	.54	1.11	
14RBC-6	50	16-14 Heavy Duty	.210	#6	5	1.06	.25	.29	.93
RBC857	500	Use RC Tooling	.210	#6	5	1.06	.25	.29	.93
14RBC-8	50	16-14 Heavy Duty	.210	#8	5	1.13	.39	.29	.93
RBC867	500	Use RC Tooling	.210	#8	5	1.13	.39	.29	.93
14RBC-10	50	16-14 Heavy Duty	.210	#10	5	1.13	.39	.29	.93
RBC877	500	Use RC Tooling	.210	#10	5	1.13	.39	.29	.93
14RBC-14	50	16-14 Heavy Duty	.210	1/4"	6	1.19	.51	.29	.93
RBC717	500	Use RC Tooling	.210	1/4"	6	1.19	.51	.29	.93
14RBC-516	50	16-14 Heavy Duty	.210	5/16"	6	1.29	.54	.38	1.03
RBC727	500	Use RC Tooling	.210	5/16"	6	1.29	.54	.38	1.03
14RBC-38	50	16-14 Heavy Duty	.210	3/8"	6	1.34	.63	.38	1.03
RBC797	500	Use RC Tooling	.210	3/8"	6	1.34	.63	.38	1.03
14RBC-12	50	16-14 Heavy Duty	.210	1/2"	6	1.57	.76	.54	1.19
RB757	500	Use RC Tooling	.210	1/2"	6	1.57	.76	.54	1.19

WT2000, WT145C, and power tools as recommended crimp in the 12-10 nest (yellow).

The heavy-duty terminal solution!

Non-Insulated
#16-14 AWG —
Heavy Duty

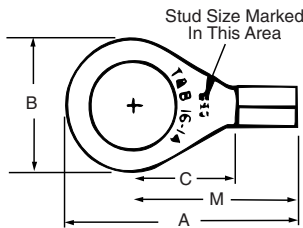

Non-Insulated

CAT. NO.	PKG. QTY.	WIRE RANGE	MAX. INS.	BOLT HOLE	WT./LBS. PER 1,000	DIMENSIONS			
						A	B	C	M
BC14-6	50	16-14 Heavy Duty	—	#6	.81	.25	.29	.68	
BC85	500	Use RC Tooling	—	#6	.81	.25	.29	.68	
BC14-8	50	16-14 Heavy Duty	—	#8	.87	.39	.29	.68	
BC86	500	Use RC Tooling	—	#8	.87	.39	.29	.68	
BC14-10	50	16-14 Heavy Duty	—	#10	.87	.39	.29	.68	
BC87	500	Use RC Tooling	—	#10	.87	.39	.29	.68	
BC14-14	50	16-14 Heavy Duty	—	1/4"	.93	.51	.29	.68	
BC71	500	Use RC Tooling	—	1/4"	.93	.51	.29	.68	
BC14-516	50	16-14 Heavy Duty	—	5/16"	1.04	.54	.38	.77	
BC72	500	Use RC Tooling	—	5/16"	1.04	.54	.38	.77	
BC14-38	50	16-14 Heavy Duty	—	3/8"	1.09	.63	.38	.77	
BC79	500	Use RC Tooling	—	3/8"	1.09	.63	.38	.77	
BC14-12	50	16-14 Heavy Duty	—	1/2"	1.32	.76	.54	.94	
BC75	500	Use RC Tooling	—	1/2"	1.32	.76	.54	.94	

WT111M, WT2000, and power tools as recommended, crimp in the 12-10 nest.

High-Temperature Non-Insulated & Tefzel® Insulated Ring Terminals

For easily installed, permanent terminations of solid, round, or stranded nichrome wires!

High-Temperature Non-Insulated Ring — 1,200° F Max.

Terminals for nichrome wire NW Series

- High temperature non-insulated ring terminals and splices
- Designed for use with solid or stranded resistance wires as used in appliances such as toasters, irons, and heaters

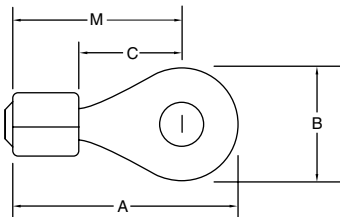

Stock Thickness:

24-22 ga. = .032
20-18 ga. = .032
16-14 ga. = .040
12-10 ga. = .040

CAT. NO.	PKG. QTY.	WIRE RANGE	BOLT HOLE	WT./LBS. PER 1,000	DIMENSIONS			
					A	B	C	M
NW21	1,000	24-22	#6	1.5	.59	.31	.28	.44
NW22	1,000	24-22	#8	1.5	.59	.31	.28	.44
NW23	1,000	24-22	#10	1.5	.59	.31	.28	.44
NW18-10	100	20-18	#10	2.5	.63	.31	.28	.38
NW52	1,000	20-18	#8	2.5	.63	.31	.28	.38
NW81	1,000	16-14	#6	2.5	.66	.31	.28	.51
NW14-8	100	16-14	#8	2.5	.66	.31	.28	.51
NW14-10	100	16-14	#10	2.5	.66	.31	.28	.51
NW83	1,000	16-14	#10	2.5	.66	.31	.28	.51
NW14-12	100	16-14	#12*	2.5	.66	.31	.28	.51
NW84	1,000	16-14	#12*	2.5	.66	.31	.28	.51
NW10-8	50	12-10	#8	3	.66	.31	.28	.51
NW10-10	50	12-10	#10	3	.66	.31	.28	.51
NW10-12	50	12-10	#12*	3	.66	.31	.28	.51

* #12 stud is approximate 1/4" stud.

Installing tool: WT1377

NOTE: Not available on Mylar Tape.

UL® 94V-0 rated! Tefzel® Insulated Ring — Insulation Grip



Stock Thickness:

RAT & RBT = .03
RCT = .04

Package Quantities:

RAT & RBT = 1,000 pieces
RCT = 500 pieces



Most standard bulk catalog numbers can be put on Mylar Tape for reel-fed applications (i.e., 12050 tool and application dies). See pages K??- K??.

Please put the suffix "M" for Mylar Tape RA2573M. (Bulk number 1,000 and 500 packages.)

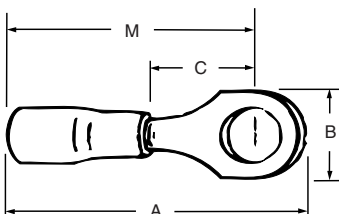

CAT. NO.	STUD SIZE	INS. DIA.	MAX. WIRE RANGE	DIMENSIONS			
				A	B	C	M
Series RAT — For UL 94V-0 Flammability Rating/High Temperature and Chemical Resistance							
RAT853	#6	.140	22-18	.81	.25	.25	.69
RAT863	#8	.140	22-18	.84	.31	.25	.69
RAT873	#10	.140	22-18	.84	.31	.25	.69
RAT713	1/4"	.140	22-18	1.07	.46	.31	.84
Series RBT							
RBT853	#6	.170	16-14	.84	.31	.25	.69
RBT863	#8	.170	16-14	.84	.31	.25	.69
RBT873	#10	.170	16-14	.84	.31	.25	.69
RBT713	1/4"	.170	16-14	1.08	.46	.31	.81
Series RCT							
RCT333	#6	.210	12-10	1.00	.37	.27	.81
RCT863	#8	.210	12-10	1.00	.37	.27	.81
RCT363	#10	.210	12-10	1.00	.37	.27	.81
RCT713	1/4"	.210	12-10	1.11	.52	.32	.85
RCT703	5/16"	.210	12-10	1.23	.52	.31	.96
RCT733**	3/8"	.210	12-10	1.29	.58	.35	1.00

** Not available on tape.

UL Listed E9809

Installing tool: WT145C, WT112M

Tefzel® is a registered trademark of DuPont.

Nylon Insulated and Non-Insulated Rectangular Ring Terminals

The terminals you need!

Nylon Insulated Rectangular Rings

Stock Thickness:
RA & RB = .03
RC = .04

NOTE:
22-18 ga. = 1-2 Navy
16-14 ga. = 2 1/4 Navy
12-10 ga. = 6-9 Navy

Most standard bulk catalog numbers can be put on Mylar Tape for reel-fed applications (i.e., 12050 tool and application dies). Please put the suffix "M" for Mylar Tape RA2573M. (Bulk number 1,000 and 500 packages.)

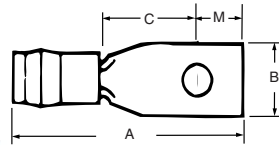

CAT. NO.	STUD SIZE	WIRE RANGE	DIMENSIONS				BU-SHIPS TONGUE SHAPE
			A	B	C	M	
Series RA							
RA486	#4	22-18	.796	.237	.237	.143	L86P-1
RA485	#4	22-18	1.015	.237	.404	.195	L85P-1
RA483	#5	22-18	.859	.277	.277	.143	L83P-1
RA484	#6	22-18	1.015	.237	.404	.195	L84P-1
RA481	#6	22-18	1.109	.302	.465	.227	L81P-1
RA482	#8	22-18	1.109	.302	.465	.227	L82P-1
RA480**	#8	22-18	1.359	.390	.621	.310	L80P-1
Series RB							
RB486	#4	16-14	.796	.237	.237	.143	L86P-2
RB485	#4	16-14	1.015	.237	.404	.195	L85P-2
RB483	#5	16-14	.859	.277	.277	.143	L83P-2
RB484	#6	16-14	1.015	.237	.404	.195	L84P-2
RB481	#6	16-14	1.109	.302	.465	.227	L81P-2
RB482	#8	16-14	1.109	.302	.465	.227	L82P-2
RB480**	#8	16-14	1.359	.390	.621	.310	L80P-2
Series RC							
RC486	#4	12-10	.984	.237	.237	.143	L86P-3
RC485	#4	12-10	1.187	.237	.404	.195	L85P-3
RC483	#5	12-10	1.046	.277	.277	.143	L83P-3
RC484	#6	12-10	1.203	.237	.404	.195	L84P-3
RC481	#6	12-10	1.281	.302	.465	.227	L81P-3
RC482	#8	12-10	1.281	.302	.465	.227	L82P-3
RC480**	#8	12-10	1.531	.390	.621	.310	L80P-3

** Not available on tape.

NOTE: RA, RB, RC486 for use with BU-Ships terminal board types 26TB. RA, RB, RC485 for use with 25TB and 27TB. RA, RB, RC483 for use with 8TB. RA, RB, RC484 for use with 10TB and 11TB. RA, RB, RC481 for use with 6TB, 7TB and 9TB. RA, RB, RC482 for use with 15TB. RA, RB, RC480 for use with 3TB, 4TB, 5TB, 16TB, 17TB and 18TB.

NOTE: When ordering terminals on tape, add the suffix "M" to the catalog number, example: (RA250M).

UL® Listed E9809

Installing tools: ERG2001, WT145C

Select from a variety of configurations!

Non-Insulated Rectangular Rings

Stock Thickness:
A & B = .03
C = .04

NOTE:
22-18 ga. = 1-2 Navy
16-14 ga. = 2 1/4 Navy
12-10 ga. = 6-9 Navy

Most standard bulk catalog numbers can be put on Mylar Tape for reel-fed applications (i.e., 12050 tool and application dies). Please put the suffix "M" for Mylar Tape RA2573M. (Bulk number 1,000 and 500 packages.)

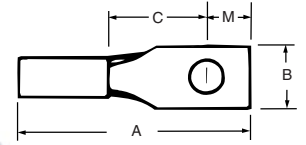

CAT. NO.	STUD SIZE	WIRE RANGE	DIMENSIONS				BU-SHIPS TONGUE SHAPE
			A	B	C	M	
Series A							
A486	#4	22-18	.65	.237	.237	.143	L86
A485	#4	22-18	.87	.237	.404	.195	L85
A483	#5	22-18	.70	.277	.277	.143	L83
A484	#6	22-18	.87	.237	.404	.195	L84
A481	#6	22-18	.96	.302	.465	.227	L81
A482	#8	22-18	.96	.302	.465	.227	L82
A480**	#8	22-18	1.21	.390	.621	.310	L80
Series B							
B486	#4	16-14	.65	.237	.237	.143	L86
B485	#4	16-14	.87	.237	.404	.195	L85
B483	#5	16-14	.70	.277	.277	.143	L83
B484	#6	16-14	.87	.237	.404	.195	L84
B481	#6	16-14	.96	.302	.465	.227	L81
B482	#8	16-14	.96	.302	.465	.227	L82
B480**	#8	16-14	1.21	.390	.621	.310	L80
Series C							
C486	#4	12-10	.73	.237	.237	.143	L86
C485	#4	12-10	.90	.237	.404	.195	L85
C483	#5	12-10	.76	.277	.277	.143	L83
C484	#6	12-10	.94	.237	.404	.195	L84
C481	#6	12-10	1.03	.302	.465	.227	L81
C482	#8	12-10	1.03	.302	.465	.227	L82
C480**	#8	12-10	1.27	.390	.621	.310	L80

** Not available on tape.

NOTE: A, B, C486 for use with Bu-Ships terminal board types 26TB. A, B, C485 for use with 25TB, 27TB. A, B, C483 for use with 8TB. A, B, C484 for use with 10TB and 11TB. A, B, C481 for use with 6TB, 7TB and 9TB. A, B, C482 for use with 15TB. A, B, C480 for use with 3TB, 5TB, 16TB, 17TB and 18TB.

NOTE: When ordering terminals on tape, add the suffix "M" to the catalog number, example: (RA250M).

UL Listed E9809

Installing tool: ERG 2002

Non-Insulated Flag Terminals

Flag terminals enable a 90° connection to the terminal block without bending the wire!



Non-Insulated Flag

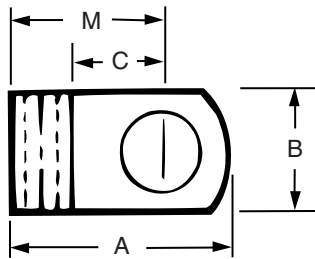
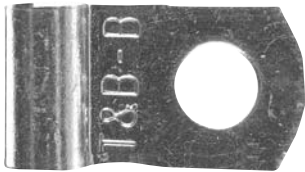

Stock Thickness:

- AB = .03
- C = .04
- D = .06
- E = .06
- F = .07
- G = .08

CAT. NO.	PKG. QTY.	WIRE RANGE	BOLT HOLE	WT./LBS. PER 1,000	DIMENSIONS			
					A	B	C	M
AB14-6A	100	22-14	#6	2½	.55	.31	.22	.39
AB51	1,000	22-14	#6	2½	.55	.31	.22	.39
AB14-8A	100	22-14	#8	2½	.55	.31	.22	.39
AB52	1,000	22-14	#8	2½	.55	.31	.22	.39
AB14-10A	100	22-14	#10	2½	.55	.31	.22	.39
AB53	1,000	22-14	#10	2½	.55	.31	.22	.39
C51	1,000	12-10	#6	5	.66	.31	.25	.48
C10-8A	50	12-10	#8	5	.66	.31	.25	.48
C52	500	12-10	#8	5	.66	.31	.25	.48
C10-10A	50	12-10	#10	5	.66	.31	.25	.48
C53	500	12-10	#10	5	.66	.31	.25	.48
D236	1,000	9,8,7	#10	—	.83	.50	.25	.59
D226	1,000	9,8,7	#10	—	.88	.50	.29	.64
D271	1,000	9,8,7	¼"	—	.92	.50	.33	.68
E226	1,000	6,5	#10	—	.93	.50	.29	.69
E271	1,000	6,5	¼"	—	.97	.50	.33	.73
E272	1,000	6,5	⅝"	—	1.05	.50	.41	.81
F226	1,000	4,3	#10	—	1.07	.56	.33	.80
F271	1,000	4,3	¼"	—	1.10	.63	.33	.80
F272	1,000	4,3	⅝"	—	1.18	.63	.41	.88
F273	1,000	4,3	¾"	—	1.20	.63	.43	.90
G671	1,000	2	¼"	—	1.20	.63	.33	.89
G672	1,000	2	⅝"	—	1.28	.63	.41	.97
G673	1,000	2	¾"	—	1.32	.63	.46	1.02
H672	—	1	⅝"	—	1.31	.63	.41	1.01
H673	—	1	¾"	—	1.36	.63	.46	1.06
J672	—	2	⅝"	—	1.46	.75	.41	1.10
J673	—	2	¾"	—	1.51	.75	.46	1.15
J675	—	2	½"	—	1.67	.75	.55	1.24
K672	—	3	⅝"	—	1.59	.81	.41	1.19
K673	—	3	¾"	—	1.64	.81	.46	1.24
K675	—	3	½"	—	1.76	.81	.55	1.34
M673	—	4	¾"	—	1.89	1.0	.46	1.43
M675	—	4	½"	—	1.99	1.0	.55	1.52

UL® Listed E9809

Installing tools: ERG-2004 (For AB and C Flag only.)

NOTE: Not available on Mylar Tape.

Sta-Kon Terminal Products and Tools

Nylon Insulated Fork Terminals

Sta-Kon Terminal Products and Tools

Withstands temperatures up to 105° C!

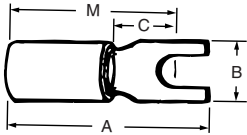

Nylon Insulated Fork — Insulation Grip

- Fork terminals with nylon insulation sleeves, recommended for temperatures up to 105°C. Inner bronze insulation grip sleeve lengthens flex radius of conductor and eliminates conductor creep. Nylon jacket is color-coded
- Stock thickness same as ring terminal of same size

Most standard bulk catalog numbers can be put on Mylar Tape for reel-fed applications (i.e., 12050 tool and application dies).

Please put the suffix "M" for Mylar Tape RA2573M. (Bulk number 1,000 and 500 packages.)



CAT. NO.	PKG. QTY.	WIRE RANGE	MAX. INS.	BOLT HOLE	WT./LBS. PER 1,000	DIMENSIONS			
						A	B	C	M
RA18-6F	100	22-16	.136	#6	3	.83	.25	.25	.71
RA1103	1,000	22-16	.136	#6	3	.83	.25	.25	.71
RA18-8F	100	22-16	.136	#8	3	.86	.31	.25	.71
RA1123	1,000	22-16	.136	#8	3	.86	.31	.25	.71
RA18-10F	100	22-16	.136	#10	3	.86	.31	.25	.71
RA1153	1,000	22-16	.136	#10	3	.86	.31	.25	.71
RA18-14F	100	22-16	.136	1/4"	4	.95	.44	.31	.70
RA1163	1,000	22-16	.136	1/4"	4	.95	.44	.31	.70
RB14-6F	100	18-14	.162	#6	3 1/2	.87	.31	.25	.71
RB1113	1,000	18-14	.162	#6	3 1/2	.87	.31	.25	.71
RB14-8F	100	18-14	.162	#8	3 1/2	.87	.31	.25	.71
RB1123	1,000	18-14	.162	#8	3 1/2	.87	.31	.25	.71
RB14-10F	100	18-14	.162	#10	4	.87	.38	.25	.71
RB1153	1,000	18-14	.162	#10	4	.87	.38	.25	.71
RB14-14F	100	18-14	.162	1/4"	4	.95	.44	.28	.74
RB1163	1,000	18-14	.162	1/4"	4	.95	.44	.28	.74
RB1103	1,000	18-14	.162	#6	6	.74	.28	.16	.60
RB1124	1,000	18-14	.190	#8	6	.95	.31	.25	.79
RB1154	1,000	18-14	.190	#10	6	.95	.31	.25	.79
RC10-6F	50	12-10	.210	#6	6	.97	.31	.27	.81
RC1113	500	12-10	.210	#6	6	.97	.31	.27	.81
RC10-8F	50	12-10	.210	#8	6	1.00	.37	.27	.81
RC1123	500	12-10	.210	#8	6	1.00	.37	.27	.81
RC10-10F	50	12-10	.210	#10	6	1.00	.37	.27	.81
RC1153	500	12-10	.210	#10	6	1.00	.37	.27	.81
RC10-14F	50	12-10	.210	1/4"	6	1.12	.50	.27	.86
RC1163	500	12-10	.210	1/4"	6	1.12	.50	.27	.86
RC1124	1,000	12-10	.250	#8	6	1.10	.37	.27	.91
RC1154	1,000	12-10	.250	#10	6	1.10	.37	.27	.91

UL® Listed E9809

Installing tools: WT145C, WT2000, WT112M, ERG-2001, ERG-2003, WT145A

Enables EASY installation — just loosen the screw!

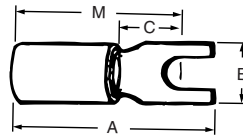

Nylon Insulated Fork Flanged Tongue — Insulation Grip

- Suffix "S" indicates a flanged-tongue fork with turned up tips for extra holding protection
- Stock thickness same as ring terminal of same size

Most standard bulk catalog numbers can be put on Mylar Tape for reel-fed applications (i.e., 12050 tool and application dies).

Please put the suffix "M" for Mylar Tape RA2573M. (Bulk number 1,000 and 500 packages.)



CAT. NO.	PKG. QTY.	WIRE RANGE	MAX. INS.	BOLT HOLE	WT./LBS. PER 1,000	DIMENSIONS			
						A	B	C	M
RA18-6FS	100	22-16	.136	#6	3	.75	.28	.16	.62
RA1203	1,000	22-16	.136	#6	3	.75	.28	.16	.62
RA18-8FS	100	22-16	.136	#8	3	.89	.31	.23	.65
RA1223	1,000	22-16	.136	#8	3	.89	.31	.23	.65
RA18-10FS	100	22-16	.136	#10	3	.93	.38	.26	.68
RA1253	1,000	22-16	.136	#10	3	.93	.38	.26	.68
RB14-6FS	100	18-14	.162	#6	4	.74	.28	.16	.60
RB1203	1,000	18-14	.162	#6	4	.74	.28	.16	.60
RB14-8FS	100	18-14	.162	#8	4	.89	.31	.23	.66
RB1223	1,000	18-14	.162	#8	4	.89	.31	.23	.66
RB14-10FS	100	18-14	.162	#10	4	.94	.38	.27	.69
RB1253	1,000	18-14	.162	#10	4	.94	.38	.27	.69
RB1204	1,000	18-14	.190	#6	4	.79	.28	.16	.67
RB1224	1,000	18-14	.190	#8	4	.94	.31	.23	.71
RC10-8FS	50	12-10	.210	#8	5	.97	.34	.23	.73
RC1223	500	12-10	.210	#8	5	.97	.34	.23	.73
RC10-10FS	50	12-10	.210	#10	5	1.00	.38	.26	.74
RC1253	500	12-10	.210	#10	5	1.00	.38	.26	.74
RC1224	1,000	12-10	.250	#8	5	1.08	.34	.23	.80
RC1254	1,000	12-10	.250	#10	5	1.12	.38	.26	.86

UL Listed E9809

Installing tools: WT145C, WT2000, WT112M, ERG-2001, ERG-2003, WT145A

Vinyl Insulated Fork Terminals

Protects and relieves stress at the wire's flex point.

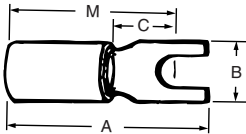

Vinyl Insulated Fork — Insulation Support

- These fork terminals have extra-long PVC insulation sleeve for protection and stress relief at wire's flex point
- Brazed seam barrel is serrated for high pull-out value. Terminal is high conductivity electrolytic copper, electro-tin plated. Insulation is color-coded
- Stock thickness same as ring terminal of same size

Most standard bulk catalog numbers can be put on Mylar Tape for reel-fed applications (i.e., 12050 tool and application dies).



CAT. NO.	PKG. QTY.	WIRE RANGE	MAX. INS.	BOLT HOLE	WT./LBS. PER 1,000	DIMENSIONS			
						A	B	C	M
18RA-6F	100	22-16	.150	#6	5	.94	.25	.27	.81
RA1167	1,000	22-16	.150	#6	5	.94	.25	.27	.81
18RA-8F	100	22-16	.150	#8	5	.97	.31	.27	.81
RA1147	1,000	22-16	.150	#8	5	.97	.31	.27	.81
18RA-10F	100	22-16	.150	#10	5	.97	.31	.27	.81
RA1157	1,000	22-16	.150	#10	5	.97	.31	.27	.81
14RB-6F	100	18-14	.170	#6	6	.97	.31	.27	.81
RB647	1,000	18-14	.170	#6	6	.97	.31	.27	.81
14RB-6FX	100	18-14	.170	#6	6	.89	.30	.25	.75
14RB-8F	100	18-14	.170	#8	6	.97	.31	.27	.81
RB657	1,000	18-14	.170	#8	6	.97	.31	.27	.81
14RB-10F	100	18-14	.170	#10	6	.97	.31	.27	.81
RB1157	1,000	18-14	.170	#10	6	.97	.31	.27	.81
14RB-14F	100	18-14	.170	1/4"	6	1.11	.44	.38	.89
RB1717	1,000	18-14	.170	1/4"	6	1.11	.44	.38	.89
10RC-6F	50	12-10	.210	#6	7	1.09	.38	.27	.90
RC1337	500	12-10	.210	#6	7	1.09	.38	.27	.90
10RC-8F	50	12-10	.210	#8	7	1.09	.38	.27	.90
RC1147	500	12-10	.210	#8	7	1.09	.38	.27	.90
10RC-10F	50	12-10	.210	#10	7	1.09	.38	.27	.90
RC1157	500	12-10	.210	#10	7	1.09	.38	.27	.90
10RC-14F	50	12-10	.210	1/4"	7	1.15	.50	.37	.90
RC1167	500	12-10	.210	1/4"	7	1.15	.50	.37	.90

UL® Listed E9809.

Installing tools: WT145C, WT2000, WT112M, ERG-2001, ERG-2003

Please put the suffix "M" for Mylar Tape RA2573M. (Bulk number 1,000 and 500 packages.)

Wider wire entry to accommodate heavy wall insulation!

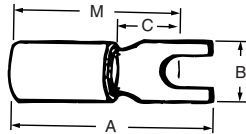

Vinyl Insulation Fork — Expanded Insulation Support

- Fork terminals enable easy installation because the mounting screw does not have to be completely removed
- Suffix "X" indicates an expanded insulation support, meaning a wider wire entry to accommodate heavy wall insulation
- Stock thickness same as ring terminal of same size

Most standard bulk catalog numbers can be put on Mylar Tape for reel-fed applications (i.e., 12050 tool and application dies).



CAT. NO.	PKG. QTY.	WIRE RANGE	MAX. INS.	BOLT HOLE	WT./LBS. PER 1,000	DIMENSIONS			
						A	B	C	M
18RA-6FX	100	22-16	.170	#6	5	.94	.25	.27	.81
RA1167-170	1,000	22-16	.170	#6	5	.94	.25	.27	.81
18RA-8FX	100	22-16	.170	#8	5	.97	.31	.27	.81
RA1147-170	1,000	22-16	.170	#8	5	.97	.31	.27	.81
18RA-10FX	100	22-16	.170	#10	5	.97	.31	.27	.81
RA1157-170	1,000	22-16	.170	#10	5	.97	.31	.27	.81
14RB-6FX	100	18-14	.200	#6	6	.97	.31	.27	.81
RB647-200	1,000	18-14	.200	#6	6	.97	.31	.27	.81
14RB-8FX	100	18-14	.200	#8	6	.97	.31	.27	.81
RB657-200	1,000	18-14	.200	#8	6	.97	.31	.27	.81
14RB-10FX	100	18-14	.200	#10	6	.97	.31	.27	.81
RB1157-200	1,000	18-14	.200	#10	6	.97	.31	.27	.81
10RC-8FX	50	12-10	.250	#8	7	1.11	.38	.27	.90
RC1147-250	500	12-10	.250	#8	7	1.11	.38	.27	.90
10RC-10FX	50	12-10	.250	#10	7	1.11	.38	.27	.90
RC1157-250	500	12-10	.250	#10	7	1.11	.38	.27	.90
10RC-14FX	50	12-10	.250	1/4"	7	1.17	.50	.37	.90

UL Listed E9809.

Installing tools: WT145C, WT2000, WT112M, ERG2001, ERG2003

Please put the suffix "M" for Mylar Tape RA2573M. (Bulk number 1,000 and 500 packages.)

Non-Insulated & Nylon Insulated Locking Fork Terminals

Electrolytic copper offers high conductivity.

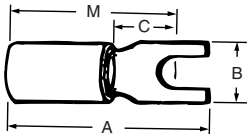

Non-Insulated Fork

- Can be installed with crimping tools having a single indenter or double indenter (recommended for solid wire)
- Serrated barrel increases grip on wire
- Wire range identification is stamped on the tongue of each terminal
- Stock thickness same as ring terminal of same size

Most standard bulk catalog numbers can be put on Mylar Tape for reel-fed applications (i.e., 12050 tool and application dies).



CAT. NO.	PKG. QTY.	WIRE RANGE	BOLT HOLE	WT./LBS. PER 1,000	DIMENSIONS			
					A	B	C	M
A18-6F	100	22-16	#6	4	.72	.25	.27	.59
A116	1,000	22-16	#6	4	.72	.25	.27	.59
A18-8F	100	22-16	#8	4	.75	.31	.27	.59
A114	1,000	22-16	#8	4	.75	.31	.27	.59
A18-10F	100	22-16	#10	4	.75	.31	.27	.59
A115	1,000	22-16	#10	4	.75	.31	.27	.59
B14-6F	100	18-14	#6	6	.75	.31	.27	.59
B64	1,000	18-14	#6	6	.75	.31	.27	.59
B19	1,000	18-14	#6	6	.66	.25	.13	.50
B14-8F	100	18-14	#8	6	.75	.31	.27	.59
B65	1,000	18-14	#8	6	.75	.31	.27	.59
B14-10F	100	18-14	#10	6	.75	.31	.27	.59
B115	1,000	18-14	#10	6	.75	.31	.27	.59
B14-14F	100	18-14	1/4"	6	.90	.44	.38	.68
C10-6F	50	12-10	#6	7	.77	.31	.27	.63
C133	500	12-10	#6	7	.77	.31	.27	.63
C10-8F	50	12-10	#8	7	.82	.38	.27	.63
C114	500	12-10	#8	7	.82	.38	.27	.63
C10-10F	50	12-10	#10	7	.82	.38	.27	.63
C115	500	12-10	#10	7	.82	.38	.27	.63
C10-14F	50	12-10	1/4"	7	.98	.50	.37	.73
C116	500	12-10	1/4"	7	.98	.50	.37	.73

UL® Listed E9809

Installing tools: WT111M, WT112M, WT110M, WT2000, ERG-2002

Please put the suffix "M" for Mylar Tape RA2573M. (Bulk number 1,000 and 500 packages.)

Goes on like a fork, stays on like a ring!

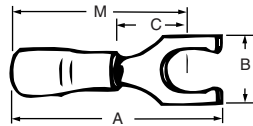

Nylon Insulated Locking Fork — Insulation Grip

- Specially designed tongue enables it to go on like a fork and stay on like a ring
- Stock thickness same as ring terminal of same size

Most standard bulk catalog numbers can be put on Mylar Tape for reel-fed applications (i.e., 12050 tool and application dies).



CAT. NO.	PKG. QTY.	WIRE RANGE	MAX. INS.	BOLT HOLE	WT./LBS. PER 1,000	DIMENSIONS			
						A	B	C	M
RA18-6FL	100	22-16	.136	#6	5	.86	.25	.25	.71
RA2213	1,000	22-16	.136	#6	5	.86	.25	.25	.71
RA18-8FL	100	22-16	.136	#8	5	.86	.29	.25	.71
RA2243	1,000	22-16	.136	#8	5	.86	.29	.25	.71
RA18-10FL	100	22-16	.136	#10	5	.86	.29	.25	.71
RA2253	1,000	22-16	.136	#10	5	.86	.29	.25	.71
RB14-6FL	100	18-14	.162	#6	6	.87	.25	.25	.71
RB2213	1,000	18-14	.162	#6	6	.87	.25	.25	.71
RB2214	1,000	18-14	.190	#6	6	.95	.25	.25	.79
RB14-8FL	100	18-14	.162	#8	6	.87	.29	.25	.71
RB2233	1,000	18-14	.162	#8	6	.87	.29	.25	.71
RB14-10FL	100	18-14	.162	#10	6	.87	.29	.25	.71
RB2253	1,000	18-14	.162	#10	6	.87	.29	.25	.71
RB2254	1,000	—	.190	#10	6	.95	.29	.25	.71
RC10-6FL	50	12-10	.210	#6	8	.97	.31	.27	.81
RC2203	500	12-10	.210	#6	8	.97	.31	.27	.81
RC2204	1,000	12-10	.250	#6	8	1.07	.31	.27	.91
RC10-8FL	50	12-10	.210	#8	8	1.00	.37	.27	.81
RC2213	500	12-10	.210	#8	8	1.00	.37	.27	.81
RC10-10FL	50	12-10	.210	#10	8	1.00	.37	.27	.81
RC2223	500	12-10	.210	#10	8	1.00	.37	.27	.81
RC2224	1,000	12-10	.250	#10	8	1.10	.37	.27	.91
RC10-14FL	50	12-10	.210	1/4"	8	1.12	.50	.32	.86
RC2233	500	12-10	.210	1/4"	8	1.12	.50	.32	.86

UL Listed E9809

Installing tools: ERG-2001, ERG-2003, WT145C, WT2000, WT112M, WT145A

Please put the suffix "M" for Mylar Tape RA2573M. (Bulk number 1,000 and 500 packages.)

Vinyl Insulated Fork Terminals

Stock thickness same as ring terminal of same size!

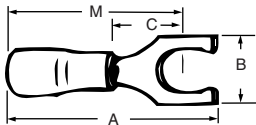

Vinyl Insulated Locking Fork — Insulation Support

Most standard bulk catalog numbers can be put on Mylar Tape for reel-fed applications (i.e., 12050 tool and application dies).



CAT. NO.	PKG. QTY.	WIRE RANGE	MAX. INS.	BOLT HOLE	WT./LBS. PER 1,000	DIMENSIONS			
						A	B	C	M
18RA-6FL	100	22-16	.150	#6	5	.97	.25	.25	.81
RA2217	1,000	22-16	.150	#6	5	.97	.25	.25	.81
RA2227	1,000	22-16	.155	#6	5	.97	.29	—	.81
18RA-8FL	100	22-16	.150	#8	5	.97	.29	.25	.81
RA2247	1,000	22-16	.150	#8	5	.97	.29	.25	.81
18RA-10FL	100	22-16	.150	#10	5	.97	.29	.25	.81
RA2257	1,000	22-16	.150	#10	5	.97	.29	.25	.81
14RB-6FL	100	18-14	.170	#6	6	.97	.25	.27	.81
RB2207	1,000	18-14	.170	#6	6	.97	.25	.27	.81
RB2217	1,000	—	.170	#6	6	.97	.29	.27	.81
14RB-8FL	100	18-14	.170	#8	6	.97	.29	.27	.81
RB2237	1,000	18-14	.170	#8	6	.97	.29	.27	.81
14RB-10FL	100	18-14	.170	#10	6	.97	.29	.27	.81
RB2257	1,000	18-14	.170	#10	6	.97	.29	.27	.81
10RC-6FL	50	12-10	.220	#6	8	1.09	.31	.27	.90
RC2207	500	12-10	.220	#6	8	1.09	.31	.27	.90
10RC-8FL	50	12-10	.220	#8	8	1.09	.37	.27	.90
RC2217	500	12-10	.220	#8	8	1.09	.37	.27	.90
10RC-10FL	50	12-10	.220	#10	8	1.09	.37	.27	.90
RC2227	500	12-10	.220	#10	8	1.09	.37	.27	.90
10RC-14FL	50	12-10	.220	¼"	8	1.09	.49	.27	.90
RC2237	500	12-10	.220	¼"	8	1.09	.49	.27	.90

UL® Listed E9809.

Installing tools: ERG-2001, ERG-2003, WT145C, WT2000, WT112M

Please put the suffix "M" for Mylar Tape RA2573M. (Bulk number 1,000 and 500 packages.)

Provides expanded insulation support.

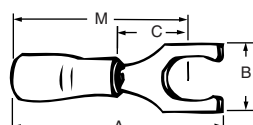

Vinyl Insulated Locking Fork — Expanded Insulation Support

- Stock thickness same as ring terminal of same size

Most standard bulk catalog numbers can be put on Mylar Tape for reel-fed applications (i.e., 12050 tool and application dies).



CAT. NO.	PKG. QTY.	WIRE RANGE	MAX. INS.	BOLT HOLE	WT./LBS. PER 1,000	DIMENSIONS			
						A	B	C	M
18RA-6FLX	100	22-16	.170	#6	5	.97	.25	.25	.81
18RA-8FLX	100	22-16	.170	#8	5	.97	.29	.25	.81
18RA-10FLX	100	22-16	.170	#10	5	.97	.29	.25	.81
RA2257-170	1,000	22-16	.170	#10	5	.97	.29	.25	.81
14RB-6FLX	100	18-14	.200	#6	6	.97	.31	.27	.81
RB2207-200	1,000	18-14	.200	#6	6	.97	.31	.27	.81
RB2217-200	1,000	18-14	.200	#6	6	.97	.29	.27	.81
14RB-8FLX	100	18-14	.200	#8	6	.97	.31	.27	.81
RB2237-200	1,000	18-14	.200	#8	6	.97	.31	.27	.81
14RB-10FLX	100	18-14	.200	#10	6	.97	.31	.27	.81
RB2257-200	1,000	18-14	.200	#10	6	.97	.31	.27	.81
10RC-6FLX	50	12-10	.250	#6	8	1.07	.31	.27	.91
RC2207-250	500	12-10	.250	#6	8	1.07	.31	.27	.91
10RC-8FLX	50	12-10	.250	#8	8	1.10	.37	.27	.91
10RC-10FLX	50	12-10	.250	#10	8	1.10	.37	.27	.91
RC2227-250	500	12-10	.250	#10	8	1.10	.37	.27	.91
10RC-14FLX	50	12-10	.250	¼"	8	1.22	.50	.32	.96

UL Listed E9809.

Installing tools: ERG-2001, ERG-2003, WT145C, WT2000, WT112M

Please put the suffix "M" for Mylar Tape RA2573M. (Bulk number 1,000 and 500 packages.)

Sta-Kon Terminal Products and Tools

Locking Fork & Pin Terminals



Locking fork terminals for a secure, tight fit.

Heat-Shrinkable Locking Fork Terminals — Expanded Insulation Support

- UL® Listed
- Expanded insulation support

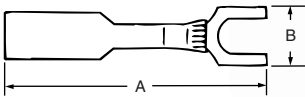

CAT. NO.	PKG. QTY.	WIRE RANGE	MAX. INS.	BOLT HOLE	WT./LBS. PER 1000	DIMENSIONS	
						A	B
RAS18-6FLX	100	22-18	.170	#6	5	1.350	.25
RAS18-8FLX	100	22-18	.170	#8	5	1.350	.29
RAS18-10FLX	100	22-18	.170	#10	5	1.350	.29
RBS14-6FLX	100	16-14	.200	#6	6	1.350	.25
RBS14-8FLX	100	16-14	.200	#8	6	1.350	.29
RBS14-10FLX	100	16-14	.200	#10	6	1.350	.29
RCS10-6FLX	50	12-10	.250	#6	8	1.350	.31
RCS10-8FLX	50	12-10	.250	#8	8	1.350	.37
RCS10-10FLX	50	12-10	.250	#10	8	1.350	.37
RCS10-14FLX	50	12-10	.250	1/4"	8	1.350	.49

UL Listed E9809

Installing tool: WT1255

NOTE: Heat-Shrinkable terminals not available on Mylar Tape.

Terminals that do the job right!

Non-Insulated Locking Fork Terminals

- Stock thickness same as ring terminal of same size
- UL Listed



Most standard bulk catalog numbers can be put on Mylar Tape for reel-fed applications (i.e., 12050 tool and application dies). See pages C??-C??.

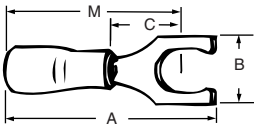

Easily terminate stranded wire into European/metric-style terminal blocks.

Pin Terminals

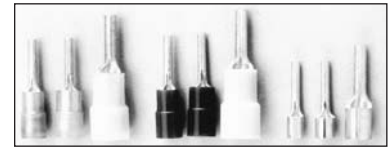

- Meets emerging global standards, requiring wire-to-metric style terminal block installations be terminated with a "pin" style terminal
- Available in vinyl insulated, nylon insulated, and non-insulated styles
- All styles offered in 22 AWG to 10 AWG and compatible with existing Sta-Kon® tooling

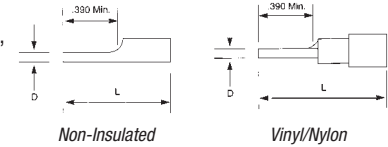

Voltage Rating: Vinyl – 300V Nylon – 300V

CAT. NO.	PKG. QTY.	WIRE RANGE	BOLT HOLE	WT./LBS. PER 1000	DIMENSIONS			
					A	B	C	M
A18-6FL	100	22-16	#6	4%	.75	.25	.27	.59
A221	1,000	22-16	#6	4%	.75	.25	.27	.59
A18-8FL	100	22-16	#8	4%	.75	.29	.27	.59
A224	1,000	22-16	#8	4%	.75	.29	.27	.59
A18-10FL	100	22-16	#10	4%	.75	.29	.27	.59
A225	1,000	22-16	#10	4%	.75	.29	.27	.59
B14-6FL	100	18-14	#6	4%	.75	.25	.27	.59
B220	1,000	18-14	#6	4%	.75	.25	.27	.59
B14-8FL	100	18-14	#8	4%	.75	.29	.27	.59
B223	1,000	18-14	#8	4%	.75	.29	.27	.59
B14-10FL	100	18-14	#10	4%	.75	.29	.27	.59
B225	1,000	18-14	#10	4%	.75	.29	.27	.59
C10-6FL	50	12-10	#6	7%	.85	.31	.27	.66
C220	500	12-10	#6	7%	.85	.31	.27	.66
C10-8FL	50	12-10	#8	7%	.85	.37	.27	.66
C221	500	12-10	#8	7%	.85	.37	.27	.66
C10-10FL	50	12-10	#10	7%	.85	.37	.27	.66
C222	500	12-10	#10	7%	.85	.37	.27	.66
C10-14FL	50	12-10	1/4"	7%	.85	.49	.27	.66

UL Listed E9809

Installing tools: WT110M, WT111M, WT112M, WT2000, ERG-2002

Please put the suffix "M" for Mylar Tape RA2573M. (Bulk number 1,000 and 500 packages.)

CAT. NO.	PKG. QTY.	WIRE RANGE	D (DIA.)	L	RECOMMENDED TOOLS
A47PT	1000	22-18	.075	.63	WT111M
B47PT	1000	16-14	.075	.63	ERG-2002
C55PT	500	12-10	.110	.76	
Vinyl					
18RA-47PT	100	22-18	.075	.85	ERG-2003
RA47PT	1000	22-18	.075	.85	
14RB-47PT	100	16-14	.075	.87	
RB47PT	1000	16-14	.075	.87	
10RC-55PT	50	12-10	.110	1.06	
RC55PT	500	12-10	.106	1.06	ERG-2001
Nylon					
RA18-47PT	100	22-18	.075	.85	ERG-2003
RA147PT	1000	22-18	.075	.85	WT2000
RB14-47PT	100	16-14	.075	.87	
RB147PT	1000	16-14	.075	.87	
RC10-55PT	50	12-10	.110	1.06	
RC155PT	500	12-10	.106	1.06	ERG-2001

Most standard bulk catalog numbers can be put on Mylar Tape for reel-fed applications (i.e., 12050 tool and application dies). See pages C??- C??.

Please put the suffix "M" for Mylar Tape RA2573M. (Bulk number 1,000 and 500 packages.)

Insulated Ferrules

Easy to use — just strip, slide, and crimp!

Insulated Ferrules

Features

- Ferrules ensure reliable electrical connections when terminating conductors in screw clamp terminal blocks
- Fraying and breaking of wire strands is prevented and the possibility of an unreliable connection is minimized
- Insulated ferrules prevent conductor breakage due to bending, wire stress, or vibration, while facilitating wire insertions into the terminal block clamp
- Ferrules are the preferred alternative to twisting wire stands or tinning the wire end before terminating into a terminal block
- Ferrules are thin-walled copper tubes, which are mechanically crimped onto the ends of stranded wires
- They are easy to use — simply strip the wire, slide the ferrule onto the end of the wire and crimp

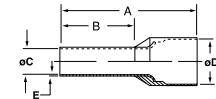

How to Apply a Ferrule

- Strip the insulation from the end of the wire and insert into the insulated end of the ferrule
- Using the designated crimping tool, place the metal shaft into the tool's appropriate slot. Compress the tool to make a crescent-shape depression along the length of the ferrule
- Insert the crimped ferrule into the terminal block
- Tighten the ferrule and wire into the terminal block

Materials

- High conductivity copper
- Tin plating

CAT. NO.	CONDUCTOR SECTION		COLOR	DIMENSIONS INCHES/MM					INSTALLATION TOOLING	BAG PKG. QTY.	CASE PKG. QTY.
	AWG	MM2		A	B	OC	OD	E			
F4004	26	0.14	Gray	.413/10.5	.236/6.0	.031/8.0	.079/2.0	.010/.25	T3, ERG2	500	10,000
F4005	26	0.14	Gray	.492/12.5	.315/8.0	.031/8.0	.079/2.0	.010/.25	T3, ERG2	500	10,000
F4006	24	0.25	Yellow	.413/10.5	.236/6.0	.031/8.0	.079/2.0	.010/.25	T3, ERG2	500	10,000
F4007	24	0.25	Yellow	.492/12.5	.315/8.0	.031/8.0	.079/2.0	.010/.25	T3, ERG2	500	10,000
F4008	22	0.34	Purple	.413/10.5	.236/6.0	.031/8.0	.079/2.0	.010/.25	T3, ERG2	500	10,000
F4009	22	0.34	Purple	.492/12.5	.315/8.0	.031/8.0	.079/2.0	.010/.25	T3, ERG2	500	10,000
F2020	20	0.50	White	.453/11.5	.236/6.0	.043/1.1	.098/2.5	.006/0.15	T1, T3 & ERG-2	500	5,000
F2021	20	0.50	White	.531/13.5	.315/8.0	.043/1.1	.098/2.5	.006/0.15	T1, T3 & ERG-2	500	10,000
F2022	20	0.50	White	.610/15.5	.394/10.0	.043/1.1	.098/2.5	.006/0.15	T1, T3 & ERG-2	500	5,000
F2023	18	0.75	Gray	.472/12.0	.236/6.0	.051/1.3	.110/2.8	.006/0.15	T1, T3 & ERG-2	500	5,000
F2024	18	0.75	Gray	.551/14.0	.315/8.0	.051/1.3	.110/2.8	.006/0.15	T1, T3 & ERG-2	500	10,000
F2025	18	0.75	Gray	.630/16.0	.394/10.0	.051/1.3	.110/2.8	.006/0.15	T1, T3 & ERG-2	500	5,000
F2026	18	0.75	Gray	.709/18.0	.472/12.0	.051/1.3	.110/2.8	.006/0.15	T1, T3 & ERG-2	500	5,000
F2027	18	0.75	Red	.492/12.5	.236/6.0	.059/1.5	.118/3.0	.006/0.15	T1, T3 & ERG-2	500	5,000
F2028	18	0.75	Red	.571/14.5	.315/8.0	.059/1.5	.118/3.0	.006/0.15	T1, T3 & ERG-2	500	10,000
F2029	18	0.75	Red	.650/16.5	.394/10.0	.059/1.5	.118/3.0	.006/0.15	T1, T3 & ERG-2	500	5,000
F2030	18	0.75	Red	.728/18.5	.472/12.0	.059/1.5	.118/3.0	.006/0.15	T1, T3 & ERG-2	500	5,000
F2031	16	1.50	Black	.571/14.5	.315/8.0	.071/1.8	.134/3.4	.006/0.15	T1, T3 & ERG-2	500	10,000
F2032	16	1.50	Black	.650/16.5	.394/10.0	.071/1.8	.134/3.4	.006/0.15	T1, T3 & ERG-2	500	5,000
F2033	16	1.50	Black	.728/18.5	.472/12.0	.071/1.8	.134/3.4	.006/0.15	T1, T3 & ERG-2	500	5,000
F2034	16	1.50	Black	.965/24.5	.708/18.0	.071/1.8	.134/3.4	.006/0.15	T1, T3 & ERG-2	500	5,000
F2035	14	2.50	Blue	.591/15.0	.315/8.0	.091/2.3	.165/4.2	.006/0.15	T1, T3 & ERG-2	500	10,000
F2036	14	2.50	Blue	.748/19.0	.472/12.0	.091/2.3	.165/4.2	.006/0.15	T1, T3 & ERG-2	500	5,000
F2037	14	2.50	Blue	.984/25.0	.708/18.0	.091/2.3	.165/4.2	.006/0.15	T1, T3 & ERG-2	500	5,000
F2038	12	4.00	Gray	.889/17.5	.394/10.0	.114/2.9	.189/4.8	.008/0.20	T3 & ERG-2	500	5,000
F2039	12	4.00	Gray	.787/20.0	.472/12.0	.114/2.9	.189/4.8	.008/0.20	T3 & ERG-2	500	5,000
F2040	12	4.00	Gray	1.024/26.0	.708/18.0	.114/2.9	.189/4.8	.008/0.20	T3 & ERG-2	100	1,000
F2041	10	6.00	Yellow	.787/20.0	.472/12.0	.142/3.6	.244/6.2	.008/0.20	T3 & ERG-2	100	1,000
F2042	10	6.00	Yellow	.984/25.0	.708/18.0	.142/3.6	.244/6.2	.008/0.20	T3 & ERG-2	100	1,000
F2043	8	10.00	Red	.827/21.0	.472/12.0	.181/4.6	.295/7.5	.008/0.20	T3 & ERG-2	100	1,000
F2044	8	10.00	Red	1.063/27.0	.708/18.0	.181/4.6	.295/7.5	.008/0.20	T3 & ERG-2	100	1,000
F2045	6	16.00	Blue	.906/23.0	.472/12.0	.236/6.0	.346/8.8	.008/0.20	ERG-2	100	1,000
F2046	6	16.00	Blue	1.142/29.0	.708/18.0	.236/6.0	.346/8.8	.008/0.20	ERG-2	50	1,000
F2047	4	25.00	Yellow	1.142/29.0	.630/18.0	.295/7.5	.433/11.0	.008/0.20	ERG-2	50	500
F2048	4	25.00	Yellow	1.220/31.0	.708/18.0	.295/7.5	.433/11.0	.008/0.20	ERG-2	50	500
F2049	4	25.00	Yellow	1.378/35.0	.866/22.0	.295/7.5	.433/11.0	.008/0.20	ERG-2	50	500
F2050	2	35.00	Red	1.181/30.0	.630/16.0	.335/8.5	.492/12.5	.008/0.20	ERG-2	50	500
F2051	2	35.00	Red	1.260/32.0	.708/18.0	.335/8.5	.492/12.5	.008/0.20	ERG-2	50	500
F2052	2	35.00	Red	1.535/39.0	.984/25.0	.335/8.5	.492/12.5	.008/0.20	ERG-2	50	500
F2053	1/0	50.00	Blue	1.417/36.0	.787/20.0	.413/10.5	.591/15.0	.014/0.35	ERG-2	50	500
F2054	1/0	50.00	Blue	1.614/41.0	.984/25.0	.413/10.5	.591/15.0	.014/0.35	ERG-2	50	500

Ferrule Dimensions conform to DIN 46228, Part 4.

Insulated Ferrules

Available in a variety of colors!

Insulated Twin Ferrules

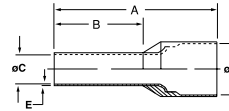

CAT. NO.	CONDUCTOR SECTION			DIMENSIONS INCHES/MM					INSTALLATION TOOLING	BAG PKG. QTY.	CASE PKG. QTY.
	AWG	MM	COLOR	A	B	OC	OD	E			
F8000	2x 20	2x 0.50	White	.591/15.0	.315/8.0	.059/1.5	.177/4.5	.010/0.25	T3	500	5,000
F8001	2x 18	2x 0.75	Gray	.591/15.0	.315/8.0	.071/1.8	.201/5.1	.010/0.25	T3	500	5,000
F8002	2x 18	2x 0.75	Gray	.669/17.0	.394/10.0	.071/1.8	.201/5.1	.006/0.15	T3	500	5,000
F8003	2x 17	2x 1.00	Red	.591/15.0	.315/8.0	.081/2.05	.201/5.1	.006/0.15	T3	500	5,000
F8005	2x 17	2x 1.00	Red	.669/17.0	.394/10.0	.081/2.05	.201/5.1	.006/0.15	T3	500	5,000
F8006	2x 16	2x 1.50	Black	.630/16.0	.315/8.0	.091/2.3	.252/6.4	.006/0.15	T3	500	5,000
F8007	2x 16	2x 1.50	Black	.787/20.0	.472/12.0	.091/2.3	.252/6.4	.006/0.15	T3	500	5,000
F8008	2x 14	2x 2.50	Blue	.728/18.5	.394/10.0	.114/2.9	.295/7.5	.006/0.15	T3	500	5,000
F8009	2x 14	2x 2.50	Blue	.846/21.5	.512/13.0	.114/2.9	.295/7.5	.006/0.15	T3	500	5,000
F8010	2x 12	2x 4.00	Gray	.906/23.0	.472/12.0	.150/3.8	.339/8.6	.006/0.15	ERG-2 / 6MM DIE	100	1,000
F8011	2x 10	2x 6.00	Yellow	.984/25.0	.551/14.0	.193/4.9	.378/9.6	.008/0.20	ERG-2 / 10MM DIE	100	1,000

Ferrule Dimensions conform to DIN 46228, Part 4.

Still available and ready to work for you!

Insulated Ferrules (Old DIN and French Standards)

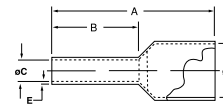

Cat. No.	STYLE	CONDUCTOR SECTION			DIMENSIONS INCHES/MM					INSTALLATION TOOLING	BAG PKG. QTY.	CASE PKG. QTY.
		AWG	MM	COLOR	A	B	OC	OD	E			
F4000	OLD DIN	20	0.50	Orange	.571/14.5	.315/8.0	.043/1.1	.102/2.6	.006/0.15	T1, T3 & ERG-2	500	10,000
F4001	OLD DIN	18	0.75	White	.571/14.5	.315/8.0	.051/1.3	.110/2.8	.006/0.15	T1, T3 & ERG-2	500	10,000
F4002	OLD DIN	18-17	1.00	Yellow	.571/14.5	.315/8.0	.059/1.5	.118/3.0	.006/0.15	T1, T3 & ERG-2	500	10,000
F4003	OLD DIN	16	1.50	Red	.571/14.5	.315/8.0	.071/1.8	.134/3.4	.006/0.15	T1, T3 & ERG-2	500	10,000
F4004		26	0.14	Gray	.413/10.5	.236/6.0	.031/0.80	.079/2.0	.010/0.25	T3, ERG2	500	10,000
F4005		26	0.14	Gray	.492/12.5	.315/8.0	.031/0.80	.079/2.0	.010/0.25	T3, ERG2	500	10,000
F4006		24	0.25	Yellow	.413/10.5	.236/6.0	.031/0.80	.079/2.0	.010/0.25	T3, ERG2	500	10,000
F4007		24	0.25	Yellow	.492/12.5	.315/8.0	.031/0.80	.079/2.0	.010/0.25	T3, ERG2	500	10,000
F4008		22	0.34	Purple	.413/10.5	.236/6.0	.031/0.80	.079/2.0	.010/0.25	T3, ERG2	500	10,000
F4009		22	0.34	Purple	.492/12.5	.315/8.0	.031/0.80	.079/2.0	.010/0.25	T3, ERG2	500	10,000
F4020	OLD DIN	14	2.50	Blue	.571/14.5	.315/8.0	.091/2.3	.165/4.2	.006/0.15	T1, T3 & ERG-2	500	10,000
F4021	FRENCH	20	0.50	White	.571/14.5	.315/8.0	.043/1.1	.102/2.6	.006/0.15	T1, T3 & ERG-2	500	10,000
F4023	FRENCH	18	0.75	Lt. Blue	.571/14.5	.315/8.0	.051/1.3	.110/2.8	.006/0.15	T1, T3 & ERG-2	500	10,000
F4024	FRENCH	18-17	1.00	Red	.571/14.5	.315/8.0	.059/1.5	.118/3.0	.006/0.15	T1, T3 & ERG-2	500	10,000
F4027	FRENCH	16	1.50	Black	.571/14.5	.315/8.0	.071/1.8	.134/3.4	.006/0.15	T1, T3 & ERG-2	500	10,000
F4028	FRENCH	14	2.50	Gray	.571/14.5	.315/8.0	.091/2.3	.165/4.2	.006/0.15	T1, T3 & ERG-2	500	10,000

Ferrule Dimensions conform to DIN 46228, Part 4.

The crimping tools you need!

Tooling for Sta-Kon® Insulated Ferrules

CAT. NO.	DESCRIPTION	STD. PKG.
T1	Sta-Kon® Crimp Tool for Wire Ferrules #20-14 AWG – Insulated Handle	1
T3	Sta-Kon® Crimp Tool for Wire Ferrules #26-10 AWG – Insulated Handle	1
ERG-2	Comfort Crimp® Sta-Kon® Crimp Tool with Shure-Stake® mechanism, for installing wire ferrules #26-1/0 AWG. 4 interchangeable die sets included. Insulated handle. Packaged in sturdy plastic carrying case.	1

ERG3000 Dies available.



Non-Insulated Ferrules



Ferrules for every application!

Uninsulated Ferrule Terminals

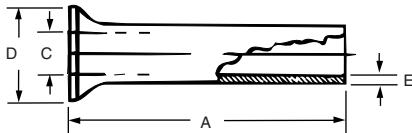

CAT. NO.	CONDUCTOR SECTION		DIMENSIONS (INCHES/MM)				INSTALLATION TOOLING	PKG. QTY.
	AWG	MM	A	C	D	E		
F9000	24	0.25	.196/5	.030/0.75	.067 / 1.7	.006/0.15	T1, ERG2	1,000
F9001	22	0.5	.236/6	.039/1.0	.083 / 2.1	.006/0.15	T1, T3, ERG2	1,000
F9002	22	0.5	.394/10	.039/1.0	.083 / 2.1	.006/0.15	T1, T3, ERG2	1,000
F9003	18	0.75	.236/6	.047/1.2	.091 / 2.3	.006/0.15	T1, T3, ERG2	1,000
F9004	18	0.75	.394/10	.047/1.2	.091 / 2.3	.006/0.15	T1, T3, ERG2	1,000
F9005	18	1	.236/6	.055/1.4	.098 / 2.5	.006/0.15	T1, T3, ERG2	1,000
F9006	18	1	.394/10	.055/1.4	.098 / 2.5	.006/0.15	T1, T3, ERG2	1,000
F9007	16	1.5	.276/7	.067/1.7	.110 / 2.8	.006/0.15	T1, T3, ERG2	1,000
F9008	16	1.5	.394/10	.067/1.7	.110 / 2.8	.006/0.15	T1, T3, ERG2	1,000
F9009	16	1.5	.473/12	.067/1.7	.110 / 2.8	.006/0.15	T1, T3, ERG2	1,000
F9010	16	1.5	.709/18	.067/1.7	.110 / 2.8	.006/0.15	T1, T3, ERG2	1,000
F9011	14	2.5	.276/7	.087/2.2	.139 / 3.4	.006/0.15	T1, T3, ERG2	1,000
F9012	14	2.5	.394/10	.087/2.2	.139 / 3.4	.006/0.15	T1, T3, ERG2	1,000
F9013	14	2.5	.472/12	.087/2.2	.139 / 3.4	.006/0.15	T1, T3, ERG2	1,000
F9014	14	2.5	.709/18	.087/2.2	.139 / 3.4	.006/0.15	T1, T3, ERG2	1,000
F9015	12	4	.354/9	.110/2.8	.158 / 4	.008/0.2	T3, ERG2	1,000
F9016	12	4	.472/12	.110/2.8	.158 / 4	.008/0.2	T3, ERG2	1,000
F9017	12	4	.591/15	.110/2.8	.158 / 4	.008/0.2	T3, ERG2	1,000
F9018	12	4	.709/18	.110/2.8	.158 / 4	.008/0.2	T3, ERG2	1,000
F9019	10	6	.472/12	.138/3.5	.185 / 4.7	.008/0.2	T3, ERG2	1,000
F9020	10	6	.591/15	.138/3.5	.185 / 4.7	.008/0.2	T3, ERG2	1,000
F9021	10	6	.709/18	.138/3.5	.185 / 4.7	.008/0.2	T3, ERG2	1,000
F9022	8	10	.472/12	.177/4.5	.228 / 5.8	.008/0.2	T3, ERG2	500
F9023	8	10	.591/15	.177/4.5	.228 / 5.8	.008/0.2	T3, ERG2	500
F9024	8	10	.709/18	.177/4.5	.228 / 5.8	.008/0.2	T3, ERG2	500
F9025	6	16	.472/12	.228/5.8	.295 / 7.5	.008/0.2	T3, ERG2	250
F9026	6	16	.591/15	.228/5.8	.295 / 7.5	.008/0.2	T3, ERG2	250
F9027	6	16	.709/18	.228/5.8	.295 / 7.5	.008/0.2	T3, ERG2	250
F9028	6	16	.984/25	.228/5.8	.295 / 7.5	.008/0.2	T3, ERG2	250
F9029	6	16	1.26/32	.228/5.8	.295 / 7.5	.008/0.2	T3, ERG2	250
F9030	4	25	.591/15	.287/7.3	.374 / 9.5	.010/25	ERG2	100
F9031	4	25	.709/18	.287/7.3	.374 / 9.5	.010/25	ERG2	100
F9032	4	25	.984/25	.287/7.3	.374 / 9.5	.010/25	ERG2	100
F9033	4	25	1.26/32	.287/7.3	.374 / 9.5	.010/25	ERG2	100
F9034	2	35	.709/18	.327/8.3	.433 / 11	.010/25	ERG2	100
F9035	2	35	.984/25	.327/8.3	.433 / 11	.010/25	ERG2	100
F9036	2	35	1.26/32	.327/8.3	.433 / 11	.010/25	ERG2	100
F9037	Jan-00	50	.709/18	.406/10.3	.512 / 13	.012/0.3	ERG2	100
F9038	Jan-00	50	.984/25	.406/10.3	.512 / 13	.012/0.3	ERG2	100
F9039	Jan-00	50	1.18/30	.406/10.3	.512 / 13	.012/0.3	ERG2	100

Heat-Shrinkable Terminals, Splices, and Disconnects

The heat shrinkable advantage!

- These ring terminals, butt splices, and disconnects are self-insulated with heat-shrinkable polyolefin and internally coated sealant
- Upon completed installation, a fully sealed connection is achieved to protect the joint against the degrading effects of galvanic action, corrosion, and environmental exposure



Protects joints!

Heat-Shrinkable Ring Terminals — Expanded Insulation Support



- Self-insulated with heat shrinkable polyolefin and internally coated sealant. Upon completed installation, a fully sealed connection is achieved to protect the joint

RAS & RBS stock thickness: .03

RCS stock thickness: .04

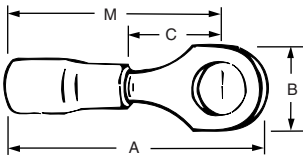

CAT. NO.	PKG. QTY.	WIRE RANGE	MAX. INS.	BOLT HOLE	WT./LBS. PER 1,000	DIMENSIONS			
						A	B	C	M
RAS18-6X	100	22-18	.170	#6	2	1.23	.25	.27	1.10
RAS18-8X	100	22-18	.170	#8	3	1.26	.31	.27	1.10
RAS18-10X	100	22-18	.170	#10	2	1.26	.31	.27	1.10
RBS14-6X	100	16-14	.200	#6	3	1.23	.25	.27	1.10
RBS14-8X	100	16-14	.200	#8	3	1.23	.25	.27	1.10
RBS14-10X	100	16-14	.200	#10	3½	1.26	.31	.27	1.10
RCS10-6X	50	12-10	.250	#6	3	1.34	.31	.27	1.15
RCS10-8X	50	12-10	.250	#8	5	1.34	.37	.27	1.15
RCS10-10X	50	12-10	.250	#10	5	1.34	.37	.27	1.15
RCS10-14X	50	12-10	.250	b"	6	1.34	.49	.32	1.15

UL® Listed E9809

Installing tool: WT1255

NOTE: Not available on Mylar Tape.

Fully sealed connections!

Heat-Shrinkable Locking Fork Terminals — Expanded Insulation Support



CAT. NO.	PKG. QTY.	WIRE RANGE	MAX. INS.	BOLT HOLE	WT./LBS. PER 1,000	DIMENSIONS	
						A	B
RAS18-6FLX	100	22-18	.170	#6	5	1.350	.25
RAS18-8FLX	100	22-18	.170	#8	5	1.350	.29
RAS18-10FLX	100	22-18	.170	#10	5	1.350	.29
RBS14-6FLX	100	16-14	.200	#6	6	1.350	.25
RBS14-8FLX	100	16-14	.200	#8	6	1.350	.29
RBS14-10FLX	100	16-14	.200	#10	6	1.350	.29
RCS10-6FLX	50	12-10	.250	#6	8	1.350	.31
RCS10-8FLX	50	12-10	.250	#8	8	1.350	.37
RCS10-10FLX	50	12-10	.250	#10	8	1.350	.37
RCS10-14FLX	50	12-10	.250	¼"	8	1.350	.49

UL Listed E9809

Installing tool: WT1255

NOTE: Heat Shrinkable terminals not available on Mylar Tape.

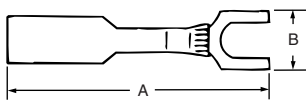

Heat-Shrinkable Terminals, Splices, and Disconnects

The disconnects you need!
**Heat-Shrinkable — Fully Insulated
 250 Disconnects — Female**

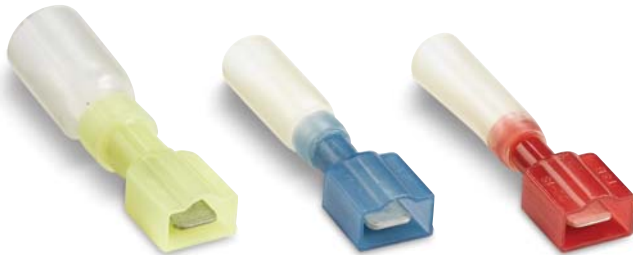

CAT. NO.	PKG. QTY.	WIRE RANGE	MAX. INS.	TAB SIZE	WT./LBS. PER 1,000	A
RAS18-250AX	25	22-18	.170	.250 x .032	4	1.82
RBS14-250AX	25	16-14	.200	.250 x .032	5	1.77
RCS10-250AX	25	12-10	.250	.250 x .032	6	1.80

Installing tool: WT1255

Available in the wire ranges you need!

**Heat-Shrinkable — Fully Insulated
 250 Disconnects — Male**



CAT. NO.	PKG. QTY.	WIRE RANGE	MAX. INS.	TAB SIZE	WT./LBS. PER 1,000	A
18RAS-251TX	25	22-18	.170	.250 x .032	4	1.80
14RBS-251TX	25	16-14	.200	.250 x .032	5	1.75
10RCS-251TX	25	12-10	.250	.250 x .032	6	1.80

Installing tool: WT1255

These butt splices are self-insulated with heat shrinkable polyolefin and internally coated sealant.

**Heat-Shrinkable Splices —
 Butt Type — Expanded Insulation**



- Upon completed installation, a fully sealed connection is achieved to protect the joint against the degrading effects of galvanic action, corrosion, and environmental exposure

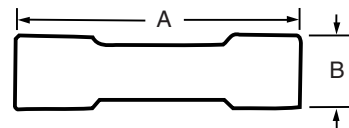

CAT. NO.	PKG. QTY.	WIRE RANGE	MAX. INS.	WT./LBS. PER 1,000	DIMENSIONS A	B
RAA217	50	22-18	.150	3	1.50	.25
2RAS18X	50	22-18	.170	3	1.50	.25
2RA18X	50	22-18	.170	3	1.50	.25
2RAA217-170	50	22-18	.170	3	1.50	.25
RAAS22X	500	22-18	.170	3	1.50	.25
RBB217	50	16-14	.170	3	1.50	.26
2RBS14X	50	16-14	.200	3	1.50	.26
2RB14X	50	16-14	.200	3	1.50	.26
2RBB217-200	50	16-14	.200	3	1.50	.26
RBBS22X	500	16-14	.200	3	1.50	.26
2RCS10X	25	12-10	.250	7	1.60	.31
2RC10X	25	12-10	.250	7	1.60	.31
RCC217-250	25	12-10	.250	7	1.60	.31
RCCS22X	250	12-10	.250	7	1.60	.31
RCC217	250	12-10	.210	7	1.60	.31

Installing tool: WT1255

Splice Connectors

Butt Type Splices

- Wires are butted together and crimped at each end of the splice
- Available either non-insulated or insulated with nylon or PVC
- Nylon insulated splices meet or exceed the requirements of MIL-T-7928
- Color-coded according to wire size

Engineered for aircraft systems!

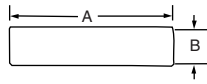

Nylon Insulated Splices — Aircraft Systems Splices



CAT. NO.	PKG. QTY.	WIRE RANGE	WT./LBS. PER 1,000	DIMENSIONS	
				A	B
2RZZ	50	26-22	2	1.22	.15
2RAA	50	22-18	6	1.52	.25
RAA23	500	22-18	6	1.52	.25
2RBB	50	16-14	6	1.52	.28
RBB23	500	16-14	6	1.52	.28
2RCC	25	12-10	8	1.53	.35
RCC23	250	12-10	8	1.53	.35

Not UL® Listed

Installing Tools: WT145C, ERG-2001, ERG-2003 (For RAA, RBB, RCC Only), WT1452 (RZZ)

Meets or exceeds MIL-T-7928 requirements!

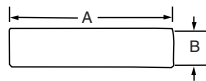

Nylon Insulated Splices — Butt Type — Insulation Support



CAT. NO.	PKG. QTY.	MAX INS. DIA.	WIRE RANGE	WT./LBS. PER 1,000	DIMENSIONS	
					A	B
2RA18	100	.115	22-18	3	1.19	.18
RAA21	1,000	.115	22-18	3	1.19	.18
2RB14	100	.148	16-14	3	1.19	.21
RBB21	1,000	.148	16-14	3	1.19	.21
2RC10	50	.210	12-10	7	1.26	.28
RCC21	500	.210	12-10	7	1.26	.28
2RD8	25	.340	8	25	1.69	.36
RDD27	200	.340	8	25	1.69	.36
2RE6	20	.420	6	35	1.85	.45
REE28	200	.420	6	35	1.85	.45
2RF4	15	.510	4	40	1.85	.52

UL Listed E9809

Installing tools: ERG-2001, ERG-2003, WT145C, WT112M, TBM6/TBM6S (D-F)

NOTE: Not available on Mylar Tape.

Select the wire range and quantity needed!



Vinyl Insulated Splices — Butt Type — Expanded Insulation



CAT. NO.	PKG. QTY.	WIRE RANGE	MAX. INS.	WT./LBS. PER 1,000	DIMENSIONS	
					A	B
2RA18X	100	22-18	.170	3	1.13	.25
RAA217-170	1,000	22-18	.170	3	1.13	.25
RAA217	1,000	22-18	.155	3	1.13	.23
2RB14X	100	16-14	.200	3	1.13	.26
RBB217-200	1,000	16-14	.200	3	1.13	.26
RBB217	1,000	16-14	—	3	1.13	.23
2RC10X	50	12-10	.210	7	1.31	.31
RCC217-250	500	12-10	.250	7	1.31	.31
RCC217	1,000	12-10	.210	7	1.31	.29

UL Listed E9809

Installing tools: WT145C, WT2000, WT112M, ERG-2001, ERG-2003

Bulk Nos.: RAA22X- RBB22X - RCC22X

UL Listed E9809!

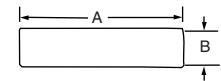

Non-Insulated Splices — Butt Type

- A, B, and C bulk numbers can be put on Mylar Tape for reel-fed applications (i.e., 12050 tool and application dies).
- Please put the suffix "M" for Mylar Tape RA2573M. (Bulk number 1,000 and 500 packages.)



CAT. NO.	PKG. QTY.	WIRE RANGE	WT./LBS. PER 1,000	DIMENSIONS	
				A	B
2A-18	100	22-18	2½	.62	.12
AA2	1,000	22-18	2½	.62	.12
2B-14	100	16-14	2½	.62	.16
BB2	1,000	16-14	2½	.62	.16
2C-10	50	12-10	7	.72	.22
CC2	500	12-10	7	.72	.22
2D-8	25	9-8-7	18	1.03	.28
DD102	200	9-8-7	18	1.03	.28
2E-6	20	6-5	25	1.12	.37
EE2	200	6-5	25	1.12	.37
2F-4	15	4-3	30	1.25	.44
FF2	200	4-3	30	1.25	.44
2G21	5	2-1	40	1.72	.55
GG2	25	2-1	40	1.72	.55

Installing tools: A, B, C: WT111M, WT110M, WT2000, ERG-2002, WT112M

Installing tools: D, E, F, G: WT115A, TBM6/TBM6S

Splice Connectors

Easy to install!

Nylon Insulated Splices — Overlap Type (Parallel)

- Wires are laid side by side in the connector, and the connection is made in one crimp
- Offer advantages in simplicity of installation and small size
- One crimp completes the splice



CAT. NO.	PKG. QTY.	WIRE RANGE	WT./LBS. PER 1,000	DIMENSIONS	
				A	B
2A20	100	22-20	2	.84	.20
RAA24	1,000	22-20	2	.84	.20
2B-16	100	18-16	2	.84	.23
RBB25	1,000	18-16	2	.84	.23
2C-12	50	14-12	4	.90	.28
RCC26	500	14-12	4	.90	.28

UL® Listed E9809

Installing tools: WT2000, WT112M

Offers solutions for hundreds of OEM, utility, and communications applications!

Sta-Kon® Parallel Splices

- Provide excellent reliability, long-term performance, and a UL listed connection at a low installed cost
- Resistant to corrosion and preserve the electrical integrity of the wires in single or multiple strands
- Feature an intelligent constructable part number for quick identification of the wire range and pack quantity

CAT. NO.	WIRE SIZE	CIR MIL RANGE	LENGTH (A)	O.D. (B)	I.D. (C)	PACK QTY.	UPC NUMBER
A18-PS-M	22-16 AWG	509-3,260	0.314	0.129	0.086	1,000	78621093625
B14-PS-M	16-14 AWG	2,050-5,180	0.315	0.155	0.113	1,000	78621093626
C10-PS-D	12-10 AWG	5,180-13,100	0.380	0.220	0.170	500	78621093627
D8-PS-D	8 AWG	13,100-20,800	0.375	0.260	0.180	500	78621089076
E6-PS-D	6 AWG	20,800-33,100	0.500	0.365	0.266	500	78621089080
F4-PS-W	4 AWG	33,100-52,600	0.531	0.410	0.302	250	78621089082
G2-PS-W	2 AWG	52,600-83,700	0.640	0.521	0.396	250	78621089084
H1/0-PS-C	1/0 AWG	83,700-119,500	0.750	0.571	0.446	100	78621089086
J2/0-PS-C	2/0 AWG	119,500-150,500	0.750	0.632	0.507	100	78621089078
K3/0-PS-L	3/0 AWG	150,500-190,000	0.750	0.701	0.564	50	78621089777
L4/0-PS-L	4/0 AWG	190,000-231,100	0.770	0.766	0.629	50	78621089092
M250-PS-Q	250 MCM	231,100-300,000	1.063	0.926	0.749	25	78621089094
N300-PS-X	300 MCM	300,000-380,000	1.125	1.100	0.882	10	78621089096
P400-PS-X	400 MCM	380,000-478,000	1.250	1.200	0.956	10	78621089098
R500-PS-V	500 MCM	478,000-600,000	1.438	1.330	1.060	5	78621089100

The total combined cross sectional area of all wires must be within the CMA range.

Color coded according to wire size!

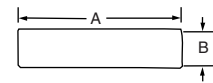

Tefzel® Insulated Butt Splice



CAT. NO.	PKG. QTY.	WIRE RANGE	WT./LBS. PER 1,000	DIMENSIONS A	MAX. INS. DIA.
RAAT21	1,000	22-18	3	1.22	.115
RBBT21	1,000	16-14	3	1.22	.148
RCCT21	1,000	12-10	7	1.22	.210

Installing tool: WT-145C

Tefzel® is a registered trademark of DuPont.

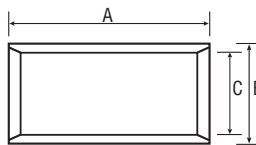

Specifications

Material — Tin-plated Copper

Range — 22AWG to 500 MCM

Listing — UL, CSA Listed

Wire Size

22-10 AWG

16-6 AWG

8-2 AWG

1/0 AWG-500 MCM

Tools

ERG2002, WT111M, WT112M, WT2000

ERG2005

WT115A, TBM8-750M1, TBM8-750BSCR

TBM8-750M1, TBM8-750BSCR



Disconnects

Quick, reliable method of connection to terminal blocks and boards without the use of tools!

250 Series — Female Disconnects

1

RA18-250F

Nylon self-insulated

Installing tools: WT145C, WT2000, ERG-2001, ERG-2003, WT112M



2

18RA-250F

Vinyl self-insulated

Installing tools: WT145C, WT2000, ERG-2001, ERG-2003, WT112M



3

18RA-2577

Nylon fully insulated

Installing tools: WT145C, WT2000, ERG-2001, ERG-2003, WT112M



4

RAS18-250AX

Heat-shrinkable fully insulated disconnects

Installing tool: WT1255



5

RA18-250A

Nylon open top insulated 90° flag

Installing tools: WT145C, WT2000, ERG-2001, ERG-2003, WT112M



6

A18-250

Non-insulated

Installing tools: WT111M, WT1110M, WT2000, ERG-2002, WT112M



7

B14-250F

Non-insulated/insulation grip

Installing tool: WT110M



8

A18-250A

Non-insulated 90° flag

Installing tools: WT110M, WT111M, WT2000, ERG-2002, WT112M



Most standard bulk catalog numbers can be put on Mylar Tape for reel-fed applications (i.e., 12050 tool and application dies). See pages C??- C?? for description of tooling.

Please add the suffix "M" for Mylar Tape (i.e., RA2573-M).

- Supplied in a variety of styles to meet virtually all quick-disconnect requirements
- Female disconnect terminals and matching male tabs accommodate a range of 22–10 AWG, and are available in non-insulated, partially insulated, and fully insulated styles, in both nylon and vinyl
- Available in various tab widths including .250", .187", and .110", and a combination size

- Unique construction of the female disconnect offers long-term dependability
- Brazed seam serrated barrel provides maximum tensile strength

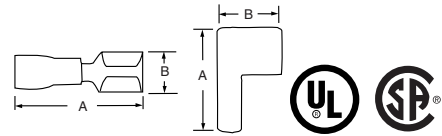

CAT. NO.	PKG. QTY.	WIRE RANGE	MAX. INS.	TAB SIZE	WT./LBS. PER 1,000	DIMENSIONS	
						A	B
RA18-250F	100	22–18	.136	.250 x .032	4	.91	.29
RA250	1,000	22–18	.136	.250 x .032	4	.91	.29
RB14-250F	100	16–14	.162	.250 x .032	4	.91	.29
RB250	1,000	16–14	.162	.250 x .032	4	.91	.29
RC10-250F	50	12–10	.215	.250 x .032	4	1.04	.29
RC250	500	12–10	.215	.250 x .032	4	1.04	.29
18RA-250F	100	22–18	.150	.250 x .032	3	.96	.29
RA257	1,000	22–18	.150	.250 x .032	3	.96	.29
RA257-170	1,000	22–18	.170	.250 x .032		.96	.29
14RB-250F	100	16–14	.170	.250 x .032	3	.96	.29
RB257	1,000	16–14	.170	.250 x .032	3	.96	.29
RB257-200	1,000	16–14	.200	.250 x .032		.96	.29
10RC-250F	50	12–10	.250	.250 x .032	4	1.03	.29
RC257	500	12–10	.250	.250 x .032	4	1.03	.29
18RA-2577	100	22–18	.165	.250 x .032	3	1.01	.38
RA2573	1,000	22–18	.165	.250 x .032	3	1.01	.38
14RB-2577	100	16–14	.185	.250 x .032	4	1.01	.38
RB2573	1,000	16–14	.185	.250 x .032	4	1.01	.38
10RC-2577	50	12–10	.225	.250 x .032	5	1.04	.38
RC2573	500	12–10	.225	.250 x .032	5	1.04	.38
RAS18-250AX	50	22–18	.170	.250 x .032	4	1.83	—
RBS14-250AX	50	16–14	.200	.250 x .032	5	1.78	—
RCS10-250AX	25	12–10	.250	.250 x .032	6	1.80	—
RA18-250A	50	22–18	.170	.250 x .032	4	.80	.71
RA2577F	500	22–18	.170	.250 x .032	4	.80	.71
RB14-250A	50	16–14	.190	.250 x .032	5	.80	.72
RB2577F	500	16–14	.190	.250 x .032	5	.80	.72
RC10-250A	50	12–10	.245	.250 x .032	6	.80	.88
RC2577F	500	12–10	.245	.250 x .032	6	.80	.88
A18-250	100	22–18	—	.250 x .032	3	.73	.31
A250	1,000	22–18	—	.250 x .032	3	.73	.31
B14-250	100	16–14	—	.250 x .032	3	.73	.31
B250	1,000	16–14	—	.250 x .032	3	.73	.31
C10-250F	50	12–10	—	.250 x .032	4	.73	.31
C250	500	12–10	—	.250 x .032	4	.73	.31
B14-250F	100	16–14	—	.250 x .032	5	.87	.31
B250G	1,000	16–14	—	.250 x .032	5	.87	.31
A18-250A	50	22–18	—	.250 x .032	3	.58	.61
A252G	500	22–18	—	.250 x .032	3	.58	.61
B14-250A	50	16–14	—	.250 x .032	3	.58	.62
B252G	500	16–14	—	.250 x .032	3	.58	.62
C10-250A	50	12–10	—	.250 x .032	4	.64	.63
C252G	500	12–10	—	.250 x .032	4	.64	.63

Material: brass Finish: tin plated

UL® Listed E66716

Designed for stacking applications!

250 Series — Piggy Back Disconnects — Nylon Insulated

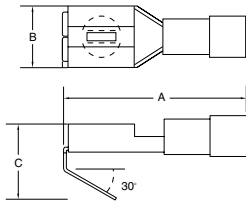

CAT. NO.	PKG. QTY.	WIRE RANGE	MAX. INS.	TAB SIZE	WT./LBS. PER 1,000	DIMENSIONS		
						A	B	C
RA18-250FP	100	22-18	.136	.250 x .032	3	.87	.30	.43
RA250P	1,000	22-18	.136	.250 x .032	3	.87	.30	.43
RB14-250FP	100	16-14	.163	.250 x .032	3	.87	.30	.43
RB250P	1,000	16-14	.163	.250 x .032	3	.87	.30	.43

For stacking applications. **Installing Tool:** WT112M

Connect without tools!

187 Series — Female Disconnects

1
RAD18-183
 Nylon self-insulated
Installing tools: WT145C, WT2000, ERG-2001, ERG-2003, WT112M

2
18RAD-183
 Vinyl self-insulated
Installing tools: WT145C, WT2000, ERG-2001, ERG-2003, WT112M

3
18RAD-18377
 Nylon fully insulated
Installing tools: WT145C, WT2000, ERG-2001, ERG-2003, WT112M

4
AD18-183
 Non-insulated
Installing tools: WT111M, ERG-2002, WT2000, WT112M

5
RAD18-187A
 Nylon fully insulated 90° flange
Installing tools: WT1145C, WT2000, ERG-2001, ERG-2003, WT112M

Most standard bulk catalog numbers can be put on Mylar Tape for reel-fed applications (i.e., 12050 tool and application dies). See pages C??- C?? for description of tooling.

Please add the suffix "M" for Mylar Tape (i.e., RA2573-M).

- Quick, reliable method of connection to terminal blocks and boards without the use of tools
- Available in various tab widths including .250", .187", and .110", and a combination size
- Supplied in a variety of styles to meet virtually all quick-disconnect requirements
- Unique construction of the female disconnect offers long-term dependability
- Female disconnect terminals and matching male tabs accommodate a range of 22-10 AWG, and are available in non-insulated, partially insulated, and fully insulated styles, in both nylon and vinyl

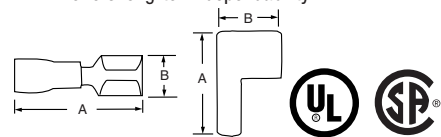

CAT. NO.	PKG. QTY.	TAB SIZE	WIRE RANGE	MAX. INS. DIA.	DIMENSIONS	
					A	B
RAD18-183	100	.187 x .032	22-18	.136	.83	.23
RAD1833	1,000	.187 x .032	22-18	.136	.83	.23
RAD18-182	100	.187 x .020	22-18	.136	.83	.23
RAD1823	1,000	.187 x .020	22-18	.136	.83	.23
RBD14-183	100	.187 x .032	16-14	.163	.83	.23
RBD1833	1,000	.187 x .032	16-14	.163	.83	.23
RBD14-182	100	.187 x .020	16-14	.163	.83	.23
RBD1823	1,000	.187 x .020	16-14	.163	.83	.23
18RAD-183	100	.187 x .032	22-18	.150	.85	.23
RAD1837	1,000	.187 x .032	22-18	.150	.85	.23
18RAD-182	100	.187 x .020	22-18	.150	.85	.23
RAD1827	1,000	.187 x .020	22-18	.150	.85	.23
14RBD-183	100	.187 x .032	16-14	.170	.85	.23
RBD1837	1,000	.187 x .032	16-14	.170	.85	.23
14RBD-182	100	.187 x .020	16-14	.170	.85	.23
RBD1827	1,000	.187 x .020	16-14	.170	.85	.23
18RAD-18377	100	.187 x .032	22-18	.150	.89	.30
RAD18377	1,000	.187 x .032	22-18	.150	.89	.30
18RAD-18277	100	.187 x .020	22-18	.150	.89	.30
RAD18277	1,000	.187 x .020	22-18	.150	.89	.30
14RBD-18377	100	.187 x .032	16-14	.170	.89	.30
RBD18377	1,000	.187 x .032	16-14	.170	.89	.30
14RBD-18277	100	.187 x .020	16-14	.170	.89	.30
RBD18277	1,000	.187 x .020	16-14	.170	.89	.30
AD18-183	100	.187 x .032	22-18	—	.64	.23
AD183	1,000	.187 x .032	22-18	—	.64	.23
AD18-182	100	.187 x .020	22-18	—	.64	.23
AD182	1,000	.187 x .020	22-18	—	.64	.23
BD14-183	100	.187 x .032	16-14	—	.64	.23
BD183	1,000	.187 x .032	16-14	—	.64	.23
BD14-182	100	.187 x .020	16-14	—	.64	.23
RAD18-187A	50	.187 x .032	22-18	.150	.74	.59
RAD1877F	500	.187 x .032	22-18	.150	.74	.59
RAD18-188A	50	.187 x .020	22-18	.150	.74	.59
RAD1887F	500	.187 x .020	22-18	.150	.74	.59
RBD14-187A	50	.187 x .032	16-14	.170	.74	.61
RBD1877F	500	.187 x .032	16-14	.170	.74	.61
RBD14-188A	50	.187 x .020	16-14	.170	.74	.61
RBD1887F	500	.187 x .020	16-14	.170	.74	.61

Material: brass **Finish:** tin plated U.L. Listed E66716

Disconnects

Select the tabs you need!

250 Series — Male Tabs

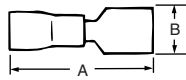

Most standard bulk catalog numbers can be put on Mylar Tape for reel-fed applications (i.e., 12050 tool and application dies).

Please add the suffix "M" for Mylar Tape (i.e., RA2573-M).



Sta-Kon Terminal Products and Tools

1

18RA-250T

Vinyl self-insulated

Installing tools: WT145C, WT2000, ERG-2001, ERG-2003, WT112M



2

18RA-251T

Nylon fully insulated

Installing tools: WT145C, WT2000, ERG-2001, ERG-2003, WT112M



3

18RAS-251TX

Heat-shrinkable nylon fully insulated

Installing tool: WT1255



4

A18-250T

Non-insulated/insulated grip

Installing tool: WT110M



5

18-251T

Non-insulated

Installing tools: WT110M, WT111M, WT2000, WT112M, ERG-2002, WT112M



6

18RAD-187

Vinyl insulated

Installing tools: WT145C, WT2000, ERG-2001, ERG-2003, WT112M



7

F250TA

Non-insulated



8

RB14-250

Insulated coupler

No tool required

Male



CAT. NO.	PKG. QTY.	WIRE RANGE	MAX. INS.	TAB SIZE	WT./LBS. PER 1,000	DIMENSIONS	
						A	B
18RA-250T	100	22-18	.150	.250 x .032	3	.95	—
RA2517	1,000	22-18	.150	.250 x .032	3	.95	—
14RB-250T	100	16-14	.170	.250 x .032	3	.95	—
1 RB2517	1,000	16-14	.170	.250 x .032	3	.95	—
10RC-250T	50	12-10	.250	.250 x .032	4	1.08	—
RC2517	500	12-10	.250	.250 x .032	4	1.08	—
18RA-251T	50	22-18	.150	.250 x .032	5	1.13	.45
RA25177	500	22-18	.150	.250 x .032	5	1.13	.45
14RB-251T	50	16-14	.170	.250 x .032	5	1.13	.45
1 RB25177	500	16-14	.170	.250 x .032	5	1.13	.45
10RC-251T	25	12-10	.210	.250 x .032	5	1.17	.45
RC25177	500	12-10	.210	.250 x .032	5	1.17	.45
18RAS-251TX	50	22-18	.170	.250 x .032	4	1.80	—
14RBS-251TX	100	16-14	.200	.250 x .032	5	1.75	—
10RCS-251TX	100	12-10	.250	.250 x .032	6	1.80	—
A18-250T	100	22-18	—	.250 x .032	3	.87	—
B14-250T	100	20-14	—	.250 x .032	3	.87	—
A18-251T	100	22-18	—	.250 x .032	2	.68	—
A251	1,000	22-18	—	.250 x .032	2	.68	—
B14-251T	100	16-14	—	.250 x .032	2	.68	—
B251	1,000	16-14	—	.250 x .032	2	.68	—
C10-251T	50	12-10	—	.250 x .032	2	.68	—

Material: brass Finish: tin plated

187 Series — Male Tabs

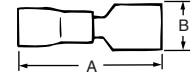

CAT. NO.	PKG. QTY.	TAB SIZE	WIRE RANGE	MAX. INS.	WT./LBS. PER 1,000	DIA. A
18RAD-187	100	.187 x .032	22-18	.150	4	.87
18RAD-188	100	.187 x .020	22-18	.150	4	.87
14RBD-187	100	.187 x .032	16-14	.170	4	.87
14RBD-188	100	.187 x .020	16-14	.170	4	.87

UL® Listed E66716 Material: brass Finish: tin plated

Insulated coupler requires no tool!

250 Series — Adapters and Coupler†

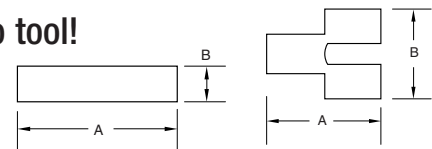

CAT. NO.	PKG. QTY.	TAB SIZE	WT./LBS. PER 1,000	DIMENSIONS	
				A	B
F250TA	50	.250 x .032	3	.82	.56
FTA250	500	.250 x .032	3	.82	.56
RB14-250	50	.250 x .032	7	2.35	.51
RBB250	500	.250 x .032	7	2.35	.51

† Not UL Listed

Cat. No. F250TA — Material: brass Finish: tin plated

Cat. No. RB14-250 — Material: brass Finish: none Insulation: vinyl

Disconnects

Available in variety of wire ranges!

110 Series — Disconnects*

9

RA18-111F
Nylon-insulated
Installing tool: WT465



10

A18-111F
Non-insulated
Installing tools: WT111M, WT2000, WT112M

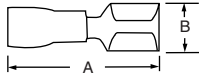
Most standard bulk catalog numbers can be put on Mylar Tape for reel-fed applications (i.e., 12050 tool and application dies). See pages C??- C??.

Please put the suffix "M" for Mylar Tape RA2573M. (Bulk number 1,000 and 500 packages.)

CAT. NO.	PKG. QTY.	TAB SIZE	WIRE RANGE	MAX INS.	WT./LBS. PER 1,000	DIMENSIONS	
						A	B
RA18-110F	100	.110 x .032	22-18	.110	4	.75	.15
RA10	1,000	.110 x .032	22-18	.110	4	.75	.15
RA18-111F	100	.110 x .020	22-18	.110	4	.75	.15
RA11	1,000	.110 x .020	22-18	.110	4	.75	.15
RB14-110F	100	.110 x .032	16-14	.135	4	.75	.15
RB10	1,000	.110 x .032	16-14	.135	4	.75	.15
RB14-111F	100	.110 x .020	16-14	.135	4	.75	.15
RB11	1,000	.110 x .020	16-14	.135	4	.75	.15
A18-110F	100	.110 x .032	22-18	—	3	.59	.15
A10	1,000	.110 x .032	22-18	—	3	.59	.15
A18-111F	100	.110 x .020	22-18	—	3	.59	.15
A11	1,000	.110 x .020	22-18	—	3	.59	.15
B14-110F	100	.110 x .032	16-14	—	3	.59	.15
B10	1,000	.110 x .032	16-14	—	3	.59	.15
B14-111F	100	.110 x .020	16-14	—	3	.59	.15
B11	1,000	.110 x .020	16-14	—	3	.59	.15

*Not UL Listed or CSA approved.

Material: brass Finish: tin plated

RA Series requires a 12061 Die. RB Series requires a 12062 Die.

11

RA18D
Nylon-insulated wire barrels
Installing tool: WT2000 (Not UL)



Choose from nylon-insulated or non-insulated! Wristlock Disconnects†

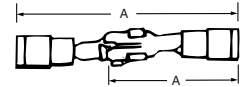

12

B14-D
Non-insulated/insulation grip
Installing tool: WT110M (Not UL)



Nylon Insulated and Non-insulated

Picture shows wristlock assembled as 2 pieces. Parts are sold by the piece not assemblies.

CAT. NO.	PKG. QTY.	WIRE RANGE	MAX. INS.	WT./LBS. PER 1,000	DIMENSIONS	
					A	A1
RA18D	50	22-18	.136	4	.99	1.70
RA23	500	22-18	.136	4	.99	1.70
RB14D	50	16-14	.162	4	.99	1.70
RB23	500	16-14	.162	4	.99	1.70
B14-D	50	16-14	.187	4	.97	1.66
B23	500	16-14	.187	4	.97	1.66

† Not UL Listed NOTE: Not available on Mylar Tape.

Convenient 20-count packaging!

Sta-Kon® Mini-Pack Terminals

- Wire ranges from 22 AWG to 10 AWG
- Vinyl insulated ring and forked-tongued terminals, female disconnects, butt-type splice connectors



NOTE: "CP" designates mini-pack quantities. Refer to other catalog pages for description and dimensional information.

CAT. NO.	UNIT QTY.	STD. PACK.	WIRE RANGE	BOLT HOLE
18RA-6FCP	20	100	22-18	#6
18RA-8CP	20	100	22-18	#8
18RA-10CP	20	100	22-18	#10
14RB-6CP	20	100	16-14	#6
14RB-8CP	20	100	16-14	#8
14RB-10CP	20	100	16-14	#10
10RC-10CP	20	100	12-10	#10
10RC-14CP	20	100	12-10	1/4
18RA-8FCP	20	100	22-18	#8
18RA-10FCP	20	100	22-18	#10
14RB-6FCP	20	100	16-14	#6
14RB-8FCP	20	100	16-14	#8
14RB-10FCP	20	100	16-14	#10
10RC-8FCP	20	100	12-10	#8
10RC-10FCP	20	100	12-10	10
2RA18XCP	20	100	22-18	—
2RB14XCP	20	100	16-14	—
2RC10XCP	20	100	12-10	—
18RA-250FCP	20	100	22-18	—
14RB-250FCP	20	100	16-14	—
10RC-250FCP	20	100	12-10	—

UL Listed E9809

Wire Joints — Nylon Insulated

Available in one-piece nylon, self-insulated and non-insulated, and a two-piece nylon insulator.



Crimp-On Wire Joints — Tool Applied

1

One Piece

Nylon self-insulated

Installing tools: WT2000, WT2130A (RC & RP)

2

Two Piece

Nylon insulator

Installing tool: WT161M

3

One Piece

Non-insulated

Installing tool: WT161M

1

CAT. NO.	PKG. QTY.	WIRE RANGE		DIMENSIONS		WT./LBS. PER 1,000
		MIN.	MAX.	A	B	
RB44	100	2#18	2#16	.31	.78	2
RB4	1,000	2#18	2#16	.31	2	2
RC55	50	4#18	2#12	.43	.95	3
RC6	500	4#18	2#12	.43	3	3
RP12	100	3#14	4#12	.53	1.00	3
RP7	1,000	3#14	4#12	.53	1.00	3
PT66M	100	2#18	3#12 combination	—	—	4
PT6M	100	—	Insulator only	.50	.93	2
PT60M	100	2#14	3#12 Connector only	.31	.37	2
PT70	200	2#14	3#12	.29	.34	2
PT70M	200	3#18	4#12	.31	.37	2
PT80	50	2#16	4#10	.35	.62	6

UL® Listed E9809

Items on this page sold in multiples of unit packages only.

Installation Procedure for "PT" Connectors



Twist wires, insert through serrated barrel of wire joint. (PT60M, PT70, PT70M, PT80).



Crimp and trim off excess wire with WT161M hand tool.



Screw PT6 insulator firmly onto PT160M barrel.

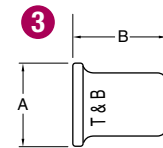
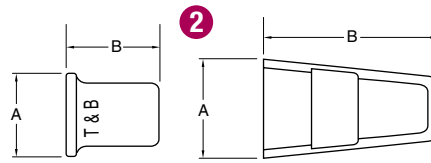
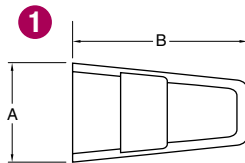

CAT. NO.	ALLOWABLE WIRE COMBINATIONS						
	#22	#20	#18	#16	#14	#12	#10
RB4/RB44	2-3						
	1-2		2				
	3						
	3			1			
	2		3				
	1-2		2				
	2		1				
	3		1				
	1		2				
	2		1				
1		2					

CAT. NO.	ALLOWABLE WIRE COMBINATIONS						
	#22	#20	#18	#16	#14	#12	#10
RC6/RC55	1-4		1				
	1-3		1				
	1-2			1			
	2						
	3-5			1			
	2-4		1				
	3						
	1-4		2				
	1-3		2				
	1-3		3				
1		3					
2-5							
4-6							

CAT. NO.	ALLOWABLE WIRE COMBINATIONS						
	#22	#20	#18	#16	#14	#12	#10
RP7/RP12	2						
	1					1	
	1						
	2-4						
	2-4		1				
	1-3		2				
	1						
	3-6						
	1		2-3				
	2		1-2				
3		1-2					
4		1					

Installing Kits & Application Tools

Heavy-duty steel drawer!

Wiring Organizer

- Does not include Thomas & Betts products

ORG-2

CAT. NO.	DESCRIPTION	STD. PKG.	WT.
ORG2	Heavy-Duty Steel Drawer with (17) compartments to hold Sta-Kon® terminals, Color-Keyed® lugs, Ty-Rap® cable ties, and other small parts	1	4 lbs.

Single operation to cut and strip at the same time!

SWS01/DWS02 Wire Stripping/Cutting Tools

- Automatic adjustment to the diameter of the wire, with neither setting nor selection
- Sharply cuts and strips insulator without damaging the conductors
- DWS02 is a double-side stripper



CAT. NO.	DESCRIPTION
SWS01	Single-Side Stripper
DWS02	Double-Side Stripper

Integral wire cutter lets user cut and strip with the same tool!

Sta-Kon® ERG1-WS Wire Stripping/Cutting Tool

- Interchangeable cassettes enable the user to strip a wide range of insulations without having to change tools
- Tool automatically strips wire to preset length



"V" Blade Cassette

CAT. NO.	DESCRIPTION	WEIGHT EACH
ERG1-WS	Ergonomic Wire Stripping Tool	.3 lbs.
SBC-1	Replacement Straight Blade Cassette	.03 lbs.
VBC-1	Replacement "V" Blade Cassette	.03 lbs.

ERG1-WS Wire Stripping/Cutting Tool is shipped with one Straight Blade Cassette. "V" Blade Cassettes sold separately. Tool and Replacement Blades are shipped in packaging suitable for merchandising display.

Perfect for residential or light commercial installations!

Sta-Kit

- Assortment of popular Sta-Kon® vinyl terminals
- Kit includes a WT112M crimping tool
- All splices, terminals, and disconnects are vinyl insulated



CAT. NO.	DESCRIPTION	STD. PKG.	WT.
STAKIT	(100) 2RA18X butt splices for 22-18 AWG, (100) 2RB14X butt splices for 18-14 AWG, (50) 2RC10X butt splices for 12-10 AWG, (50) 10RC-10 ring terminals for 12-10 AWG, (50) 10RC-10FL locking fork terminals for 12-10 AWG, (50) 10RC-250F disconnects for 12-10 AWG, (100) 14RB-10 ring terminals for 18-14 AWG, (100) 14RB-8FL locking fork terminals for 18-14 AWG, (100) 14RB-250F disconnects for 18-14 AWG, (100) 18RA-8F Fork Terminals for 22-18 AWG, (100) 18RA-6FL locking fork terminals for 22-18 AWG, (100) 18RA-250F disconnects for 22-18 AWG (1) WM-0-9 wire marker book (1) WT112M crimping tool and 100 TY525M Ty-Rap® cable ties (approx. length 7 1/2")	1	1 lb.

Lightweight, durable, nylon construction!

Sta-Org™ Terminal and Splice Organizer Kit

- Ideal for contractors, OEMs, or any other user of terminals and splices
- Slips in a tool box or sits on your bench — only 6.6"L x 3" dia.
- Benchmarkable (hardware included)



CAT. NO.	DESCRIPTION	STD. PKG. QTY.	UPC NUMBER
STA-ORG	Sta-Kon® Sta-Org™ Terminal and Splice Organizer Kit	1	78621093652

Sta-Kon Terminal Products and Tools

Application Tools

Used for installation of various Sta-Kon® terminal series.

Plier Type Tools

- Available in a variety of styles — some with wire cutters and strippers
- #22–10 AWG wire range

WT110M

- Installs “C” Sta-Kon® terminals — gauging .075–.095



- Installs “A” & “B” Sta-Kon® terminals — gauging .030–.050
- Closing Insulation Grip on Sta-Kon® “B” size terminals and disconnect tips
- Closing Insulation Grip on Sta-Kon® “A” size terminals and disconnect tips

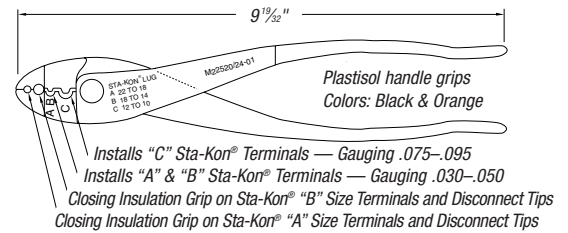

WT111M

- Cutters
- Installs “A” & “B” Sta-Kon® terminals — gauging .027–.053.



- Installs “C” Sta-Kon® terminals-gauging .072–.098

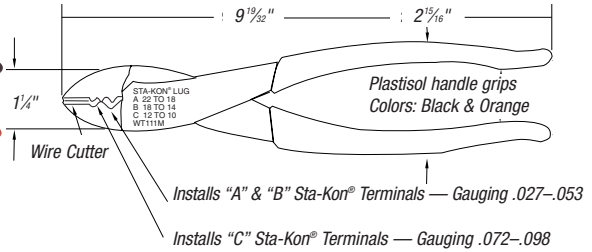

WT112M

- Installs insulated and non-insulated Sta-Kon® terminals, splices, disconnects, and wire joints 22–10 AWG

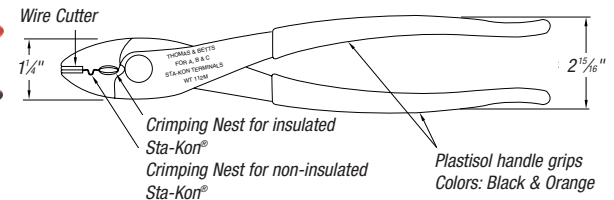

WT161M

- Installs “A,” “B,” and “C” size (#18–#10 wire) Sta-Kon® terminals, splices, and wire joints (PT-60M and PT-70)

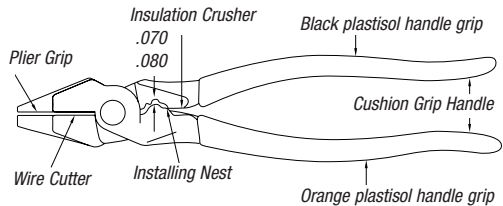

WT2000

- Wire cutter — No. 10 AWG and smaller, solid or stranded wire
- Crimping nests — insulated and non-insulated Sta-Kon® terminals, splices, and wire joints on No. 22 to No. 10 AWG, solid or stranded wire
- Cutters — chasing feature for screws, sizes 4–40, 6–32, 8–32, 10–24, 10–32
- Wire stripper — removes most types of insulation from No. 22–10 AWG stranded wire and No. 18–8 AWG solid wire

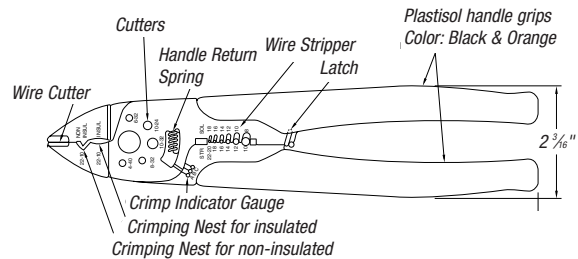

CAT. NO.	DESCRIPTION	STD. PKG.	WT. EACH
WT110M	A, B, C non-insulated terminal and splices and A, B non-insulated terminals with insulation grip	1	1
WT111M	A, B, C, PT non-insulated terminal and splices	1	1
WT112M	RA, RB, A, B, C, non-insulated and RC insulated nylon and vinyl terminal and splices	1	1

CAT. NO.	DESCRIPTION	STD. PKG.	WT. EACH
WT161M	A, B, C, PT non-insulated terminal and splices	1	1
WT2000	A, B, C, AB, PT, RA, RB, RC insulated and non-insulated terminal and splices	1	????

Sta-Kon Terminal Products and Tools

Application Tools

Ergonomically designed handles let user get a grip on safety.

For easy visual verification of crimps, integrity dots are embossed on the top and bottom of the terminal.

Toggle action increases mechanical gain, which dramatically reduces handle force — and the stress on your hands.

Advanced ergonomic design of handle distributes the force more evenly across the hand.

Color-coded die nests on both the right and left sides of the tool are included for insulated terminals.

Shure-Stake® mechanism helps to ensure a complete crimp cycle before it releases the tool.

Rubberized thermoplastic handle combines maximum friction with a soft, comfortable feel that reduces muscle tension.

ERG-2001

Terminal locator

Shure-Stake® release on both sides

(22-18) A Nest
(16-14) B Nest
(12-10) C Nest

- Installs nylon and vinyl insulated terminals, disconnects, and splices 22-10/22-14 AWG
- The force required to release the Shure-Stake® mechanism should be no less than 15 lbs.

Shure-Stake® release on both sides

(12-10) C Nest
(16-14) B Nest
(22-18) A Nest

STA-KON®
CAT. NO. ERG-2008

- Installs non-insulated terminals, disconnects, and splices 22-10 AWG
- The force required to release the Shure-Stake® mechanism should be no less than 15 lbs.



- Installs Non-Insulated Terminals #8-1/0 AWG
- UL® Listed crimp per UL standard 486C on tubular D-, E-, F-, G-, and H-style Sta-Kon® Terminals

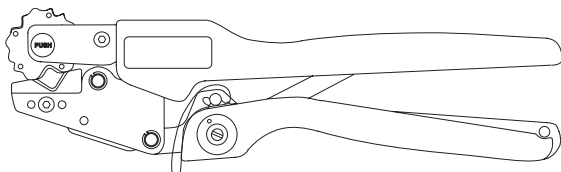

Comfort Crimp® Terminal Tool

Concerned about safety? Down time? Health care costs?

The Thomas & Betts ergonomically-designed Comfort Crimp® tool helps reduce the risk of carpal tunnel syndrome, the cause of almost one out of every two industrial injuries.

This tool's unique design delivers the same reliable crimp with up to 60% less handle force than other terminal hand tools, so you won't have to sacrifice your hand to make a successful crimp. We've researched the tool components to provide maximum comfort to the operator while ensuring a complete crimp.

Just wrap your hands around our Comfort Crimp® terminal tool. It's such a relief you won't want to handle any other tool ever again.

CAT. NO.	DESCRIPTION	STD. PKG.
ERG-2001	RA, RB, RC Nylon & vinyl terminals, splices & disconnects	1
ERG-2002	A, B, C Non-insulated terminals, splices, disconnects	1
ERG-2004	C and C Flag terminal AB Flag terminal and A, B, C non-insulated terminals, splices, disconnects	1
ERG-2005	B, C, D Non-insulated terminals, splices, (D tubular only) & E (tubular only)	1
ERG-2007	RD & RE Insulated terminals (Except Brazed Seam)	1
ERG-2008	Non-insulated terminals #8-1/0 AWG	

Tool Gauging Requirements

CAT. NO.	NEST	GAUGING MIN.-MAX.
ERG-2001	RA	.100-.106
	RB	.116-.124
	RC	.148-.156
ERG-2002	A	.062-.067
	B	.084-.089
	C	.110-.115
ERG-2004	AB	.062-.067
	C	.110-.115
ERG-2005	B	.082-.090
	C	.117-.125
	D	.145-.153
ERG-2007	8 (RED)	.190-.196
	6 (BLUE)	.212-.218
ERG-2008	Self-Contained Rotating Die	8-1/0 AWG

Gauges available from T&B Tool Service.

ERG-2001

NEST	GAUGING MIN.-MAX.
Red	.100-.106
Blue	.116-.124
Yellow	.148-.156

ERG-2002

NEST	GAUGING MIN.-MAX.
A	.067-.062
B	.089-.084
C	.115-.110

Application Tools

Correct compression every time — the Shure-Stake® mechanism principle prevents opening of the handles until full staking action is completed. Installs self-insulated and non-insulated Sta-Kon® terminal series in the #26–10 AWG wire range.

Installs RA, RB, RBC, RC nylon terminals.

WT145A Ratchet Hand Tool

- Features Shure-Stake® mechanism
- With the “Lower” gauge (683-G-398) placed into the rectangular side of the lower nest, the force required to release the Shure-Stake® mechanism should be 10–40 lbs.

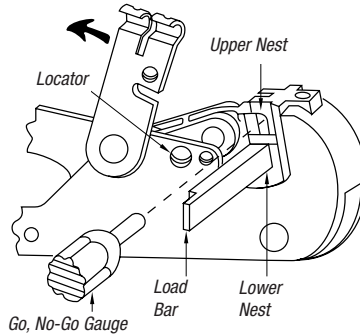
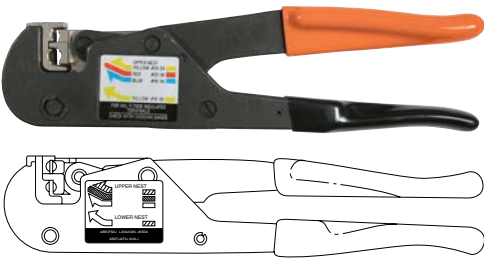

CAT. NO.	DESCRIPTION	STD. PKG
WT145A	RA, RAX, RB, RBC, RC, RAA, RBB, RBC, RCC nylon terminal	1

NEST	GAUGING MIN.–MAX.
Upper	.097–.106
Lower	.121–.128

Installs RA, RB, RC nylon and vinyl terminals, disconnects, and splices.

WT145C Ratchet Hand Tool

- Features Shure-Stake® mechanism
- Force required to release the Shure-Stake® mechanism should be 10 lbs. minimum

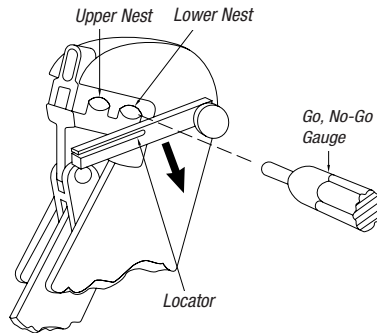

CAT. NO.	DESCRIPTION	STD. PKG
WT145C	RA, RB, RC, RAA, RBB, RCC, RBC nylon and vinyl terminals, splices, and disconnects	1

NEST	GAUGING MIN.–MAX.
Upper	.118–.122
Lower	.169–.173

Installs NW series heater wire terminals.

WT1377 Ratchet Hand Tool

- Features Shure-Stake® mechanism
- Use front nest to install NW18 series terminals, NW20 series terminals, NW22 series terminals, and NW50 series terminals
- Use rear nest to install NW10 series terminals, NW14 series terminals, NW80 series terminals, and 675-14716 series terminals



NW80 series terminals gauging .064–.069

NW20, NW50 series terminals gauging .047–.054

Caution: Handles are non-insulating. Do not crimp energized wires.

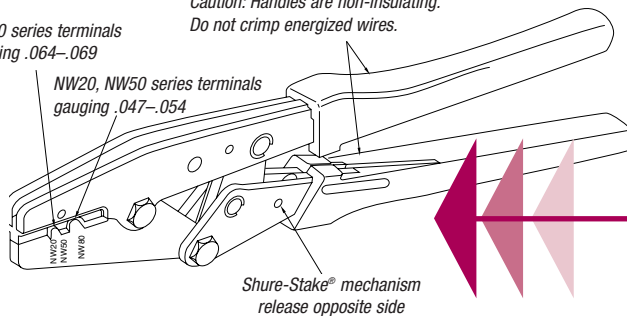

CAT. NO.	DESCRIPTION	STD. PKG
WT1377	NW Ring Terminals	1

Sta-Kon Terminal Products and Tools

Application Tools

Installs RZ, RV terminals (26–22 AWG wire) and splices.

WT1452 Ratchet Hand Tool

- Ergonomic design

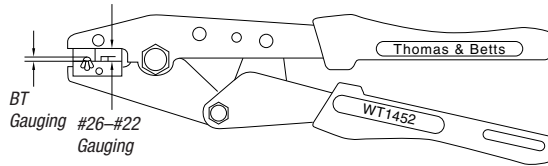

CAT. NO.	DESCRIPTION	STD. PKG	NEST	MIN. GAUGE	MAX. GAUGE
WT1452	Installs RZ, RV Terminals/Splices	1		"GO"	"NO-GO"
			BT	.039	.049
			RZ, RV #26-#22	.063	.073

Installs .110 RA, RB disconnects.

WT465 Ratchet Hand Tool

- Pre-load requirement: 20–50 lbs.

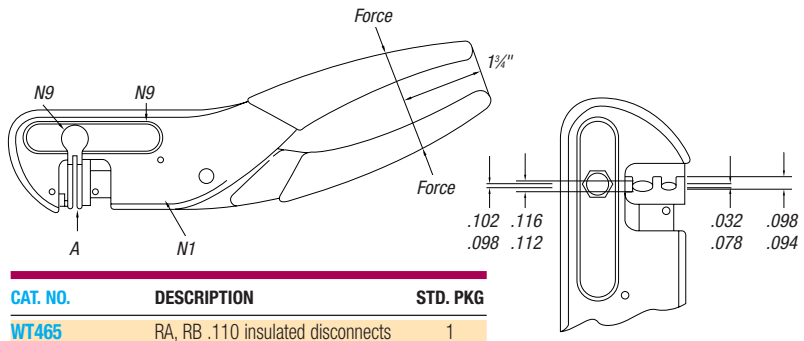

CAT. NO.	DESCRIPTION	STD. PKG
WT465	RA, RB .110 insulated disconnects	1

Installs RA, RB, RC heat-shrinkable nylon insulated terminals, butt splices, and disconnects.

WT1255 Ratchet Hand Tool

- Pre-load 35–45 lbs.

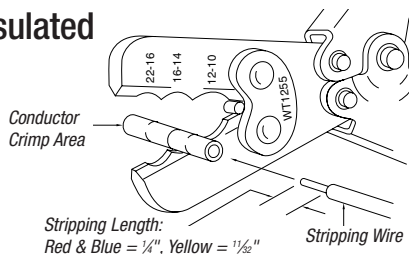

CAT. NO.	DESCRIPTION	STD. PKG	NEST	GAUGING MIN.-MAX.
WT1255	RA, RB, RC Heat-Shrinkable nylon insulated terminals, butt splices, and disconnects	1	22-18	.098-.086
			16-14	.113-.101
			12-10	.161-.149

Installs RBC, RC, RD, Sta-Kon® terminals, and RC6 and RP7 wire joints.

WT2130A Ratchet Hand Tool

- Features Shure-Stake® mechanism
- The force required to release the Shure-Stake® mechanism should be 20 lbs. minimum.

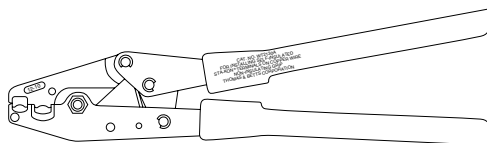

CAT. NO.	DESCRIPTION	STD. PKG	NEST	GAUGING MIN.-MAX.
WT2130A	RC, RBC, and RD insulated terminal #14-#8	1	12-10	.147-.157
			8	.185-.195

Application Tools

Installs 8 AWG to 250 MCM non-insulated Sta-Kon® terminals.

Sta-Kon Terminal Products and Tools

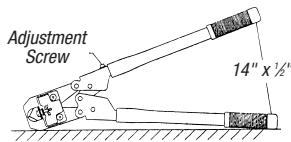
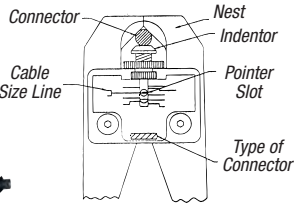

WT3185 Ratchet Hand Tool

Installation and Gauging Procedure — Adjustable Crimper

Gauging Procedure

1. Close the tool jaws until they bottom.
2. Select the side of tool to be gauged (Tubular or Brazed seam)
3. Move indentor until the pointer slot aligns (clicks) with the selected cable size: For brazed seam connector, use 6 AWG. For tubular connectors, use 2/0.
4. Gauge the crimping area with a suitable pin gauge. The gauge diameter must fall within .4056010 tubular and .2156.010 for 6 AWG. brazed product.

Checking Handle Pre-load

1. Lay the tool on a flat surface as shown. Open handle and release it so that it will close of its own weight.
2. Measure the handle spread distance at the inner surface of the handle tips as shown.
3. If the distance is 14"±½", the tool is adjusted properly. If not, the tool should be adjusted.

Pre-load Adjustment Procedure

1. Turn Adjustment screw clockwise to increase handle spread and counterclockwise to decrease handle spread.

CAT. NO.	FOR USE WITH STA-KON® SERIES	STD. PKG.	WT. EACH
WT3185	For 8 AWG to 250 MCM Non-Insulated Sta-Kon® Terminals	1	????? lbs.

Installs D thru M (uninsulated terminals), and RD thru RM (insulated terminals).

TBM6ORS Short Handle Ratchet Tool

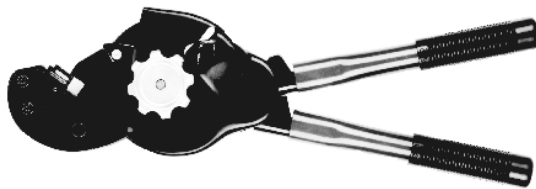

Gauging Procedure

1. Ratchet handles until jaws are fully closed.
2. Insert GO, NO-GO gauge into nest. GO gauge should enter freely. NO-GO gauge should not enter.

CAT. NO.	FOR USE WITH STA-KON® SERIES	STD. PKG.	WT. EACH
TBM6ORS	D thru M (Uninsulated Terminals) RD thru RM (Insulated Terminals)	1	6lbs.

For more information, see page C??.

Installs Sta-Kon® terminals series D, E, F, and G flag terminals.

WT129 Flag Terminal Type Hand Tool



NEST	GAGING
D	.138 ± .005
E	.170 ± .005
F	.192 ± .005
G	.222 ± .005

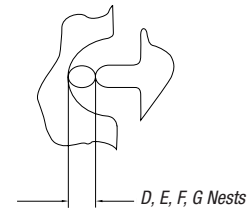

CAT. NO.	DESCRIPTION	STD. PKG.
WT129	D, E, F, & G Non-Insulated Flag Terminals	1

Application Tools

Installs Sta-Kon® terminals series D, E, F, and G.

WT115A Toggle-Type Hand Tools

NEST	GAUGING
D	.138 ± .005
E	.170 ± .005
F	.192 ± .005
G	.222 ± .005

CAT. NO.	FOR USE WITH STA-KON® SERIES	STD. PKG.	WT. EACH
WT115A	D, E, F, & G Non-Insulated Terminals	1	4lbs.

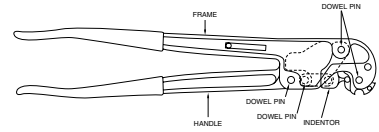

Installs D–M non-insulated terminals and splices, and RD–RM nylon insulated terminals and splices.

TBM6 & TBM6S Toggle-Type Hand Tools

Directions:

Close handles until lower die touches upper die. Measure distance between ends of handles. Distance must be 11" min. and 14" max. If it is less than 11" or more than 14", the tool needs to be adjusted.

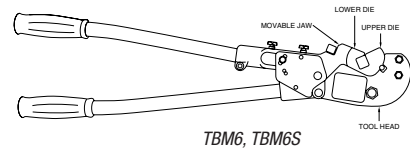
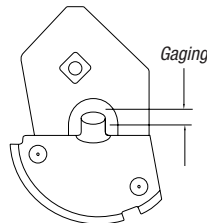
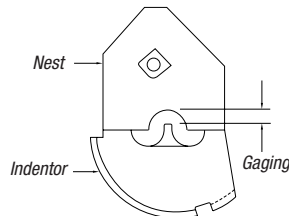

TBM6, TBM6S

CAT. NO.	FOR USE WITH STA-KON® SERIES	STD. PKG.	WT. EACH
TBM6	D thru M (Dies not included) RD thru RM	1	9lbs.
TBM6S	D thru M (Dies not included) RD thru RM with Shure-Stake®	1	9lbs.

Installing Dies for Non-Insulated Code and Aircraft Sta-Kon® Terminals

NEST STATIONARY DIE	INDENTOR MOVABLE DIE	TERM. SIZE	GAUGING ± .010
11803		D	.152
11803		E (Tubular)	.152
11805		E (Brazed), F (Tubular)	.167
11806	11802	F (Brazed), G	.206
11807		H	.234
11808		J	.272
11809		K	.250
11810		L	.266
11811		M	.312

Installing Dies for Nylon Insulated Sta-Kon® Terminals TBM6 & TBM6S Tool

CAT. NO. DIE SET	TERM. SIZE	GAUGING ± .010
11821	RD	.170
11822	RE	.202
11823	RF	.254
11824	RG	.321
11825	RH	.339
11826	RJ	.370
11827	RK	.382
11828	RL	.456
11829	RM	.554

Application Tools

Safe, fast, high-volume crimping machine!

Shure-Stake® Auto-Feed Tool

- Shure-Stake® mechanism
- Fully guarded foot pedal
- Clear plastic safety guard over die area
- Dies color coded to terminals
- #26–10 AWG wire range
- Compact, pneumatically operated unit
- Installs insulated and non-insulated terminals and disconnects

12050
Crimping tape-mounted STA-KON® terminals.
Wire Range — #26–#10 AWG.

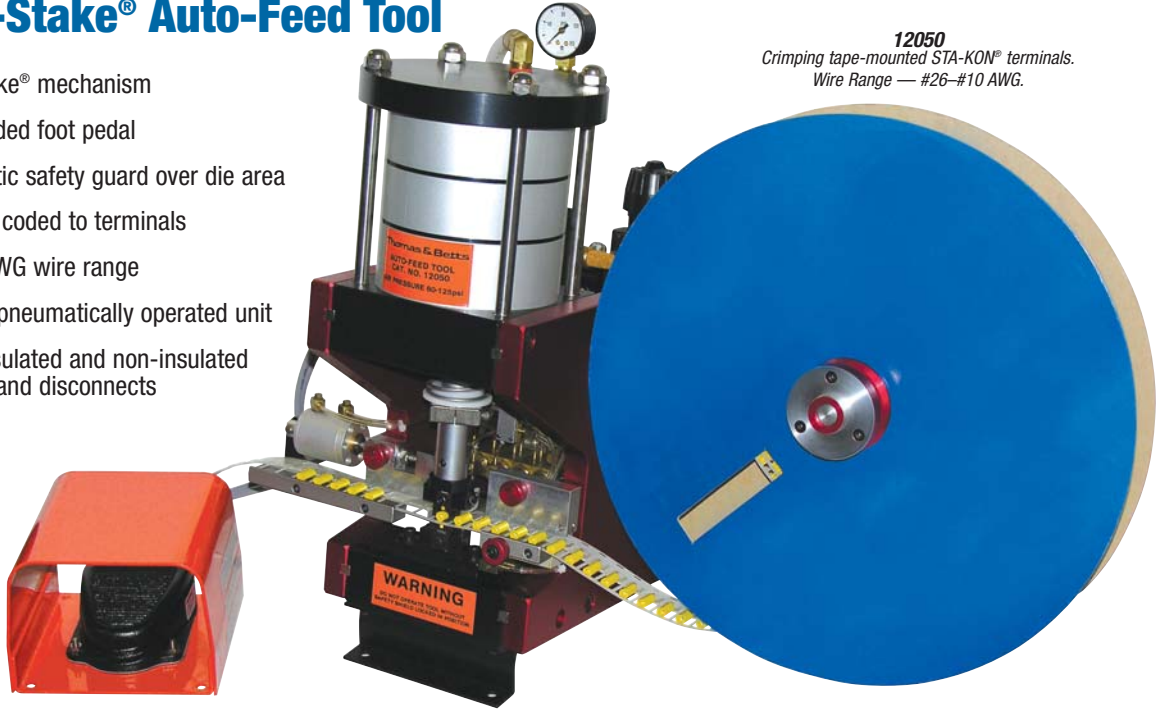

Sta-Kon Terminal Products and Tools

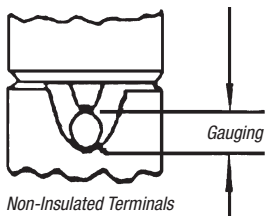
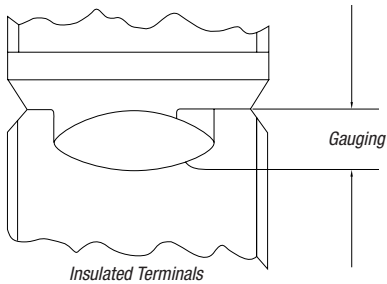

CAT. NO.	DESCRIPTION	STD. PKG.
12050	Compact, pneumatically operated unit for crimping tape-mounted STA-KON® terminals; equipped with a Shure-Stake® mechanism, which ensures a full compression each time	1

Space Requirement: 30" W x 20" H x 20" D
Weight: 55 lbs.
Wire Range: #26–#10 AWG
Air Pressure: 90–125 psi input air supply

Installing Dies for 12050

STA-KON® TERMINAL TYPE	AWG WIRE SIZE	DIE CAT. NO.	GAUGING MIN.-MAX.	MAX. INSUL. DIA.
RA — Nylon	22–18	12051	.108/.114	.136
RA — Vinyl		12054*	.117/.121	.150
RB — Nylon	16–14	12052	.133/.139	.162
RB — Vinyl		12055*	.122/.126	.170
RC — Nylon and Vinyl Insulated	12–10	12056	.149/.157	.210
A — Non-Insulated	22–18	12057	.061/.068	—
B — Non-Insulated	16–14	12058	.083/.090	—
C — Non-Insulated	12–10	12059	.126/.134	—
C Disconnect, Non-Insul.	12–10	12060	.103/.111	—
RV — RZ	26–24	683-54335	.075/.081	—

*Can also be used on nylon.

RA Series requires a 12061 Die. RB Series requires a 12062 Die.

Application Tools

1½ tons of grip that weighs less than 3 pounds!

Battery-Powered Crimping Tool — BAT22-6

T&B's newest battery-powered tool is fast and portable for making high-volume and difficult-to-reach terminal installations in a snap. The Sta-Kon® BAT22-6 delivers 1.5 tons of crimping force with an easy, pushbutton trigger. The lightweight, ergonomic design minimizes the risk of repetitive motion injuries that can occur with traditional hand crimping tools. And at less than three pounds, one-hand operation is easy while still packing enough power to crimp up to 6 AWG terminals in seconds.

- Interchangeable dies can be quickly changed to crimp non-insulated and insulated terminals up to 6 AWG
- Dies are the same as our hand tools — crimps will be exactly the same between Sta-Kon® hand tools such as our ERG-2001 and the new BAT22-6
- 360° rotating head gives the user the added flexibility when crimping hard-to-reach connections
- Short cycle time equates to crimping times of less than two seconds
- Quick, lightweight, and maneuverable
- NiCd battery operation provides long-lasting battery life to complete up to 150 crimps on a single charge
- Extra battery and charger are included with the tool, ensuring round-the-clock operation
- Battery charger provides full battery life in under an hour
- Linear crimping motion gives a symmetric, high-quality crimp every time



Specifications

- **Crimping Force** — 2,900 lbs. max.
- **Crimp Cycle Time** — 2 seconds
- **Wire Crimping Range** — Up to 6 AWG
- **Power Supply** — 9.6V NiCd battery
- **Recharging Time** — 1 hour
- **Crimps per Charge** — 150
- **Dimensions** —
25.4" (645 mm) Length
3.1" (79 mm) Width
2.1" (53 mm) Height
- **Tool Weight (With Battery)** — 2½ lbs.

Included Accessories

- Sturdy, plastic carrying case for portability
- Two 9.6V NiCd batteries and battery charger
- Sturdy tray for convenient storage of crimp dies

CAT. NO.	DESCRIPTION
BAT22-6	Battery Crimping Tool, 1.5 Ton with 120 VAC Charger
Crimp Dies*	
DIE2001	Insulated 22–10 AWG Sta-Kon Terminals
DIE2002	Non-Insulated 22–10 AWG Sta-Kon and Spec-Kon Terminals
DIE2005	16–14/12–10/8–6 (Tubular Only) Sta Kon Terminals
DIE2007	Insulated 8–6 AWG Sta-Kon Terminals

Tool purchase includes crimping tool, two 9V batteries, charger, and case.

*Dies sold separately.

Application Tools

Crimp 22–6 AWG terminals!

Air Operated — Bench Mounted Tools

- 1.5 tons of grip
- Bench-mounted heavy-duty air tool
- Short cycle time
- Shure Stake® mechanism
- Foot actuated
- Accepts T&B standard hand tool dies
- Installs Sta-Kon® and Spec-Kon® terminals as well as ferrules and Dragon Tooth®

CAT. NO.	DESCRIPTION	STD. PKG.
BAIR22-6	Heavy-duty, high-speed production tool installs a wide range of Sta-Kon® terminals, from 26-6 gauge; uses the ERG 2000 series dies for both non-insulated and insulated terminals; is supplied complete with foot pedal, air hose-air/lubricator	1

Crimp Dies*

DIE2001	Insulated 22–10 AWG Sta-Kon Terminals
DIE2002	Non-Insulated 22–10 AWG Sta-Kon and Spec-Kon Terminals
DIE2005	16–14/12–10/8–6 (Tubular Only) Sta-Kon Terminals
DIE2007	Insulated 8–6 AWG Sta-Kon Terminals

Tool purchase includes crimping tool, two 9V batteries, charger, and case.

*Dies sold separately.

NOTE: The dies for the BAIR22-6, PAIR22-6, and the BATT22-6 (page C-41) are interchangeable.



Sta-Kon® terminals, insulated and non-insulated #22 thru #6 wire range.

Sta-Kon Terminal Products and Tools

1.5 tons of portable grip!



Portable Air Hydraulic Tool

- Crimps 22-6 AWG terminals
- Portable heavy-duty air tool
- Installs Sta-Kon® and Spec-Kon® terminals as well as ferrules and Dragon Tooth®
- Interchangeable dies
- Open yoke enables easy access to insert and remove terminals for crimping

CAT. NO.	DESCRIPTION
PAIR22-6	Open yoke; hand actuated

Crimp Dies*

DIE2001	Insulated 22–10 AWG Sta-Kon Terminals
DIE2002	Non-Insulated 22–10 AWG Sta-Kon and Spec-Kon Terminals
DIE2005	16–14/12–10/8–6 (Tubular Only) Sta-Kon Terminals
DIE2007	Insulated 8–6 AWG Sta-Kon Terminals

Tool purchase includes crimping tool, two 9V batteries, charger, and case.

*Dies sold separately.

Cat. No. 11913 air hose not included.

NOTE: The dies for the BAIR22-6, PAIR22-6, and the BATT22-6 (page C-41) are interchangeable.

Application Tools

No more undercrimping!

Air Operated — Bench Mounted Tools

- Convenience and Economy

The tool accepts a full range of interchangeable dies, the same as used in the TBM6 or 6S tools. To install the dies, simply pull the spring-loaded pin and remove the indentor die. Then, flex the retaining spring and remove the die nest.

- Shure-Stake® Mechanism Means Quality Connections

The Shure-Stake® mechanism senses inlet air pressure, and if insufficient, is designed to prevent the tool from cycling. Thus you avoid "undercrimping." An 85–90 psi air pressure source is required.

- Safety Features Increase Productivity, Reduce Downtime

Safety features include a guard over the die area, an air shutdown switch activated by a slight push with the finger, and an enclosed foot pedal designed to prevent unwanted tool operation. In addition, the tool may be bench-mounted for stability and control. For convenience when crimping large size terminals on heavy wire, the head assembly may overhang the workbench.



Sta-Kon Terminal Products and Tools

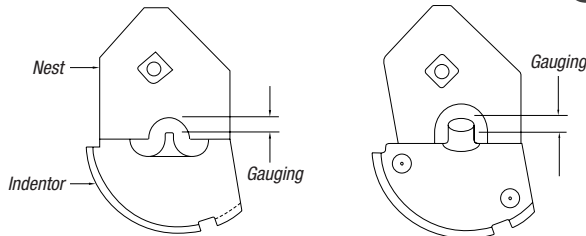

Installing Dies for Non-Insulated Code and Aircraft Sta-Kon® Terminals for 25000 Tool

Installing Dies for Nylon Insulated Sta-Kon® Terminals for 25000 Tool

CAT. NO.	DESCRIPTION	STD. PKG.
25000	This compact heavy-duty air tool installs nylon and Tefzel® insulated Sta-Kon® terminals on wire sizes from 8 AWG to 250 MCM; non-insulated styles are also installed just as quickly and dependably; to crimp a terminal, you simply insert the stripped wire into the terminal barrel, position it in the crimping nest, and depress the foot pedal, actuating the crimping dies — it's that easy	1

Tefzel® is a registered trademark of DuPont.

CAT. NO.	CAT. NO.	TERM. GAUGING
NEST STATIONARY DIE	INDENTOR MOVABLE DIE	SIZE ±.010
11803	D	.152
11803	E	.152
11805	F	.167
11806	11802	G .206
11807	H	.234
11808	J	.272
11809	K	.250
11810	L	.266
11811	M	.312

CAT. NO.	TERM. GAUGING
DIE SET	SIZE ±.010
11821	RD .170
11822	RE .202
11823	RF .254
11824	RG .321
11825	RH .339
11826	RJ .370
11827	RK .382
11828	RL .456
11829	RM .554

Application Tools

Sta-Kon Terminal Products and Tools



Installs insulated and non-insulated Sta Kon® Terminals!

Twelve Ton Crimping Tool

CAT. NO.	DESCRIPTION	STD. PKG.
13400	Twelve ton crimping tool for installing both insulated and non-insulated Sta-Kon® terminals #8 to 250 MCM (dies ordered separately)	1

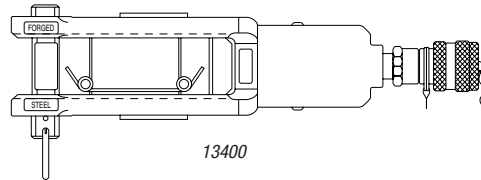

Heavy duty and high-flow rate!

Electric Hydraulic Pump

- Up to 10,000 psi output pressure
- Durable construction
- Hand or foot actuated



CAT. NO.	DESCRIPTION
13810	Electric hydraulic pump, 10,000 psi with Shure-Stake® mechanism feature; this is a heavy-duty OEM pump with high flow rate; 115V, 60Hz, 1½ HP, 23A; requires hand or foot control.

You may also need...

13611	Hand Switch for 13810
13612	Foot Switch for 13810
13613	High-Pressure, Steel-Reinforced Hydraulic Hose; 6 ft.
13614	High-Pressure, Steel-Reinforced Hydraulic Hose; 10 ft.
13619	High-Pressure, Plastic Hydraulic Hose; 10 ft.

13600 This electric hydraulic pump is for use with all T&B hydraulic heads — consists of pump with pressure gauge and Pioneer type male coupler; add suffix **WG** to eliminate gauge; output pressure 9,800 psi; order switch and hose separately.

You may also need...

13620	Hand Switch — 10 ft.
13589A	Foot Switch — 10 ft.
13619	10-ft. Non-Metallic Hose
13618	20-ft. Non-Metallic Hose

A remote control switch is required. Order Cat. No. 13620 for hand operation or Cat. No. 13589A for foot operation.

All pumps are supplied with a metal carrying case.

13610A Shure-Stake® electric hydraulic pump has same features as 13600, but includes the Shure-Stake® control mechanism; prevents under-crimping; (pump pressure must reach 9,800 psi before recycling); requires hand or foot control; order switch and hose separately.

You may also need...

13611	Hand Switch — 10 ft.
13612	Foot Switch — 10 ft.
13797	In-line hydraulic pressure inspection gauge with male and female pioneer-type coupler.

A remote control switch is required to operate this unit. Use either a #13611 (hand) or #13612 (foot) switch.



Application Tools

Military listed and 12 tons of crimping power!

Twelve Tons Crimping Tool (Military Spec. MS25441-1)



13642M

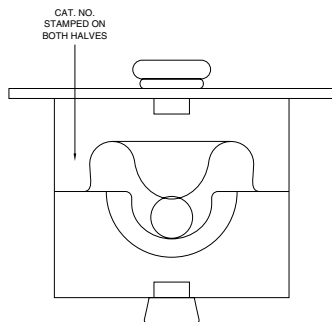
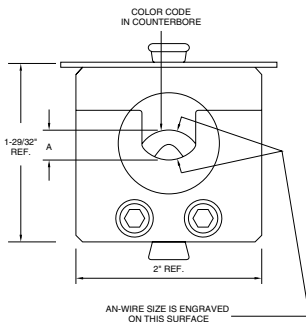
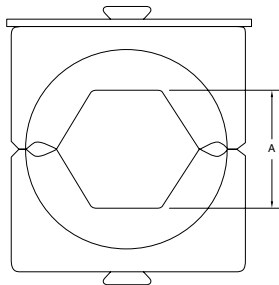

CAT. NO.	DESCRIPTION	STD. PKG.
13642M	Hydraulic operated 12 ton press installs "D" size through "M" size Sta-Kon® terminals on "AN" copper wire	1

Hex dies for 13642M and 13400

DIE CAT. NO.					
FOR TUBULAR TERM	FOR BRAZED SEAM	STA-KON® SIZE	WIRE SIZE	HEX DIE CODE	A GAUGING
11732	—	D	8	21	.197 ± .005
—	11733	—	—	24	.228 ± .005
11733	—	E	6	24	.228 ± .005
—	11734	—	—	29	.288 ± .005
11734	—	F	4	29	.288 ± .005
—	11735	—	—	33	.332 ± .005
11736	—	G	2-1	37	.376 ± .005
11737	—	H	1/0	42	.415 ± .005
11738	—	J	2/0	45	.453 ± .005
11739	—	K	3/0	50	.500 ± .005
11740	—	L	4/0	54	.544 ± .009
11771	—	M	250 MCM	62	.623 ± .004

Installing Dies for Insulated Terminals to Fit 13642M (Military Listed)

CAT. NO.	A GAUGING	STA-KON SIZE
21707M	.168 – .172	RD
21708M	.200 – .204	RE
21709M	.252 – .256	RF
21710M	.310 – .314	RG
21711M	.337 – .341	RH
21712M	.368 – .372	RJ
21713M	.406 – .402	RK
21714M	.436 – .440	RL
21715M	.471 – .475	RM

Nest and Indentor for Installing One Piece — Non-Insulated Terminals to Fit 13642M and 13400

INDENTOR CAT. NO.	NEST CAT. NO.	A GAUGING	TERMINAL SERIES
13650	13654	.202 – .210	G
13650	13655	.230 – .238	H
13650	13656	.268 – .276	J
13650	13657	.246 – .254	K
13650	13658	.262 – .270	L
13650	13659	.308 – .316	M

Nest and Indentors for Installing Sta-Kon® Brazed Seam Type Non-insulated Terminals to Fit 13642M and 13400

NEST CAT. NO.	INDENT. CAT. NO.	STA-KON® CODE SIZE	WIRE	DIA.
13643	—	D	8	.153/.161
13644	13650	E	6	.183/.191
13645	—	F	4	.214/.222

Hex Dies for 13642M (Military Listed)

DIE CAT. NO.	STA-KON® SIZE	WIRE SIZE	A GAUGING
11781M	D	8AN	.208 – .212
11782M	E	6AN	.238 – .242
11783M	F	4AN	.297 – .301
11784M	G	2AN	.375 – .379
11785M	H	1AN	.415 – .419
11786M	J	1/0AN	.454 – .458
11787M	K	2/0AN	.488 – .502
11788M	L	3/0AN	.560 – .564
11789M	M	4/0AN	.616 – .620

Gauging for Installing Dies Used to Install Flag Type Sta-Kon® Terminals — Use with 13642M and 13400

NEST CAT. NO.	INDENTOR CAT. NO.	STA-KON® SIZE	GAUGE MIN.	GAUGE MAX.
21733	—	8	.147	.153
21734	21731	6	.171	.177
21735	—	4	.194	.200
21736	—	2	.262	.269
21737	—	1	.278	.284
21738	21732	1/0	.309	.315
21739**	—	2/0	.356	.362
21740**	—	3/0	.382	.388
21741**	—	4/0	.434	.440

** Cat. Nos. 21739, 21740, and 21741 dies must be left in 13642 head with 21732 indenter when gauging.

Tool Charts

Select the die numbers you need!

Sta-Kon Terminal Products and Tools

TOOL		PLIERS					RACHET ERGONOMIC HAND TOOLS				
DESCRIPTION	TERMINAL SERIES	WT110M	WT111M	WT112M	WT161M	WT2000	ERG-2001	ERG-2002	ERG-2004	ERG-2005	WT1377
Nylon Terminal	RZZ										
	RA, RAX			•		•	•				
	RB,			•		•	•				
	RBC, RC			•		•	•				
Nylon/ Butt Splice	RA			•		•	•				
	RB			•		•	•				
	RC			•		•	•				
Nylon/ Parallel Splices	RAA					•					
	RBB					•					
	RCC					•					
Nylon Disconnect/ Fully Insul. Disconnects (except 110 Disconnects)	RA			•		•	•				
	RB			•		•	•				
	RC			•		•	•				
Heat-Shrinkable Nylon Terminal, Butt Splice, Disconnects	RAS										
	RBS										
	RCS										
Vinyl Terminal, Splices	RA, RAA			•		•	•				
	RB, RBB			•		•	•				
	RC, RCC, RBC			•		•	•				
Bare Terminal, Splices	A, AA	•	•	•	•	•		•			
	B, BB	•	•	•	•	•		•		•	
	C, CC	•	•	•	•	•		•		•	
Wire Joints	RB						•				
	RC			•		•					
	RP			•		•					
Hi-Temp Terminals	PT		•	•		•					
	NW-Rings										•
	NW-Splice										•
Insulation Grip	A	•									
	B	•									
110 Disconnects	A, B	•	•	•							
	RA, RB										
Flag Terminal	AB								•		
	C								•		
Tefzel® Terminal	RAT, RBT, RCT			•		•	•	•			
Vinyl Disconnects	RA			•		•	•	•			
	RB			•		•	•	•			
	RC			•		•	•				
Bare Disconnects	A	•	•	•	•	•		•	•		
	B	•	•	•	•	•		•		•	
	C	•	•	•	•	•		•		•	
Tefzel® Butt Splices	RAAT			•		•					
	RBBT			•		•					
	RCCT			•		•					

Tefzel® is a registered trademark of DuPont.

Tool Charts

Critical information for determining the products you need!

Sta-Kon Terminal Products and Tools

DESCRIPTION	TERMINAL		HAND TOOL WITH DIES	25000 AIR TOOL TBM6 — TOGGLE HAND TOOL TBM6S — TOGGLE HAND TOOL DIE CAT. NOS.		13642M (MS25441-1) AND 13400 HYDRAULIC TOOL		
	SERIES	TYPE		NEST (STATIONARY)	INDENTOR (MOVABLE)	HEX DIES	NEST	INDENTOR
Non-Insulated Terminals and Splices	D	Tubular	ERG2005	11803	11802	11781M*	13651	13650**
	D	Tubular	ERG2008	11803	11802	11781M*	13651	13650**
	D	Tubular	WT3185	11803	11802	11732	13651	13650**
	D	Brazed	WT3185	11803	11802	11733	13652	13650**
	E	Tubular	ERG2005	11803	11802	11733	13652	13650**
	E	Tubular	ERG2008	11803	11802	11733	13652	13650**
	E	Tubular	WT3185	11803	11802	11782M*	13652	13650**
	E	Brazed	WT3185	11805	11802	11734	13653	13650**
	F	Tubular	ERG2008	11805	11802	11734	13653	13650**
	F	Tubular	WT3185	11805	11802	11783M*	13653	13650**
	F	Brazed	WT3185	11806	11802	11735	13645	13650**
	G	Tubular	ERG2008	11806	11802	11784M*/11736	13654	13650**
	G	Tubular	WT3185	11806	11802	11784M*/11736	13654	13650**
	H	Tubular	ERG2008	11807	11802	11785M*	13655	13650**
	H	Tubular	WT3185	11807	11802	11785M*	13655	13650**
	H	Tubular	WT3185	11807	11802	11737	13655	13650**
	J	Tubular	WT3185	11808	11802	11786M*	13656	13650**
	J	Tubular	WT3185	11808	11802	11738	13656	13650**
	K	Tubular	—	11809	11802	11787M*	13657	13650**
	K	Tubular	—	11809	11802	11739	13657	13650**
L	Tubular	—	11810	11802	11788M*	13658	13650**	
L	Tubular	—	11810	11802	11740	13658	13650**	
M	Tubular	—	11811	11802	11789M*	13659	13650**	
M	Tubular	—	11811	11802	11771	13659	13650**	
Tefzel® Nylon Insulated Terminals and Splices	RD	Tubular	ERG2007	11821 (Set)	—	—	21707M* (Set)	—
	RD	Brazed	—	11822 (Set)	—	—	21708M* (Set)	—
	RE	Tubular	ERG2007	11822 (Set)	—	—	21708M* (Set)	—
	RE	Brazed	—	11823 (Set)	—	—	21709M* (Set)	—
	RF	Tubular	—	11823 (Set)	—	—	21709M* (Set)	—
	RF	Brazed	—	11824 (Set)	—	—	21710M* (Set)	—
	RG	Tubular	—	11824 (Set)	—	—	21710M* (Set)	—
	RH	Tubular	—	11825 (Set)	—	—	21711M* (Set)	—
	RJ	Tubular	—	11826 (Set)	—	—	21712M* (Set)	—
	RK	Tubular	—	11827 (Set)	—	—	21713M* (Set)	—
RL	Tubular	—	11828 (Set)	—	—	21714M* (Set)	—	
RM	Tubular	—	11829 (Set)	—	—	21715M* (Set)	—	
Non-Insulated Flag Terminals	D	—	WT129	—	—	—	21733	21731
	E	—	WT129	—	—	—	21734	21731
	F	—	WT129	—	—	—	21735	21731
	G	—	WT129	—	—	—	21736	21732
	H	—	—	—	—	—	21737	21732
	J	—	—	—	—	—	21738	21732
	K	—	—	—	—	—	21739	21732
	M	—	—	—	—	—	21740	21732

* Indicates military listed die.

** To order the military version, suffix the indentor catalog number with an "M" (13650M). Nest catalog number does not change.

† Tefzel® is a registered trademark of DuPont.

Stud Size and Clearance Hole Chart

STUD SIZE	2	4	6	8	10	¼	⅜	½	⅝	¾	1	
Min. hole diam. — in.	0.92	.116	.143	.169	.196	.262	.323	.388	.453	.516	.650	.775
Min. hole diam. — mm	2.337	2.946	3.632	4.292	4.978	6.655	8.204	9.855	11.506	13.106	16.510	19.685

Wire Guide Tables

Wire Strip Length Chart

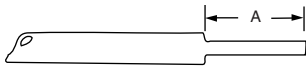

WIRE STRIP LENGTH	TERMINAL SERIES	RECOMMEND WIRE STRIP LENGTH "A" STANDARD TERMINALS
Non-Insulated	A	¼
	B	¼
	C, BC	⅜
Vinyl Insulated — Add ⅜" for	RA	¼
	RB	¼
Funnel Entry Type	RC, RBC	½
Nylon Insulated and Tefzel®	RA	⅜
	RB	⅜
Insulated	RC, RBC	⅝
Nylon Insulated and Tefzel® Insulated when using Aircraft and Code Wire	RD	⅞
	RE	⅞
	RF	⅞
	RG	⅞
	RH	⅞
	RJ	¾
Non-Insulated, when using Aircraft Code Wire	RK	¾
	RL	¾
	RM	1
	D	⅞
	E	⅞
F	½	
G	⅜	
H	⅜	
J	⅜	
K	⅝	
L	⅝	
M	⅝	

Tefzel® is a registered trademark of DuPont.

AWG OR AN	NAVY SHIPBOARD ³	INDIVIDUAL STRANDS		WHOLE CONDUCTOR		
		NO.	DIAM. IN.	CIR. MIL. AREA	DIAM. IN.	DIAM. MM
22 Wire Size						
22	3/5 (1)	1	.025	642	.025	.635
22	3/5 (7)	7	.010	703	.030	.762
AN-22*		7	*	704	.032	.813
	½ (21)	21	.005	525	.028	.711
20 Wire Size						
20	1 (1)	1	.032	1,022	.032	.813
20		7	.012	1,024	.036	.914
20		10	.010	1,005	.040	1.016
20		19	.007	1,022	.037	.940
20		26	.006	1,034	.039	.991
AN-20*		7	*	1,119	.040	1.016
	1 (7)	7	.013	1,119	.038	.965
	1 (10)	10	.010	1,005	.038	.965
	1 (26)	26	.006	1,034	.042	1.067
18 Wire Size						
18	1½ (1)	1	.040	1,624	.040	1.016
18	1½ (7)	7	.016	1,624	.049	1.245
18	1½ (16)	16	.010	1,608	.049	1.245
18		19	.009	1,624	.046	1.168
18	1½ (41)	41	.006	1,630	.049	1.245
AN-18*	2 (7)	7	.016	1,779	.048	1.219
16 Wire Size						
16	2½ (1)	1	.051	2,583	.051	1.295
16		7	.019	2,583	.058	1.473
16		19	.012	2,601	.058	1.473
16		26	.010	2,613	.059	1.499
16		65	.006	2,580	.058	1.473
AN-16*	2½ (19)	19	.011	2,407	.061	1.549
	2½ (26)	26	.010	2,613	.061	1.549
14 Wire Size						
14		1	.064	4,107	.064	1.626
14		7	.024	4,107	.073	1.854
14		19	.015	4,107	.074	1.880
14		37	.011	4,107	.074	1.880
14		14	.009	4,157	.083	2.108
14		104	.006	4,128	.074	1.880
AN-14*		19	*	3,830	.076	1.930
	3 (7)	7	.020	2,828	.060	1.524
	3 (19)	19	.013	3,036	.063	1.600
	4 (1)	1	.064	4,107	.064	1.626
	4 (7)	7	.025	4,497	.076	1.930
	4 (19)	19	.014	3,828	.072	1.829
	4 (41)	41	.010	4,121	.077	1.956
12 Wire Size						
12		1	.081	6,530	.081	2.057
12		7	.031	6,530	.092	2.337
12		19	.019	6,530	.093	2.362
12		37	.013	6,530	.093	2.362
12		49	.012	6,593	.104	2.642
12		65	.010	6,533	.093	2.362
12		104	.008	6,574	.094	2.388
12		165	.006	6,559	.095	2.413
AN-12*	6 (19)	19	.018	6,088	.096	2.438
	6 (7)	7	.031	6,512	.092	2.337
	6 (65)	65	.010	6,533	.097	2.964
10 Wire Size						
10		1	.102	10,380	.102	2.591
10		7	.039	10,380	.116	2.946
10		19	.023	10,380	.117	2.972
10		37	.017	10,443	.117	2.972
10		49	.015	10,445	.131	2.327
10		104	.010	10,452	.116	2.946
AN-10*		37	*	10,380	.117	2.972
	9 (7)	7	.036	9,016	.108	2.743
	9 (37)	37	.016	9,402	.109	2.769
	9 (90)	90	.010	9,045	.120	3.048

* MIL-W-5086. * Strand diameter not specified. 3 MIL-E-16366 A.

Wire Guide Tables

AWG OR AN	NAVY SHIPBOARD ³	INDIVIDUAL STRANDS		WHOLE CONDUCTOR		
		NO.	DIAM. IN.	CIR. MIL. AREA	DIAM. IN.	DIAM. MM
9 Wire Size						
9		7	.043	13,090	.130	3.302
	14 (7)	7	.045	14,340	.136	3.454
8 Wire Size						
8		7	.049	16,510	.146	3.712
8		19	.030	16,510	.148	3.763
8		37	.021	16,510	.148	3.763
7 Wire Size						
7		1	.144	20,820	.144	3.662
	14 (7)	7	.045	14,340	.136	3.454
	14 (140)	140	.010	14,070	.145	3.787
6 Wire Size						
6		7	.061	25,250	.184	4.672
6		19	.037	26,250	.186	4.722
6		37	.027	26,250	.186	4.722
6		49	.023	26,146	.208	5.283
6		661	.006	26,274	.259	6.579
5 Wire Size						
5		1	.181	33,100	.181	4.595
	20 (49)	7x7	.020	19,800	.180	4.570
	23 (7)	7	.057	22,800	.171	4.345
	23 (228)	19x12	.010	22,190	.190	4.830
	26 (49)	7x7	.023	26,250	.210	5.330
4 Wire Size						
4		7	.077	41,740	.232	5.891
4		19	.047	41,740	.235	5.967
4		37	.034	41,740	.235	5.967
3 Wire Size						
3		1	.229	52,630	.229	5.819
	30 (304)	19x16	.010	30,550	.220	5.590
	33 (336)	7x48	.010	33,370	.235	5.967
	40 (19)	19	.045	38,910	.226	5.742
	42 (49)	7x7	.029	41,740	.260	6.600
	42 (209)	19x11	.014	42,110	.260	6.600
	50 (19)	19	.051	49,080	.254	6.452
2 Wire Size						
2		7	.097	66,370	.292	7.421
2		19	.059	66,370	.296	7.522
2		37	.042	66,370	.297	7.548
2		49	.037	66,356	.331	8.405
2		133	.022	66,140	.335	8.507
AN-2*		663	*	66,832	.345	8.767
	53 (532)	19x28	.010	53,470	.304	7.772
	60 (37)	37	.040	60,090	.282	7.161
	60 (304)	19x16	.014	61,260	.310	7.870
	66 (133)	19x7	.022	66,370	.330	8.380
	75 (37)	37	.045	75,780	.317	8.048
1 Wire Size						
1		7	.109	83,690	.328	8.333
1		19	.066	83,690	.332	8.431
1		37	.048	83,690	.333	8.456
1		61	.037	83,690	.333	8.456
1		133	.025	83,690	.377	9.578
1		259	.018	83,916	.378	9.603
AN-1*		812	*	81,807	.384	9.752
	83 (418)	19x22	.014	84,230	.380	9.650
	84 (2,107)	2107	*	83,690	.410	10.41

* MIL-W-5086.
 * Strand diameter not specified.
 3 MIL-E-16366 A

Wire Guide Tables

AWG OR AN	NAVY SHIPBOARD ³	INDIVIDUAL STRANDS		WHOLE CONDUCTOR		
		NO.	DIAM. IN.	CIR. MIL. AREA	DIAM. IN.	DIAM. MM
1/0 Wire Size						
1/0		7	.123	105,500	.368	9.343
1/0		19	.075	105,500	.373	9.476
1/0		37	.053	105,500	.374	9.502
1/0		61	.042	105,500	.374	9.502
1/0		133	.028	105,761	.423	10.721
1/0		259	.020	105,672	.424	10.772
AN-0*		1,033	*	104,118	.432	10.971
	100 (61)	61	.040	99,060	.363	9.216
	105 (259)	37x7	*	105,500	.410	10.410
2/0 Wire Size						
	105 (2,646)	2,646	*	105,500	.460	11.680
2/0		7	.138	133,100	.414	10.512
2/0		19	.084	133,100	.419	10.639
2/0		37	.060	133,100	.420	10.670
2/0		61	.047	133,100	.420	10.670
2/0		133	.032	132,800	.474	12.042
2/0		259	.023	133,462	.477	12.118
AN-00*		1,327	*	133,665	.490	12.450
	125 (61)	61	.045	124,900	.407	10.338
	133 (259)	37x7	*	133,100	.460	11.680
	133 (684)	19x36	.014	137,800	.480	12.190
	133 (3,325)	3,325	*	133,100	.520	13.210
	150 (61)	61	.051	157,600	.457	11.608
3/0 Wire Size						
3/0		7	.155	167,800	.464	11.782
3/0		19	.094	167,800	.470	11.940
3/0		37	.067	167,800	.471	11.965
3/0		61	.052	167,800	.472	11.991
3/0		133	.036	167,607	.533	13.536
3/0		259	.026	167,402	.536	13.612
3/0		4,227	.006	168,023	.610	15.490
	150 (760)	19x40	.014	153,100	.510	12.950
	168 (427)	61x7	*	167,800	.520	13.210
4/0 Wire Size						
4/0		7	.174	211,600	.522	13.261
4/0		19	.106	211,600	.528	13.413
4/0		37	.076	211,600	.529	13.439
4/0		61	.059	211,600	.530	13.460
4/0		133	.040	211,736	.599	15.219
4/0		259	.029	211,845	.601	15.265
AN-000*		1,661	*	167,332	.548	13.923
	200 (61)	61	.057	198,700	.514	13.652
	200 (988)	19x52	.014	199,100	.580	14.730
250 MCM Wire Size						
250,000		19	.115	250,000	.574	14.582
250,000		37	2	250,000	.575	14.607
250,000		61	.064	250,000	.576	14.632
250,000		91	.052	250,000	.576	14.632
AN-0000*		2,104	*	211,954	.615	15.617
	220 (259)	37x7	.029	220,700	.610	15.490
	250 (61)	61	.064	250,000	.577	14.658

* MIL-W-5086.

* Strand diameter not specified.

3 MIL-E-16366 A.

Terminals Military Standard Cross Reference

Sta-Kon Terminal Products and Tools

MIL-T-7928 MS-25036	T&B CAT. NO. CLASS 1 & 2
-101	RA333
-102	RA853
-103	RA873
-104	RA723
-105	RA733
-106	RB1333
-107	RB853
-108	RB873
-109	RB723
-110	RB733
-111	RC333
-112	RC363
-113	RC703
-114	RC733
-115	RD10361
-116	RD10711
-117	RD10721
-118	RD10731
-119	RE10261
-120	RE10711
-121	RE10721
-122	RE10731
-123	RF10711
-124	RF10721
-125	RF10731
-126	RG9711
-127	RG9731
-128	RG9751
-129	RH9711
-130	RH9731
-131	RH9751
-132	RJ9711
-133	RJ9731
-135	RK9721
-136	RK9731
-137	RK9751
-138	RL9731
-139	RL9751
-140	RM9731
-141	RM9751
-142	—
-143	RAX23
-144	RAX43
-145	RAX63
-146	RAX83
-147	RAX103
-148	RA323
-149	RA863
-150	RA713
-151	RA753
-152	RB1323
-153	RB863
-154	RB713
-155	RB753
-156	RC863
-157	RC713
-158	RC753

MIL-T-7928 MS-20659	T&B CAT. NO. CLASS 1 & 2
-101	A85G
-102	A87G
-103	B85G
-104	B87G
-105	C26
-106	C70
-107	D10361
-108	D10721
-109	E10711
-110	E10731
-111	F10711
-112	F10731
-113	G971
-114	G973
-115	H971
-116	H973
-117	J971
-118	J973
-119	K972
-120	K973
-121	L973
-122	L975
-123	M973
-124	M975
-128	C73
-129	D10731
-130	E10261
-131	E10721
-132	F10721
-133	G975
-134	H975
-135	J975
-136	K975
-140	D10161
-141	D10711
-144	F10261
-146	G926
-147	G972
-148	G974
-149	H972
-151	J972
-152	J974
-153	K971
-154	K974
-155	L972
-156	L974
-157	M972
-158	M974
-165	C33
-166	C75

MIL-T-22909 MS-90485	T&B CAT. NO.
-8	11781M
-6	11782M
-4	11783M
-2	11784M
-1	11785M
-01	11786M
-02	11787M
-03	11788M
-04	11789M

MIL-T-7928 MS-17143	T&B CAT. NO.
-1	RA480
-2	RB480
-3	RC480
-4	RA481
-5	RB481
-6	RC481
-7	RA482
-8	RB482
-9	RC482
-10	RA483
-11	RB483
-12	RC483
-13	RA484
-14	RB484
-15	RC484
-16	RA485
-17	RB485
-19	RA486
-20	RB486

MIL-T-7928 MS-21004	T&B CAT. NO.
-1	A486
-2	A483
-3	A482
-4	A481
-5	A485
-6	A484
-7	A480
-8	B486
-9	B483
-10	B482
-11	B481
-12	B485
-13	B484
-14	B480
-15	C486
-16	C483
-17	C482
-18	C481
-19	C485
-20	C484
-21	C480

MIL-T-22909 -MS-23002	T&B CAT. NO.
-8	21707M
-6	21708M
-4	21709M
-2	21710M
-1	21711M
-01	21712M
-02	21713M
-03	21714M
-04	21715M

NOTE: All catalog numbers do not appear in this cross reference. This means it may not be available in one of the package options.

Cross Reference for Packaging

T&B DISTRIBUTOR PACKAGE	T&B BULK PACKAGE
A18-6	A85
A18-6F	A116
A18-6FL	A221
A18-8	A86
A18-8F	A114
A18-8FL	A224
A18-10	A87
A18-10F	A115
A18-10FL	A225
A18-12	A75
A18-14	A71
A18-38	A73
A18-110F	A10
A18-111F	A11
A18-250	A250
A18-250A	A252G
A18-251T	A251
A18-516	A72
AB14-6A	AB51
AB14-8A	AB52
AB14-10A	AB53
AD18-182	AD182
AD18-183	AD183
B14-D	B23
B14-4	B132
B14-6	B133
B14-6F	B64
B14-6FL	B220
B14-6FS	B19
B14-8	B86
B14-8F	B65
B14-8FL	B223
B14-10	B87
B14-10F	B115
B14-10FL	B225
B14-10G	B87G
B14-12	B75
B14-14	B71
B14-38	B73
B14-110F	B10
B14-111F	B11
B14-250	B250
B14-250A	B252G
B14-250F	B250G
B14-250T	B251G
B14-251T	B251
B14-516	B72
BC14-6	BC85
BC14-8	BC86
BC14-10	BC87
BC14-12	BC75
BC14-14	BC71
BC14-38	BC79
BC14-516	BC72
BD14-183	BD183
C10-6	C33
C10-6A	C51
C10-6F	C133
C10-6FL	C220
C10-8	C77
C10-8A	C52
C10-8F	C114
C10-8FL	C221
C10-10	C26
C10-10A	C53
C10-10F	C115
C10-10FL	C222
C10-12	C75

T&B DISTRIBUTOR PACKAGE	T&B BULK PACKAGE
C10-14	C71
C10-14F	C116
C10-38	C73
C10-250A	C252G
C10-250F	C250
C10-516	C70
D8-10	D36
D8-12	D75
D8-14	D71
D8-38	D73
D8-516	D72
E6-10	E26
E6-12	E75
E6-14	E71
E6-38	E73
E6-516	E72
F4-10	F26
F4-12	F75
F4-14	F71
F4-38	F73
F4-516	F72
F250TA	FTA250
G2-12	G975
G2-14	G971
G2-38	G973
G2-516	G972
H10-14	H971
J20-38	J973
K30-38	K973
L40-38	L973
M250-38	M973
NW14-6	NW81
NW14-10	NW83
NW14-12	NW84
NW22-10	NW23
RA18D	RA23
RA18-4	RA323
RA18-6	RA853
RA18-6F	RA1103
RA18-6FL	RA2213
RA18-6FS	RA1203
RA18-8	RA863
RA18-8F	RA1123
RA18-8FL	RA2243
RA18-8FS	RA1223
RA18-10	RA873
RA18-10F	RA1153
RA18-10FL	RA2253
RA18-10FS	RA1253
RA18-12	RA753
RA18-14	RA713
RA18-14F	RA1163
RA18-38	RA733
RA18-47PT	RA147PT
RA18-110F	RA10
RA18-111F	RA11
RA18-250A	RA2577F
RA18-250F	RA250
RA18-250FP	RA250P
RA18-516	RA723
RAD18-182	RAD1823
RAD18-183	RAD1833
RB14-4	RB1323
RB14-6	RB853
RB14-6F	RB1113
RB14-6FL	RB2213
RB14-6FS	RB1203
RB14-6X	RB854

T&B DISTRIBUTOR PACKAGE	T&B BULK PACKAGE
RB14-8	RB863
RB14-8F	RB1123
RB14-8FL	RB2233
RB14-8FS	RB1223
RB14-8X	RB864
RB14-10	RB873
RB14-10F	RB1153
RB14-10FL	RB2253
RB14-10FS	RB1253
RB14-10X	RB874
RB14-12	RB753
RB14-14	RB713
RB14-14F	RB1163
RB14-14X	RB714
RB14-38	RB733
RB14-38X	RB734
RB14-47PT	RB147PT
RB14-110F	RB10
RB14-111F	RB11
RB14-250	RBB250
RB14-250A	RB2577F
RB14-250F	RB250
RB14-250FP	RB250P
RB14-516	RB723
RB14-516X	RB724
RB44	RB4
RBC14-14	RBC713
RBC14-516	RBC723
RBD14-182	RBD1823
RBD14-183	RBD1833
RC10-6	RC333
RC10-6F	RC1113
RC10-6FL	RC2203
RC10-8	RC863
RC10-8F	RC1123
RC10-8FL	RC2213
RC10-8FS	RC1223
RC10-8X	RC864
RC10-10	RC363
RC10-10F	RC1153
RC10-10FL	RC2223
RC10-10FS	RC1253
RC10-10X	RC364
RC10-12	RC753
RC10-14	RC713
RC10-14F	RC1163
RC10-14FL	RC2233
RC10-14X	RC714
RC10-38	RC733
RC10-38X	RC734
RC10-55PT	RC155PT
RC10-250A	RC2577F
RC10-250F	RC250
RC10-516	RC703
RC55	RC6
RD8-10	RD367
RD8-12	RD757
RD8-14	RD717
RD8-38	RD737
RD8-516	RD727
RE6-10	RE267
RE6-12	RE757
RE6-14	RE717
RE6-38	RE737
RE6-516	RE727
RF4-10	RF267
RF4-12	RF757
RF4-14	RF717

T&B DISTRIBUTOR PACKAGE	T&B BULK PACKAGE
RF4-38	RF737
RF4-516	RF727
RG2-10	RG267
RG2-12	RG757
RG2-14	RG717
RG2-38	RG737
RG2-516	RG727
RP12	RP7
2A-18	AA2
2A20	RAA24
2A22-20	A1A
2B-14	BB2
2B-16	RBB25
2B18-16	B1B
2C-10	CC2
2C-12	RCC26
2C14-12	C1C
2D-8	DD102
2D10-9	D1D
2E-6	EE2
2E8-7	E1E
2F-4	FF2
2F6-5	F1F
2G21	GG2
2G4-2	G1G
2RAA	RAA23
2RA18	RAA21
2RA18X	RAA217-170
2RBB	RBB23
2RB14	RBB21
2RB14X	RBB217-200
2RCC	RCC23
2RC10	RCC21
2RC10X	RCC217-250
2RD8	RDD27
2RE6	REE28
10RC-6	RC337
10RC-6F	RC1337
10RC-6FL	RC2207
10RC-6FLX	RC2207-250
10RC-6X	RC337-250
10RC-8	RC777
10RC-8F	RC1147
10RC-8FL	RC2217
10RC-8FLX	RC2217-250
10RC-8X	RC777-250
10RC-10	RC367
10RC-10F	RC1157
10RC-10FL	RC2227
10RC-10FLX	RC2227-250
10RC-10FX	RC1157-250
10RC-10X	RC367-250
10RC-14	RC717
10RC-14F	RC1167
10RC-14FL	RC2237
10RC-14X	RC717-250
10RC-38	RC737
10RC-38X	RC737-250
10RC-55PT	RC55PT
10RC-250F	RC257
10RC-250T	RC2517
10RC-251T	RC25177
10RC-516	RC707
10RC-2577	RC2573
14RB-4	RB1327
14RB-6	RB857

T&B DISTRIBUTOR PACKAGE	T&B BULK PACKAGE
14RB-6F	RB647
14RB-6FL	RB2207
14RB-6FLX	RB2207-200
14RB-6FX	RB647-200
14RB-6X	RB857-200
14RB-8	RB867
14RB-8F	RB657
14RB-8FL	RB2237
14RB-8FLX	RB2237-200
14RB-8FX	RB657-200
14RB-8X	RB867-200
14RB-10	RB877
14RB-10F	RB1157
14RB-10FL	RB2257
14RB-10FLX	RB2257-200
14RB-10FX	RB1157-200
14RB-10X	RB877-200
14RB-14	RB717
14RB-14X	RB717-200
14RB-38	RB737
14RB-47PT	RB47PT
14RB-250F	RB257
14RB-250T	RB2517
14RB-251T	RB25177
14RB-516	RB727
14RB-2577	RB2573
14RBC-6	RBC857
14RBC-8	RBC867
14RBC-10	RBC877
14RBC-14	RBC717
14RBC-516	RBC727
14RBC-38	RBC797
14RBC-12	RBC757
14RBD-182	RBD1827
14RBD-183	RBD1837
14RBD-18277	RBD18277
14RBD-18377	RBD18377
18RA-4	RA77
18RA-6	RA857
18RA-6F	RA1167
18RA-6FL	RA2217
18RA-6FLX	RA2217-170
18RA-6FX	RA1167-170
18RA-6X	RA857-170
18RA-8	RA867
18RA-8F	RA1147
18RA-8FL	RA2247
18RA-8FX	RA1147-170
18RA-8X	RA867-170
18RA-10	RA877
18RA-10F	RA1157
18RA-10FL	RA2257
18RA-10FLX	RA2257-170
18RA-14	RA717
18RA-38	RA737
18RA-47PT	RA47PT
18RA-250F	RA257
18RA-250T	RA2517
18RA-251T	RA25177
18RA-516	RA727
18RA-516X	RA727-170
18RA-2577	RA2573
18RAD-182	RAD1827
18RAD-183	RAD1837
18RAD-18277	RAD18277
18RAD-18377	RAD18377

Sta-Kon Terminal Products and Tools

Cross Reference for Packaging

Sta-Kon Terminal Products and Tools

T&B DISTRIBUTOR PACKAGE	T&B BULK PACKAGE
RB14-8	RB863
RB14-8X	RB864
14RB-8	RB867
14RB-8X	RB867-200
RB14-10	RB873
RB14-10X	RB874
14RB-10	RB877
14RB-10X	RB877-200
RB14-6F	RB1113
RB14-8F	RB1123
RB14-10F	RB1153
14RB-10F	RB1157
14RB-10FX	RB1157-200
RB14-14F	RB1163
RB14-6FS	RB1203
RB14-8FS	RB1223
RB14-10FS	RB1253
RB14-4	RB1323
14RB-4	RB1327
14RB-6FL	RB2207
14RB-6FLX	RB2207-200
RB14-6FL	RB2213
RB14-8FL	RB2233
14RB-8FL	RB2237
14RB-8FLX	RB2237-200
RB14-10FL	RB2253
14RB-10FL	RB2257
14RB-10FLX	RB2257-200
14RB-250T	RB2517
14RB-257T	RB2573
RB14-250A	RB2577F
14RB-251T	RB25177
2RB14	RBB21
2RBB	RBB23
2B16	RBB25
2RB14X	RBB217-200
RB14-250	RBB250
RBC14-14	RBC713
14RBC-14	RBC717
RBC14-516	RBC723
14RBC-516	RBC727
14RBC-12	RBC757
14RBC-38	RBC797
14RBC-6	RBC857
14RBC-8	RBC867
14RBC-10	RBC877
RBD14-182	RBD1823
14RBD-182	RBD1827
RBD14-183	RBD1833
14RBD-183	RBD1837
14RBD-18277	RBD18277
14RBD-18377	RBD18377
RC55	RC6
10RC-55PT	RC55PT
RC10-55PT	RC155PT
RC10-250F	RC250
10RC-250F	RC257
RC10-6	RC333
10RC-6	RC337
10RC-6X	RC337-250
RC10-10	RC363
RC10-10X	RC364
10RC-10	RC367
10RC-10X	RC367-250
RC10-516	RC703
10RC-516	RC707

T&B DISTRIBUTOR PACKAGE	T&B BULK PACKAGE
RC10-14	RC713
RC10-14X	RC714
10RC-14	RC717
10RC-14X	RC717-250
RC10-38	RC733
RC10-38X	RC734
10RC-38	RC737
10RC-38X	RC737-250
RC10-12	RC753
10RC-8	RC777
10RC-8X	RC777-250
RC10-8	RC863
RC10-8X	RC864
RC10-6F	RC1113
RC10-6FL	RC1123
10RC-8F	RC1147
RC10-10F	RC1153
10RC-10F	RC1157
10RC-10FX	RC1157-250
RC10-14F	RC1163
RC10-8FS	RC1223
RC10-10FS	RC1253
10RC-6F	RC1337
RC10-6FL	RC2203
10RC-6FL	RC2207
RC10-6FLX	RC2207-250
10RC-8FL	RC2213
10RC-8FL	RC2217
10RC-8FLX	RC2217-250
RC10-10FL	RC2223
10RC-10FL	RC2227
10RC-10FLX	RC2227-250
RC10-14FL	RC2233
10RC-14FL	RC2237
10RC-250T	RC2517
10RC-257T	RC2573
RC10-250A	RC2577F
10RC-251T	RC25177
2RC10	RCC21
2RCC	RCC23
2C12	RCC26
2RC10X	RCC217-250
RD8-10	RD367
RD8-14	RD717
RD8-516	RD727
RD8-38	RD737
RD8-12	RD757
2RD8	RDD27
RE6-10	RE267
RE6-14	RE717
RE6-516	RE727
RE6-38	RE737
RE6-12	RE757
2RE6	REE28
RF4-10	RF267
RF4-14	RF717
RF4-516	RF727
RF4-38	RF737
2RF4	RFF29
RG2-10	RG267
RG2-14	RG717
RG2-516	RG727
RG2-38	RG737
RG2-12	RG757
RP12	RP7

T&B DISTRIBUTOR PACKAGE	T&B BULK PACKAGE
A18-110F	A10
A18-111F	A11
A18-10F	A115
A18-14	A71
A18-14F	A71F
A18-12	A75
A18-6	A85
A18-8	A86
A18-10	A87
A18-8F	A114
A18-10F	A115
A18-6F	A116
A18-6FL	A221
A18-8FL	A224
A18-10FL	A225
A18-250	A250
A18-251T	A251
A18-250A	A252G
2A22-20	A1A
2A18	AA2
AB14-6A	AB51
AB14-8A	AB52
AB14-10A	AB53
AD18-182	AD182
AD18-183	AD183
B14-110F	B10
B14-111F	B11
B14-D	B23
B14-6F	B64
B14-8F	B65
B14-14	B71
B14-516	B72
B14-38	B73
B14-12	B75
B14-6	B133
B14-8	B86
B14-10	B87
B14-10G	B87G
B14-10F	B115
B14-4	B132
B14-6FL	B220
B14-8FL	B223
B14-10FL	B225
B14-250	B250
B14-250F	B250G
B14-251T	B251
B14-250T	B251G
B14-250A	B252G
2B18-16	B1B
2B14	BB2
BC14-14	BC71
BC14-516	BC72
BC14-12	BC75
BC14-38	BC79
BC14-6	BC85
BC14-8	BC86
BC14-10	BC87
BD14-183	BD183
C10-10	C26
C10-6	C33
C10-8A	C52
C10-10	C53
C10-516	AC70
C10-14	C71
C10-38	C73
C10-12	C75
C10-8	C77
C10-8F	C114

T&B DISTRIBUTOR PACKAGE	T&B BULK PACKAGE
C1010F	C115
C10-14F	C116
C10-6F	C133
C10-6FL	C220
C10-8FL	C221
C10-10FL	C222
C10-250F	C250
C10-250A	C252G
2C14-12	C1C
2C10	CC2
D8-10	D36
D8-14	D71
D8-516	D72
D8-38	D73
D8-12	D75
2D10-9	D1D
2D8	DD102
E6-10	E26
E6-14	E71
E6-516	E72
E6-38	E73
E6-12	E75
2E8-7	E1E
2.00E+06	EE2
F4-10	F26
F4-14	F71
F4-516	F72
F4-38	F73
F4-12	F75
2F6-5	F1F
2F4	FF2
F250-TA	FTA250
G2-14	G971
G2-516	G972
G2-38	G973
G2-12	G975
2G4-2	G1G
2G21	G62
H10-14	H971
J20-38	J973
K30-38	K973
L40-38	L973
M250-38	M973
NW22-10	NW23
NW14-10	NW83
NW14-12	NW84
RA18-110F	RA10
RA18-111F	RA11
RA18-D	RA23
18RA-47PT	RA47PT
18RA-4	RA77
RA18-47PT	RA147PT
RA18-250F	RA250
RA18-250FP	RA250P
18RA-250F	RA257
RA18-4	RA323
RA18-14	RA713
18RA-14	RA717
RA18-516	RA723
18RA-516	RA727
RA18-38	RA733
18RA-38	RA737
RA18-12	RA753
RA18-6	RA853
18RA-6	RA857
18RA-6X	RA857-170
RA18-8	RA863
18RA-8	RA867

T&B DISTRIBUTOR PACKAGE	T&B BULK PACKAGE
18RA-8X	RA867-170
RA18-10	RA873
18RA-10	RA877
18RA-10X	RA877-170
RA18-6F	RA1103
RA18-8F	RA1123
18RA-8F	RA1147
18RA-8FX	RA1147-170
RA18-10F	RA1153
18RA-10F	RA1157
RA18-14F	RA1163
18RA-6F	RA1167
18RA-6FX	RA1167-170
RA18-6FS	RA1203
18RA-8FS	RA1223
RA18-10FS	RA1253
RA18-6FL	RA2213
18RA-6FL	RA2217
18RA-6FLX	RA2217-170
RA18-8FL	RA2243
18RA-8FL	RA2247
RA18-10FL	RA2253
18RA-10FL	RA2257
18RA-10FLX	RA2257-170
18RA-250T	RA2517
18RA-257T	RA2573
RA18-250A	RA2577F
18RA-251T	RA25177
2RA18	RAA21
2RAA	RAA23
2A20	RAA24
2RA18X	RAA217-170
RAD18-182	RAD1823
18RAD-182	RAD1827
RAD18-183	RAD1833
18RAD-183	RAD1837
RAD18-188A	RAD1887F
18RAD18277	RAD18277
18RAD18377	RAD18377
RB44	RB4
RB14-110F	RB10
RB14-111F	RB11
RB14-D	RB23
14RB-47PT	RB47PT
14RB-6FS	RB197
RB14-47PT	RB147PT
RB14-250F	RB250
RB14-250FP	RB250P
14RB-250F	RB257
14RB-6F	RB647
14RB-6FX	RB647-200
14RB-8F	RB657
14RB-8FX	RB657-200
RB14-14	RB713
RB14-14X	RB714
14RB-14	RB717
14RB-14X	RB717-200
RB14-516	RB723
RB14-516X	RB724
14RB-516	RB727
RB14-38	RB733
RB14-38X	RB734
14RB-38	RB737
RB14-12	RB753
RB14-6	RB853
RB14-6X	RB854
14RB-6	RB857
14RB-6X	RB857-200