

3W High Power LED

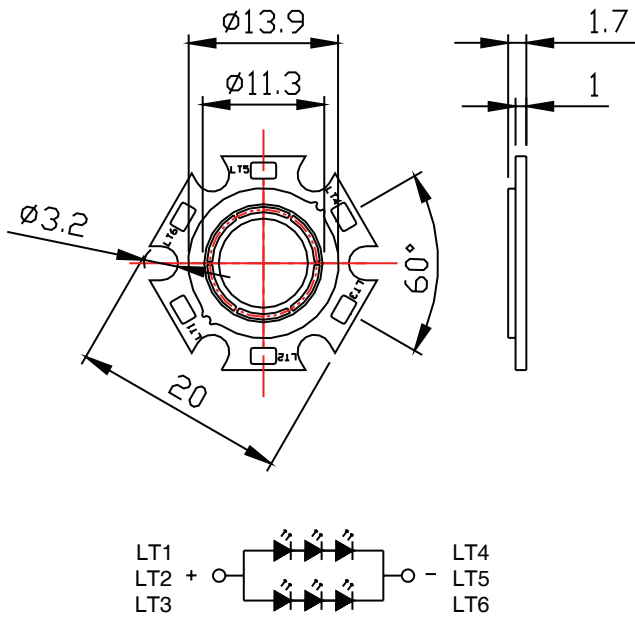

Package Dimensions:



Features:

- Pb-Free soldering application
- Multi-Chip package
- High reliability

Applications:

- Bulb
- Indoor decoration lighting
- Signal and symbol luminaries
- Reading lights
- Portable flashlight

All dimensions are in mm
Tolerance: $\pm 0.25\text{mm}$

Absolute Maximum Ratings at $T_a=25^\circ\text{C}$

| Parameter | Symbol | Rating | Unit |
|--|--------------|---|------------------|
| Power Dissipation* | P_D | 540 | mW |
| LED Junction Temperature* | T_j | 120 | V |
| Reverse Voltage* | V_r | 5 | mA |
| D.C. Forward Current* | I_r | 150 | μA |
| Peak Current (1 / 10 Duty Cycle, 0.1ms Pulse Width)* | I_f (Peak) | 500 | mA |
| Storage Temperature Range | $T_{stg.}$ | -40 to +85 | $^\circ\text{C}$ |
| Soldering Temperature (1.6mm from body) | $T_{sld.}$ | Dip Soldering: 260°C for 5sec. Hand Soldering: 350°C for 3sec. | |
| Electric Static Discharge Threshold (HBM)* | ESD | 300 | V |

* The values are based on 1 die performance.

3W High Power LED



Electrical & Optical Characteristics

| Parameter | Symbol | Condition | Min. | Typ. | Max. | Unit | |
|--------------------------------------|----------|------------------|---------|--------|------|------------------|------|
| Luminous Flux | Φ_v | IF=1,050mA | 200 | 250 | | lm | |
| | | | Rank L1 | 200 | | | 250 |
| | | | Rank L2 | 250 | | | 300 |
| Forward Voltage | VF | IF=1,050m | | 9.5 | | V | |
| | | | Rank V1 | 9 | | | 9.5 |
| | | | Rank V2 | 9.51 | | | 10 |
| | | | Rank V3 | 10.01 | | | 10.5 |
| Correlated Colour Temperature | CCT | IF=1,050mA | 5,250 | 5,750 | | K | |
| CIE Chromaticity Coordinates: X Axis | X | IF=1,050mA | | 0.3287 | | | |
| CIE Chromaticity Coordinates: Y Axis | Y | IF=1,050mA | | 0.3417 | | | |
| Reverse Current | IR | Vr=5V | | | 50 | μ A | |
| Colour Rendering Index | CRI | IF=1,050mA | | 72 | | Ra | |
| Viewing Angle at 50% | | $2\theta_{1/2}$ | | 120 | | Deg | |
| Thermal Resistance Junction to Case | | R θ_{j-c} | | 15 | | $^{\circ}$ C / W | |

Notes: 1. The data is tested by IS tester.
2. Customer's special requirements are also welcome.

Typical Electrical & Optical Characteristics Curves:

(25 $^{\circ}$ C Ambient temperature unless otherwise noted)

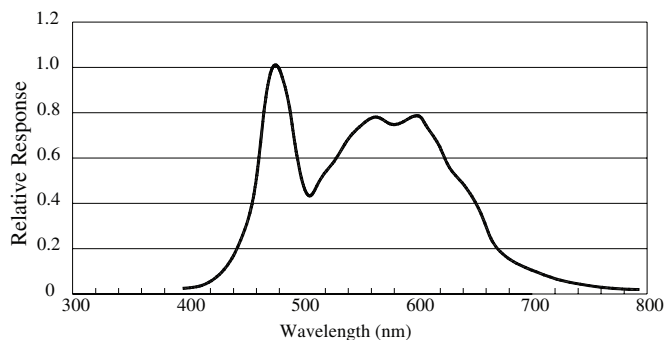
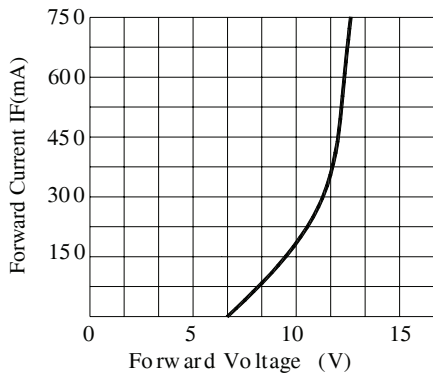
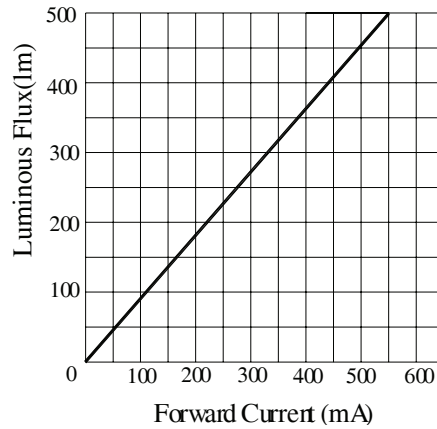

Fig.1 WHITE LED Spectrum VS. WAVELENGTH

3W High Power LED



Forward Current VS. Applied Voltage



Forward Current VS. Luminous Flux

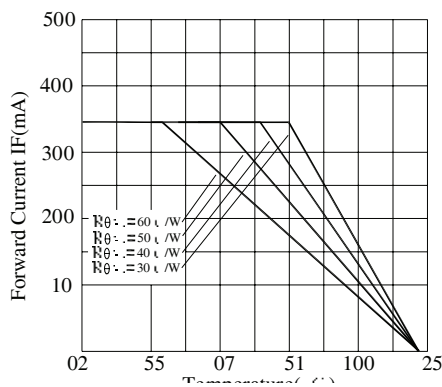

Ambient Temperature VS. Forward Current

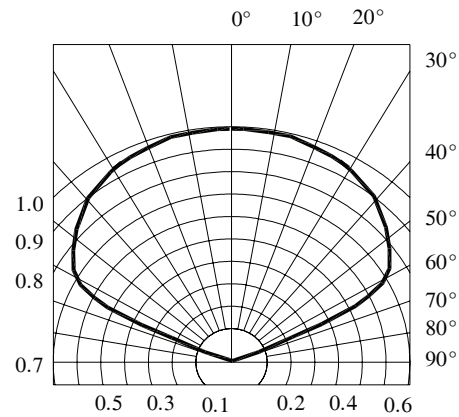

Radiation Diagram

Chromaticity Coordinates Specifications for Bin Grading:

| Bin | Rank | | | | | Bin | Rank | | | | |
|-----|------|--------|--------|--------|--------|-----|------|--------|--------|--------|--------|
| WB6 | X | 0.3327 | 0.3394 | 0.3390 | 0.3324 | WB7 | X | 0.3324 | 0.3390 | 0.3385 | 0.3324 |
| | Y | 0.3650 | 0.3719 | 0.3591 | 0.3519 | | Y | 0.3519 | 0.3591 | 0.3465 | 0.3388 |
| WC6 | X | 0.3264 | 0.3327 | 0.3324 | 0.3268 | WC7 | X | 0.3268 | 0.3324 | 0.3324 | 0.3272 |
| | Y | 0.3551 | 0.3650 | 0.3519 | 0.3430 | | Y | 0.3430 | 0.3519 | 0.3388 | 0.3305 |
| WD6 | X | 0.3210 | 0.3264 | 0.3268 | 0.3218 | WD7 | X | 0.3218 | 0.3268 | 0.3272 | 0.3227 |
| | Y | 0.3468 | 0.3551 | 0.3430 | 0.3353 | | Y | 0.3353 | 0.3430 | 0.3305 | 0.3233 |
| WE6 | X | 0.3164 | 0.3210 | 0.3218 | 0.3175 | WE7 | X | 0.3175 | 0.3218 | 0.3227 | 0.3186 |
| | Y | 0.3395 | 0.3468 | 0.3353 | 0.3283 | | Y | 0.3283 | 0.3353 | 0.3233 | 0.3169 |

Note: X, Y

Tolerance each Bin limit is ± 0.01



3W High Power LED



Chromaticity Coordinates & Bin Grading Diagram:

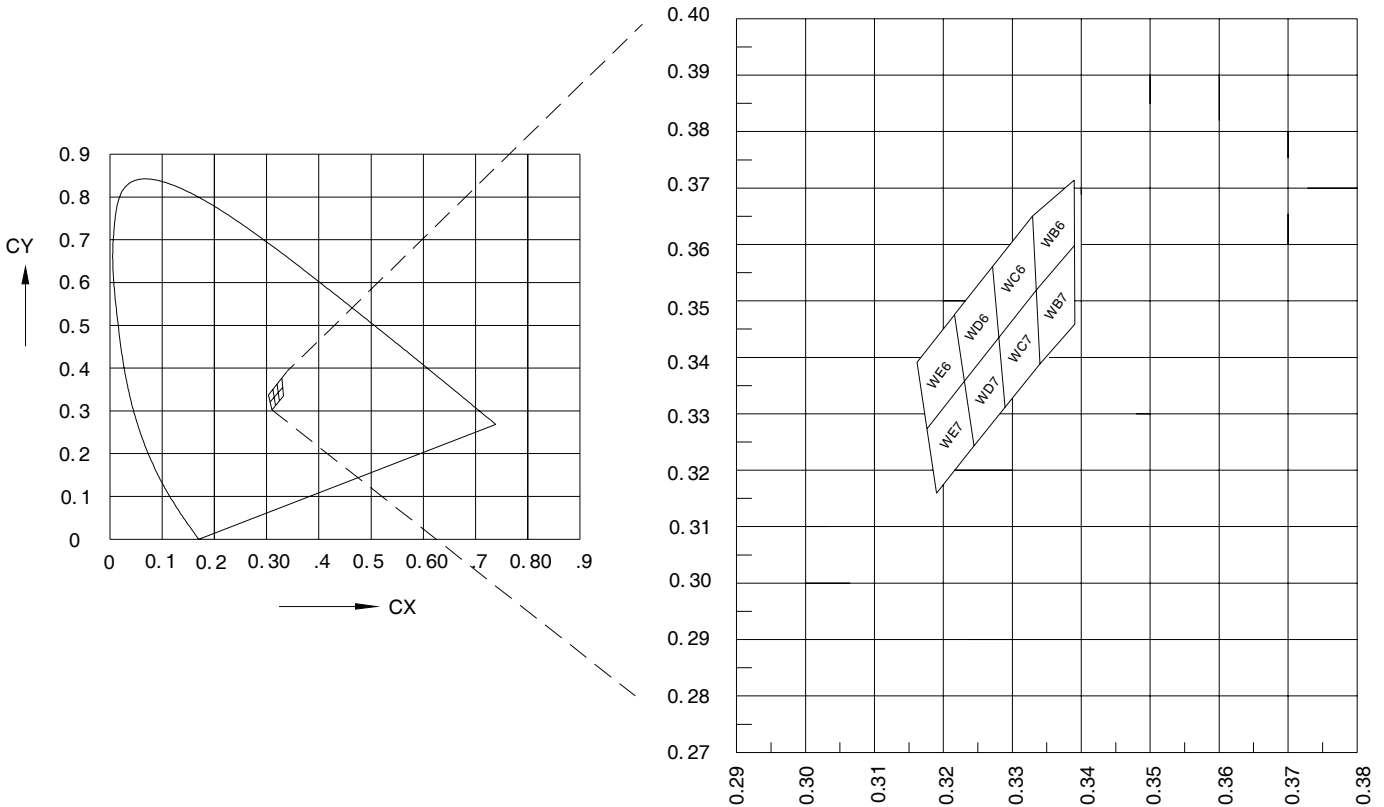

Part Number Table

| LED Chip | | Lens Colour | Part Number |
|----------------|--------------------|-----------------|-------------|
| Material | Colour Coordinates | | |
| InGaN/Sapphire | White | Yellow diffused | 703-0114 |

Important Notice : This data sheet and its contents (the "Information") belong to the members of the Premier Farnell group of companies (the "Group") or are licensed to it. No licence is granted for the use of it other than for information purposes in connection with the products to which it relates. No licence of any intellectual property rights is granted. The Information is subject to change without notice and replaces all data sheets previously supplied. The Information supplied is believed to be accurate but the Group assumes no responsibility for its accuracy or completeness, any error in or omission from it or for any use made of it. Users of this data sheet should check for themselves the Information and the suitability of the products for their purpose and not make any assumptions based on information included or omitted. Liability for loss or damage resulting from any reliance on the Information or use of it (including liability resulting from negligence or where the Group was aware of the possibility of such loss or damage arising) is excluded. This will not operate to limit or restrict the Group's liability for death or personal injury resulting from its negligence. Multicomp is the registered trademark of the Group. © Premier Farnell plc 2012.

