

5W High Power LED

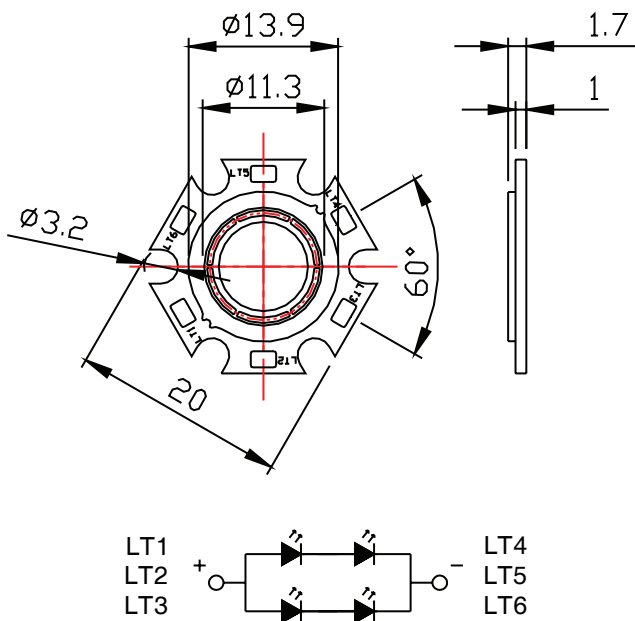

Package Dimensions:



Features:

- Pb-Free soldering application
- Multi-Chip package
- High reliability

Applications:

- Bulb
- Indoor decoration lighting
- Signal and symbol luminaries
- Reading lights
- Portable flashlight

All dimensions are in mm
Tolerance: $\pm 0.25\text{mm}$

Absolute Maximum Ratings at $T_a=25^\circ\text{C}$

Parameter	Symbol	Rating	Unit
Power Dissipation*	P_D	1,260	mW
LED Junction Temperature*	T_j	120	V
Reverse Voltage*	V_r	5	mA
D.C. Forward Current*	I_r	350	μA
Peak Current (1 / 10 Duty Cycle, 0.1ms Pulse Width)*	I_f (Peak)	1,000	mA
Storage Temperature Range	$T_{stg.}$	-40 to +85	$^\circ\text{C}$
Soldering Temperature (1.6mm from body)	$T_{sld.}$	Dip Soldering: 260°C for 10sec. Hand Soldering: 350°C for 3sec.	
Electric Static Discharge Threshold (HBM)*	ESD	300	V

* The values are based on 1 die performance.

Electrical & Optical Characteristics

Parameter	Symbol	Condition	Min.	Typ.	Max.	Unit
Luminous Flux		IF=1,050mA	300	400		lm
	Rank L1		300		400	
	Rank L2		400		450	
Forward Voltage		IF=1,050m		6.5		V
	Rank V1		6		6.5	
	Rank V2		6.51		7	
Correlated Colour Temperature	CCT	IF=1,050mA	5,250	5.750		K
CIE Chromaticity Coordinates: X Axis	X	IF=1,050mA		0.3287		
CIE Chromaticity Coordinates: Y Axis	Y	IF=1,050mA		0.3417		
Reverse Current	IR	Vr=5V			50	µA
Colour Rendering Index	CRI	IF=1,050mA		72		Ra
Viewing Angle at 50%		2 θ ½		120		Deg
Thermal Resistance Junction to Case		R θ j-c		15		°C / W

Notes: 1. The data is tested by IS tester.
2. Customer's special requirements are also welcome.

Typical Electrical & Optical Characteristics Curves:

(25°C Ambient temperature unless otherwise noted)

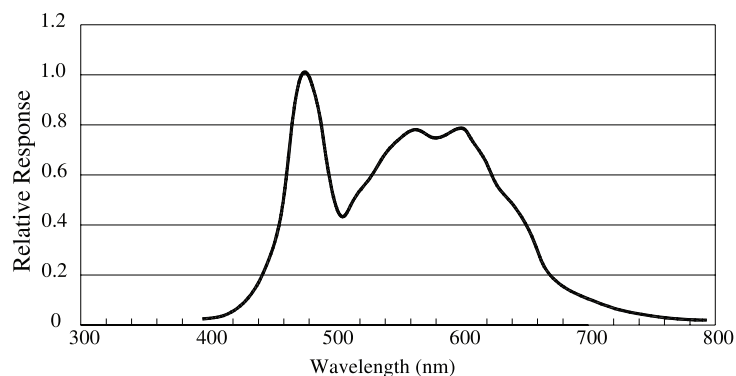
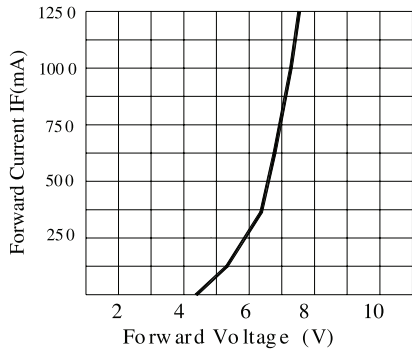
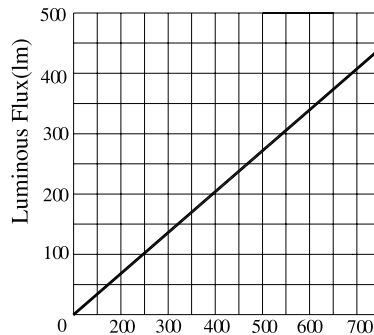

Fig.1 WHITE LED Spectrum VS. WAVELENGTH

5W High Power LED



Forward Current VS. Applied Voltage



Forward Current VS. Luminous Flux

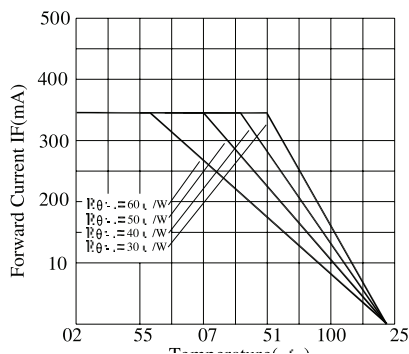

Ambient Temperature VS. Forward Current

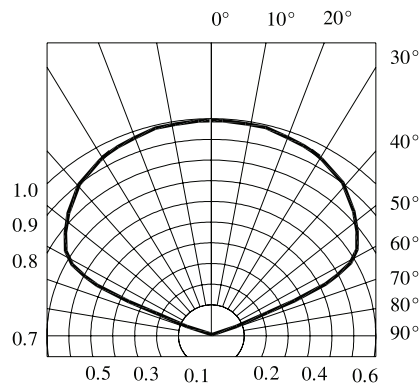

Radiation Diagram

Chromaticity Coordinates Specifications for Bin Grading:

Bin	Rank					Bin	Rank				
WB6	X	0.3327	0.3394	0.3390	0.3324	WB7	X	0.3324	0.3390	0.3385	0.3324
	Y	0.3650	0.3719	0.3591	0.3519		Y	0.3519	0.3591	0.3465	0.3388
WC6	X	0.3264	0.3327	0.3324	0.3268	WC7	X	0.3268	0.3324	0.3324	0.3272
	Y	0.3551	0.3650	0.3519	0.3430		Y	0.3430	0.3519	0.3388	0.3305
WD6	X	0.3210	0.3264	0.3268	0.3218	WD7	X	0.3218	0.3268	0.3272	0.3227
	Y	0.3468	0.3551	0.3430	0.3353		Y	0.3353	0.3430	0.3305	0.3233
WE6	X	0.3164	0.3210	0.3218	0.3175	WE7	X	0.3175	0.3218	0.3227	0.3186
	Y	0.3395	0.3468	0.3353	0.3283		Y	0.3283	0.3353	0.3233	0.3169

Note: X, Y
Tolerance each Bin limit is ± 0.01



5W High Power LED



Chromaticity Coordinates & Bin Grading Diagram:

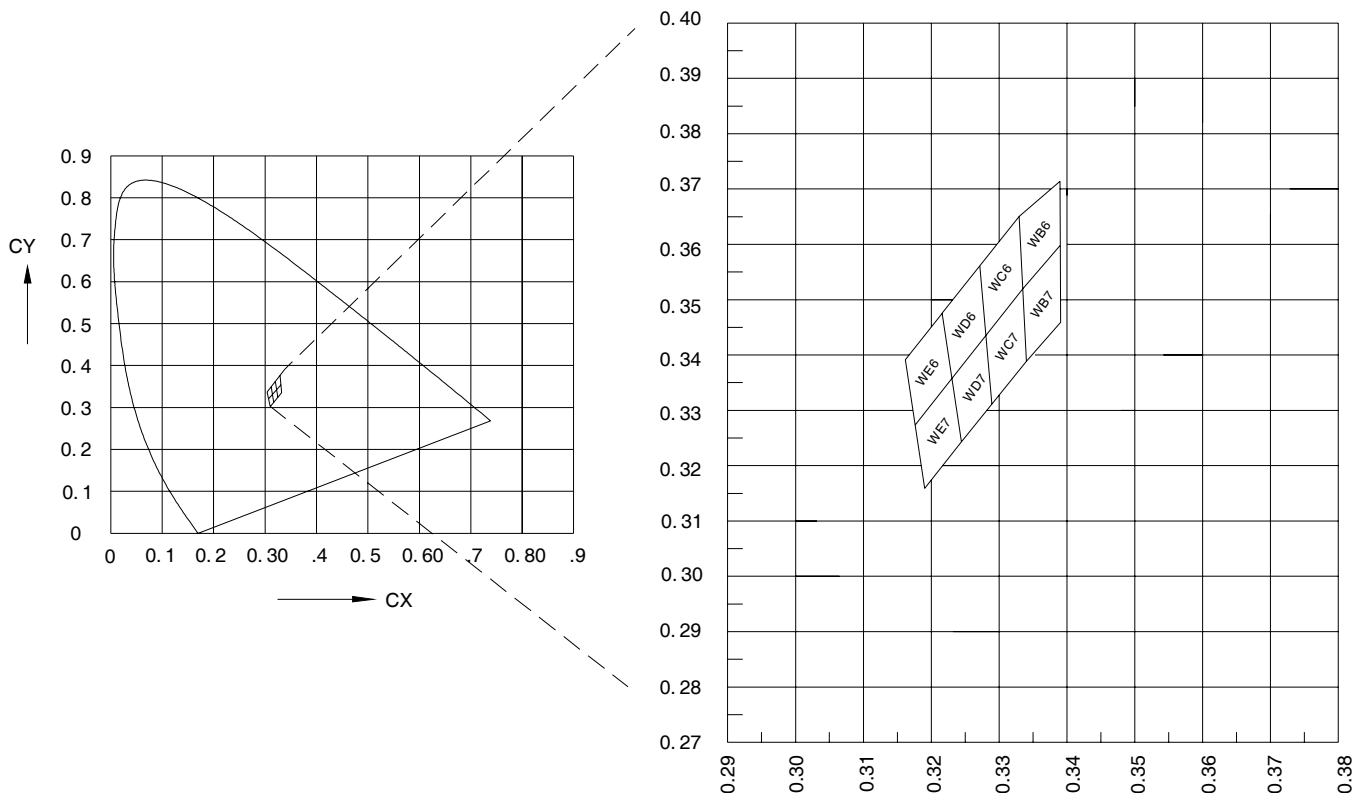

Part Number Table

LED Chip		Lens Colour	Part Number
Material	Colour Coordinates		
InGaN/Sapphire	White	Yellow diffused	703-0116

Important Notice : This data sheet and its contents (the "Information") belong to the members of the Premier Farnell group of companies (the "Group") or are licensed to it. No licence is granted for the use of it other than for information purposes in connection with the products to which it relates. No licence of any intellectual property rights is granted. The Information is subject to change without notice and replaces all data sheets previously supplied. The Information supplied is believed to be accurate but the Group assumes no responsibility for its accuracy or completeness, any error in or omission from it or for any use made of it. Users of this data sheet should check for themselves the Information and the suitability of the products for their purpose and not make any assumptions based on information included or omitted. Liability for loss or damage resulting from any reliance on the Information or use of it (including liability resulting from negligence or where the Group was aware of the possibility of such loss or damage arising) is excluded. This will not operate to limit or restrict the Group's liability for death or personal injury resulting from its negligence. Multicomp is the registered trademark of the Group. © Premier Farnell plc 2012.

www.element14.com
 www.farnell.com
 www.newark.com

