

THE INFORMATION CONTAINED IN THIS DRAWING IS THE SOLE PROPERTY OF L-COM, INC. ANY REPRODUCTION IN PART OR WHOLE WITHOUT THE WRITTEN PERMISSION OF L-COM, INC. IS PROHIBITED.

REVISIONS			
REV	DESCRIPTION	DATE	APPROVED
C	ECN1504: CHANGED CONTACT FROM 2 PRONG TO 3 PRONG TYPE	9/17/03	D. PARHAM
D	ECN1530: UPDATE NOTES	10/01/03	D. PARHAM
E	ECN1618: ADDED COMPONENT SPECIFICATION TABLE	01/06/04	D. PARHAM
F	ECN#2230: ADDED REFERENCE DOCUMENTATION LINKS	10/17/05	D. PARHAM

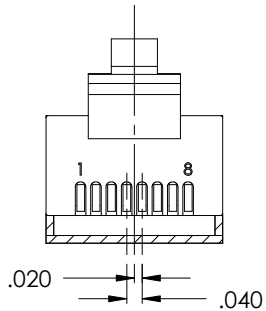

Component Specification	
Material	
Housing	UL94V-0 compliant polycarbonate
Contacts	Copper Alloy
Shielding	Brass
Finish	
Contact Plating	15 μinches Gold
Shielding	Nickel
Design	
Interface (Mechanical)	Shall conform to FCC 68.5 subpart F
Electrical	
Current Rating	2A (max) @ 25°C
Voltage Rating	250 VAC (max)
Insulation Resistance	500 MΩ @ 1000 VAC
Mechanical	
Durability	Minimum of 500 insertion and withdrawal cycles
Conductor acceptance	24 or 26 AWG
Maximum Conductor OD	.038"
Conductor Type	Stranded or Solid
Contact Style	Three prong
Environmental	
Operating Temperature Range	-40°C to +125°C

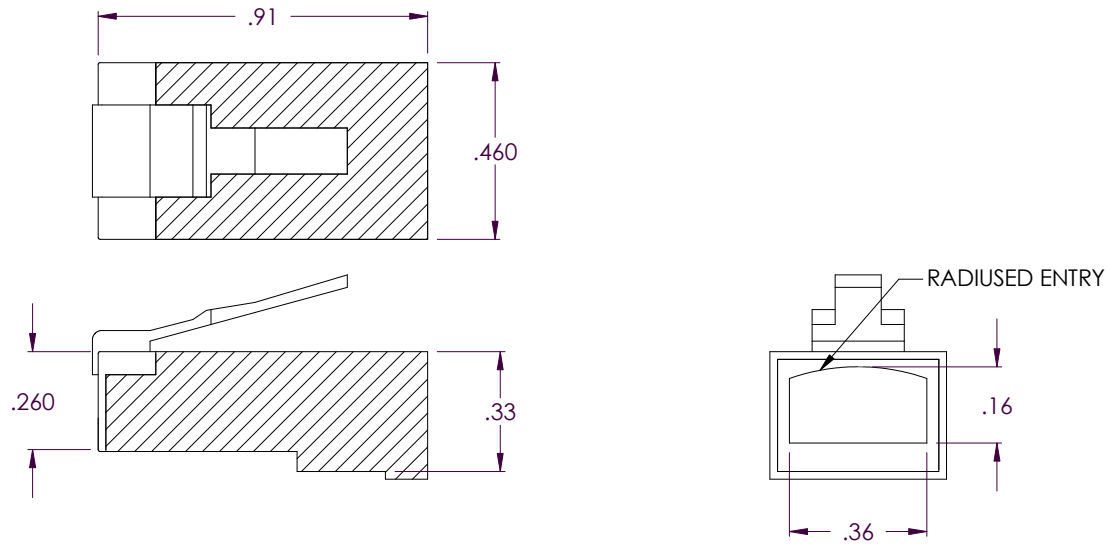
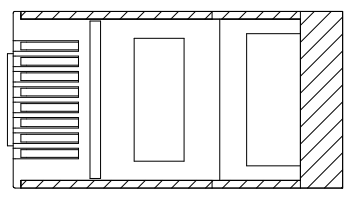

*CONTACTS SHOWN CRIMPED

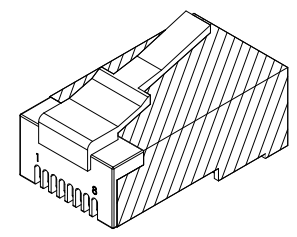

REFERENCE THE FOLLOWING DOCUMENTS
[TERMINATION INSTRUCTIONS LTI-018](#)
[TOOLING INFORMATION LCT-002](#)
[LCT-003 \(PROPRIETARY\)](#)

UNLESS OTHERWISE SPECIFIED, DIMENSIONS ARE IN INCHES. TOLERANCES ARE:
 X ±.1
 XX ±.05
 XXX ±.005
 CABLE LENGTH TOLERANCE
 <300" ±5% >300" ±2%

APPROVALS	DATE
DRAWN BY D. PARHAM	3/25/2002
CHECKED BY T. CLARK	3/26/2002
APPROVED BY C. McCORMICK	3/26/2002

CONFIGURATION DETAILS OF UNDIMENSIONED FEATURES MAY VARY

L-com 45 BEECHWOOD DRIVE
 CONNECTIVITY PRODUCTS NORTH ANDOVER, MA 01845

PRODUCT DESCRIPTION
PLUG, RJ45 8X8 SHIELDED

DRAWING TITLE
OUTLINE DRAWING

SIZE A	FSCM NO. 43321	DWG. NO. T8P8CSR-OD1	REV. F
------------------	--------------------------	--------------------------------	------------------

SCALE: NONE CAD FILE: T8P8CSR-OD1.SLDDRW SHEET 1 OF 1

**8 Position Shielded Modular Plug
(Round Shielded Cable Applications)**

STEP 1

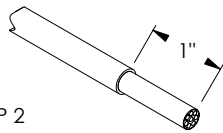

STEP 1. Strip cable jacket 1".

STEP 2

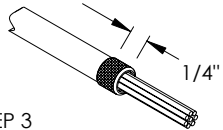

STEP 2. Fold shielding back over jacket. Wrap drain wire around shielding. Trim shielding leaving approximately 1/4" on jacket. (If desired, the drain wire may be soldered to the plug shielding after termination is completed).

STEP 3

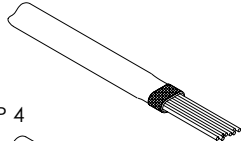

STEP 3. Untwist pairs and arrange conductors into desired order. Do not untwist pairs inside cable jacket.

STEP 4

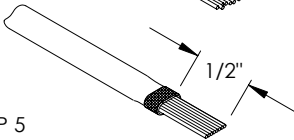

STEP 4. Trim conductors to 1/2" long. All conductors should be the same length.

STEP 5

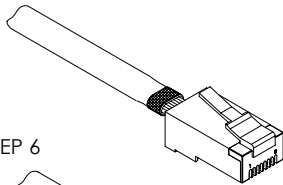

STEP 5. Push the cable into the connector. Be certain the conductors contact the end of the plug. NOTE: The conductors should be visible through the end of the plug.

STEP 6

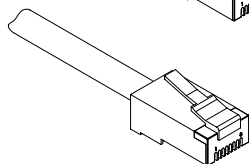

STEP 6. Crimp the contacts and using the proper crimping tool.



Crimp Tool Cross Reference Chart

Use this chart to locate the recommended crimp tool for the modular plug in a Deluxe or Economy model.

PLUG P/N	DELUXE	ECONOMY		PLUG P/N	DELUXE	ECONOMY
TSP3044	HTS7100 w/ HTS7100-04	HT2094C		TD4P4HS	HTS7100 w/ HTS7100-04	HT2094C
TS3044R	HTS7100 w/ HTS7100-04	HT2094C		TD6P4C	HTS7100 w/ HTS7100-06A	HT2096
TSP3046	HTS7100 w/ HTS7100-06A	HT2096		TD6P6C	HTS7100 w/ HTS7100-06A	HT2096
TS3046R	HTS7100 w/ HTS7100-06A	HT2096		TD6P6MMJ	N/A	HT209C
TSP3066	HTS7100 w/ HTS7100-06A	HT2096		TD8P8C	HTS2100 w/ HTS2100-08	HT1500
TSP3066R	HTS7100 w/ HTS7100-06A	HT2096		TDR6P4C	HTS7100 w/ HTS7100-06A	HT2096
TSP3066MMJ	N/A	HT209C		TDR6P6C	HTS7100 w/ HTS7100-06A	HT2096
TSP3088	HTS7100 w/ HTS7100-08A	HT210A		TDR8P8C	HTS7100 w/ HTS7100-08A	N/A
TSP3088K	N/A	HT210A		TDR10P10C	HTS7100 w/ HTS7100-10	N/A
TSP3088R	HTS7100 w/ HTS7100-08A	HT210A		TDS8PC5	HTS2500 OR HTS2600	N/A
TSP3788C5	HTS2100 w/ HTS2100-08	HT1500		T8P8CSR	HTS2100 w/ HTS2100-08	HT210A
TSP3788C5S	N/A	N/A				
TSP3988C6	HTS2100 w/ HTS2100-08	HT1500				
TSP3988C6S	N/A	N/A				