

REV	MODIFICATION	DATE	DRAW
B	EN-10-1023	99.10.28	SAN
C	EN-11-1009	100.10.07	Chris

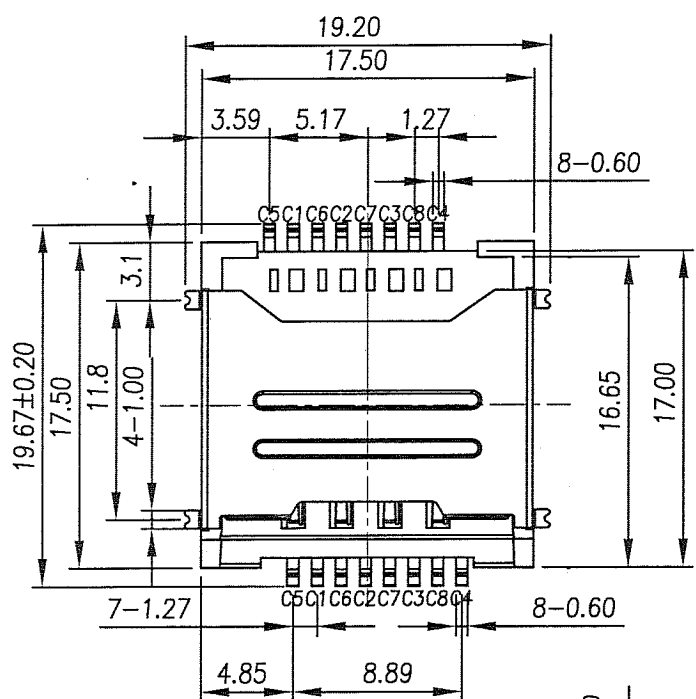

SEE DEAIL A

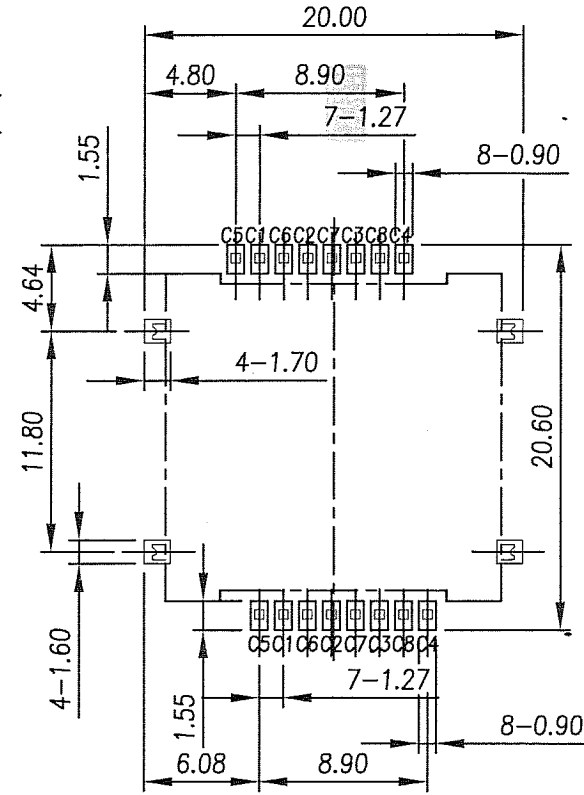
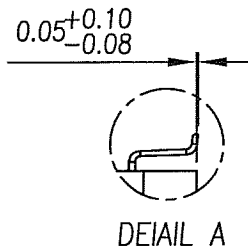
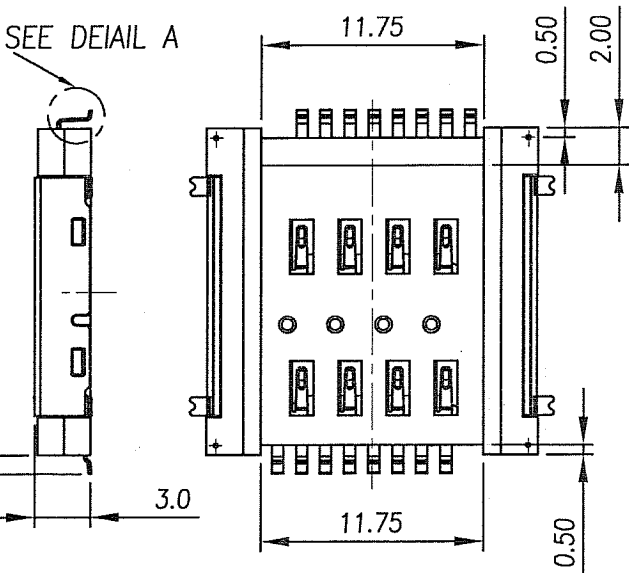

RECOMMENDED PC BOARD LAOUT
TOLERANCE: ±0.05[TOP VIEW]

NOTES:

- General Characteristics
Dimensions: 17.50Lx17.50Wx3.05H mm
Weight: Approx. 0.70g
Contact principle: Friction technology
Operating position: Shaft up/Down/Horizontal
Mounting System: SMT without post
Durability: 5,000 cycles min.
- Material:
Insulation material: Thermoplastic. UL94V-0
- Electrical Characteristics
Number of contacts: 8 pins
Contact resistance: 50 mΩ typical, 100 mΩ max.
Insulation resistance: >1000 megaohms /500 VDC

- Solderability
Wave: Not applicable
Vaporphase: 215°C, 30 sec. MAX.
IR reflow: 230°C, 15sec. MAX.
Manual soldering: 360°C, 3 sec. MAX.
- Environmental Characteristics
Operating temperature: -40°C~+85°C
Operating humidity: 10%~95%RH
Storage temperature: -40°C~+85°C
Storage humidity: 10%~95%RH
Thermal shock: -40°C~+85°C, 5 cycles
Damp Heat: 40°C, 90%RH, 500HR.
Salt-mist: 35°C, 5%, NaCl, 48Hrs.



DIMENSION IN mm [Inch]		PROD. SPEC.
TOLERANCE UNLESS OTHERWISE SPECIFIED		PKG. SPEC.
.X±0.20	X'± 2'	APPROVE Gary
.XX±0.10	X'± 1'	CHECK Gary
.XXX±0.05	XX'± 0.5'	DRAW Chris

C KINGFONT KINGFONT PRECISION INDUSTRIAL CO., LTD.	
TITLE DUAL SIM CARD CONNECTOR	CUSTOMER DRAWING
FILE NO.	DWG NO. SIMMP-20805BT01
SIZE A4	PROJ. SHEET 1 / 1
SCALE 1:1	REV C