

THIS DRAWING IS UNPUBLISHED.

RELEASED FOR PUBLICATION

© COPYRIGHT

ALL RIGHTS RESERVED.

LOC DIST

REVISIONS

P	LTR	DESCRIPTION	DATE	DWN	APVD
		AB6 REVISED PER ECO-11-005140	01APR11	RK	HMR

CIRCUIT IDENTIFICATION

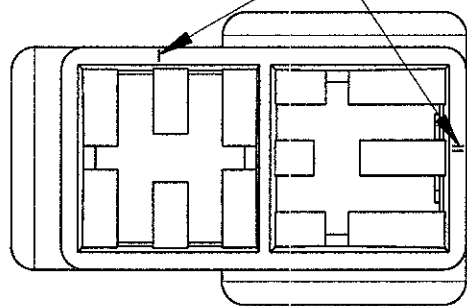

TYPICAL CAVITY FOR FASTIN-FASTON CONN. .250" SR. TAB CTC

SECTION A-A

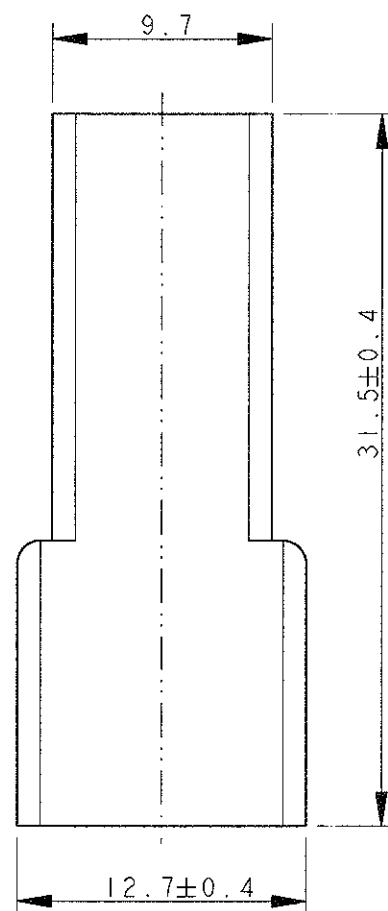
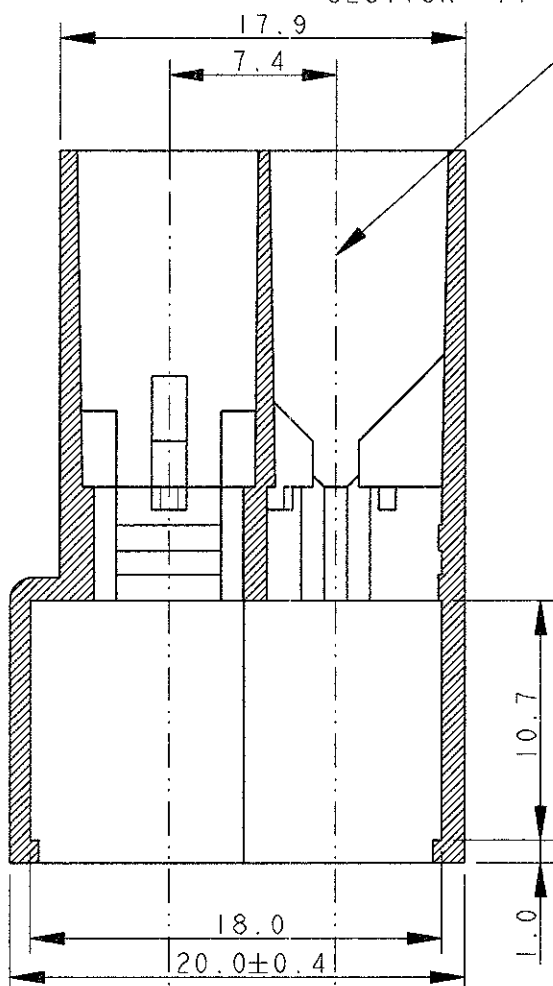

ALTERNATIVE SHAPE : ACCEPTED ONE RETENTION RIB FOR THE TOTAL LENGTH OF THE HSG.

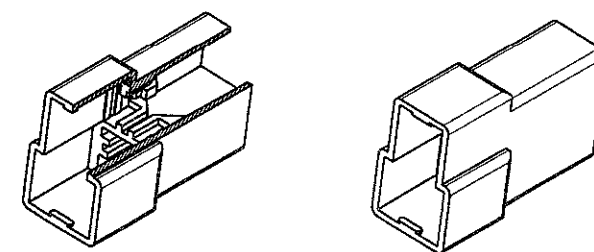

SCALE 1:1

2 OBSOLETE PARTS: OBSOLETE CIS STREAMLINING PER D.RENAUD/D.SINISI

2 OBSOLETE

OBSOLETE

NOTES	COLOUR	MATERIAL	PART NUMBER	REV
	BLACK	POLYAMIDE 6.6	0-180908-5	AB
	YELLOW		0-180908-4	AB
	BLUE		0-180908-3	AB
	GREEN		0-180908-2	AB
	RED		0-180908-1	AB
	NATURAL	NYLON 606 ZYTEL 101L	0-180908-0	AB
UL APPROVED	BLACK		1-180908-5	O
	YELLOW		1-180908-4	AB
	GREEN		1-180908-2	AB
	NATURAL		1-180908-0	AB

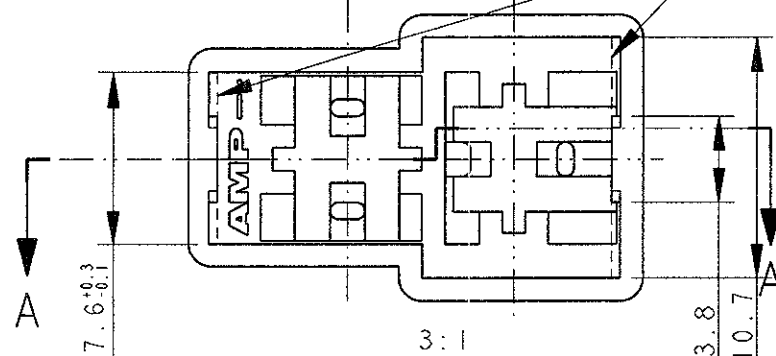

DIMENSIONS: mm		TOLERANCES UNLESS OTHERWISE SPECIFIED: 0 PLC ±. 1 PLC ±0.3 2 PLC ±. 3 PLC ±. 4 PLC ±. ANGLES ±2° FINISH		DWN H. YAALI 08JUL2002 CHK C. TARTARI APVD PRODUCT SPEC 108-20020 APPLICATION SPEC WEIGHT 2.3 g		TE Connectivity	
MATERIAL SEE TABLE		FINISH SEE TABLE		NAME FASTIN-FASTON* Connector, .250" sr. TAB HOUSING 2 WAY		SIZE A3 CAGE CODE 00779 DRAWING NO. C-180908 RESTRICTED TO	
CUSTOMER DRAWING				SCALE 3:1 SHEET 1 OF 1 REV AB6			