

LCD SCREEN VESA INTERFACE PLATE

PARTS LIST

V0208

BT 7507

THIS PACK CONTAINS 1 VESA INTERFACE PLATE.
PLEASE KEEP THIS PARTS LIST FOR FUTURE REFERENCE

BT7507 IS DESIGNED FOR LCD SCREENS WITH VESA MOUNTING PATTERNS OF 200mm x 200mm, 200mm x 100mm, 100mm x 100mm or 75mm x 75mm.

USE WITH:
BT8000, BT8001, BT8002, BT8003, BT8004, BT8016 or BT8017.

Suitable for loads up to 70kg (154lbs)

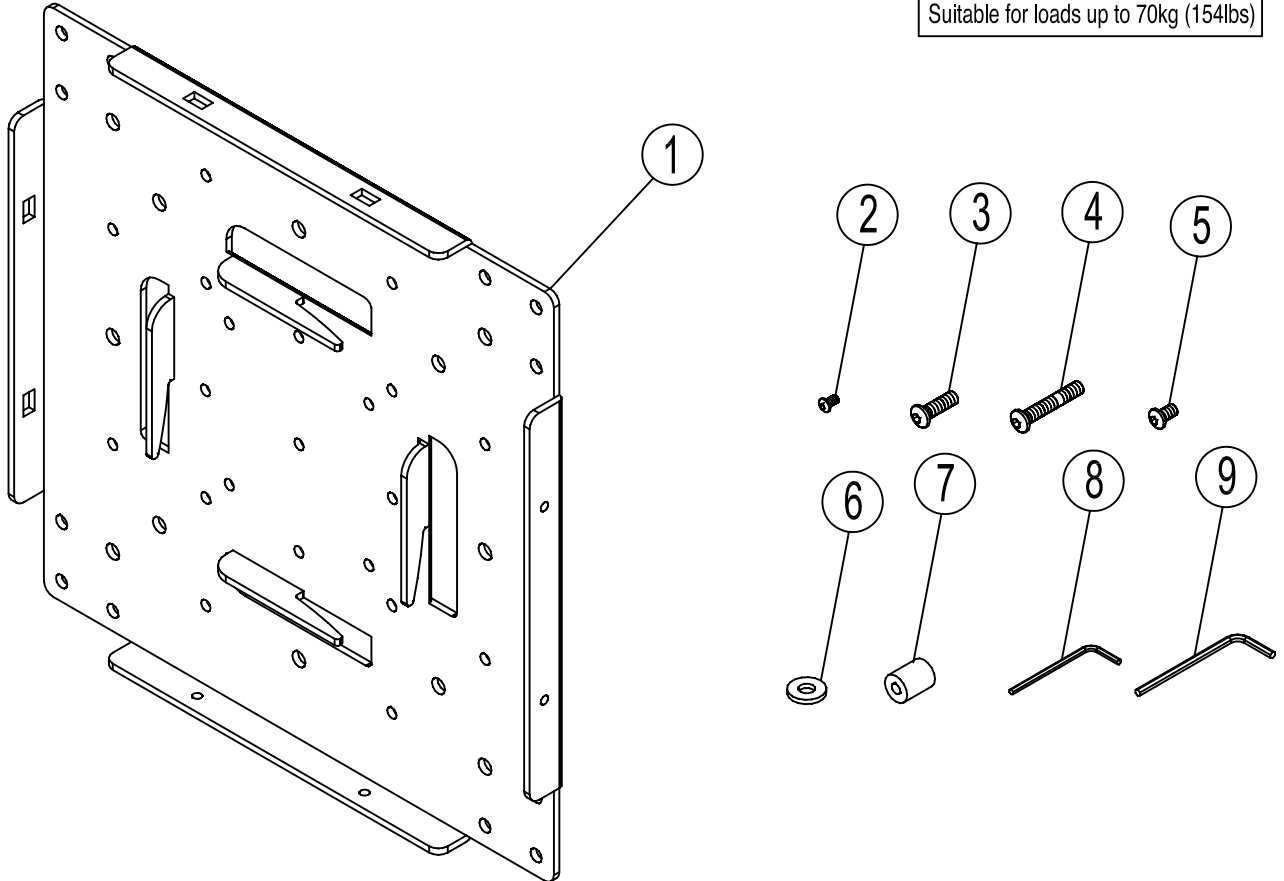

PART NUMBER	PART NAME	QUANTITY
1	VESA INTERFACE PLATE	1
2	M4 x 10mm SCREW - 2.5mm SOCKET	10
3	M4 x 15mm SCREW - 2.5mm SOCKET	6
4	M4 x 25mm SCREW - 2.5mm SOCKET	6
5	M6 x 15mm SCREW	6
6	Ø1/4" Ø16mm T2.0mm WASHER	6
7	Ø4.5mm Ø12mm x 15mm SPACER	6
8	2.5mm ALLEN KEY	1
9	4mm ALLEN KEY	1

(C) 2008 B-Tech International Ltd. All rights reserved. B-Tech and Better by Design are registered trademarks of B-Tech International Ltd. All other brand and product names are trademarks of their respective owners. B-Tech International Ltd. its distributors and dealers are not responsible for damage or injury caused by improper installation, improper use, modifications, installations over the specified weight capacity and/or failure to observe these safety instructions. In such cases, any warranty will expire. It is recommended that this product should only be installed by a qualified professional / installer. B-Tech does not claim any liability for any difficulties that may arise from the interpretation of information contained in these instructions. Failure to mount this product correctly may lead to serious injury and/or death. Please check carefully to make sure there are no missing or defective parts - defective parts must never be used. In the event of missing and/or defective parts, or technical questions, please contact an authorised dealer.

For more information on B-Tech Audio Video Mounts please visit: www.btechavmounts.com