

Peristaltic Pump



General:

The CCL Peristaltic Pump consists of an a.c motor driving a roller guide assembly around a peristaltic tube. The roller guide assembly is made up of two rollers, sprung-loaded to minimise tube wear. These rollers squeeze the liquid out of the peristaltic tube whilst keeping the tube closed at any position of the roller guide assembly, and also provide the valve action to prevent fall-back of the chemical

Assembling The Peristaltic Pump with reference to the exploded diagram:

1. Scrow the cover support (9) to the motor plate (1) using the screws (8) and washers (5)
2. Push the roller guide assembly (2) onto the motor shaft, ensuring that the round centre holes face the motor plate
3. Turn the roller guide assembly (2) until the rollers are in the vertical or six o'clock position as shown.
4. Slide one end of the peristaltic tube connector (7) onto the support cover (9), with the widest part facing down. Please note this part can only be fitted in one direction
5. Loop the peristaltic tube (3) carefully over the centre of the roller guide assembly (2), and slide the other peristaltic tube connector (7) into the hole on the support cover (9)
6. Lift the pump cover (4) over the roller guide assembly (2) and the peristaltic tube (3), taking care not to push the tube off the roller (2a)
7. Tilt the bottom of the pump cover (4) forward. Press the pump cover (4) down onto the roller guide assembly (2) and push the cover (4) back onto the top of the cover support (9) until the parts are locked together
8. Secure the pump cover (4) to the motor plate (1) by using the screws (6) and washers (5)

Replacing The Peristaltic Tube with reference to the exploded diagram:

First remove the pump cover (4) by unscrewing the screws (6) and washers (5). Then pull the top of the pump cover (4) forward until it lifts off

- Notes**
1. When replacing any part of the pump assembly, never lubricate the peristaltic tube (3) or the rollers (2a)
 2. To replace the peristaltic tube (3), lift the pump cover (4) onto the top of the tube (3). Avoid pushing the tube (3) off the roller (2a)
 3. Always ensure that the peristaltic tube (3) is fitted onto the connectors (7) squarely, so that when the tube (3) is carefully fitted around the roller guide assembly (2) the tube does not become twisted
 4. The tube must be fitted tightly onto the connector (7), so avoid wetting the tube (3) to ensure a dry seal
 5. To check the pump action, close the inlet of the pump with your thumb and suction will be felt. If no suction is felt check the peristaltic tube (3) is not twisted, and the roller guide assembly tension
 6. Fit fan supplied if motor is to be ON permanently for periods greater than 15 minutes

Peristaltic Pump

Flow Rate

1.6 mm tube - 1.5 litres per hour
 3.2 mm tube - 5 litres per hour
 4.8 mm tube - 10 litres per hour

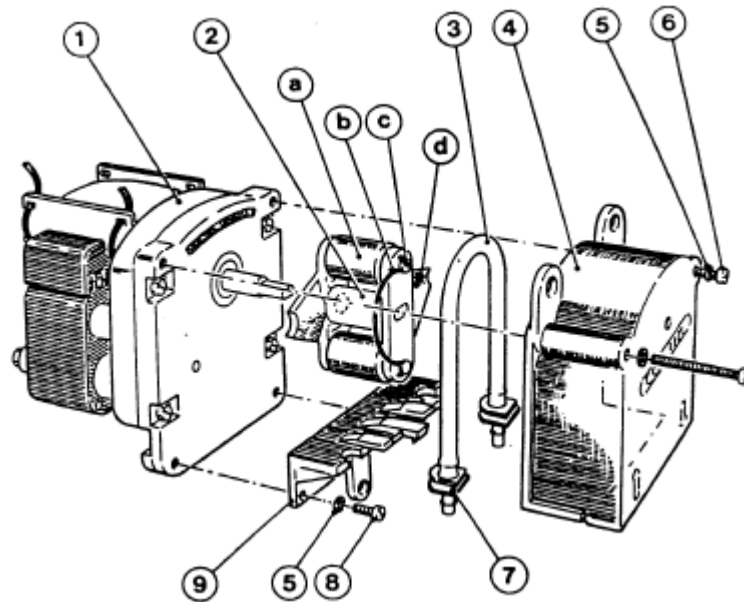

Part List

Order Code	Drawing Reference	Description
PS-DM	1	230 V 50 / 60 Hz motor
PS-RO	2a	Pump roller
PS-SPLD	2b	Pump spring
PS-PIN	2c	Pump roller pin
PS-RG	2d	Pump roller guide
PS-TT1616	3	Pump tube - thermoelectric 1.6 mm bore
PS-TT3216	3	Pump tube - thermoelectric 3.2 mm bore
PS-TT4816	3	Pump tube - thermoelectric 4.8 mm bore
PS-PCCS	4 + 9	Pump cover and support
SC-M4W	5	M4 shakeproof washer / 100
SC-M445	6	M4 × 45 cheesehead screw / 50
PS-TC16	7	Pump tube connector 1.6 mm
PS-TC32	7	Pump tube connector 3.2 mm
PS-TC48	7	Pump tube connector 4.8 mm
SC-M48	8	M4 × 8 Cheese head screw / 100

Additional Data : Pump inlet and outlet connectors suitable for 8 × 5 mm tubing

Part Number Table

Description	Part Number
Peristaltic Pump	PUMP 9L

Important Notice : This data sheet and its contents (the "Information") belong to the members of the Premier Farnell group of companies (the "Group") or are licensed to it. No licence is granted for the use of it other than for information purposes in connection with the products to which it relates. No licence of any intellectual property rights is granted. The Information is subject to change without notice and replaces all data sheets previously supplied. The Information supplied is believed to be accurate but the Group assumes no responsibility for its accuracy or completeness, any error in or omission from it or for any use made of it. Users of this data sheet should check for themselves the Information and the suitability of the products for their purpose and not make any assumptions based on information included or omitted. Liability for loss or damage resulting from any reliance on the Information or use of it (including liability resulting from negligence or where the Group was aware of the possibility of such loss or damage arising) is excluded. This will not operate to limit or restrict the Group's liability for death or personal injury resulting from its negligence. Multicomp is the registered trademark of the Group. © Premier Farnell plc 2012.