

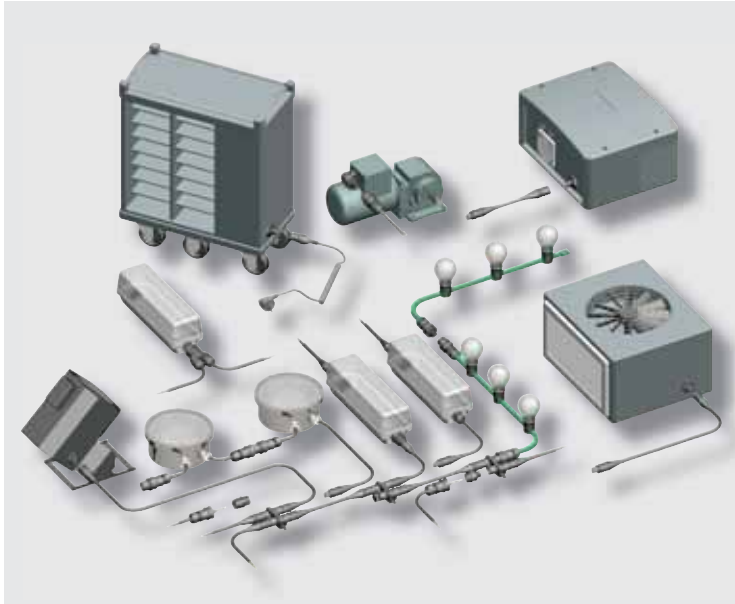

2 variations for connecting electrical drives or for laying AS-i and 24V auxiliary voltage

Application example



General

The four pole connector is based on the 5 pole variation with one pole left empty.

Two codings are available: a black coding for connecting electrical drives, and a brown coding for laying AS-Interface and the 24V auxiliary voltage together.

They are mechanically coded. This means that only associated pairs of male and female can be connected with the correct polarity. This ensures a clear separation from the connectors of the other product series.

Coding

					Application		
					Power 250/400V	AS-i / 24V	
					Mechanical coding		
					1, 2, 3, ground	1, 2, 3, 4	
Name	Description	Connection style	Strain relief housing	Connection points per pole	gray	black	brown
Connectors	1 x cable entry	Screw Crimp	yes	1			
	2 x cable entry	Screw	yes	1			
Distribution units	RST compact distribution unit/multi-distribution unit				available on request	available on request	available on request
	Individual distribution box				available on request	available on request	available on request
Device connectors	M16 device connector, modular, straight						
	M16 device connector, modular, angled 7°						
	M25 device connector, standard						
	M20 device connector, standard						
	M20 device connector, modular, angled						
Cable assemblies	Connection cable Male – Free end						
	Connection cable Female – Free end	pre-assembled	pre-assembled	pre-assembled			
	Extension cable Male – Female						

Connector for cables of Ø 6 – 10 mm and 10 – 14 mm

Female connector

Unmounted with cable gland.

Crimp contacts separately available under Accessories.

See Technical Data for sheath and insulation strip lengths.

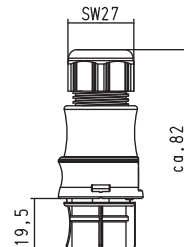

Application	Coding	Cable diameter in mm	Color	Part No.	Part No.
				with screw connection¹⁾	with crimp connection (see Accessories)
				Wire	Wire
				rigid	rigid
				fine-stranded	fine-stranded
				stranded	stranded
				mm ²	mm ²
				0.75 – 4.0	0.75 – 4.0
Power 250 V	1, 2, 3, gr.	6 – 10	gray black	96.041.4053.0 96.041.4053.1	96.141.4053.0 96.141.4053.1
		10 – 14	gray black	96.041.4153.0 96.041.4153.1	96.141.4153.0 96.141.4153.1
AS-i / 24 V	1, 2, 3, 4	6 – 10	brown	96.041.4051.4 96.041.4951.4 96.041.4851.4	96.141.4051.4 96.141.4951.4 96.141.4851.4
		1 x AS-i profile cable 2 x AS-i profile cable			

Male connector

Unmounted with cable gland and with locking device.

Crimp contacts separately available under Accessories.

See Technical Data for sheath and insulation strip lengths.

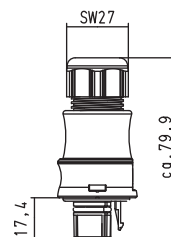
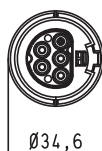

Application	Coding	Cable diameter in mm	Color	Part No.	Part No.
				with screw connection¹⁾	with crimp connection (see Accessories)
				Wire	Wire
				rigid	rigid
				fine-stranded	fine-stranded
				stranded	stranded
				mm ²	mm ²
				0.75 – 4.0	0.75 – 4.0
Power 250 V	1, 2, 3, gr.	6 – 10	gray black	96.042.4053.0 96.042.4053.1	96.142.4053.0 96.142.4053.1
		10 – 14	gray black	96.042.4153.0 96.042.4153.1	96.142.4153.0 96.142.4153.1
AS-i / 24 V	1, 2, 3, 4	6 – 10	brown	96.042.4051.4 96.042.4951.4 96.042.4851.4	96.142.4051.4 96.142.4951.4 96.142.4851.4
		1 x AS-i profile cable 2 x AS-i profile cable			

Connector, angled for cables of Ø 6 – 10 mm and 10 – 14 mm

Female connector

Unmounted with cable gland.
90° angle.

Crimp contacts separately available under Accessories.

See Technical Data for sheath and insulation strip lengths.

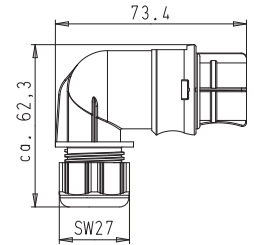
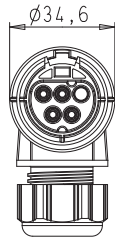

Application	Coding	Cable diameter in mm	Color	Part No.	Part No.
				with screw connection¹⁾	with crimp connection (see Accessories)
				Wire	Wire
				rigid	rigid
				fine-stranded	fine-stranded
				stranded	stranded
				mm ²	mm ²
				0.75 – 4.0	0.75 – 4.0
Power 250 V	1, 2, 3, gr.	6 – 10	gray black	96.043.4053.0 96.043.4053.1	96.143.4053.0 96.143.4053.1
		10 – 14	gray black	96.043.4153.0 96.043.4153.1	96.143.4153.0 96.143.4153.1
AS-i / 24 V	1, 2, 3, 4	6 – 10	brown	96.043.4051.4 96.043.4951.4 96.043.4851.4	96.143.4051.4 96.143.4951.4 96.143.4851.4
		1 x AS-i profile cable 2 x AS-i profile cable			

Male connector

Unmounted with cable gland and with locking device.

Crimp contacts separately available under Accessories.

See Technical Data for sheath and insulation strip lengths.

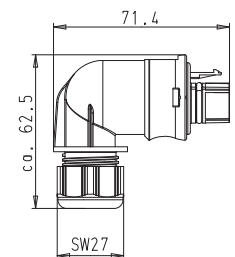

Application	Coding	Cable diameter in mm	Color	Part No.	Part No.
				with screw connection¹⁾	with crimp connection (see Accessories)
				Wire	Wire
				rigid	rigid
				fine-stranded	fine-stranded
				stranded	stranded
				mm ²	mm ²
				0.75 – 4.0	0.75 – 4.0
Power 250 V	1, 2, 3, gr.	6 – 10	gray black	96.044.4053.0 96.044.4053.1	96.144.4053.0 96.144.4053.1
		10 – 14	gray black	96.044.4153.0 96.044.4153.1	96.144.4153.0 96.144.4153.1
AS-i / 24 V	1, 2, 3, 4	6 – 10	brown	96.044.4051.4 96.044.4951.4 96.044.4851.4	96.144.4051.4 96.144.4951.4 96.144.4851.4
		1 x AS-i profile cable 2 x AS-i profile cable			

¹⁾ With wire protection available on request

Connector for cables of Ø 13 – 18 mm

Female connector

Unmounted with cable gland.

Crimp contacts separately available under Accessories.

See Technical Data for sheath and insulation strip lengths.

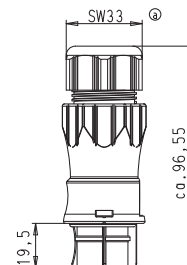

Application	Coding	Cable diameter in mm	Color	Part No.																				
				<table border="1"> <thead> <tr> <th colspan="2">with screw connection¹⁾</th> <th colspan="2">with crimp connection (see Accessories)</th> </tr> <tr> <th>Wire</th> <th>mm²</th> <th>Wire</th> <th>mm²</th> </tr> </thead> <tbody> <tr> <td>rigid</td> <td></td> <td>rigid</td> <td></td> </tr> <tr> <td>fine-stranded</td> <td>up to 4.0</td> <td>fine-stranded</td> <td>0.75 – 4.0</td> </tr> <tr> <td>stranded</td> <td></td> <td>stranded</td> <td></td> </tr> </tbody> </table>	with screw connection ¹⁾		with crimp connection (see Accessories)		Wire	mm ²	Wire	mm ²	rigid		rigid		fine-stranded	up to 4.0	fine-stranded	0.75 – 4.0	stranded		stranded	
with screw connection ¹⁾		with crimp connection (see Accessories)																						
Wire	mm ²	Wire	mm ²																					
rigid		rigid																						
fine-stranded	up to 4.0	fine-stranded	0.75 – 4.0																					
stranded		stranded																						
Power 250V	1, 2, 3, gr.	13 – 18	gray black	<table border="1"> <tbody> <tr> <td>96.041.4553.0</td> <td>96.041.4553.1</td> <td>96.141.4553.0</td> <td>96.141.4553.1</td> </tr> </tbody> </table>	96.041.4553.0	96.041.4553.1	96.141.4553.0	96.141.4553.1																
96.041.4553.0	96.041.4553.1	96.141.4553.0	96.141.4553.1																					

Male connector

Unmounted with cable gland and with locking device.

Crimp contacts separately available under Accessories.

See Technical Data for sheath and insulation strip lengths.

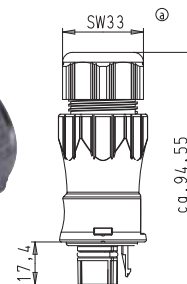

Application	Coding	Cable diameter in mm	Color	Part No.																				
				<table border="1"> <thead> <tr> <th colspan="2">with screw connection¹⁾</th> <th colspan="2">with crimp connection (see Accessories)</th> </tr> <tr> <th>Wire</th> <th>mm²</th> <th>Wire</th> <th>mm²</th> </tr> </thead> <tbody> <tr> <td>rigid</td> <td></td> <td>rigid</td> <td></td> </tr> <tr> <td>fine-stranded</td> <td>0.75 – 4.0</td> <td>fine-stranded</td> <td>0.75 – 4.0</td> </tr> <tr> <td>stranded</td> <td></td> <td>stranded</td> <td></td> </tr> </tbody> </table>	with screw connection ¹⁾		with crimp connection (see Accessories)		Wire	mm ²	Wire	mm ²	rigid		rigid		fine-stranded	0.75 – 4.0	fine-stranded	0.75 – 4.0	stranded		stranded	
with screw connection ¹⁾		with crimp connection (see Accessories)																						
Wire	mm ²	Wire	mm ²																					
rigid		rigid																						
fine-stranded	0.75 – 4.0	fine-stranded	0.75 – 4.0																					
stranded		stranded																						
Power 250V	1, 2, 3, gr.	13 – 18	gray black	<table border="1"> <tbody> <tr> <td>96.042.4553.0</td> <td>96.042.4553.1</td> <td>96.142.4553.0</td> <td>96.142.4553.1</td> </tr> </tbody> </table>	96.042.4553.0	96.042.4553.1	96.142.4553.0	96.142.4553.1																
96.042.4553.0	96.042.4553.1	96.142.4553.0	96.142.4553.1																					

Splitter connector

Female connector

Unmounted with cable gland.

See the Technical Data for insulation strip lengths as well as the ferrules to be used.

See the Accessories for mounting plates used to fasten the splitter connectors.

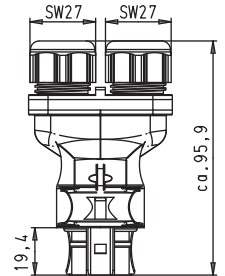
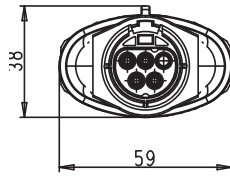

Application	Coding	Cable diameter in mm	Color	Part No.
with screw connection¹⁾				
				Wire mm ²
				rigid
				fine-stranded 0.75 – 1.5
				stranded
Power 250V	 1, 2, 3, gr.	13 – 18	gray black	96.041.4253.0 96.041.4253.1
		10 – 14	gray black	96.041.4353.0 96.041.4353.1
		13 – 18	gray black	

¹⁾ With wire protection available on request

M 25 device connector, standard

Female connector

Correct positioning guaranteed due to flattened thread. Fastening with screws from outside.

Crimp contacts separately available under Accessories.

See the Technical Data for insulation strip lengths.

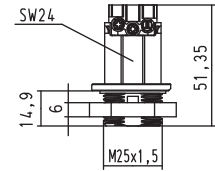
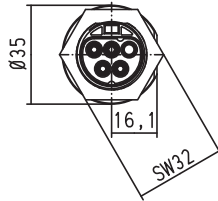

Application Coding Color

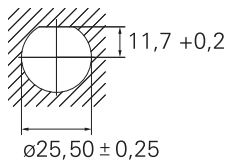

Power 250/400V		1, 2, 3, gr.	gray black
AS-i / 24V		1, 2, 3, 4	brown

Part No.

with screw connection

Wire	mm ²
rigid	
fine-stranded	0.75 – 4.0
stranded	
Term. poles	1
Thread	M25 x 1.5
Gland	outside

96.041.5053.0
96.041.5053.1
96.041.5051.4

Part No.

with crimp connection (see Accessories)

Wire	mm ²
rigid	
fine-stranded	0.75 – 4.0
stranded	
Term. poles	1
Thread	M25 x 1.5
Gland	outside

96.141.1053.0
96.141.1053.1

Male connector

Correct positioning guaranteed due to flattened thread. Fastening with screws from outside. With locking device.

Crimp contacts separately available under Accessories.

See the Technical Data for insulation strip lengths.

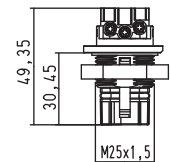
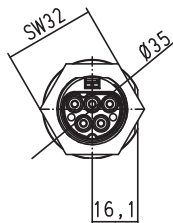

Application Coding Color

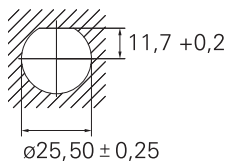

Power 250/400V		1, 2, 3, gr.	gray black
AS-i / 24V		1, 2, 3, 4	brown

Part No.

with screw connection

Wire	mm ²
rigid	
fine-stranded	0.75 – 4.0
stranded	
Term. poles	1
Thread	M25 x 1.5
Gland	outside

96.042.5053.0
96.042.5053.1
96.042.5051.4

Part No.

with crimp connection (see Accessories)

Wire	mm ²
rigid	
fine-stranded	0.75 – 4.0
stranded	
Term. poles	1
Thread	M25 x 1.5
Gland	outside

96.142.1053.0
96.142.1053.1

M 20 device connector, modular, straight

Female connector

Correct positioning guaranteed due to flattened thread. Fastening with screws from inside.

Crimp contacts separately available under Accessories.

See the Technical Data for insulation strip lengths.

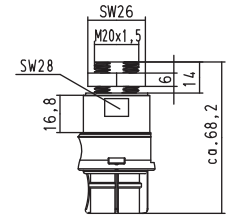

Application Coding Color

Part No.

Part No.

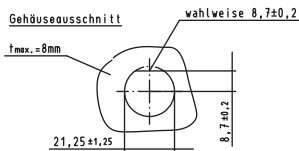

Power 250/400V		1, 2, 3, gr.	gray black
AS-i / 24V		1, 2, 3, 4	brown

with screw connection

Wire	mm ²
rigid	
fine-stranded	0.75 – 4.0
stranded	
Term. poles	1
Thread	M20 x 1.5
Gland	inside

96.041.6053.0
96.041.6053.1
96.041.6051.4

with crimp connection (see Accessories)

Wire	mm ²
rigid	
fine-stranded	0.75 – 4.0
stranded	
Term. poles	1
Thread	M20 x 1.5
Gland	inside

96.141.2053.0
96.141.2053.1

Male connector

Correct positioning guaranteed due to flattened thread. Fastening with screws from inside.
With locking device.

Crimp contacts separately available under Accessories.

See the Technical Data for insulation strip lengths.

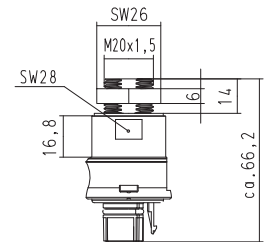

Application Coding Color

Part No.

Part No.

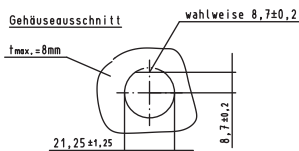

Power 250/400V		1, 2, 3, gr.	gray black
AS-i / 24V		1, 2, 3, 4	brown

with screw connection

Wire	mm ²
rigid	
fine-stranded	0.75 – 4.0
stranded	
Term. poles	1
Thread	M20 x 1.5
Gland	inside

96.042.6053.0
96.042.6053.1
96.042.6051.4

with crimp connection (see Accessories)

Wire	mm ²
rigid	
fine-stranded	0.75 – 4.0
stranded	
Term. poles	1
Thread	M20 x 1.5
Gland	inside

96.142.2053.0
96.142.2053.1

M 16 device connector, modular, straight

Female connector

Correct positioning guaranteed due to flattened thread. Fastening with screws from inside.

Crimp contacts separately available under Accessories.

See the Technical Data for insulation strip lengths.

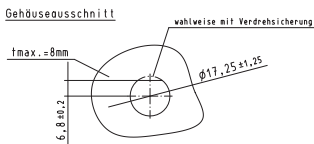
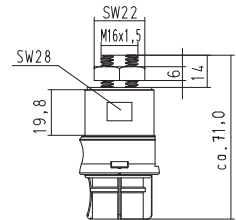

Power 250/400V		1, 2, 3, gr.	gray black
AS-i / 24V		1, 2, 3, 4	brown

Application Coding Color Part No.

with screw connection

Wire	mm ²
rigid	
fine-stranded	0.75 – 4.0
stranded	
Term. poles	1
Thread	M16 x 1.5
Gland	inside

96.041.6153.0
96.041.6153.1
96.041.6151.4

Part No.

with crimp connection (see Accessories)

Wire	mm ²
rigid	
fine-stranded	0.75 – 4.0
stranded	
Term. poles	1
Thread	M16 x 1.5
Gland	inside

96.141.2153.0
96.141.2153.1

Male connector

Correct positioning guaranteed due to flattened thread. Fastening with screws from inside. With locking device.

Crimp contacts separately available under Accessories.

See the Technical Data for insulation strip lengths.

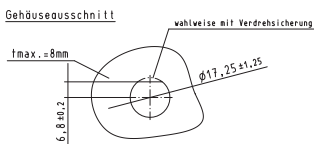
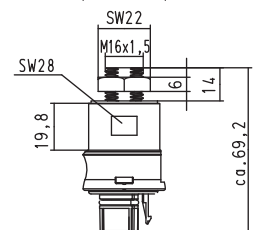

Power 250/400V		1, 2, 3, Gr.	gray black
AS-i / 24V		1, 2, 3, 4	brown

Application Coding Color Part No.

with screw connection

Wire	mm ²
rigid	
fine-stranded	0.75 – 4.0
stranded	
Term. poles	1
Thread	M16 x 1.5
Gland	inside

96.042.6153.0
96.042.6153.1
96.042.6151.4

Part No.

with crimp connection (see Accessories)

Wire	mm ²
rigid	
fine-stranded	0.75 – 4.0
stranded	
Term. poles	1
Thread	M16 x 1.5
Gland	inside

96.142.2153.0
96.142.2153.1

M 16 device connector, modular, 7° angle

Female connector

Correct positioning guaranteed due to flattened thread. Fastening with screws from inside. 7° angle, M16 thread.

Crimp contacts separately available under Accessories.

See the Technical Data for insulation strip lengths.

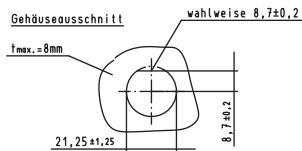
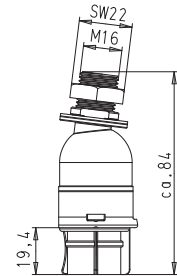

Power		1, 2	gray black
250/400V		3, gr.	
AS-i / 24V		1, 2	brown
		3, 4	

with screw connection		Part No.
Wire	mm ²	
rigid		
fine-stranded	0.75 – 4.0	
stranded		
Term. poles	1	
Thread	M16 x 1.5	
Gland	inside	

96.045.6153.0	
96.045.6153.1	
96.045.6151.4	

with crimp connection (see Accessories)		Part No.
Wire	mm ²	
rigid		
fine-stranded	0.75 – 4.0	
stranded		
Term. poles	1	
Thread	M16 x 1.5	
Gland	inside	

96.145.2153.0	
96.145.2153.1	

Male connector

Correct positioning guaranteed due to flattened thread. Fastening with screws from inside. 7° angle, M16 thread.

With locking device.

Crimp contacts separately available under Accessories.

See the Technical Data for insulation strip lengths.

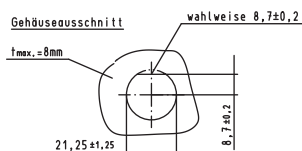
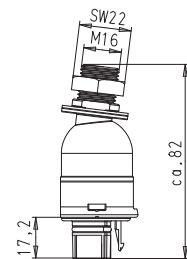

Power		1, 2	gray black
250/400V		3, gr.	
AS-i / 24V		1, 2	brown
		3, 4	

with screw connection		Part No.
Wire	mm ²	
rigid		
fine-stranded	0.75 – 4.0	
stranded		
Term. poles	1	
Thread	M16 x 1.5	
Gland	inside	

96.046.6153.0	
96.046.6153.1	
96.046.6151.4	

with crimp connection (see Accessories)		Part No.
Wire	mm ²	
rigid		
fine-stranded	0.75 – 4.0	
stranded		
Term. poles	1	
Thread	M16 x 1.5	
Gland	inside	

96.146.2153.0	
96.146.2153.1	

M 20 device connector, modular, angled

Female connector

Correct positioning guaranteed due to flattened thread. Fastening with screws from inside. 90° angle, M20 thread.

Crimp contacts separately available under Accessories.

See the Technical Data for insulation strip lengths.

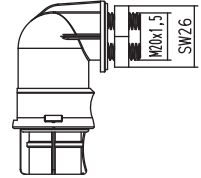
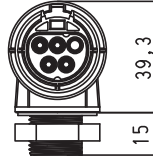

Application Coding Color

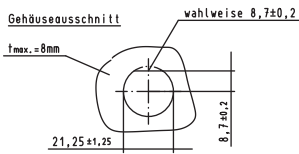

Power 250/400V		1, 2, 3, gr.	gray black
AS-i / 24V		1, 2, 3, 4	brown

Part No.

with screw connection

Wire	mm ²
rigid	
fine-stranded	0.75 – 4.0
stranded	
Term. poles	1
Thread	M20 x 1.5
Gland	inside

96.043.6053.0
96.043.6053.1
96.043.6051.4

Part No.

with crimp connection (see Accessories)

Wire	mm ²
rigid	
fine-stranded	0.75 – 4.0
stranded	
Term. poles	1
Thread	M20 x 1.5
Gland	inside

96.143.2053.0
96.143.2053.1

Male connector

Correct positioning guaranteed due to flattened thread. Fastening with screws from inside. 90° angle, M20 thread. With locking device.

Crimp contacts separately available under Accessories.

See the Technical Data for insulation strip lengths.

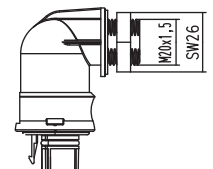
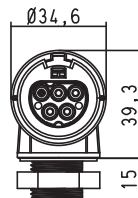

Application Coding Color

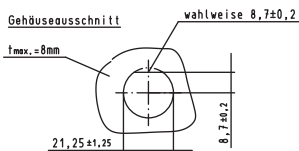

Power 250/400V		1, 2, 3, gr.	gray black
AS-i / 24V		1, 2, 3, 4	brown

Part No.

with screw connection

Wire	mm ²
rigid	
fine-stranded	0.75 – 4.0
stranded	
Term. poles	1
Thread	M20 x 1.5
Gland	inside

96.044.6053.0
96.044.6053.1
96.044.6051.4

Part No.

with crimp connection (see Accessories)

Wire	mm ²
rigid	
fine-stranded	0.75 – 4.0
stranded	
Term. poles	1
Thread	M20 x 1.5
Gland	inside

96.144.2053.0
96.144.2053.1

M 25 device connector, modular, angled

Female connector

Correct positioning guaranteed due to flattened thread. Fastening with screws from inside. 90° angle, M25 thread.

Crimp contacts separately available under Accessories.

See the Technical Data for insulation strip lengths.

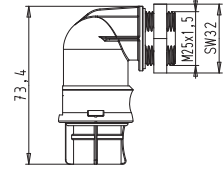
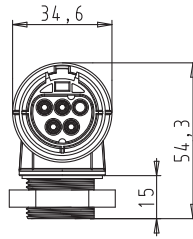

Application Coding Color

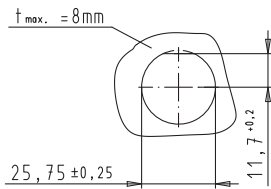

Power 250/400V		1, 2, 3, gr.	gray black
AS-i / 24V		1, 2, 3, 4	brown

Part No.

with screw connection	
Wire	mm ²
rigid	
fine-stranded	0.75 – 4.0
stranded	
Term. poles	1
Thread	M25 x 1.5
Gland	inside

96.043.6253.0
96.043.6253.1
96.043.6251.4

Part No.

with crimp connection (see Accessories)	
Wire	mm ²
rigid	
fine-stranded	0.75 – 4.0
stranded	
Term. poles	1
Thread	M25 x 1.5
Gland	inside

96.143.2253.0
96.143.2253.1

Male connector

Correct positioning guaranteed due to flattened thread. Fastening with screws from inside. 90° angle, M25 thread.

With locking device

Crimp contacts separately available under Accessories.

See the Technical Data for insulation strip lengths.

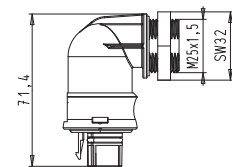
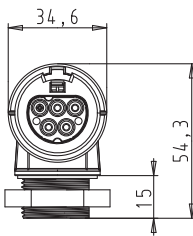

Application Coding Color

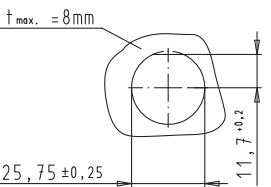

Power 250/400V		1, 2, 3, gr.	gray black
AS-i / 24V		1, 2, 3, 4	brown

Part No.

with screw connection	
Wire	mm ²
rigid	
fine-stranded	0.75 – 4.0
stranded	
Term. poles	1
Thread	M25 x 1.5
Gland	inside

96.044.6253.0
96.044.6253.1
96.044.6251.4

Part No.

with crimp connection (see Accessories)	
Wire	mm ²
rigid	
fine-stranded	0.75 – 4.0
stranded	
Term. poles	1
Thread	M25 x 1.5
Gland	inside

96.144.2253.0
96.144.2253.1

Cable assemblies 1.5 mm²

**H05VV-F
4G1.5**



Ground= GN/YE
3 = BU
1 = BN
2 = BK

Cable: black
Connector in black

Screw technology

Application	Length ²⁾ m	Part No.	Part No.	Part No.
Power	1.0	96.442.1000.1	96.442.1003.1	96.442.1004.1
250/400V	2.0	96.442.2000.1	96.442.2003.1	96.442.2004.1
1, 2, 3,	3.0	96.442.3000.1	96.442.3003.1	96.442.3004.1
ground	4.0	96.442.4000.1	96.442.4003.1	96.442.4004.1
	5.0	96.442.5000.1	96.442.5003.1	96.442.5004.1
	6.0	96.442.6000.1	96.442.6003.1	96.442.6004.1
	7.0	96.442.7000.1	96.442.7003.1	96.442.7004.1
	8.0	96.442.8000.1	96.442.8003.1	96.442.8004.1

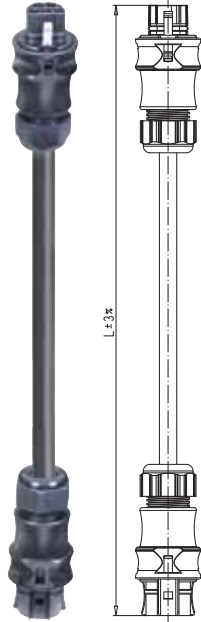

Female – Male
Extension cable
Locking device yes

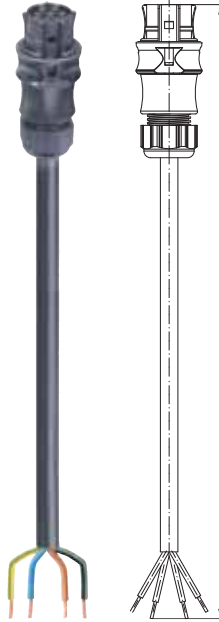

Female – Free end
Connection cable
Wire ends ultrason. welded
Sheath strip length 35 mm
Insul. strip length 9 mm

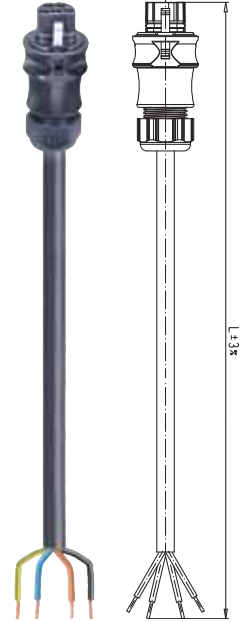

Male – Free end
Connection cable
Wire ends ultrason. welded
Sheath strip length 35 mm
Insul. strip length 9 mm
Locking device yes

¹⁾ Other cables available on request
²⁾ Other lengths available on request

Cable assemblies 1.5 mm²

H07RN-F 4G1.5				
<p>Ground= GN/YE 3 = BU 1 = BN 2 = BK</p>				
		Female – Male Extension cable Locking device yes	Female – Free end Connection cable Wire ends ultrason. welded Sheath strip length 35 mm Insul. strip length 9 mm	Male – Free end Connection cable Wire ends ultrason. welded Sheath strip length 35 mm Insul. strip length 9 mm Locking device yes
Cable: black Connector in black Screw technology				
Application	Length ²⁾ m	Part No.	Part No.	Part No.
Power	1.0	96.442.1030.1	96.442.1033.1	96.442.1034.1
250/400V	2.0	96.442.2030.1	96.442.2033.1	96.442.2034.1
1, 2, 3,	3.0	96.442.3030.1	96.442.3033.1	96.442.3034.1
ground	4.0	96.442.4030.1	96.442.4033.1	96.442.4034.1
	5.0	96.442.5030.1	96.442.5033.1	96.442.5034.1
	6.0	96.442.6030.1	96.442.6033.1	96.442.6034.1
	7.0	96.442.7030.1	96.442.7033.1	96.442.7034.1
	8.0	96.442.8030.1	96.442.8033.1	96.442.8034.1

¹⁾ Other cables available on request
²⁾ Other lengths available on request

Cable assemblies 2.5 mm²

**H05VV-F
4G2.5**



Ground = GN/YE
3 = BU
1 = BN
2 = BK

Cable: black
Connector in
black

Screw technology

Application	Length ²⁾ m	Part No.	Part No.	Part No.
Power	1.0	96.443.1000.1	96.443.1003.1	96.443.1004.1
250/400V	2.0	96.443.2000.1	96.443.2003.1	96.443.2004.1
1, 2, 3,	3.0	96.443.3000.1	96.443.3003.1	96.443.3004.1
ground	4.0	96.443.4000.1	96.443.4003.1	96.443.4004.1
	5.0	96.443.5000.1	96.443.5003.1	96.443.5004.1
	6.0	96.443.6000.1	96.443.6003.1	96.443.6004.1
	7.0	96.443.7000.1	96.443.7003.1	96.443.7004.1
	8.0	96.443.8000.1	96.443.8003.1	96.443.8004.1

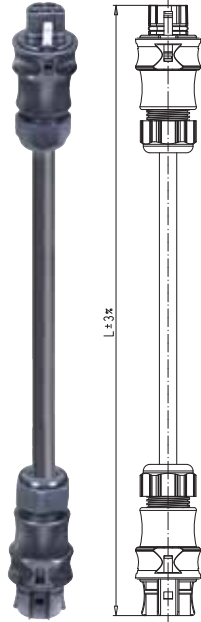

Female – Male
Extension cable
Locking device yes

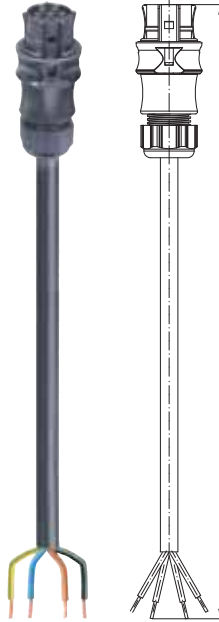

Female – Free end
Connection cable
Wire ends ultrason. welded
Sheath strip length 35 mm
Insul. strip length 9 mm

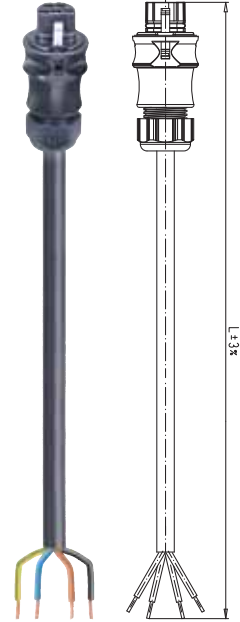

Male – Free end
Connection cable
Wire ends ultrason. welded
Sheath strip length 35 mm
Insul. strip length 9 mm
Locking device yes

¹⁾ Other cables available on request
²⁾ Other lengths available on request

Cable assemblies 2.5 mm²

H07RN-F 4G2.5				
 <p>Ground = GN/YE 3 = BU 1 = BN 2 = BK</p>				
		Female – Male Extension cable Locking device yes	Female – Free end Connection cable Wire ends ultrason. welded Sheath strip length 35 mm Insul. strip length 9 mm	Male – Free end Connection cable Wire ends ultrason. welded Sheath strip length 35 mm Insul. strip length 9 mm Locking device yes
Cable: black Connector in black Screw technology				
Application	Length ²⁾ m	Part No.	Part No.	Part No.
Power	1.0	96.443.1030.1	96.443.1033.1	96.443.1034.1
250/400V	2.0	96.443.2030.1	96.443.2033.1	96.443.2034.1
1, 2, 3,	3.0	96.443.3030.1	96.443.3033.1	96.443.3034.1
ground	4.0	96.443.4030.1	96.443.4033.1	96.443.4034.1
	5.0	96.443.5030.1	96.443.5033.1	96.443.5034.1
	6.0	96.443.6030.1	96.443.6033.1	96.443.6034.1
	7.0	96.443.7030.1	96.443.7033.1	96.443.7034.1
	8.0	96.443.8030.1	96.443.8033.1	96.443.8034.1



¹⁾ Other cables available on request
²⁾ Other lengths available on request

Cable assemblies 1.5 mm², power 4 pole

Ölflex Classic 110 4G1.5																																															
																																															
Ground = GN/YE 3 = BK 1 = BK 2 = BK																																															
Cable ¹⁾ : black Connector in black																																															
Screw technology																																															
<table border="1"> <thead> <tr> <th>Application</th> <th>Length²⁾ m</th> <th>Part No.</th> </tr> </thead> <tbody> <tr><td>Power</td><td>1.0</td><td>96.442.1080.1</td></tr> <tr><td>250/400V</td><td>2.0</td><td>96.442.2080.1</td></tr> <tr><td>1, 2, 3,</td><td>3.0</td><td>96.442.3080.1</td></tr> <tr><td>ground</td><td>4.0</td><td>96.442.4080.1</td></tr> <tr><td></td><td>5.0</td><td>96.442.5080.1</td></tr> <tr><td></td><td>6.0</td><td>96.442.6080.1</td></tr> <tr><td></td><td>7.0</td><td>96.442.7080.1</td></tr> <tr><td></td><td>8.0</td><td>96.442.8080.1</td></tr> </tbody> </table>	Application	Length ²⁾ m	Part No.	Power	1.0	96.442.1080.1	250/400V	2.0	96.442.2080.1	1, 2, 3,	3.0	96.442.3080.1	ground	4.0	96.442.4080.1		5.0	96.442.5080.1		6.0	96.442.6080.1		7.0	96.442.7080.1		8.0	96.442.8080.1	<table border="1"> <thead> <tr> <th>Part No.</th> </tr> </thead> <tbody> <tr><td>96.442.1083.1</td></tr> <tr><td>96.442.2083.1</td></tr> <tr><td>96.442.3083.1</td></tr> <tr><td>96.442.4083.1</td></tr> <tr><td>96.442.5083.1</td></tr> <tr><td>96.442.6083.1</td></tr> <tr><td>96.442.7083.1</td></tr> <tr><td>96.442.8083.1</td></tr> </tbody> </table>	Part No.	96.442.1083.1	96.442.2083.1	96.442.3083.1	96.442.4083.1	96.442.5083.1	96.442.6083.1	96.442.7083.1	96.442.8083.1	<table border="1"> <thead> <tr> <th>Part No.</th> </tr> </thead> <tbody> <tr><td>96.442.1084.1</td></tr> <tr><td>96.442.2084.1</td></tr> <tr><td>96.442.3084.1</td></tr> <tr><td>96.442.4084.1</td></tr> <tr><td>96.442.5084.1</td></tr> <tr><td>96.442.6084.1</td></tr> <tr><td>96.442.7084.1</td></tr> <tr><td>96.442.8084.1</td></tr> </tbody> </table>	Part No.	96.442.1084.1	96.442.2084.1	96.442.3084.1	96.442.4084.1	96.442.5084.1	96.442.6084.1	96.442.7084.1	96.442.8084.1
Application	Length ²⁾ m	Part No.																																													
Power	1.0	96.442.1080.1																																													
250/400V	2.0	96.442.2080.1																																													
1, 2, 3,	3.0	96.442.3080.1																																													
ground	4.0	96.442.4080.1																																													
	5.0	96.442.5080.1																																													
	6.0	96.442.6080.1																																													
	7.0	96.442.7080.1																																													
	8.0	96.442.8080.1																																													
Part No.																																															
96.442.1083.1																																															
96.442.2083.1																																															
96.442.3083.1																																															
96.442.4083.1																																															
96.442.5083.1																																															
96.442.6083.1																																															
96.442.7083.1																																															
96.442.8083.1																																															
Part No.																																															
96.442.1084.1																																															
96.442.2084.1																																															
96.442.3084.1																																															
96.442.4084.1																																															
96.442.5084.1																																															
96.442.6084.1																																															
96.442.7084.1																																															
96.442.8084.1																																															
<table border="1"> <thead> <tr> <th colspan="2">Female – Male</th> </tr> </thead> <tbody> <tr> <td>Extension cable</td> <td></td> </tr> <tr> <td>Locking device</td> <td>yes</td> </tr> </tbody> </table>	Female – Male		Extension cable		Locking device	yes	<table border="1"> <thead> <tr> <th colspan="2">Female – Free end</th> </tr> </thead> <tbody> <tr> <td>Connection cable</td> <td></td> </tr> <tr> <td>Wire ends</td> <td>ultrason. welded</td> </tr> <tr> <td>Sheath strip length</td> <td>35 mm</td> </tr> <tr> <td>Insul. strip length</td> <td>9 mm</td> </tr> </tbody> </table>	Female – Free end		Connection cable		Wire ends	ultrason. welded	Sheath strip length	35 mm	Insul. strip length	9 mm	<table border="1"> <thead> <tr> <th colspan="2">Male – Free end</th> </tr> </thead> <tbody> <tr> <td>Connection cable</td> <td></td> </tr> <tr> <td>Wire ends</td> <td>ultrason. welded</td> </tr> <tr> <td>Sheath strip length</td> <td>35 mm</td> </tr> <tr> <td>Insul. strip length</td> <td>9 mm</td> </tr> <tr> <td>Locking device</td> <td>yes</td> </tr> </tbody> </table>	Male – Free end		Connection cable		Wire ends	ultrason. welded	Sheath strip length	35 mm	Insul. strip length	9 mm	Locking device	yes																	
Female – Male																																															
Extension cable																																															
Locking device	yes																																														
Female – Free end																																															
Connection cable																																															
Wire ends	ultrason. welded																																														
Sheath strip length	35 mm																																														
Insul. strip length	9 mm																																														
Male – Free end																																															
Connection cable																																															
Wire ends	ultrason. welded																																														
Sheath strip length	35 mm																																														
Insul. strip length	9 mm																																														
Locking device	yes																																														

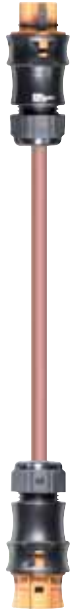
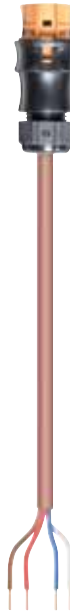
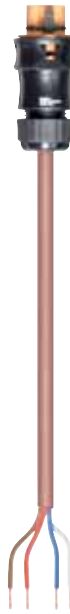

¹⁾ Other cables available on request
²⁾ Other lengths available on request

Cable assemblies 2.5 mm², AS-i 24V

PVC 4 x 2.5				
 <p>1 = BN 2 = RD 3 = BU 4 = WH</p>				
				<p>Female – Male</p> <p>Extension cable</p> <p>Locking device yes</p>
<p>Cable: brown</p> <p>Connector in brown</p> <p>Screw technology</p>				
<p>Application Length²⁾ m</p>	Part No.	Part No.	Part No.	
Power	1.0 96.443.1082.4	96.443.1087.4	96.443.1088.4	
250/400V	2.0 96.443.2082.4	96.443.2087.4	96.443.2088.4	
1, 2, 3, 4	3.0 96.443.3082.4	96.443.3087.4	96.443.3088.4	
	4.0 96.443.4082.4	96.443.4087.4	96.443.4088.4	
	5.0 96.443.5082.4	96.443.5087.4	96.443.5088.4	
	6.0 96.443.6082.4	96.443.6087.4	96.443.6088.4	
	7.0 96.443.7082.4	96.443.7087.4	96.443.7088.4	
	8.0 96.443.8082.4	96.443.8087.4	96.443.8088.4	
	9.0 96.443.9082.4	96.443.9087.4	96.443.9088.4	
 				

¹⁾ Other cables available on request
²⁾ Other lengths available on request

Distribution unit

<p>RST compact distribution unit</p> 	<table border="1"> <thead> <tr> <th>Name</th> <th>Color</th> <th>Part No.</th> </tr> </thead> <tbody> <tr> <td>RST compact distribution unit</td> <td>black</td> <td>available on request</td> </tr> </tbody> </table> <p>See pages 132 to 139 or Customer Information 0161.8 for detailed information about the distribution units</p> <table border="1"> <tbody> <tr> <td>Dimensions</td> <td>112 x 154 x 60 mm</td> </tr> <tr> <td>Fitted as required with</td> <td>M25 device connectors 2 – 5 pole</td> </tr> <tr> <td>Input</td> <td>1</td> </tr> <tr> <td>Outputs</td> <td>3</td> </tr> <tr> <td>Prewired with</td> <td>2.5 mm²</td> </tr> <tr> <td>Fastening options</td> <td>yes</td> </tr> </tbody> </table>	Name	Color	Part No.	RST compact distribution unit	black	available on request	Dimensions	112 x 154 x 60 mm	Fitted as required with	M25 device connectors 2 – 5 pole	Input	1	Outputs	3	Prewired with	2.5 mm ²	Fastening options	yes
Name	Color	Part No.																	
RST compact distribution unit	black	available on request																	
Dimensions	112 x 154 x 60 mm																		
Fitted as required with	M25 device connectors 2 – 5 pole																		
Input	1																		
Outputs	3																		
Prewired with	2.5 mm ²																		
Fastening options	yes																		
<p>RST multi-distribution unit</p> 	<table border="1"> <thead> <tr> <th>Name</th> <th>Color</th> <th>Part No.</th> </tr> </thead> <tbody> <tr> <td>RST multi-distribution unit</td> <td>black</td> <td>available on request</td> </tr> </tbody> </table> <p>See pages 132 to 139 or Customer Information 0161.8 for detailed information about the distribution units</p> <table border="1"> <tbody> <tr> <td>Dimensions</td> <td>112 x 154 x 94 mm</td> </tr> <tr> <td>Fitted as required with</td> <td>M25 device connectors 2 – 5 pole</td> </tr> <tr> <td>Input</td> <td>1</td> </tr> <tr> <td>Outputs</td> <td>7 (max.)</td> </tr> <tr> <td>Prewired with</td> <td>2,5 mm²</td> </tr> <tr> <td>Fuses</td> <td>6.3 or 10 A can be integrated</td> </tr> </tbody> </table>	Name	Color	Part No.	RST multi-distribution unit	black	available on request	Dimensions	112 x 154 x 94 mm	Fitted as required with	M25 device connectors 2 – 5 pole	Input	1	Outputs	7 (max.)	Prewired with	2,5 mm ²	Fuses	6.3 or 10 A can be integrated
Name	Color	Part No.																	
RST multi-distribution unit	black	available on request																	
Dimensions	112 x 154 x 94 mm																		
Fitted as required with	M25 device connectors 2 – 5 pole																		
Input	1																		
Outputs	7 (max.)																		
Prewired with	2,5 mm ²																		
Fuses	6.3 or 10 A can be integrated																		
<p>Distribution box</p> 	<table border="1"> <thead> <tr> <th>Name</th> <th>Color</th> <th>Part No.</th> </tr> </thead> <tbody> </tbody> </table> <p>Example: The individual distribution boxes provide optimal solutions for your special applications. The distribution units are available in various dimensions and are ready to accept modular devices and terminal blocks in any combinations. Routing to the end devices is performed using the gesis IP+ connector system. Customized and tested distribution units can be delivered to the construction site ready for assembly. The appropriate locking devices are already integrated.</p>	Name	Color	Part No.															
Name	Color	Part No.																	

