



SOCKETS FOR C7 RELAYS

- Built in retaining clip
- Removable label marking facility
- One level terminals & in line screws (on S7M)
- S7M is only 22.5mm wide
- S7-I0 input-output socket
- Bridge bar available for S7-I0



S7-M One level, screws on line
22,5 mm wide

Socket offers an optimum packing density and is provided with sturdy screws terminals. DIN rail or panel mountable. Integrated clip. Removable marking label EN/DIN and sequential numbering.

Wiring diagram

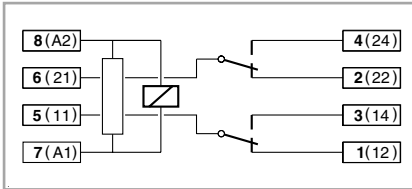

Specifications

Nominal load 10 A/250 V
Dielectric strength (adjacent screws) 2,5 KV
Dielectric strength (screws/rail) 2,5 KV
Max. screw torque 1,2 Nm
Screw dimensions M3, Pozi
Wire in-lets capacity:
Solid wire 4 mm² or 2 x 2,25 mm²
Multi-core 22 - 14 AWG

S7-L S7-P S7-PO
Solder and printed circuit tags

S7-L Flange panel mountable.
S7-P Printed circuit tags.
S7-PO Printed circuit tags with flange.

Printed circuit lay-out

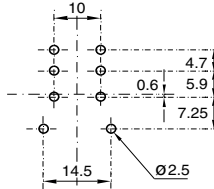

Specifications

Nominal load 10 A/250 V
Dielectric strength (adjacent screws) 2,5 KV
Hard brass tin-plated terminals

S7-I0 Input-Output socket
for 2 pole C7 relay

Bridge bar for coil (A2), Integrated clip, DIN rail or panel mounting

Specifications

Nominal load 10 A/250 V
Dielectric strength (input-output) 2,5 KV
Dielectric strength (screws/rail) 2,5 KV
M3, Pozi screw max. torque 1,2 Nm
Wire inlet capacity multi-core 22 - 14 AWG
Wire inlet solid wire 4 mm² or 2 x 2,25 mm²
Weight avg. 48 grs.

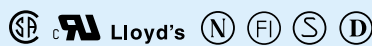
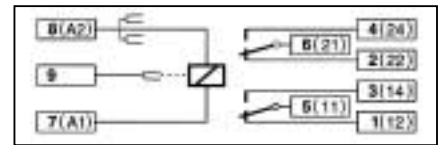

Lloyd's



S7-M

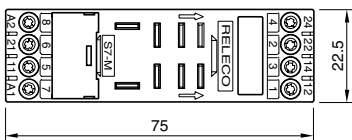
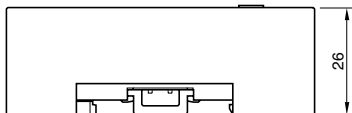

S7-PO

S7-L

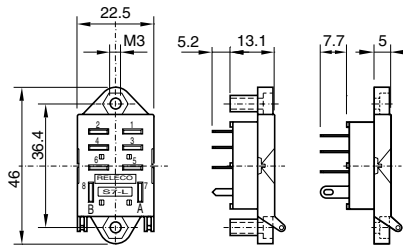

S7-P

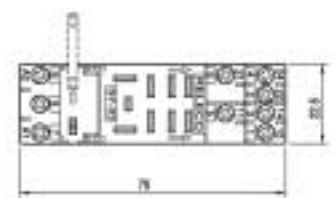
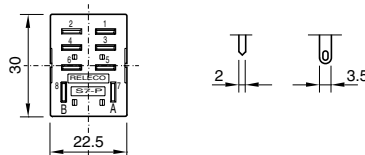

S7BB Bridge Bar

Bridge bar for use with S7-I0 sockets. Pack quantity 5 pieces of strips of 4.

S7-16 16A Socket

16A rated socket @ 250V specifically for use with C7-A10 16A single pole relays. All other characteristics as per S7-M

Bridge bar (pack of five) S7BB

