

SECTION C-C

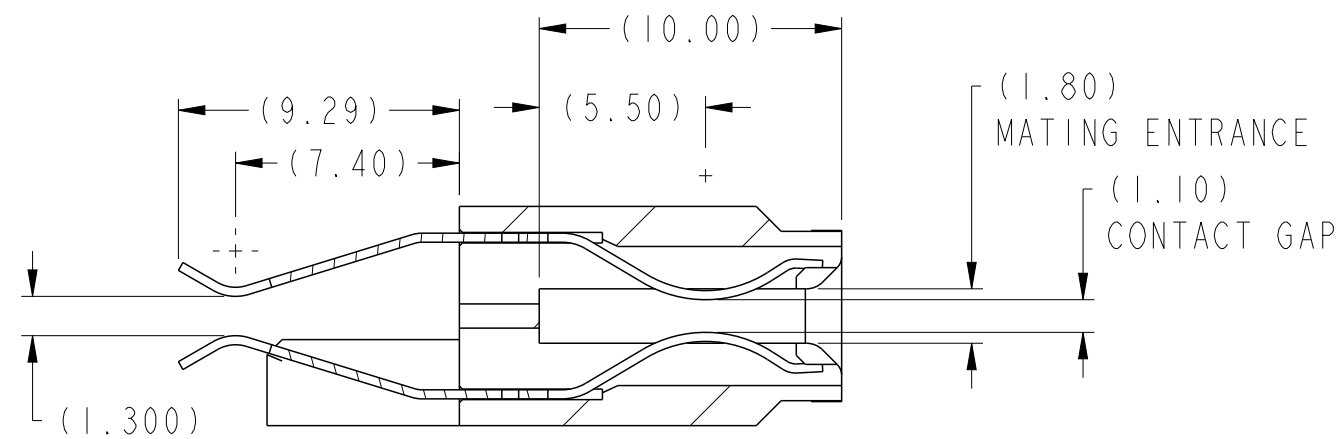

SECTION D-D

REV	ECN NO.	DR	DATE
A	---	Helen	2011-07-14
B	ELX-DG-008380-1	Helen	2011-12-01

spec ref	-	dr	Wei-Long Zhang	2011/05/05	projection	MM	size	A2	scale	4:1	
tolerance std	ASME Y14.5	eng	Wei-Long Zhang	2011/12/01					ecn no		ELX-DG-008380-1
TOLERANCES UNLESS OTHERWISE SPECIFIED		chr	Eleven Hu	2011/12/09					rel level		Released
surface	ASME Y14.5	appr	Pei-Ming Zheng	2011/12/09	product family	CARD EDGE	title	HPCE-STRADDLE MT (36P-24S)		dwg no	10118139
linear	0.X ±0.3 0.XX ±0.1 0.XXX ±0.05	www.fci.com	cat. no.	-	Product - Customer Drw	sheet 1 of 4	rev	B			
angular	0° ±0°										

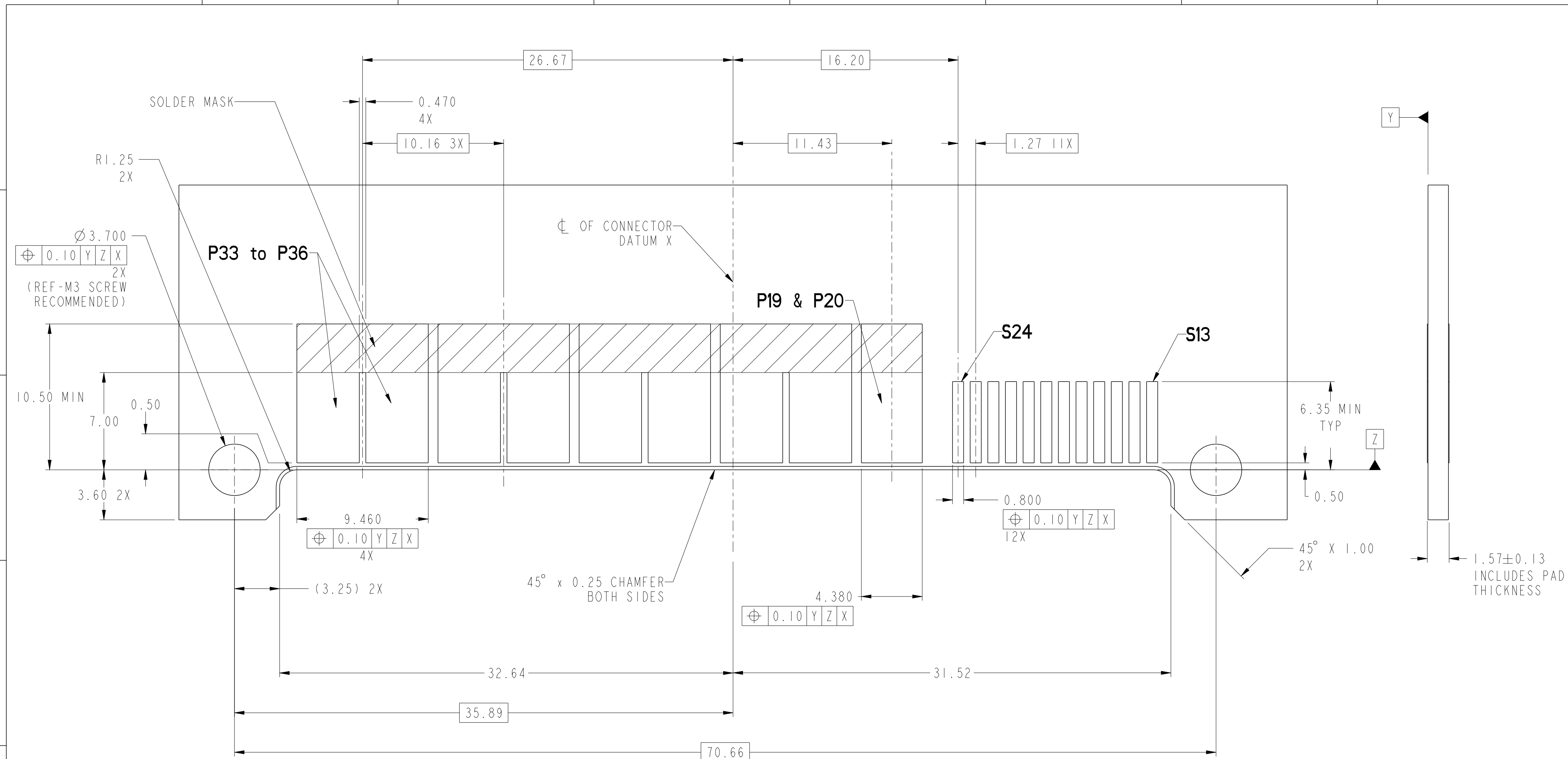

**RECOMMENDED HOST BOARD LAYOUT  
AS VIEWED**

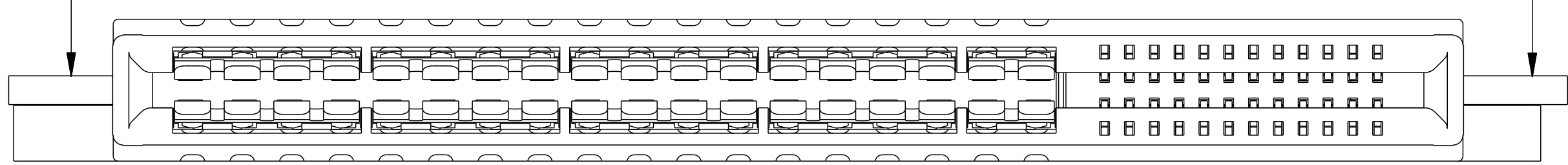

Copyright FCI.  
**FCI**

dr	Wei-Long Zhang	2011/05/05	projection	MM	size	A2	scale	4:1	
eng	Wei-Long Zhang	2011/12/01			ecn no	ELX-DG-008380-1			
chr	Eleven Hu	2011/12/09			rel level	Released			
appr	Pai-Ming Zheng	2011/12/09	product family	CARD EDGE	rel level	Released			
		title	HPCE-STRADDLE MT (36P-24S) (RECEPTACLE)		dwg no	10118139		rev	B
www.fci.com		cat. no.	-		Product - Customer Drw	sheet 2 of 4			

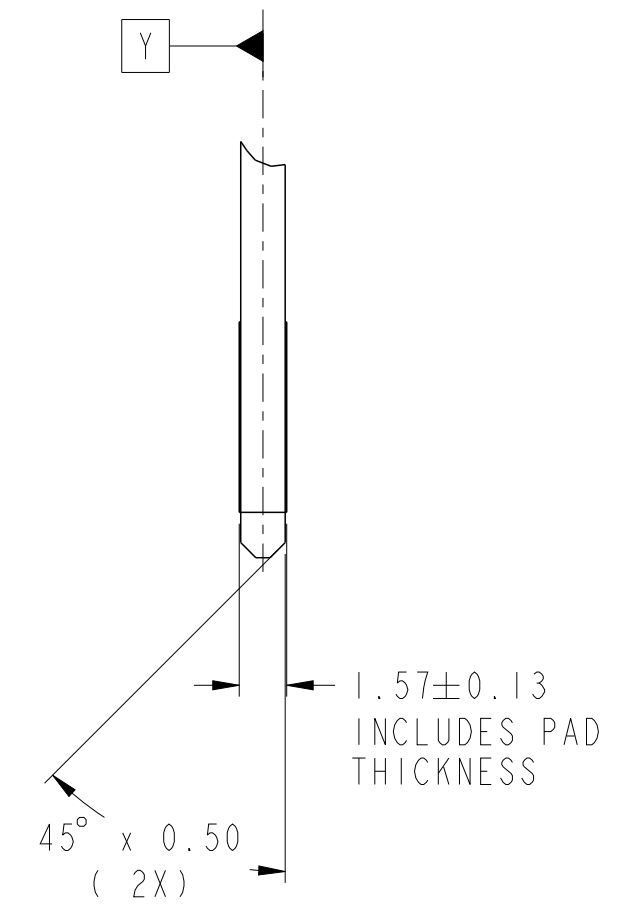
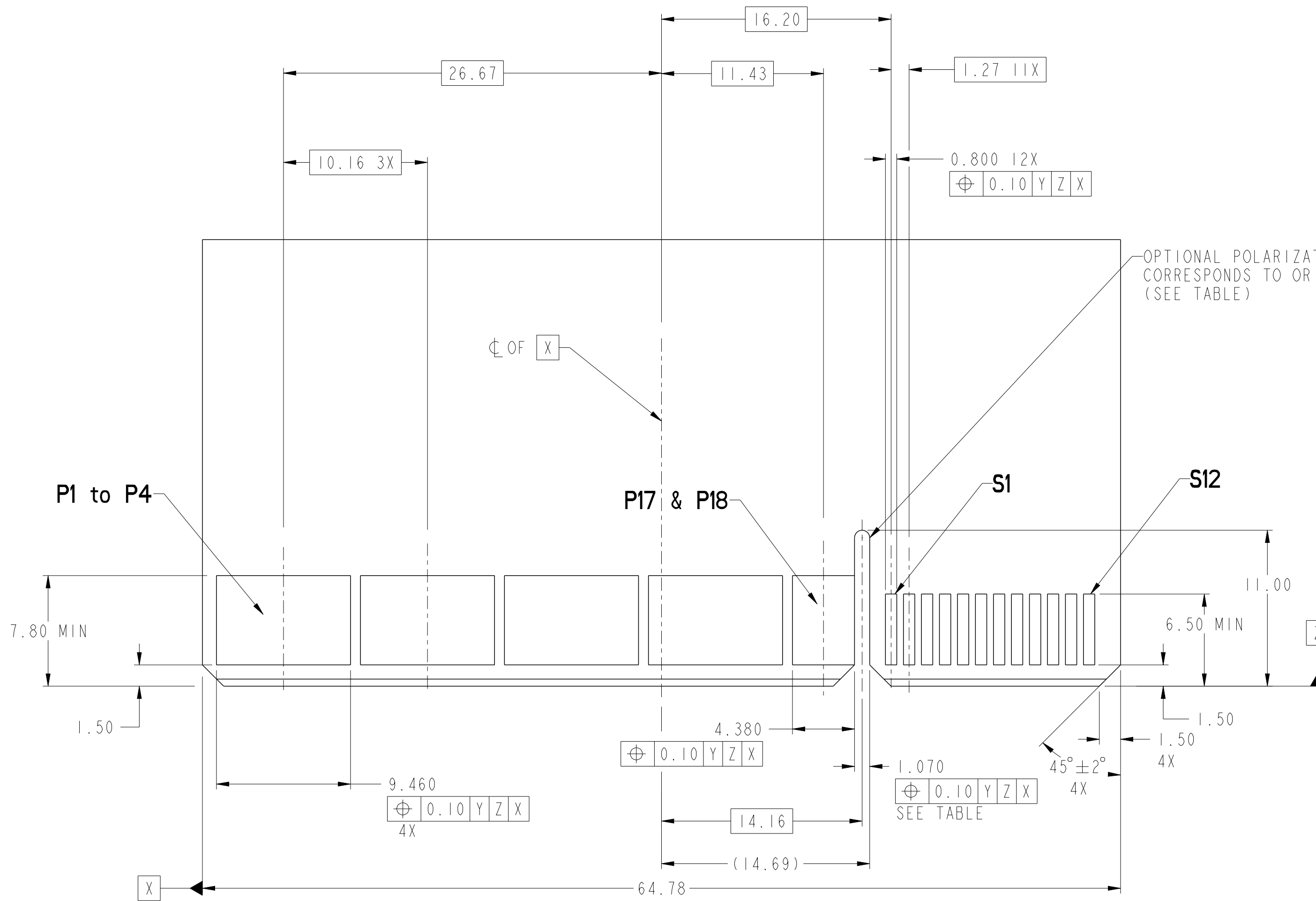

**RECOMMENDED MATING BOARD FOOTPRINT**

dr	Wei-Long Zhang	2011/05/05	projection	MM	size	A2	scale	4:1
eng	Wei-Long Zhang	2011/12/01		MM	ecn no	ELX-DG-008380-1	rel level	Released
chr	Eleven Hu	2011/12/09						
appr	Pai-Ming Zheng	2011/12/09	product family	CARD EDGE				
			title	HPCE-STRADDLE MT (36P-24S) (RECEPTACLE)	dwg no	10118139	rev	B
www.fci.com			cat. no.	-	Product - Customer Drw	sheet 3 of 4		

PART NUMBER	FEATURE A MOUNTING EARS	FEATURE B FRONT POLARIZATION KEY
10118139-001LF	YES	NO
10118139-002LF	YES	YES
10118139-003LF	NO	NO
10118139-004LF	NO	YES

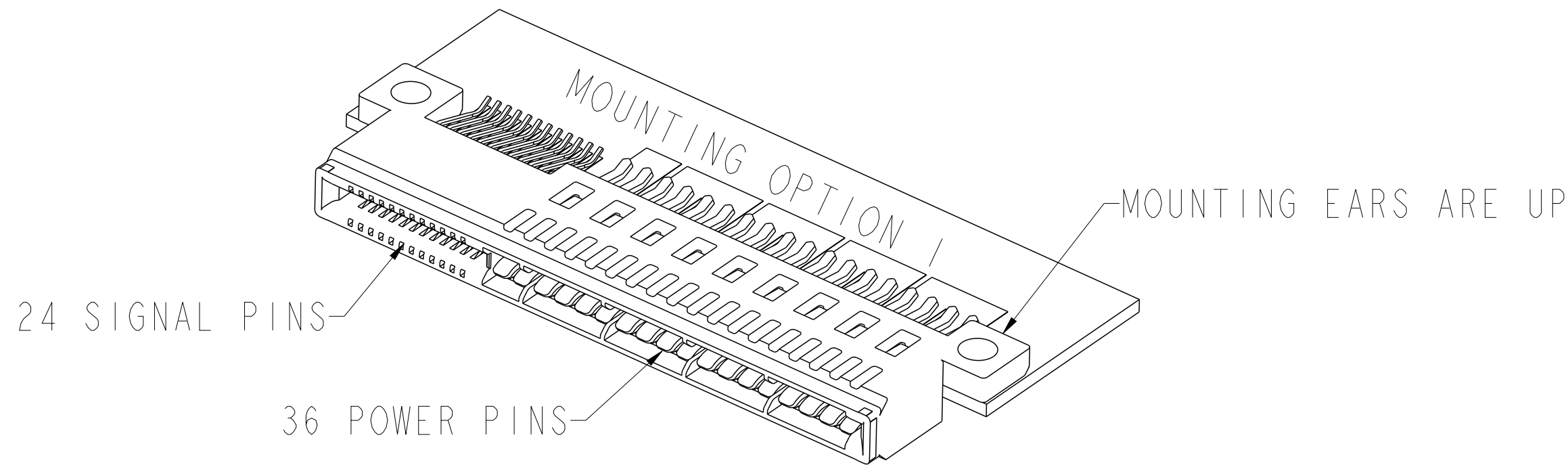
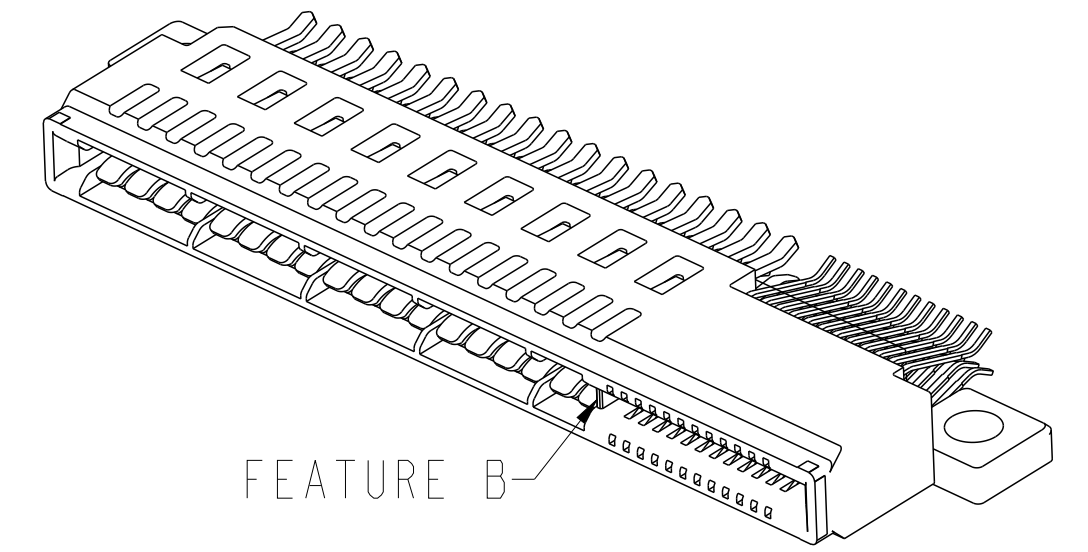
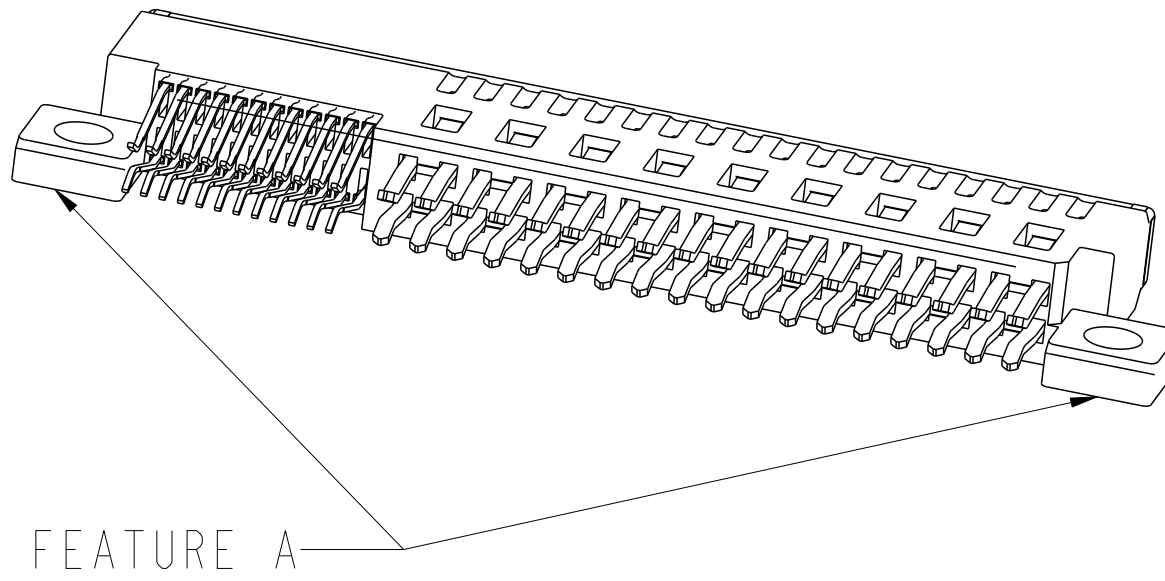

NOTES:

- CONNECTOR MATERIALS:  
 HOUSING: HIGH TEMPERATURE THERMAL PLASTIC, BLACK  
 UL 94V-0 COMPLIANT  
 CONTACTS: HIGH PERFORMANCE COPPER ALLOY.
- CONTACT FINISH REF. GS-12-604 SECTION 5.2.
- PRODUCT SPECIFICATION: GS-12-604.
- APPLICATION SPECIFICATION: GS-20-128.
- PRODUCT MARKING (FCI - PART NUMBER & DATE CODE) ON HOUSING IN AREA SHOWN.
- PACKAGING MEETS FCI SPECIFICATION GS-14-937.
- HOUSING COMPONENT WILL WITHSTAND EXPOSURE TO 260°C PEAK TEMPERATURE FOR 60 SECONDS IN A CONVECTION, INFRA-RED, OR VAPOR PHASE REFLOW OVEN.

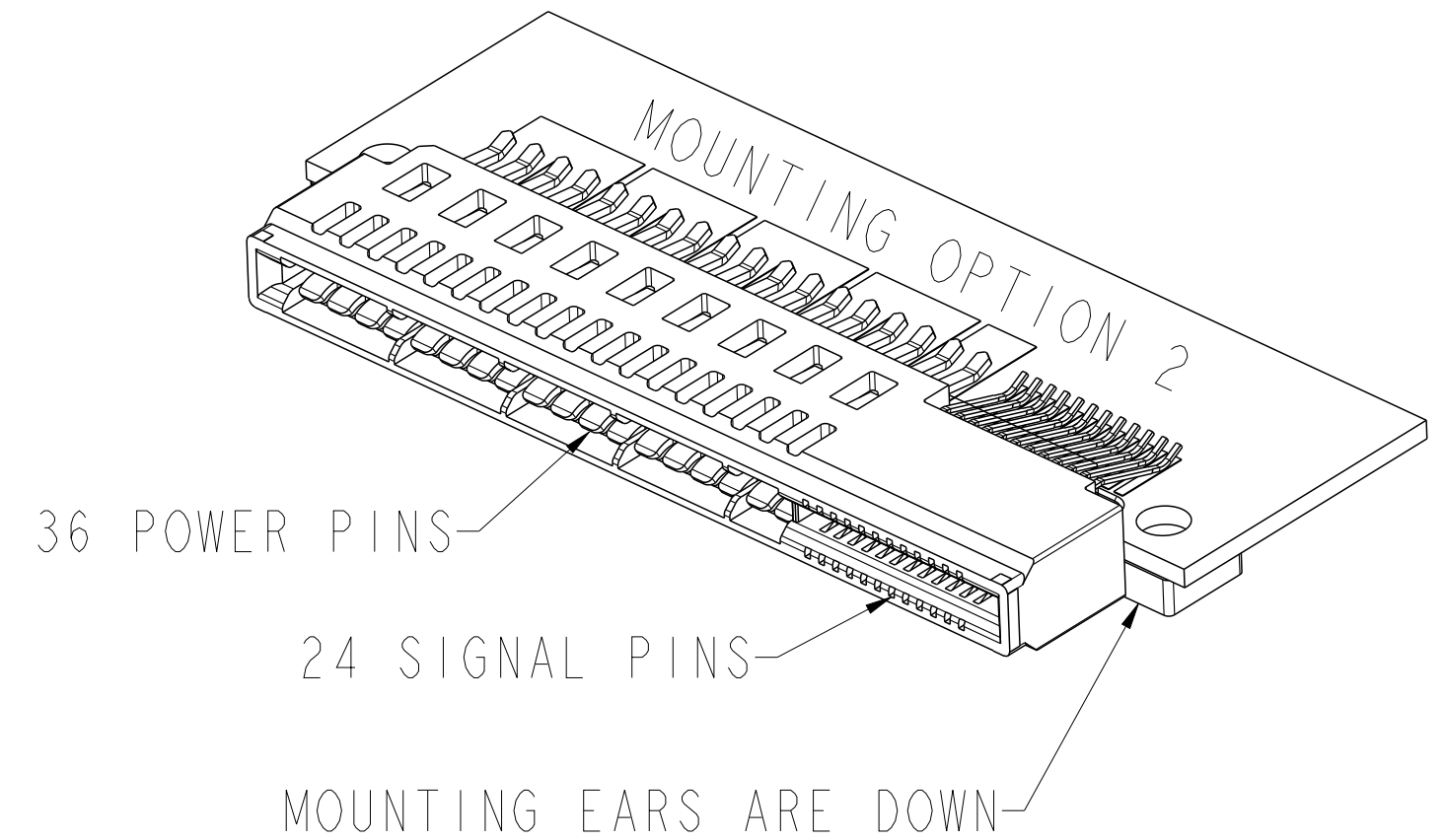

dr	Wei-Long Zhang	2011/05/05	projection	MM	size	A2	scale	4:1
eng	Wei-Long Zhang	2011/12/01			ecn no	ELX-DG-008380-1	rel level	Released
chr	Eleven Hu	2011/12/09						
appr	Fei-Ming Zheng	2011/12/09	product family	CARD EDGE	rel level	Released		
		title HPCE-STADDLE MT (36P-24S) (RECEPTACLE)	dng no 10118139	rev B				
www.fci.com		cat. no.	Product - Customer Drw		sheet 4 of 4			