

REFER TO PAGE 8 & 10 FOR PART DIMENSIONS

NOTE: ALL MOUNTING DIMENSIONS ARE FOR REFERENCE ONLY. PLEASE VERIFY YOUR BATTERY LAYOUT PRIOR TO FABRICATION.



50
550

CAT. NO.	"L" DIMENSION	
	For "AAAA"	
	0.33(8.4)	× 1.67(42.4)
50 550	0.89	(22.6)

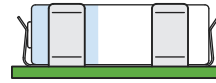

Mounting Detail

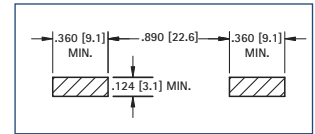

55
555

CAT. NO.	"L" DIMENSION		
	For "AAA"	For "N"	For "12V"
	0.41(10.4)	× 1.75(44.5)	
	0.45(11.4)	× 1.14(29.0)	0.40(10.2) × 1.10(27.9)
55 555	1.80	(45.7)	1.20 (30.5)
			1.15 (29.2)

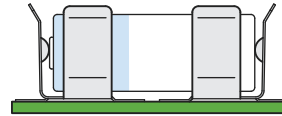

Pad Layout

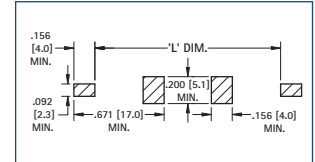

53
553

CAT. NO.	"L" DIMENSION			
	For "AA"	For "2/3 A"	For "CR2"	For "1/2 AA"
	0.56(14.2)	× 1.98(50.3)	0.67(17.0)	× 1.36(34.5)
	0.60(15.2)	× 1.05(26.7)		0.56(14.2) × 0.97(24.5)
53 553	2.05	(52.1)	1.38 (35.1)	1.12 (28.4)
				1.04 (26.4)

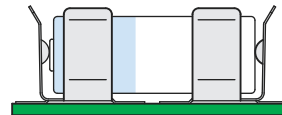

Pad Layout

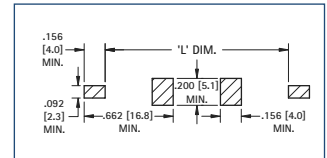

56
556
57
557

CAT. NO.	"L" DIMENSION		
	For "AAA"	For "N"	For "12 V"
	0.41(10.4)	× 1.75(44.5)	0.40(10.2) × 1.10(27.9)
56 556	1.7	(43.2)	1.1 (27.9)
			1.05 (26.7)

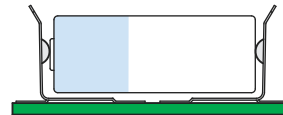

Pad Layout

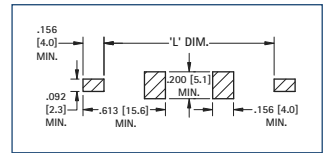

5231
5331
5230
5330

CAT. NO.	"L" DIMENSION			
	For "AA"	For "2/3 A"	For "CR2"	For "1/2 AA"
	0.56(14.2)	× 1.98(50.3)	0.60(15.2)	× 1.05(26.7)
	0.56(14.2)	× 0.97(24.5)		
5231 5331	2.38	(60.5)	1.71 (43.4)	1.53 (38.9)
				1.37 (34.8)

CAT. NO.	"L" DIMENSION			
	For "AAA"	For "N"	For "12 V"	For "AAAA"
	0.41(10.4)	× 1.75(44.5)	0.40(10.2) × 1.10(27.9)	0.33(8.4) × 1.67(42.4)
5230 5330	1.96	(49.8)	1.35 (34.3)	1.31 (33.3)
				1.86 (47.2)

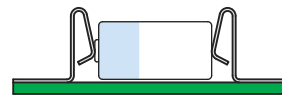

Pad Layout

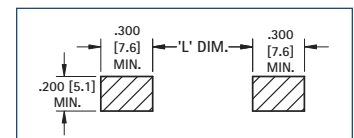

"L" dimensions reflect initial insertion deflection.



207
208

206

CAT. NO.	CELL	BATTERY DIM. REFERENCE	"L" DIMENSION
206	For "AA"	0.56 (14.2) × 1.98 (50.3)	1.10 (27.90)
207	For "C"	1.00 (25.4) × 1.97 (50.0)	0.81 (20.60)
208	For "D"	1.30 (33.0) × 2.42 (61.5)	1.25 (31.80)



Pad Layout

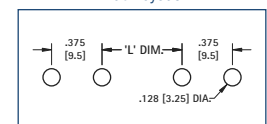

REFER TO PAGE 9 FOR PART DIMENSIONS

NOTE: ALL MOUNTING DIMENSIONS ARE FOR REFERENCE ONLY. VERIFY YOUR BATTERY LAYOUT PRIOR TO FABRICATION.

Mounting Detail

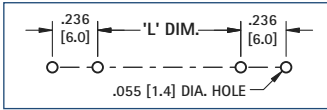

CAT. NO.	"L" DIMENSION
	For "AAAA" 0.33(8.4) × 1.67(42.4)

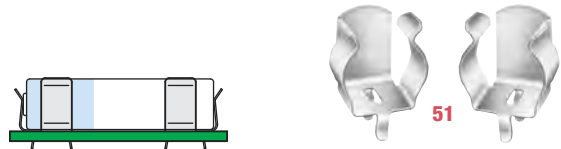

Mounting Detail

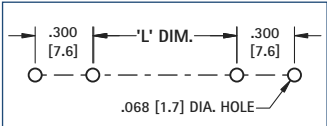

CAT. NO.	"L" DIMENSION		
	For "AAA" 0.41(10.4) × 1.75(44.5)	For "N" 0.45(11.4) × 1.14(29.0)	For "12V" 0.40(10.2) × 1.10(27.9)

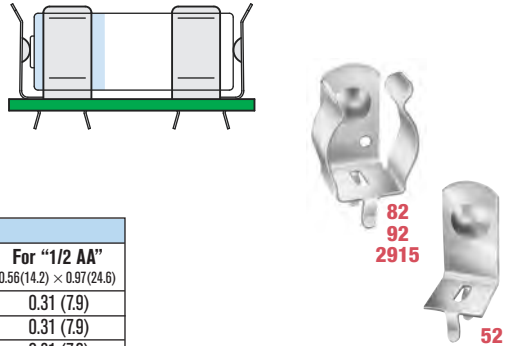

Mounting Detail

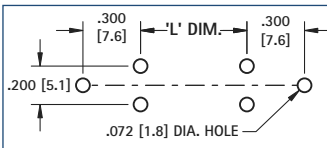

CAT. NO.	"L" DIMENSION	
	For "18650" 0.71(18.4) × 2.56(65.0)	For "2/3 A" 0.67(17.0) × 1.36(34.5)

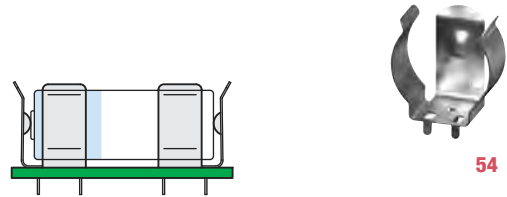

Mounting Detail

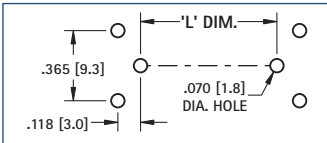

CAT. NO.	"L" DIMENSION	
	For "2/3 A" 0.6(17.0) × 1.36(34.5)	For "CR2" 0.60(15.2) × 1.05(26.7)

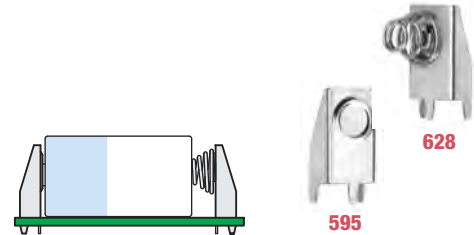

Mounting Detail

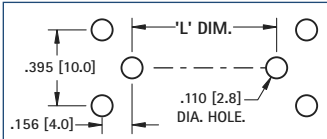

CAT. NO.	"L" DIMENSION				
	For "AA" 0.56(14.2) × 1.98(50.3)	For "AAA" 0.41(10.4) × 1.75(44.5)	For "1/2 AA" 0.56(14.2) × 0.97(24.6)	For "N" 0.45(11.4) × 1.14(29.0)	For "12V" 0.40(10.2) × 1.10(27.9)

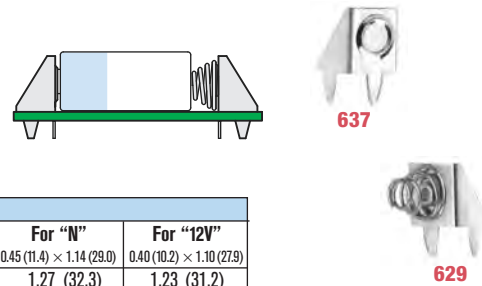

Mounting Detail

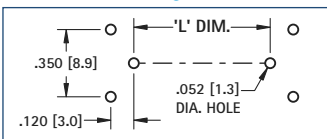

CAT. NO.	"L" DIMENSION			
	For "AA" 0.56(14.2) × 1.98(50.3)	For "2/3 A" 0.67(17.0) × 1.36(34.5)	For "CR2" 0.60(15.2) × 1.05(26.7)	For "1/2 AA" 0.56(14.2) × 0.97(24.6)

CAT. NO.	"L" DIMENSION		
	For "AAA" 0.41(10.4) × 1.75(44.5)	For "N" 0.45(11.4) × 1.14(29.0)	For "12V" 0.40(10.2) × 1.10(27.9)

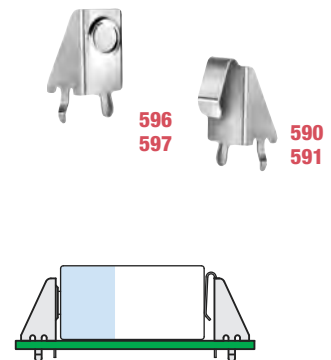

*"L" dimensions reflect initial insertion deflection.

REFER TO PAGES 12 & 13 FOR PART DIMENSIONS

NOTE: ALL MOUNTING DIMENSIONS ARE FOR REFERENCE ONLY. PLEASE VERIFY YOUR BATTERY LAYOUT PRIOR TO FABRICATION.



CAT. NO.	FIG. NO.	"L" DIMENSION			
		For "AAA" 0.41 (10.4) × 1.75 (44.5)	For "N" 0.45 (11.4) × 1.14 (29.0)	For "12 V" 0.40 (10.2) × 1.10 (27.9)	For "AAAA" 0.33 (8.4) × 1.67 (42.4)
204 with 238	1	1.87 (47.5)	1.26 (32.0)	1.22 (31.0)	1.79 (45.5)
204,238 with 295, 296	1	1.87 (47.5)	1.26 (32.0)	1.22 (31.0)	1.79 (45.5)
202 with 294	1	1.87 (47.5)	1.26 (32.0)	1.22 (31.0)	1.79 (45.5)
204 with 204	2	1.97 (50.0)	1.36 (34.5)	1.32 (33.5)	1.89 (48.0)
204 with 202	2	1.97 (50.0)	1.36 (34.5)	1.32 (33.5)	1.89 (48.0)

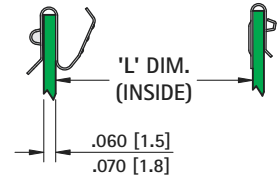

Fig. 1 Spring-Button

"L" dimensions reflect initial insertion deflection.



CAT. NO.	FIG. NO.	"L" DIMENSION			
		For "AA" 0.56(14.2) × 1.98(50.3)	For "1/2 AA" 0.56(14.2) × 0.97(24.6)	For "CR2" 0.60(15.2) × 1.05(26.7)	For "2/3 A" 0.67(17.0) × 1.36(34.5)
209 with 228	1	2.13 (54.1)	1.12 (28.4)	1.20 (30.5)	1.46 (37.1)
209, 228 with 290, 291	1	2.13 (54.1)	1.12 (28.4)	N/A	N/A
288, 210 with 292	1	2.13 (54.1)	1.12 (28.4)	N/A	N/A
209 with 209	2	2.27 (57.7)	1.26 (32.0)	1.34 (34.0)	1.60 (40.6)
209 with 288, 210	2	2.27 (57.7)	1.26 (32.0)	N/A	N/A

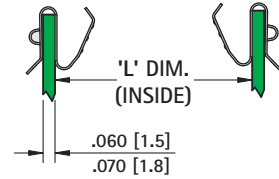

Fig. 2 Spring-Spring

"L" dimensions reflect initial insertion deflection.



CAT. NO.	"L" DIMENSION			
	For "AA" 0.56(14.2) × 1.98(50.3)	For "1/2 AA" 0.56(14.2) × 0.97(24.6)	For "CR2" 0.60(15.2) × 1.05(26.7)	For "2/3 A" 0.67(17.0) × 1.36(34.5)
109-2	2.22 (56.4)	1.21 (30.7)	1.29 (32.8)	1.55 (39.4)
109-3	2.22 (56.4)	1.21 (30.7)	1.29 (32.8)	1.55 (39.4)
1017-1	2.19 (55.6)	1.18 (29.9)	1.26 (32.0)	1.52 (38.6)
108-2	2.22 (56.4)	1.21 (30.7)	1.29 (32.8)	1.55 (39.4)

CAT. NO.	"L" DIMENSION			
	For "AAA" 0.41 (10.4) × 1.75 (44.5)	For "N" 0.45 (11.4) × 1.14 (29.0)	For "12 V" 0.40 (10.2) × 1.10 (27.9)	For "AAAA" 0.33 (8.4) × 1.67 (42.4)
1021-1	1.96 (49.8)	1.35 (34.3)	1.31 (33.3)	1.88 (47.8)
108-2	1.99 (50.5)	1.38 (35.0)	1.34 (34.0)	1.91 (48.5)

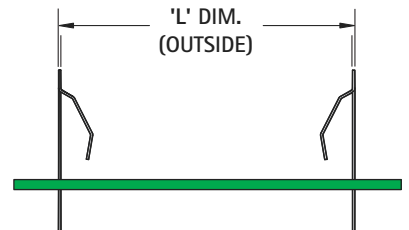

"L" dimensions reflect initial insertion deflection.

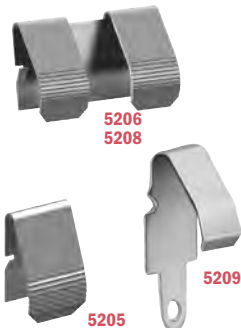

CAT. NO.	"L" DIMENSION			
	For "AA" 0.56(14.2) × 1.98(50.3)	For "1/2 AA" 0.56(14.2) × 0.97(24.6)	For "CR2" 0.60(15.2) × 1.05(26.7)	For "2/3 A" 0.67(17.0) × 1.36(34.5)
5205	2.28 (57.9)	1.27 (32.3)	1.35 (34.3)	1.61 (40.8)
5205 with 5206	2.28 (57.9)	1.27 (32.3)	N/A	N/A
5209	2.34 (59.4)	1.33 (33.8)	1.41 (35.8)	1.67 (42.4)
5209 with 5208	2.34 (59.4)	1.33 (33.8)	N/A	N/A

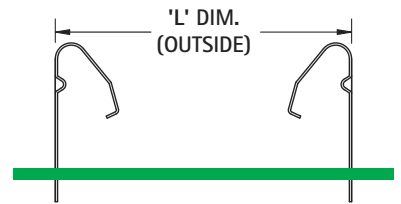

"L" dimensions reflect initial insertion deflection.



CAT. NO.	"L" DIMENSION			
	For "AAA" 0.41 (10.4) × 1.75 (44.5)	For "N" 0.45 (11.4) × 1.14 (29.0)	For "12 V" 0.40 (10.2) × 1.10 (27.9)	For "AAAA" 0.33 (8.4) × 1.67 (42.4)
230-1	1.73 (43.9)	1.12 (29.0)	1.08 (27.9)	1.65 (42.4)

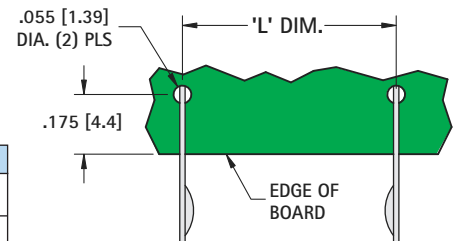

REFER TO PAGE 14 THRU 16 FOR PART DIMENSIONS

NOTE: ALL MOUNTING DIMENSIONS ARE FOR REFERENCE ONLY. VERIFY YOUR BATTERY LAYOUT PRIOR TO FABRICATION.

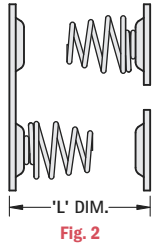
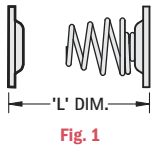

CAT. NO.	"L" DIMENSION				
	FIG. NO.	For "AAA" 0.41 (10.4) × 1.75 (44.5)	For "N" 0.45 (11.4) × 1.14 (29.0)	For "12V" 0.40 (10.2) × 1.10 (27.9)	For "AAAA" 0.33 (8.4) × 1.67 (42.4)
5203 with 5225	1	1.95 (49.5)	1.34 (34.0)	1.30 (33.0)	1.87 (47.5)
5204 with 5226	1	1.95 (49.5)	1.34 (34.0)	1.30 (33.0)	N/A
5214, 5213 with 5203, 5225	2	1.95 (49.5)	1.34 (34.0)	1.30 (33.0)	1.87 (47.5)

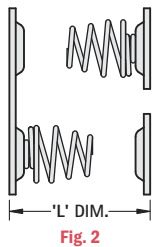
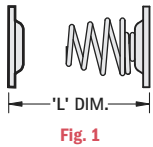

CAT. NO.	"L" DIMENSION				
	FIG. NO.	For "AA" 0.56 (14.2) × 1.98 (50.3)	For "1/2 AA" 0.56 (14.2) × 0.97 (24.6)	For "CR2" 0.60 (15.2) × 1.05 (26.7)	For "2/3 A" 0.67 (17.0) × 1.36 (34.5)
5202 with 5224	1	2.24 (56.9)	1.23 (31.2)	1.31 (33.3)	1.62 (41.1)
5222 with 5221	1	2.24 (56.9)	1.23 (31.2)	1.31 (33.3)	1.62 (41.1)
5201 with 5223	1	2.24 (56.9)	1.23 (31.2)	1.31 (33.3)	1.62 (41.1)
5220 with 5219	1	2.24 (56.9)	1.23 (31.2)	1.31 (33.3)	1.62 (41.1)
5201, 5223 with 5210, 5211	2	2.24 (56.9)	1.23 (31.2)	N/A	N/A
5222, 5221 with 5212	2	2.24 (56.9)	1.23 (31.2)	N/A	N/A
5220, 5219 with 5217, 5218	2	2.24 (56.9)	1.23 (31.2)	N/A	N/A
5227 with 5228	2	2.24 (56.9)	1.23 (31.2)	N/A	N/A

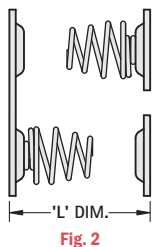
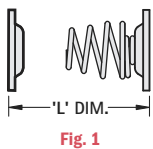

CAT. NO.	"L" DIMENSION		
	FIG. NO.	For "C" 0.99 (25.0) × 1.97 (50.0)	For "D" 1.30 (33.0) × 2.24 (56.9)
5240 with 5241	1	2.25 (57.2)	N/A
5250 with 5251	1	N/A	2.75 (69.9)
5240, 5241 with 5242	2	2.25 (57.2)	N/A
5250, 5251 with 5252, 5253	2	N/A	2.75 (69.9)