

A non-insulated terminal binding post, manufactured from nickel plated brass, rated at 30 Amps, with a non-captive 2 BA nut. Can be used on a maximum of 12,5mm panel thickness.

Dimensions

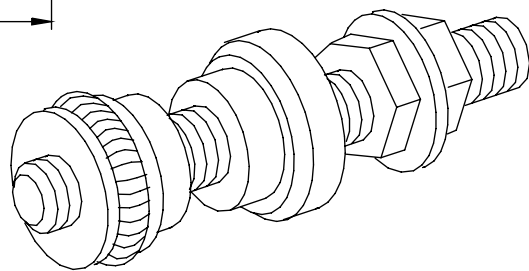
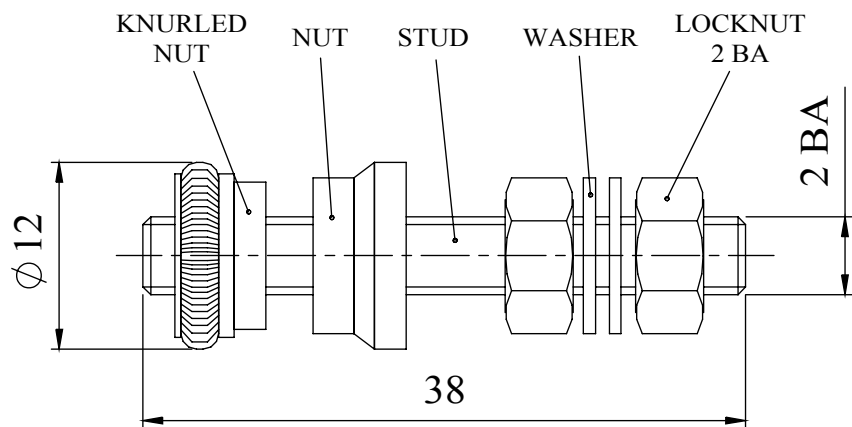

MATERIAL	
LOCKNUT	: Brass, bright nickel plate
WASHER	: Brass, bright nickel plate
STUD	: Brass, bright nickel plate
NUT	: Brass, bright nickel plate
KNURLED NUT	: Brass, bright nickel plate
Maximum Current Rating	: 30 Amps

Tel No. +44(0)1724 273200 Website www.dem-uk.com

PROPRIETARY AND CONFIDENTIAL
 THE INFORMATION CONTAINED IN THIS DRAWING IS THE SOLE PROPERTY OF
ALPHA 3 MANUFACTURING.
 ANY REPRODUCTION IN PART OR AS A WHOLE WITHOUT THE WRITTEN PERMISSION OF
ALPHA 3 MANUFACTURING IS PROHIBITED.

UNLESS OTHERWISE SPECIFIED:
 DIMENSIONS ARE IN MILLIMETRES
 LINEAR TOLERANCE:
NO DECIMAL PLACES ±0.5mm
1 DECIMAL PLACE ±0.25mm
2 DECIMAL PLACES ±0.125mm
 ANGULAR TOLERANCE: ±1°

FINISH	TERMINAL BINDING POST	DEBURR AND BREAK SHARP EDGES
IF IN DOUBT ASK DO NOT SCALE DRAWING		
MATERIAL	SEE NOTE	

DRAWN BY	SPB
APPROVED BY	WC
THIRD ANGLE PROJECTION	SHEET 1 OF 1
	SCALE 1:1
	A4

TITLE	GENERAL SPECIFICATION FOR 351-0000
DRAWING NO.	351-0000
ISSUE	02
	Release



DEM Manufacturing, Deltron Emcon House
 Hargreaves Way, Sawcliffe Ind. Park,
 Scunthorpe, North Lincolnshire, DN15 8RF, UK