

## SPRING & BUTTON CONTACTS

- Economical and reliable contacts are ideal for molded cases with self contained battery compartments
- "Solder tab" design for either wire lead or PC mounting
- Unique spring contacts adjust to variations in battery lengths
- Reliable spring contacts assure low contact resistance and a dependable connection
- Space saving, economical, excellent mechanical construction

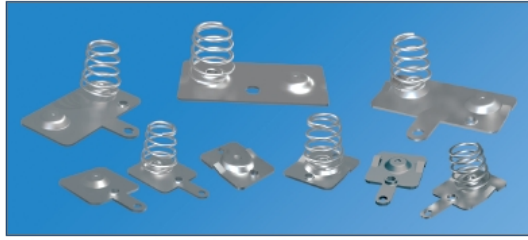

**MATERIAL:**

Plate: .020 (.51) Steel, Nickel Plate Spring: Spring Steel, Nickel Plate

Refer to page 35 for Battery Contact Layout & Mounting Details

"AA" • "CR2" • "A"

(-) NEGATIVE SPRING

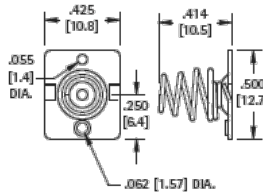

CAT. NO. 5222

(+) POSITIVE BUTTON

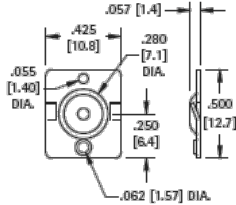

CAT. NO. 5221

DUAL CONTACT

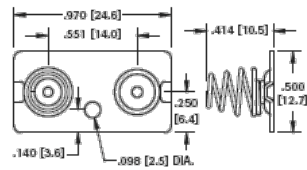

CAT. NO. 5212 Left or Right

(-) NEGATIVE SPRING WITH TAB

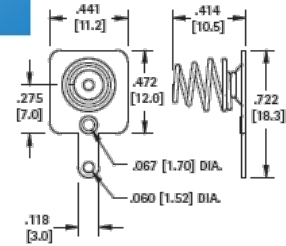

CAT. NO. 5201

(+) POSITIVE BUTTON WITH TAB

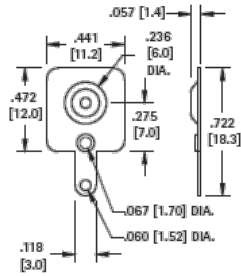

CAT. NO. 5223

DUAL CONTACT WITH TAB

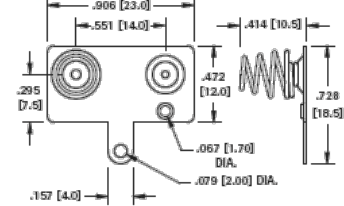

CAT. NO. 5211 Left

CAT. NO. 5211 Right (Shown)

(-) NEGATIVE SPRING WITH TAB/LANCE

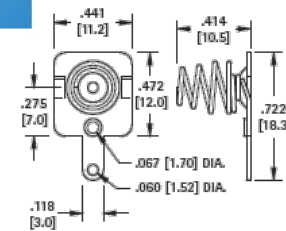

CAT. NO. 5220

(+) POSITIVE BUTTON WITH TAB/LANCE

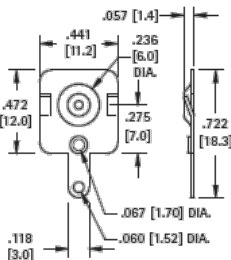

CAT. NO. 5219

DUAL CONTACT WITH TAB/LANCE

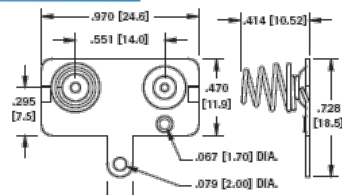

CAT. NO. 5218 Left

CAT. NO. 5217 Right (Shown)

Tel (718) 956-8900 • Fax (718) 956-9040  
(800) 221-5510 • kec@keyco.com

**KEYSTONE**  
RoHS COMPLIANT — ISO 9001 CERTIFIED

www.keyco.com  
31-07 20th Road - Astoria, NY 11105-2017

BATTERY CONTACTS FOR MOLDED CASES