

# TYS6045100M-10

## PHYSICAL DIMENSIONS:

A	6.00 ± 0.30
B	6.00 ± 0.30
C	4.50 MAX.
D	1.55 ± 0.30
E	2.90 ± 0.30

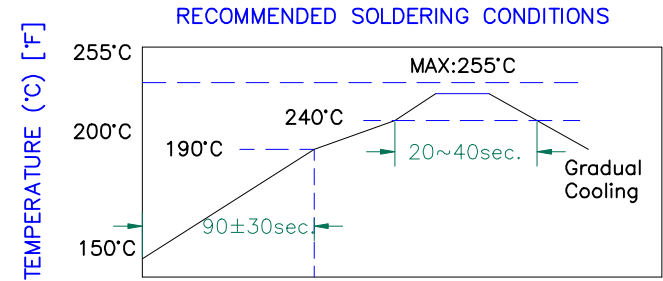
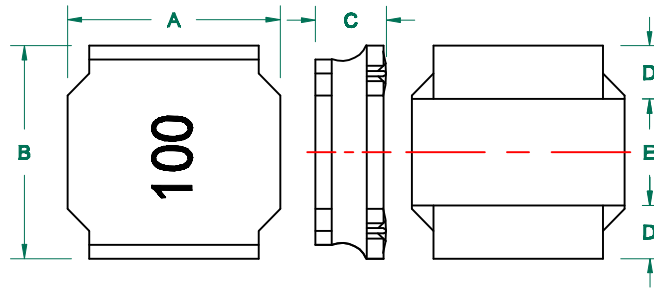

## LAND PATTERNS FOR REFLOW SOLDERING

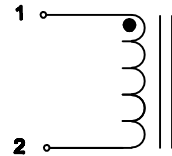
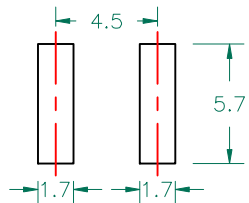

## ELECTRICAL SPECIFICATION

	Min	Nom	Max
INDUCTANCE (uH) L @ 100 KHz/1V ± 20%	8.0	10.0	12.0
DCR (Ω)		0.048	0.0624

Saturation Current(A)	3.20
SRF (MHz)	15
Temperature Rise Current (A)	2.45

## CHARACTERISTICS OF TEMPERATURE RISE

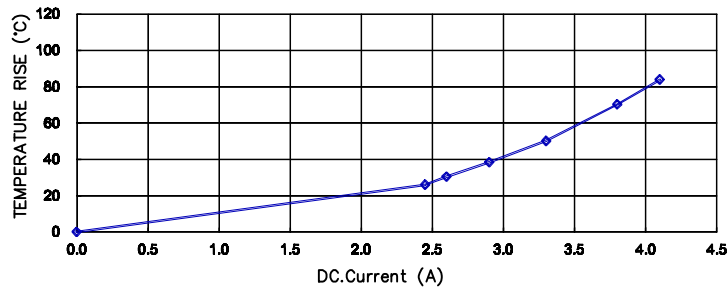

## CURRENT VS INDUCTANCE DROP IN RATES

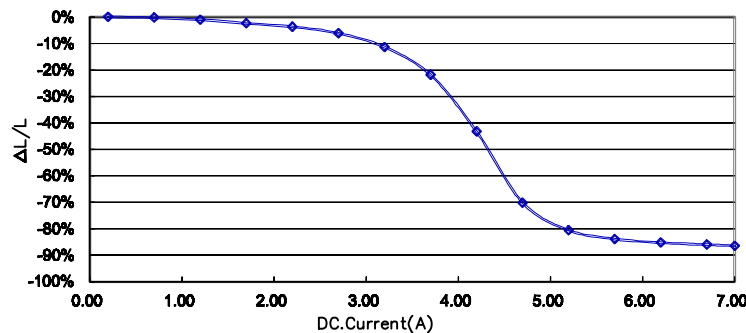

**UNCONTROLLED DOCUMENT**

NOTES: UNLESS OTHERWISE SPECIFIED

- OPERATING TEMPERATURE RANGE: -25°C TO +125°C (INCLUDING SELF-HEATING) .
- STORAGE TEMPERATURE RANGE (PACKAGING CONDITIONS): -10°C TO +40°C AND RH 70% (MAX.)
- UNLESS OTHERWISE SPECIFIED, THE STANDARD ATMOSPHERIC CONDITIONS FOR MEASUREMENT/TEST AS:
  - AMBIENT TEMPERATURE: 20±15°C.
  - RELATIVE HUMIDITY: 65%±20%.
- DEFINITION OF SATURATION CURRENT (ISAT): DC CURRENT AT WHICH THE INDUCTANCE DROPS ≤30% FROM ITS VALUE WITHOUT CURRENT.
- DEFINITION OF TEMPERATURE RISE CURRENT (IRMS): DC CURRENT THAT CAUSES THE TEMPERATURE RISE (ΔT ≤40°C) FROM 20°C AMBIENT.

DIMENSIONS ARE IN mm .				This print is the property of Laird Tech. and is loaned in confidence subject to return upon request and with the understanding that no copies shall be made without the written consent of Laird Tech. All rights to design or invention are reserved.					
				<b>Laird TECHNOLOGIES</b>					
PROJECT/PART NUMBER:				TYS6045100M-10		REV	C	PART TYPE: POWER INDUCTOR	DRAWN BY: QIU
C	ADD CURVE	05/08/12	QIU	DATE: 04/06/12		SCALE: NTS	SHEET: 2 of 2		
B	CHE OPERATING TEMPERATURE RANGE	04/06/12	QIU	DATE: 04/06/12		SCALE: NTS	SHEET: 2 of 2		
A	ORIGINAL DRAFT	11/15/11	QIU	DATE: 04/06/12		SCALE: NTS	SHEET: 2 of 2		
REV	DESCRIPTION	DATE	INT	CAD # TYS6045100M-10-C		TOOL # -	SHEET: 2 of 2		