

# Surface Mount Low Leakage Diode

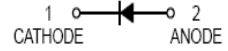

## Features:

- Low Leakage Current
- High Reverse Breakdown Voltage
- Fast Switching Speed
- Surface Mount Package Ideally Suited for Automatic Insertion



SOD-123

## Applications:

Surface mount fast switching diode

## Max. Rating @ $T_A = 25^\circ\text{C}$ unless otherwise specified

Characteristic	Symbol	Value	Unit
Peak repetitive reverse voltage	$V_{RRM}$	350	V
Working peak reverse voltage DC reverse voltage	$V_{RWM}$ $V_R$	300	V
RMS reverse voltage	$V_{R(RMS)}$	212	V
Forward continuous current	$I_{FM}$	225	mA
Repetitive peak forward current	$I_{FRM}$	625	mA
Non-Repetitive peak forward surge current @t=1.0us @t=1.0s	$I_{FSM}$	4 1	A
Power dissipation	$P_d$	400	mW
Thermal resistance junction to ambient air	$R_{\theta JA}$	312	$^\circ\text{C}/\text{W}$
Operating and storage temperature range	$T_J, T_{STG}$	-65 to +150	$^\circ\text{C}$

## Electrical Characteristics @ $T_A = 25^\circ\text{C}$ unless otherwise specified

Characteristic	Symbol	Min.	Typ.	Max.	Unit	
Reverse breakdown voltage	$V_{(BR)R}$	350	-	-	V	$I_R = 150\mu\text{A}$
Forward voltage	$V_F$	-	0.78 0.93 1.03	0.87 1 1.25	V	$I_F = 20\text{mA}$ $I_F = 100\text{mA}$ $I_F = 200\text{mA}$
Reverse current	$I_R$	-	30 35	100 100	nA uA	$V_R = 240\text{V}, T_J = 25^\circ\text{C}$ $V_R = 240\text{V}, T_J = 150^\circ\text{C}$
Total capacitance	$C_T$	-	1	5	pF	$V_R = 0\text{V}, f = 1\text{MHz}$
Reverse recovery time	$t_{rr}$	-	-	50	ns	$I_F = I_R = 30\text{mA}$ , $I_{rr} = 0.1 \times I_R, R_L = 100\Omega$

# Surface Mount Low Leakage Diode



Typical Characteristics @  $T_A = 25^\circ\text{C}$  unless otherwise specified

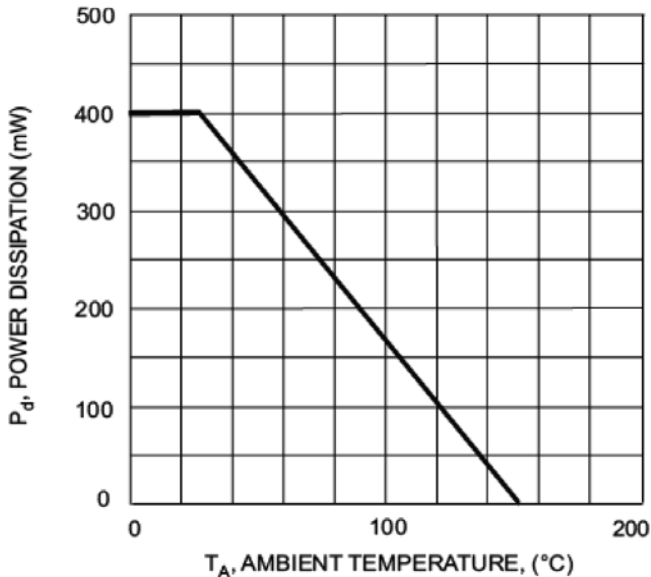

Fig. 1 Power Derating Curve

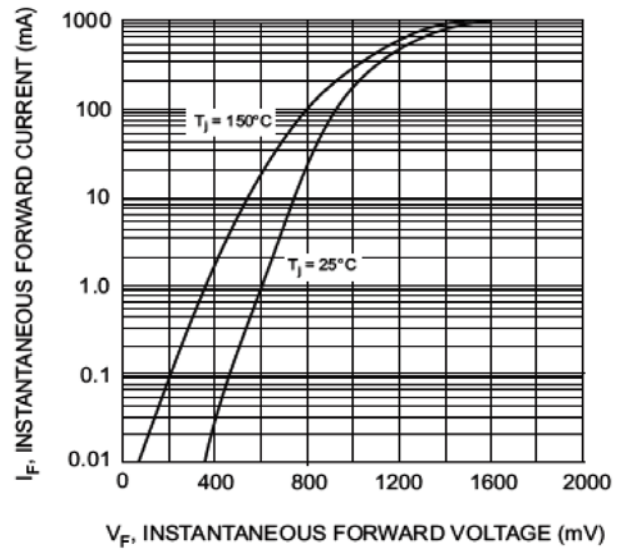

Fig. 2 Typical Forward Characteristics

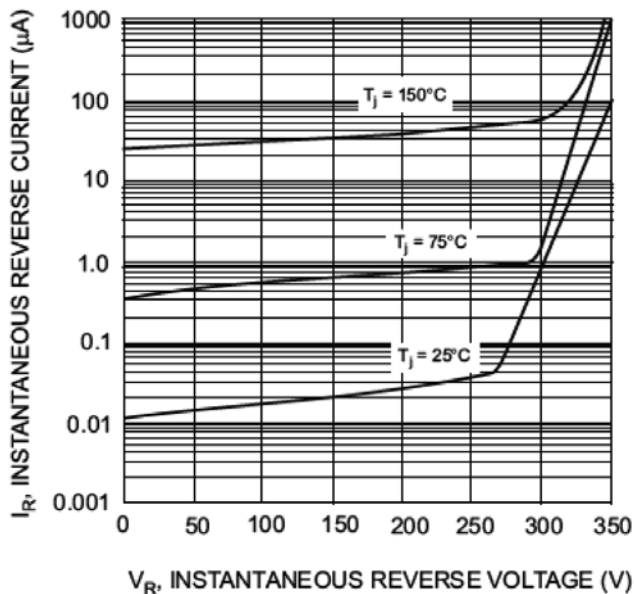

Fig. 3 Typical Reverse Characteristics

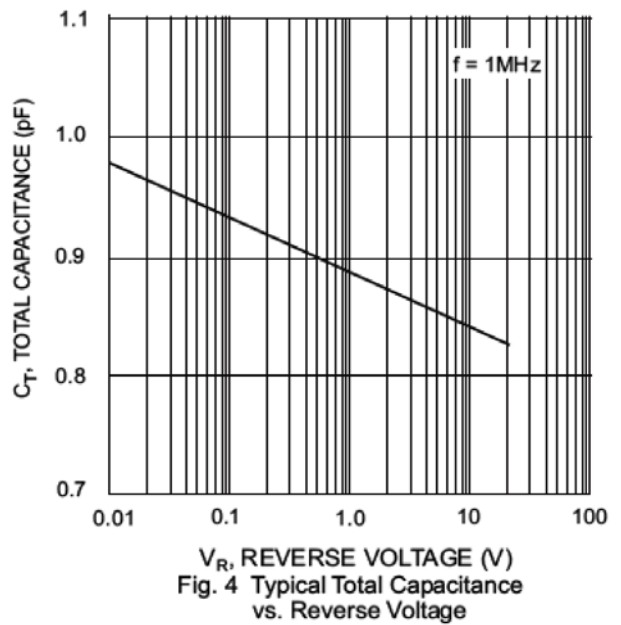

Fig. 4 Typical Total Capacitance vs. Reverse Voltage



# Surface Mount Low Leakage Diode



## Plastic surface mounted package

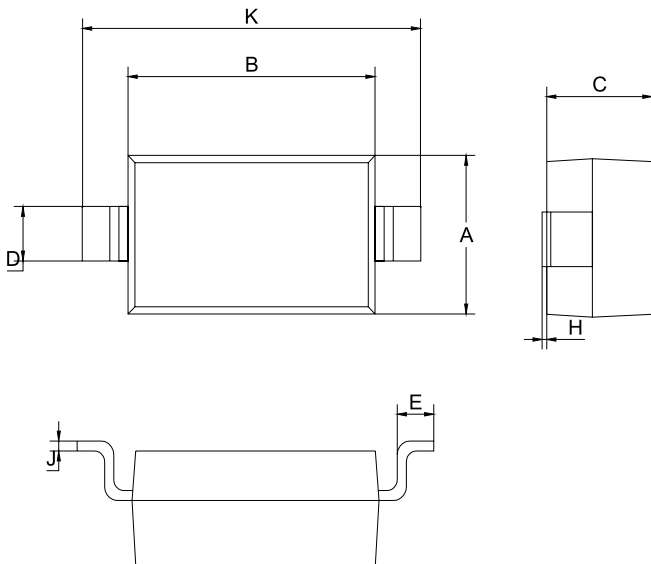

SOD-123		
Dim	Min	Max
A	1.4	1.8
B	2.55	2.85
C	1.15 Typical	
D	0.55 Typical	
E	0.3	0.4
H	0.02	0.1
J	0.1 Typical	
K	3.55	3.85
All Dimensions in mm		

## Soldering Footprint

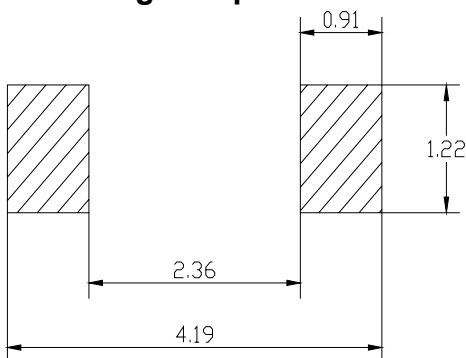

Unit: mm

## Package Information

Device	Package	Shipping
BAV3004W-7-F	SOD-123	3,000 / Tape & Reel

## Part Number Table

Description	Part Number
Surface mount low leakage diode	BAV3004W-7-F

**Important Notice :** This data sheet and its contents (the "Information") belong to the members of the Premier Farnell group of companies (the "Group") or are licensed to it. No licence is granted for the use of it other than for information purposes in connection with the products to which it relates. No licence of any intellectual property rights is granted. The Information is subject to change without notice and replaces all data sheets previously supplied. The Information supplied is believed to be accurate but the Group assumes no responsibility for its accuracy or completeness, any error in or omission from it or for any use made of it. Users of this data sheet should check for themselves the Information and the suitability of the products for their purpose and not make any assumptions based on information included or omitted. Liability for loss or damage resulting from any reliance on the Information or use of it (including liability resulting from negligence or where the Group was aware of the possibility of such loss or damage arising) is excluded. This will not operate to limit or restrict the Group's liability for death or personal injury resulting from its negligence. Multicomp is the registered trademark of the Group. © Premier Farnell plc 2012.

