

MECHANICAL DETAILS

- Shell Style Model** EG* : Fixed receptacle nut fixing
- Keying** 1 key (alpha=0, plug: male contacts, receptacle: female contacts)
- Housing Material** Brass (chrome plated) shell and collet nut, nickel plated brass latch sleeve and mid pieces
- Cable Fixing** 0 - 0 mm
- Variant 2** :

		B	L	M	N	S1	S3
Mm.		10.3	15.5	1	13.7	6.3	9
In.		0.41	0.61	0.04	0.54	0.25	0.35

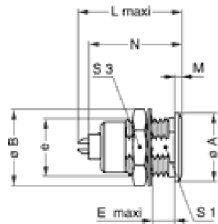

Available Download

 [unipole_multipole.pdf](#)

PERFORMANCE DETAIL

- Insert** 0.304 : 4 Low Voltage
- Insulator** L: PEEK
- Specifications**
- Contact Type:** Solder
- Max. Matings:** 5000
- Contact Dia.:** 0.5 mm (0.02in)
- Bucket Dia.:** 0.4 mm (0.016in)
- Max. Solid** 0.09 mm² (AWG 28)
- Max. Stranded** 0.05 mm² (AWG 30)
- R (max):** 8.7 mOhm









OTHER CHARACTERISTICS

- Shell Style/Model** Libellé
- IP Rating** 50



Related links

-  [Contact](#)
-  [Quote Request](#)
-  [Catalogs Downloads](#)
-  [Catalogs Requests](#)
-  [Sample Request](#)
-  [3D drawings](#)