

# High Power LED

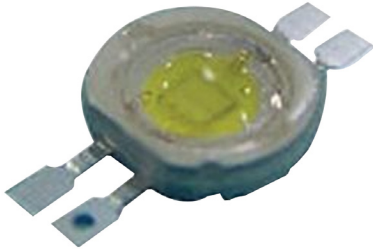

## Features:

- 3W High Luminous LED
- Excellent Heat Transfer

## Maximum Ratings at Ta=25°C

Reverse Voltage (<100µA)	: 5V
D.C. Forward Current	: 700mA
Pulse Current (tp <100µS, duty cycle = 0.005)*1	: 1,000mA
Operating Temperature Range	: -40°C to +75°C
Storage Temperature Range	: -40°C to +105°C
Soldering Temperature Reflow Soldering	: 260°C for 10 secs
Soldering Temperature Hand Soldering	: 350°C for 3 secs

## Electrical & Optical Characteristics at Ta = 25°C

LED Chip	Lens Colour	Correlated Colour Temperature ( K )			Luminous Flux (1m) at 1,500mA			Forward Voltage (V) at 1,500mA		Viewing Angle 2θ <sup>1/2</sup> (deg)	Thermal Resistance Junction to Case (°C/W)	Reverse Current (µA)	Temp Co-Efficient of Forward Voltage (mV/°C)
		min.	typ.	max.	min.	typ.	max.	min.	max.				
White	Water Clear	5,000	6,500	9,000	147	200	323	2.7	4.25	120	10	50	-2
Warm White		2,700	3,200	3,700	113	150	248						

## Typical Electrical/Optical Characteristic Curves

(25 Ambient Temperature Unless Otherwise Noted)

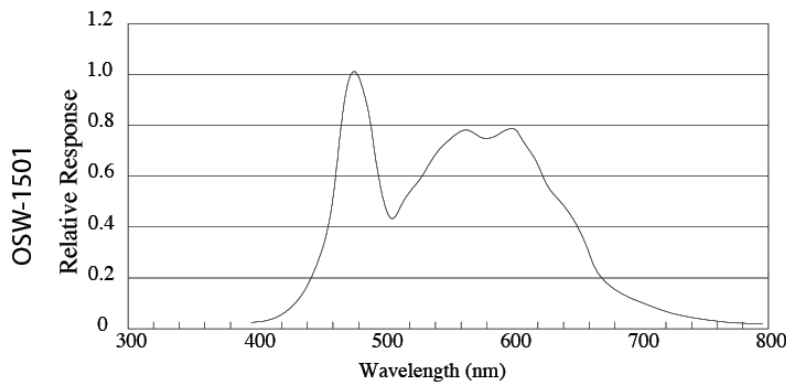

# High Power LED

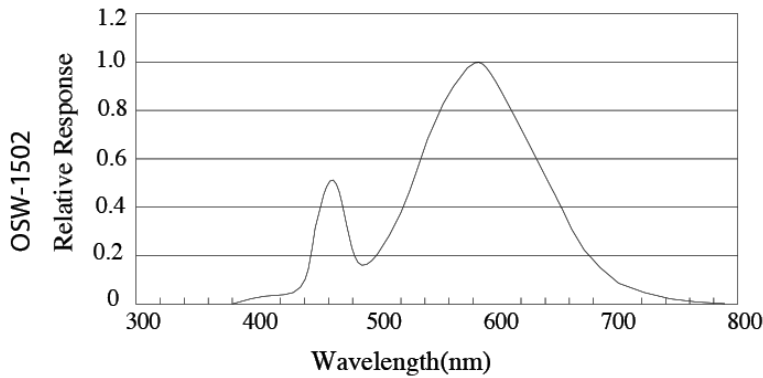

## Diagrams:

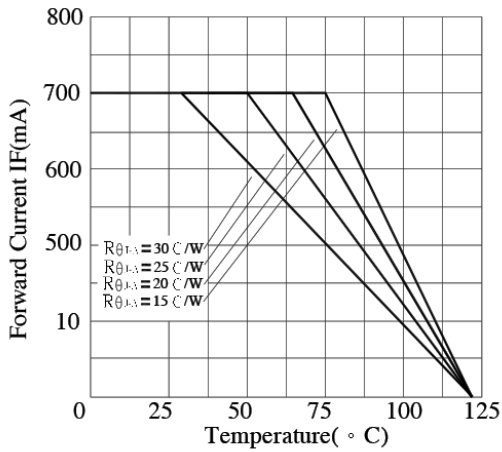

Ambient Temperature Vs. Forward Current

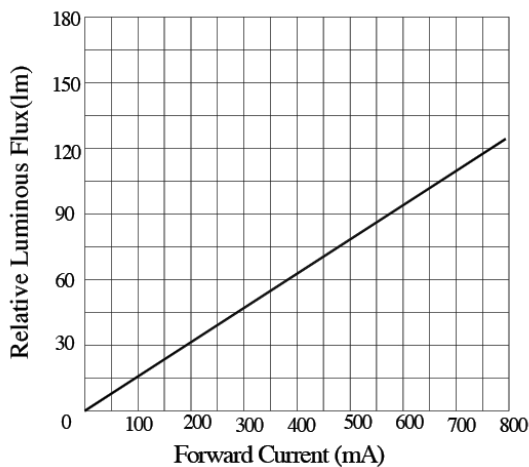

Forward Current Vs. Luminous Flux

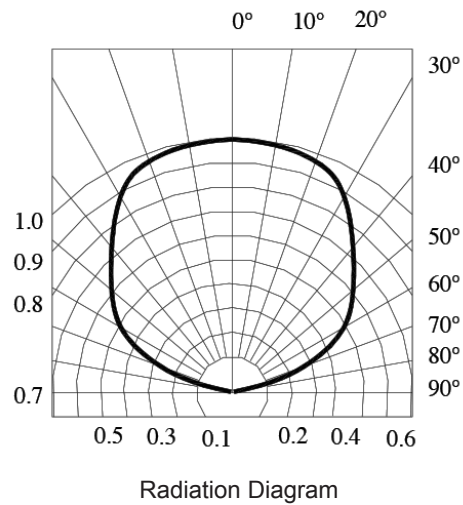

Radiation Diagram



# High Power LED



## OSW-13 Series

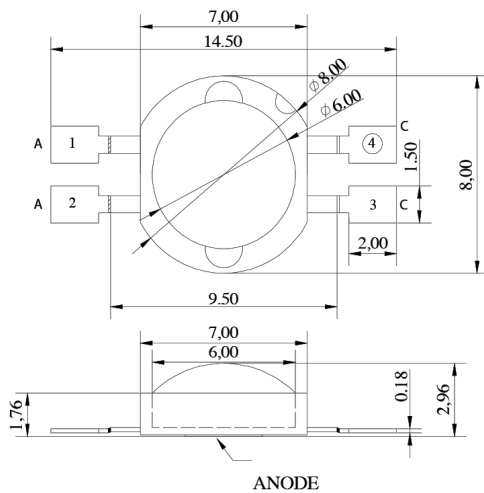

Dimensions : Millimetres

### Part Number Table

Description	Part Number
LED 5W Hi Power SMD White	OSW-1501
LED 5W Rnd Hi Power SMD Warm White	OSW-1502

**Important Notice :** This data sheet and its contents (the "Information") belong to the members of the Premier Farnell group of companies (the "Group") or are licensed to it. No licence is granted for the use of it other than for information purposes in connection with the products to which it relates. No licence of any intellectual property rights is granted. The Information is subject to change without notice and replaces all data sheets previously supplied. The Information supplied is believed to be accurate but the Group assumes no responsibility for its accuracy or completeness, any error in or omission from it or for any use made of it. Users of this data sheet should check for themselves the Information and the suitability of the products for their purpose and not make any assumptions based on information included or omitted. Liability for loss or damage resulting from any reliance on the Information or use of it (including liability resulting from negligence or where the Group was aware of the possibility of such loss or damage arising) is excluded. This will not operate to limit or restrict the Group's liability for death or personal injury resulting from its negligence. Multicomp is the registered trademark of the Group. © Premier Farnell plc 2012.

www.element14.com  
 www.farnell.com  
 www.newark.com

