

Part Number: CM43

Type	Size	Rating	Description
Incandescent	T10	2.5V 500mA	T-3¼ Bayonet Lamp

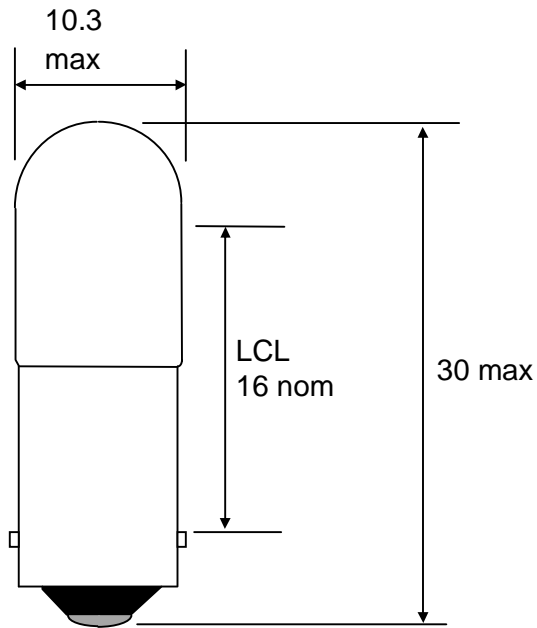

Dimensions in millimetres

TEST VOLTS	CURRENT (mA)			LIGHT OUTPUT (Lm)			LIFE Hours
	Min.	Nom.	Max.	Min.	Nom.	Max.	
2.5	450	500	550	4.8	6.3	7.8	3,000

Notes:

- 1 **Base Type** BA9s/13 Nickel plated brass
- 2 **Filament Shape** C-2R
- 3 **Lamp Marking** CML43 2.5V 500mA
- 4 **Environmental** RoHS & REACH SVHC compliant